

future 132kV Switching station
of Lichtenburg PV 1, 2 and 3
proposed by other developer

**LICHTENBURG 3
PV PROJECT**
proposed by other developer

ZAMENKOMST 4 IP
2/4

24/31

20/31

19/31

HOUTHAAALBOOMEN 31 IP

LICHTENBURG TOWN AND TOWNLANDS 27 IP
10/27

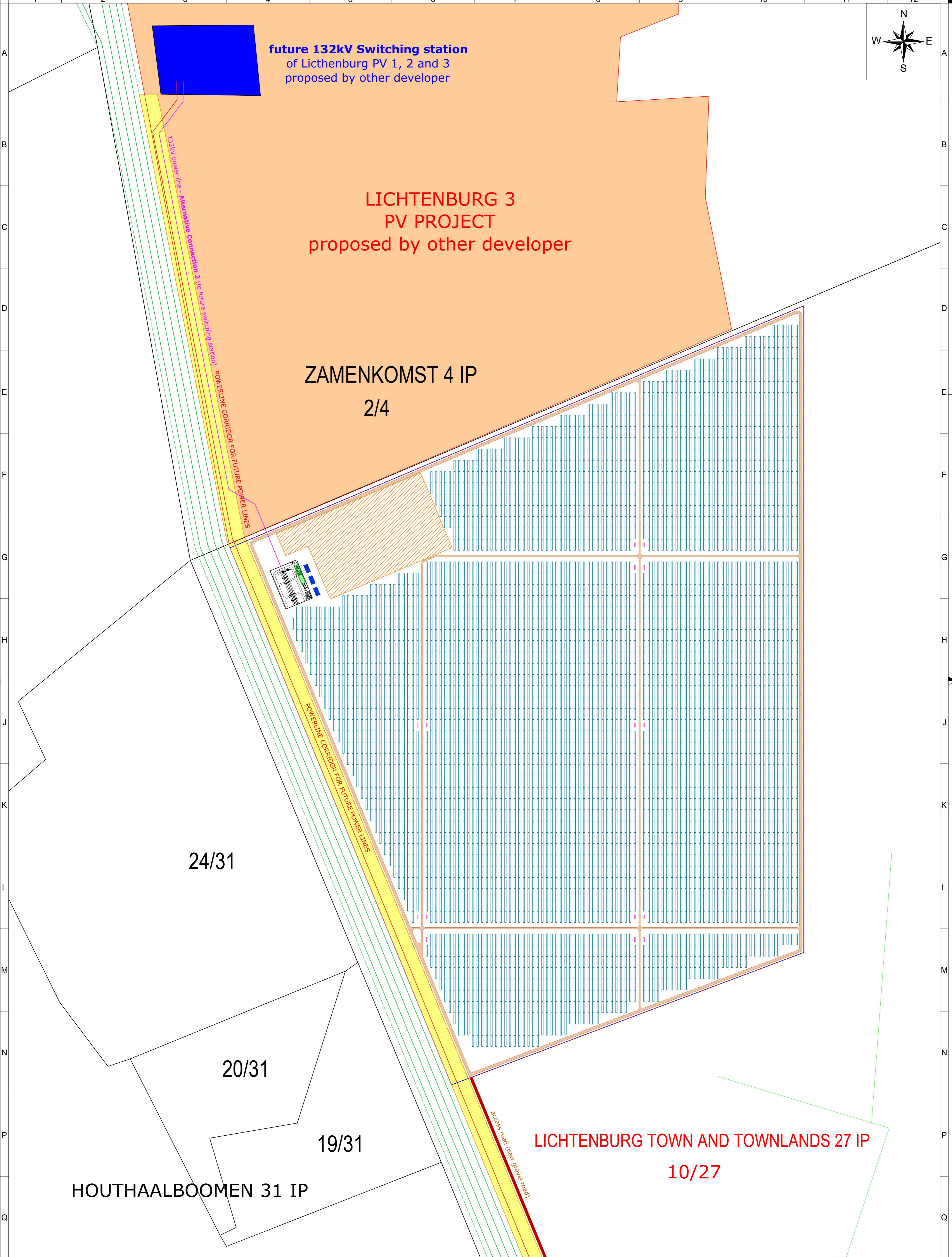

PROJECT SITE / LEASE PORTION
A PART (±271.0 ha) OF PORTION 10
OF THE FARM LICHTENBURG TOWN AND
TOWNLANDS 27 IP
Ditsobotla Local Municipality
Ngaka Modiri Molema District Municipality North
West province
LPI Code TOIP0000000002700010

FOOTPRINT (FENCED AREA)
±261 ha

- On-site 33kV/132kV step-up substation and 132kV switching station with control buildings
- Medium voltage stations
- 132 kV overhead power line to the switching station of other PV projects
Length: 1.6 km
- Medium voltage power lines
- ESKOM's 88 kV overhead powerlines

- Battery Energy Storage System (BESS)
165 MW/990 MVA (6-hour storage)
Footprint: up to 15 ha
- Warehouses - Workshops
- Internal roads
- PV arrays

Project name
LICHTENBURG SOLAR PARK

MATRIGENIX (Pty) Ltd
Registration No: 2011/115691/07

00	June 2022	Scoping Report - Annexure A
Revision	Date	Description
Title Layout Plan up to 165 MW Layout & Connection Alternative 2		
Scale	1:4000	Size A1
Sheet	1 / 1	Id. LCHSP_02_r0