

REMAINDER OF THE FARM MOHLABAS LOCATION 567 LT

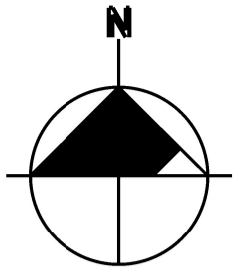

Scale:1:4000

2/567

6/567

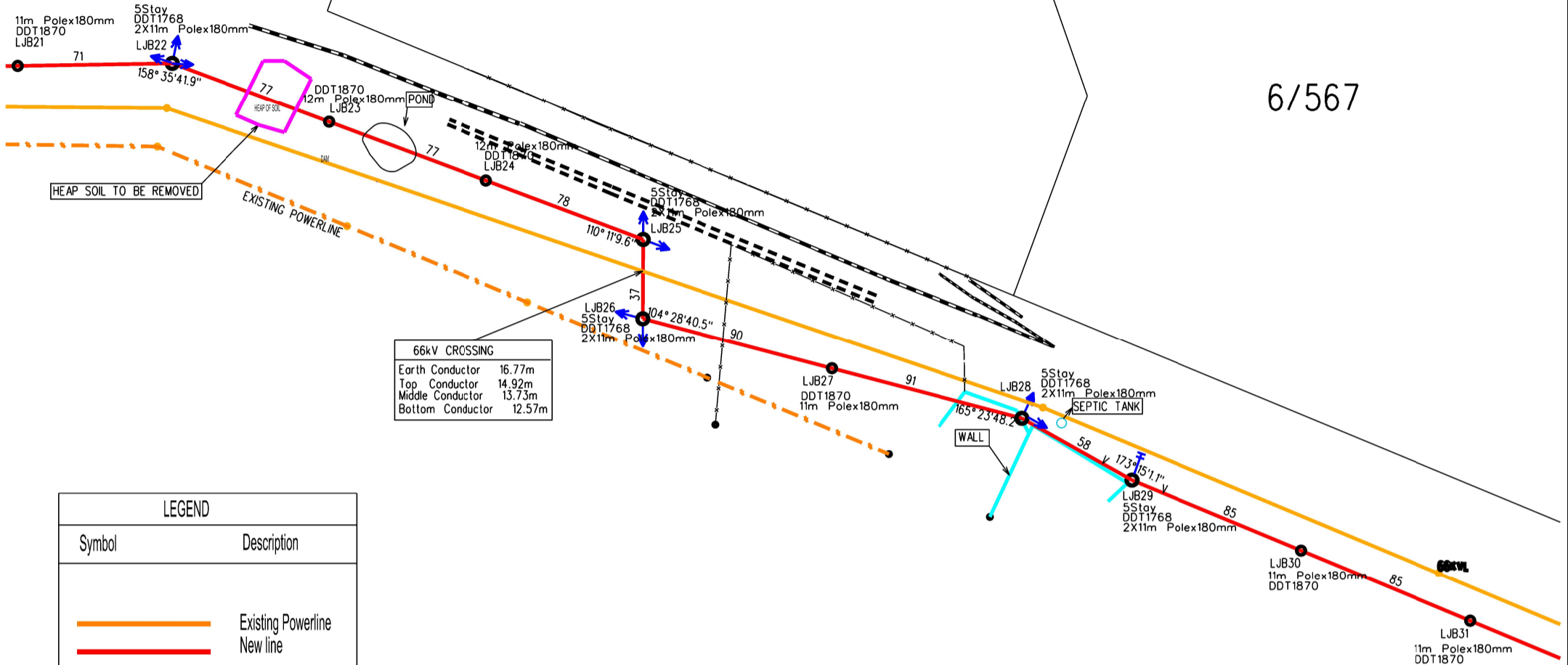

66kV CROSSING	
Earth Conductor	16.77m
Top Conductor	14.92m
Middle Conductor	13.73m
Bottom Conductor	12.57m

LEGEND	
Symbol	Description
	Existing Powerline
	New line
	Track
	Wall
	Fence
	Railway Line
	Cadastral
	Existing Pole
	bend/toff
	Angle xx°xx'xx"
	TRF
	Bend
	Strut
	Stay

REMAINDER OF THE FARM MOHLABAS LOCATION 567 LT

LETABA - JULESBURG 22KV

NOTE: PEGS on site indicate structure position.

	Strain Poles(Red)
	Suspension Pole, Line Pegs (White)
	Stay Wire/ Strut Pole(Blue)

PG3/PG4

Accepted as correct by Surveyor S HIRACHUND 076 143 0180

REV.0 21/01/2022

TRFR Size:		Project no:	
Toff Pole no:	LJB1	Project Name:	LETABA - JULESBURG LOADSHIFTING
Toff:	LAT: 23° 52' 52", LONG: 30° 16' 51"	Feeder name:	LETABA - JULESBURG 22KV
Tee off angle:	85° 58' 47"	CNC:	TZANEEN
Total Length of line:	3.5 km	Surveyor:	BFL LAND DEVELOPMENT SERVICES
Portion of map:	2330 CD	Geographic mapping:	2330 CD S

NOTE: No protected trees/plants may be cut/trimmed/removed unless the applicable tree permit is issued and handed to the construction contractor.

NOTE: Check for special conditions on Way leave



COORDINATE SYSTEM:L084/29