

S_200 - Foundation Layout

1 : 100

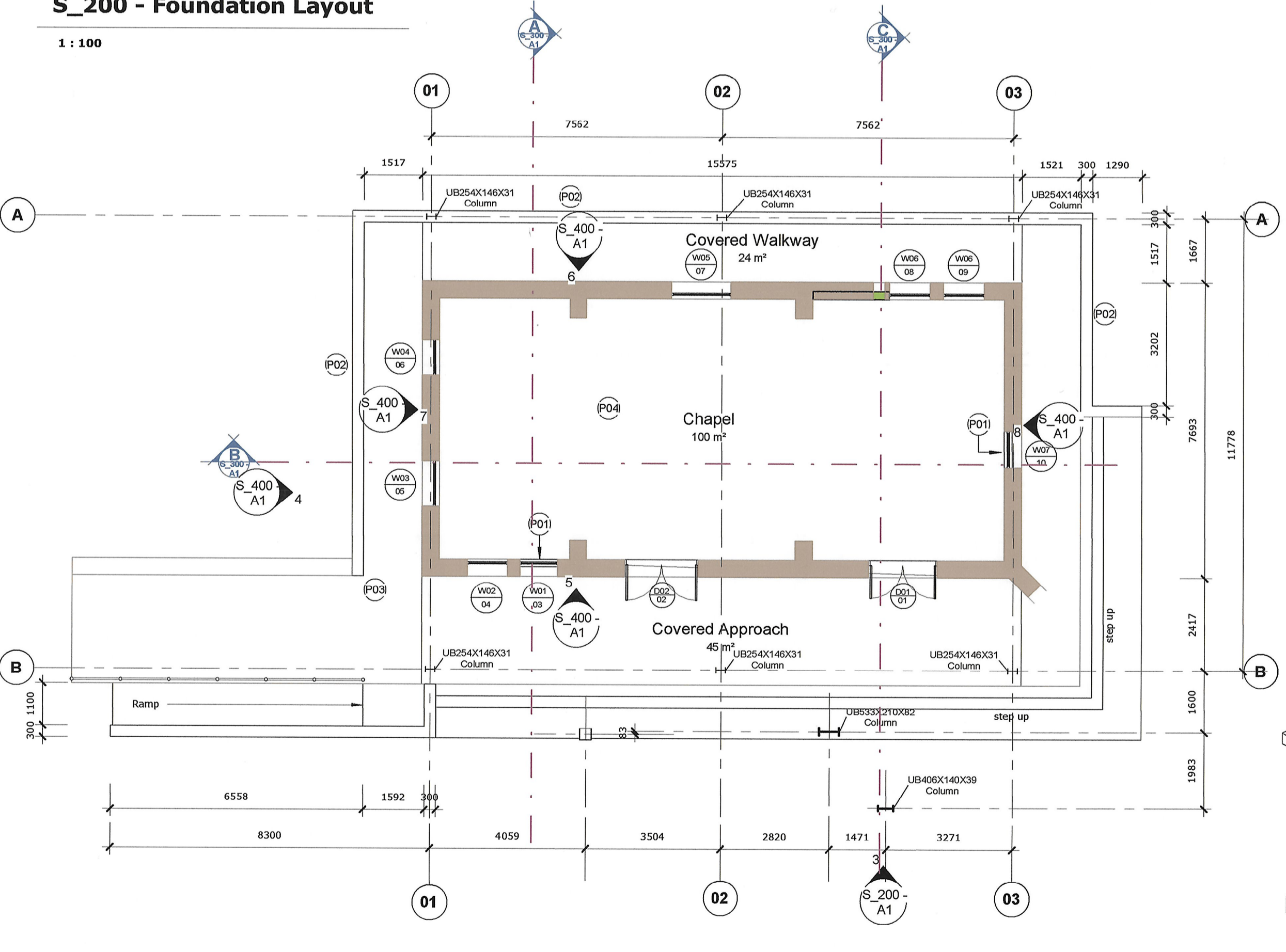

C_200 - Ground Floor Layout

1 : 100

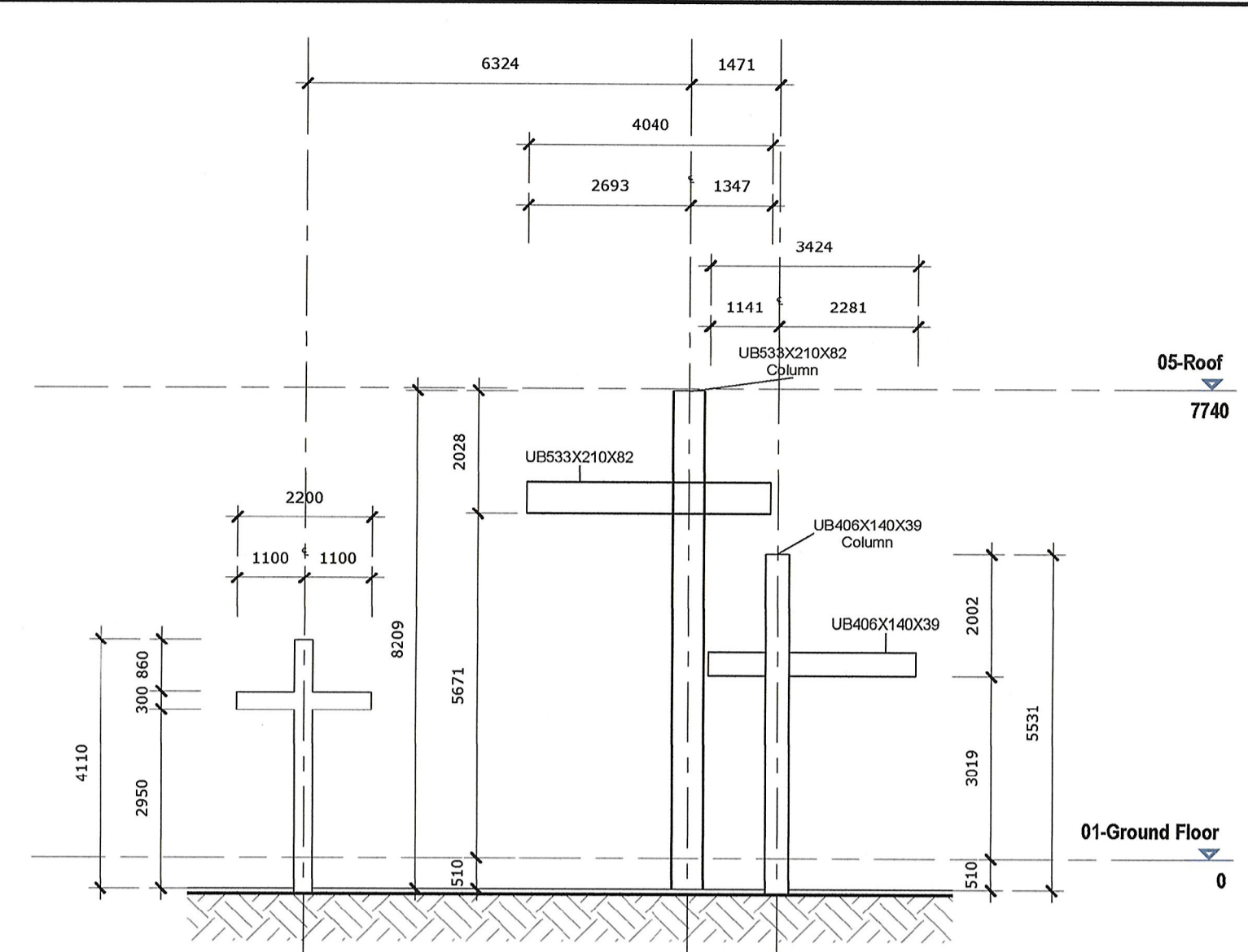

S_200 - Cross Elevation

1 : 100

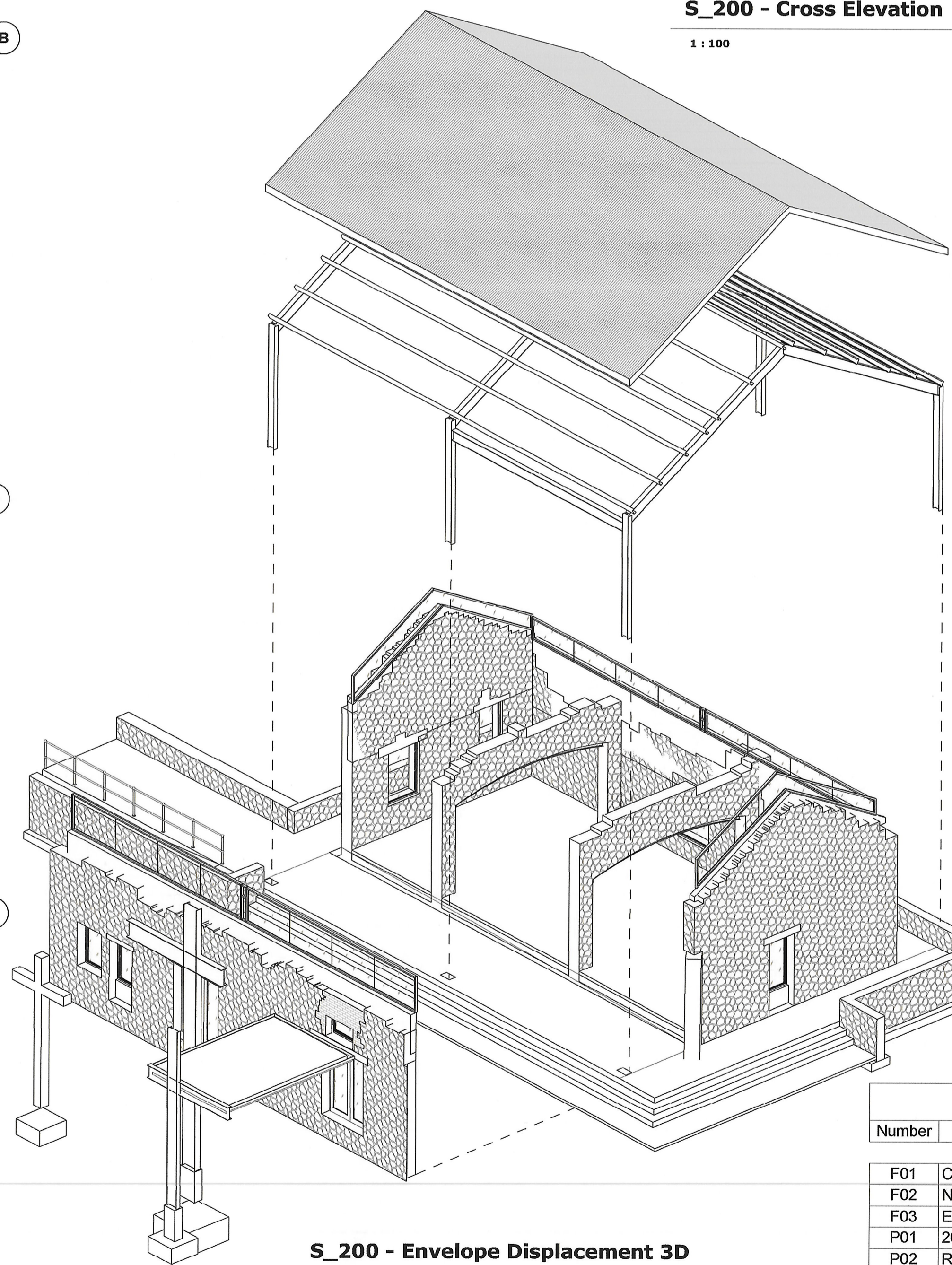

S_200 - Envelope Displacement 3D

NOTES

GENERAL NOTES:

- All material to comply with SABS standards and installed in accordance to manufacturers specification.
- All material to be SABS approved and installed in accordance to manufacturers specification.
- *All work to comply with Local Bylaws and Regulations.
- *All Levels and Dimensions to be checked on site before commencement of work.
- *Final Levels, height of plinth, depth of excavation to be determined on site.
- *375 Micron DPC to ALL external walls.
- *Fines to be as per Architects/Engineers specification and any changes to be approved prior to work being executed.
- *Links to all door and window openings (general rule of 220mm min lip on both sides).
- *All chimneys to be min 1000mm above roof to comply with SANS 10400 Part V9.

SOIL POISONING:

As per SANS 10400-Part F5 (Soil Poisoning)

All material to be SABS approved and installed in accordance to manufacturers specification.

Unless otherwise indicated (and or part of rational design) the following will apply:

- *Poison the soil against the inside of foundation walls and under floors with "Chloronine" (SABS 1165) soil insecticide according to SABS 0124.
- *Not when soil is excessively wet.
- *Treat foundation trench bottoms before casting.
- *Treat full length of pipe and cable trenches inside the building for a distance of 3m outside the building.
- *Take necessary health precautions on site during application.

Provide written guarantee for ten (10) years for the effectiveness of treatment and hand over to Architect or Principal Agent.

DRAINAGE:

Design & Installation to comply with SANS 10400-Part P (Drainage)

All material, fittings and appliances to be SABS approved and installed in accordance to manufacturers specification.

Unless otherwise indicated (and or part of rational design) the following will apply:

- Min fall to Soil Pipes 1:40 (110dia) & 1:80 (150dia).
- Soil Pipes (110dia or 150dia) to be uPvc pipes.
- Waste Pipes to be 50dia uPvc pipes.
- Soil Pipes below buildings and or closer than 1000mm from foundation to be cast in concrete.
- Min Invert level (IL) of soil pipe at head of drain to be 450mm (if a Gully) or 650mm (without Gully).
- Inspection Eyes to be provided at all bends and junctions along sewer and must be suitably marked at ground level.
- No bends or junctions permitted in Soil Pipes below floor slabs. Soil Pipes below floor slabs to be adequately protected against load.
- All Waste Pipes to be fully accessible along their entire length.
- All first floor appliances to be supplied and fitted with anti-vacuum traps.
- Provide waste fittings with reset traps.
- All 2WVW to comply with SABS 0400 Part PP20.
- All Vent Valves to be installed on 110dia uPvc Pipes, pipes for 2WVW to be max 1500mm high.
- All drainage branches longer than 3000mm to be supplied with necessary access eyes. Geyers to be in accordance to SABS 0254.

GLAZING:

Design & Installation to comply with SANS 10400-Part N (Glazing) & SABS 0137

All material and fittings to be SABS approved and installed in accordance to manufacturers specification.

Surface size:	Min glass thickness:
0 - 0,75sqm	3mm
0,75sqm - 1,5sqm	4mm
1,5sqm - 2,1sqm	5mm
2,1sqm and over	6mm

FOUNDATIONS:

Design & Installation to comply with SANS 10400-Part H (Foundations)

All material and fittings to be SABS approved and installed in accordance to manufacturers specification.

Foundation System and material mix as designed by STRUCTURAL ENGINEER (Ref. SANS 10400-A Appointment)

Minimum standards:

- *Concrete strip foundations Min 600mm x 230mm or as indicated.
- *Bottom of foundation to be min 300mm below ground level.

FLOORS:

Design & Installation to comply with SANS 10400-Part J (Floors)

All material and fittings to be SABS approved and installed in accordance to manufacturers specification.

Structural Floor System and material mix as designed by STRUCTURAL ENGINEER (Ref. SANS 10400-A Appointment)

Minimum standards:

- *Top of concrete floor slab to be min 170mm above natural ground level (NGL).
- *Min 60mm Rk concrete surface bed and as indicated.
- *250micron USB Green DPC with overlaps of 150mm min on backfill in compacted layers of max 150mm at optimum moisture content of 95% MGD ASTHO density.

ROOF:

Design & Installation to comply with SANS 10400-Part L (Roof)

All material and fittings to be SABS approved and installed in accordance to manufacturers specification.

Structural Roof System and members as designed by STRUCTURAL ENGINEER (Ref. SANS 10400-A Appointment)

*Design and installation certificate to be issued to Architect/Principal Agent after completion of installation.

*Material & installation in accordance with SANS 10400-XA

STAIRS:

Design & Installation to comply with SANS 10400-Part M (Stairs)

All material and fittings to be SABS approved and installed in accordance to manufacturers specification.

Structural System and members as designed by STRUCTURAL ENGINEER (Ref. SANS 10400-A Appointment)

- *250mm Min Tread.
- *200mm Max Riser.
- *Handrail: 1000mm max high (850mm min) measured from pitch line vertical to top rail, 100mm max opening between members.
- *Minimum headroom: 2100mm measured from pitch line of stair.
- *Stair landing to have length of not less than 900mm and a width of not less than such flights.

Plan Notes

Number	Text Note
F01	Column Base to Eng Detail
F02	New Strip Foundation for Rock Retaining Wall
F03	Existing Structure
P01	200mm Wide Concrete Wall (Height as per Section)
P02	Rock Retaining Wall with Geo Drain System @ Foundation Level
P03	Demolish Ptn of Wall. Tie new retaining Wall to Existing
P04	New 100mm Concrete slab cast over existing floor (remove all loose material and ensure dust free surface. Provide dry-bonding with ABE jointing compound prior to casting of new floor). Steel trough finish.

COPYRIGHT NOTICE

COPYRIGHT © 2020-LAD Architects

Copyright subsists in this drawing. The person or entity whose name appears in the title block of this drawing, is hereby granted a non-exclusive license to use, display, print and/or reproduce this drawing to the extent necessary to carry out and complete the project described in the title block of this drawing. The license in respect of the copyright is expressly limited as aforesaid and the person and/or entity referred to above shall not be entitled to grant sub-licenses in respect of the copyright in this drawing to any other entity. This licence confers no ownership rights in the copyright vesting in the drawing and this drawing and the copyright subsisting therein will, at all times, remain the property of LAD cc. Any unauthorized reproduction, publication, transmission, adaptation and/or inclusion of this drawing in a cinematograph film or television broadcast is an act of copyright infringement which will render the doer of the act liable for civil law copyright infringement and may in certain circumstances render the doer liable for criminal law copyright infringement.

GENERAL NOTES:

1. Check all measurements, levels and details on site before commencement with work.
2. Refer any discrepancies to architect.
3. All work to be done in accordance with SABS 10400.
4. Nothing to be scaled from drawings, request measurements from architect.
5. Architects & Engineers drawings to be read together.
6. Drawing to be used for intention as mentioned in Drawing description.

Amendment Schedule

Issue	Number	Date	Description
A	221001		Issued for information
B	221107		Issued for information
C	221115		Council Submission



LAD Architects

Profile Building
23 Corridor Crescent
Route N4 Business Park
Ben Fleur Ext 11

P.O. Box 543, Emalshani, 1935
Tel: 013-656 6321 / 653 6305
Fax: 013-653 6322 / 0866 024 012
e-mail: admin@lad-arch.com

P.J. Labuschagne, SACAP Pr.Arch 6254

PROJECT

Proposed Alterations & Additions to Taung Skull Heritage Site: (SDP) BLDNG 5: Chapel

ADDRESS

Taung Skull

CLIENT

North West Department: Economic Development, Environment, Conservation and Tourism

DRAWING DESCRIPTION	DRAWING NUMBER
Layout Plans	S_200 - A1

DESIGN	COUNCIL	CONSTRUCTION
DRAWN BY: S. Scriven	ISSUE: 221107	DATE: 221107