

From the desk of Jo-Anne Thomas
E-mail: joanne@savannahSA.com



04 March 2014

Department of Water Affairs
Private Bag X5912
Upington
8800

Attention: Jenna Lavin

Dear Jenna,

PROPOSED SOLIS CONCENTRATED SOLAR POWER (CSP) PLANT AND ASSOCIATED INFRASTRUCTURE ON A SITE NEAR UPINGTON, NORTHERN CAPE PROVINCE: WATER SUPPLY PIPELINE

Solis Power 1 (Pty) Ltd is proposing the construction and operation of the 125MW Solis Concentrated Solar (CSP) facility and associated infrastructure on the Farm Van Rooys Vlei, near Upington in the Northern Cape. An Environmental Impact Assessment (EIA) process has been undertaken for the proposed project (DEA Ref No.: 14/12/16/3/3/3/82) and an Environmental Authorisation was issued on 18 July 2013 (see attached in Appendix A).

Water for the construction and operational phase of the CSP facility will be sourced from the //Khara Hais Municipality. This water will be supplied via a water pipeline from the reservoir in Upington Industrial (Upindustria) area to the facility. Two alternative routes have been identified for this water supply pipeline (refer to attached map): **route 1** along the railway line (approximately 3m outside the servitude) and **route 2** along the N10 (within the road reserve for most of the route). The preferred route is that following the N10.

Specifications of the pipeline are as follows:

- Diameter: 125mm uPVC pipeline
- Installed underground at an average depth of 1.1 m, with a cover of ± 0.85 m

Due to the capacity and size of the pipeline, the construction thereof along the preferred alternative route does not trigger the need to obtain Environmental Authorisation in terms of the EIA Regulations promulgated under NEMA. However, there may be a need to undertake an archaeological impact assessment in terms of the requirements of the National Heritage Resources Act (as the pipeline exceeds 300m in length).

UNIT 10, BUILDING 2, S WOODLANDS DRIVE OFFICE PARK, CNR. WOODLANDS DRIVE & WESTERN SERVICE ROAD, WOODMEAD, JOHANNESBURG
PO BOX 148, SUNNINGHILL, 2157, GAUTENG
TEL: +27 (0)11 656 3237 • FAX: +27 (0)86 684 0547 • E-MAIL: INFO@SAVANNAHSA.COM
WWW.SAVANNAHSA.COM

DIRECTORS: KM JODAS • J THOMAS • M MATSABU
COMPANY REGISTRATION NO.: 2006/000127/07
VAT REGISTRATION NO.: 4780226736

Please advise regarding the requirement for an archaeological impact assessment for this pipeline.

Please contact me with any queries in this regard.

Kind regards

Jo-Anne Thomas

**APPENDIX A:
MAP INDICATING TWO PIPELINE ROUTE
OPTIONS**

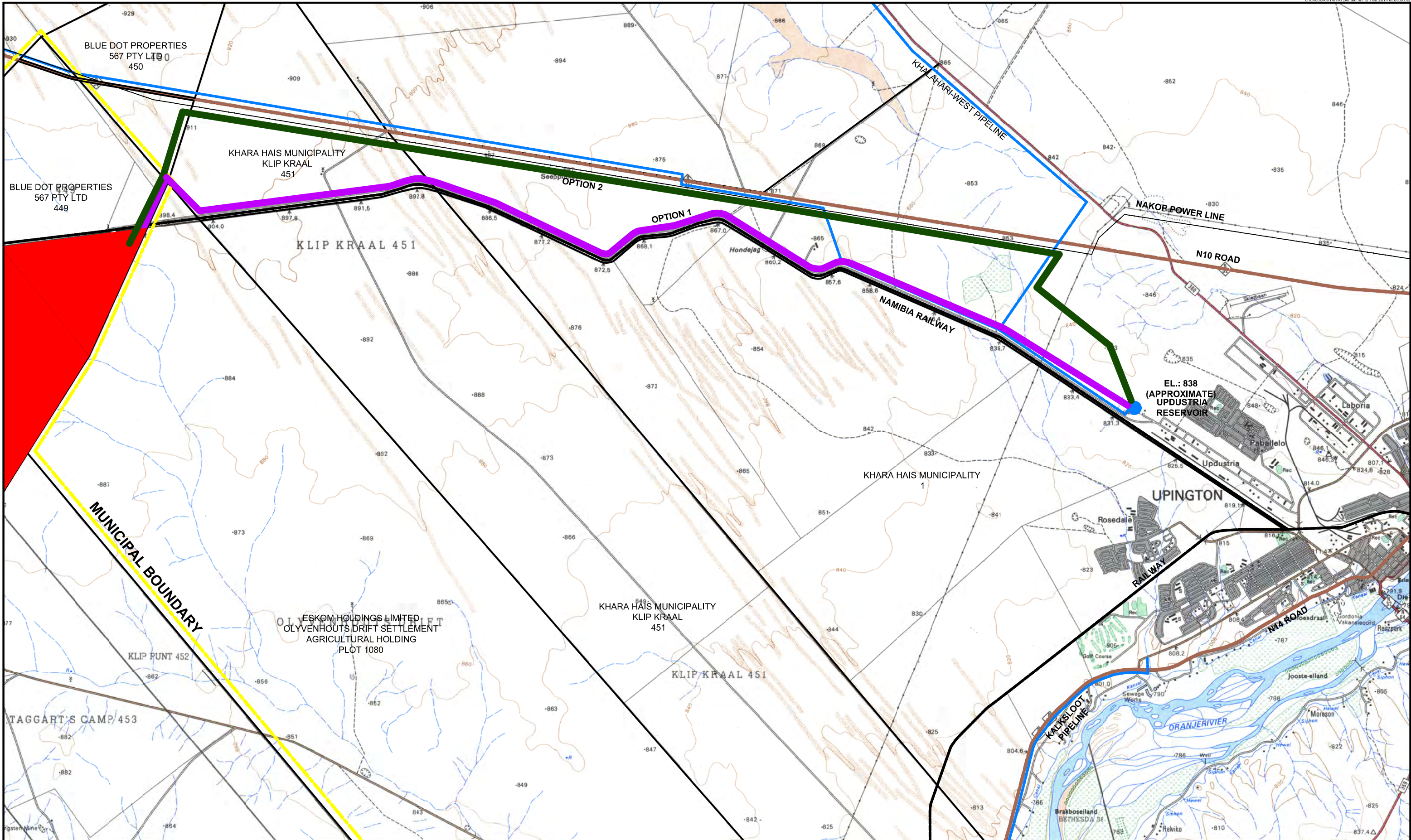

NOTE / LEGENDS	DRAWING SIZE: A1	REVISION: C
ISSUE DATE: 23 Jan 2014		
X PRELIMINARY		
INFO ONLY		
FOR TENDER		
FOR CONSTRUCTION		
AS-BUILT		

APPROVED BY COUNCIL / CLIENT	DATE	INITIAL	No./CODE	REVISION DESCRIPTION
	22/01/2014	GC	B	CHANGE OF PIPE ROUTE OPTIONS
	23/01/2014	GC	C	CHANGE OF PIPE ROUTE OPTIONS

CITY ENGINEER / CLIENT	REG. NO.	DATE

BrightSource
WEBBER WENTZEL
 in alliance with **Linklaters**

bvi
 CONSULTING ENGINEERS
 Civil, Structural & Electrical Engineers, Environmental & Project Management

PROVINCE	OFFICE	E-MAIL
Free State	Phelisa (012) 348-0099	phelisa@bvi.co.za
Free State	Blombosfontein (051) 442-2137	bfontein@bvi.co.za
Free State	Wolfsburg (052) 352-3099	wolfsburg@bvi.co.za
Northern Cape	Upington (054) 337-6000	upington@bvi.co.za
Northern Cape	Springbok (051) 710-9990	springbok@bvi.co.za
Northern Cape	Carletonville (011) 266-4383	carletonville@bvi.co.za
Eastern Cape	Engenungweni (025) 788-0250	engengweni@bvi.co.za
Eastern Cape	Port Elizabeth (041) 373-4343	portelizabeth@bvi.co.za
Western Cape	Cape Town (021) 527-7000	capetown@bvi.co.za

PROJECT	20010016	20/01/2014
PROJECT SOLIS	REG. NO.	DATE
DRAWING TITLE		
PROPOSED BULK WATER SUPPLY OPTIONS		

APPROVED BY BVI	20010016	20/01/2014
ENGINEER/TECHNOLOGIST	REG. NO.	DATE
SCALE	1:30 000	DRAWN G. Coetzee
DESIGNED	E. Myburgh	CHECKED M. Pretorius
PLAN NUMBER	REVISION NO.	DATE SAVED
U10408C-001-01	C	12 Feb 2014

DRAWING NOT PRINTED TO SCALE REDUCED FROM A1 TO A3

U10408C-001-01-C.dwg