

Reference	CAD-Line Survey-LOU
Effective Date	15/10/2015
Revision	01

Description	Quantity
Shrubs > 40 cm	0%
Trees Trim	1
Trees to Cut	0%
Bushclearing required (m)	0%

MAK358542196

Mopani District Municipality Metz

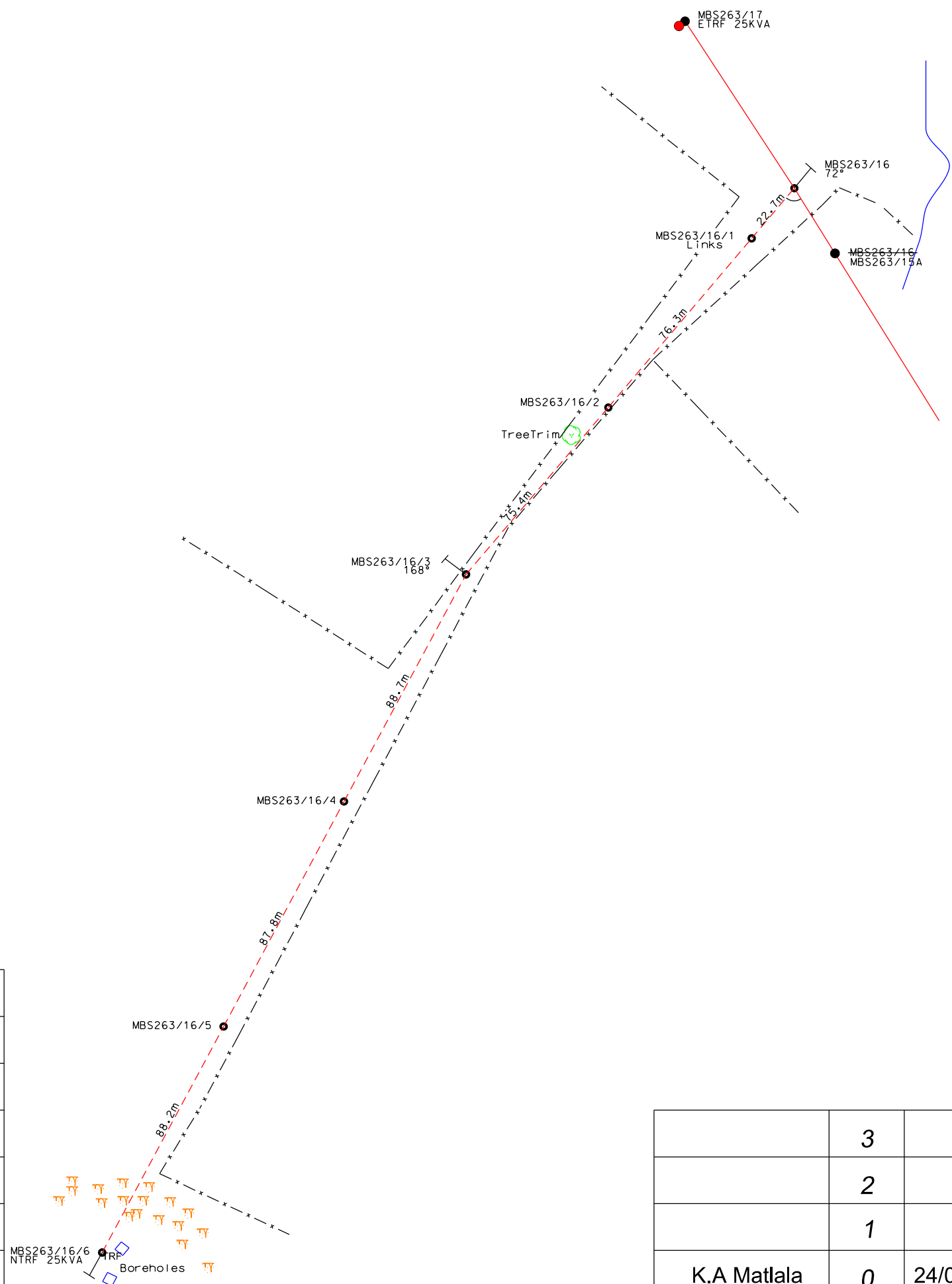

LEGEND

	Exis. MV Line
	New MV Line
	Exis. LV Line
	Donga
	River
	Boreholes

	3	
	2	
	1	
K.A Matlala	0	24/08/2020
SURVEYOR	REV	SURVEY DATE

FEEDER: Bismack 22kV
PROJECT NO: MAK358542196
CONDUCTOR: Fox 3Ph
LENGTH OF LINE: 439m
SURVEYOR: KA Matlala
DRAUGHTSPERSON: KA Matlala

CUSTOMER: Mopani District Municipality
PROPERTY: Metz 75 KT Metz Village
CONTACT DETAILS: 015 230 1546
SCALE:
PAGE: [1] of [1]

THIS DRAWING IS THE PROPERTY OF ESKOM
Disclaimer: Eskom is not responsible for any errors displayed on this drawing