

Reference	CAD-Line Survey-LOU
Effective Date	15/10/2015
Revision	01

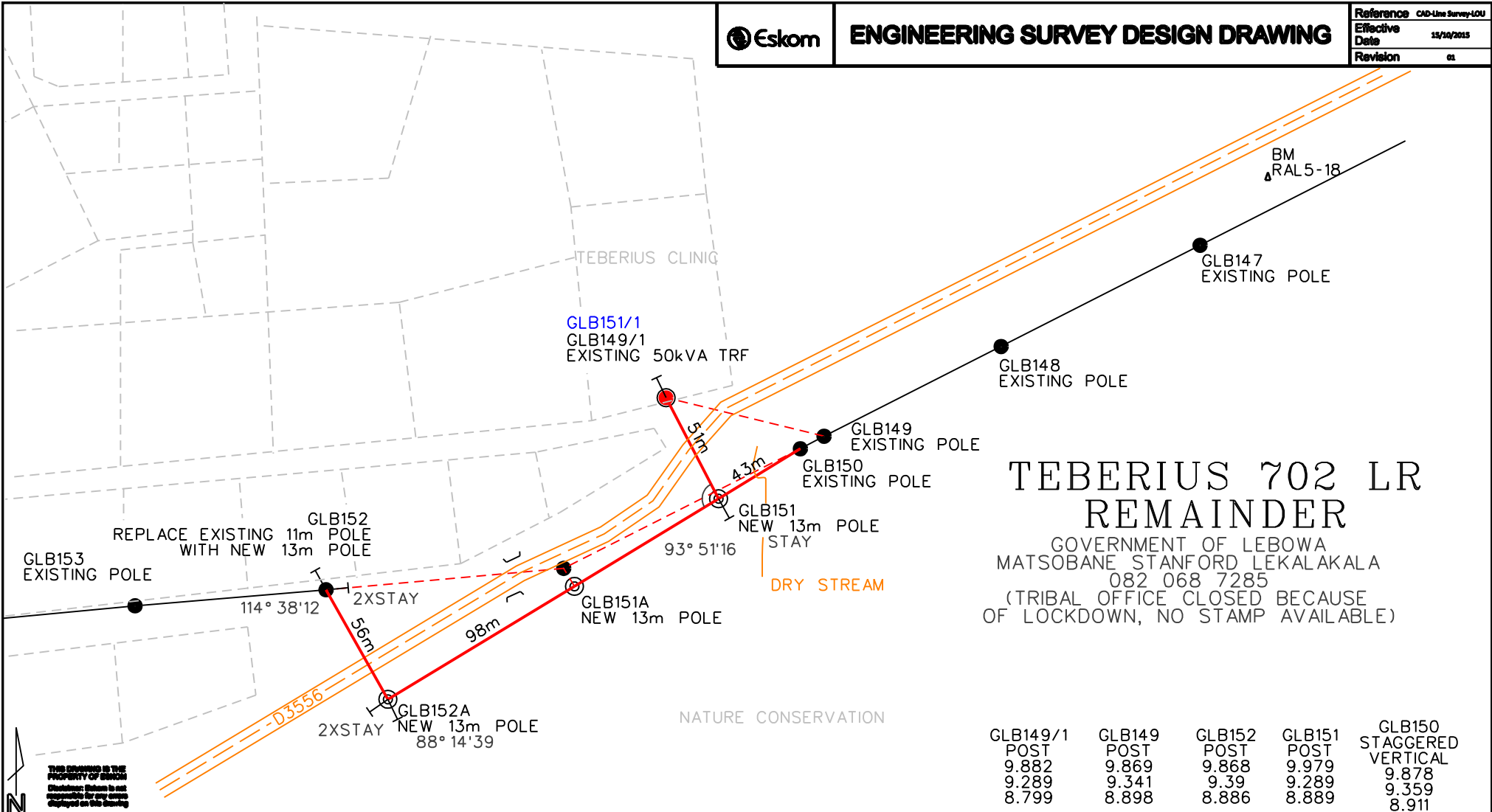

GLB149/1	GLB149	GLB152	GLB151	GLB150
POST	POST	POST	POST	STAGGERED VERTICAL
9.882	9.869	9.868	9.979	9.878
9.289	9.341	9.39	9.289	9.359
8.799	8.898	8.886	8.889	8.911

THIS DRAWING IS THE PROPERTY OF ESCOM  
Distances shown to not responsible for any errors displayed on this drawing

**LEGEND**

- Existing MV Structure
- ⊙ New MV Structure Bend/T Off
- New TRF
- Existing TRF
- New MV Structure - Intermediate
- Existing MV
- New MV
- - - Fence/Stand
- Telkom
- Road
- Water Pipeline
- Protected Tree

<b>PROJECT NO:</b>	MGL326121462
<b>FEEDER:</b>	GILEAD / LEBELO 22kV
<b>CONDUCTOR:</b>	FOX
<b>LENGTH OF LINE:</b>	0.324 km
<b>SURVEYOR:</b>	LJCC ENGINEERING SURVEYS
<b>DRAUGHTSPERSON:</b>	A NEETHLING (082 448 2641)
<b>CUSTOMER:</b>	MR KELVIN BULANGA
<b>PROPERTY:</b>	TEBERIUS 702 LR REMAINDER
<b>CONTACT DETAILS</b>	(015) 297 7457
<b>SCALE:</b>	1 : 2 500
<b>PAGE:</b>	1 of 2

T-Off Pole:			
VARIOUS INFO ABOVE		<b>3</b>	
		<b>2</b>	
		<b>1</b>	
	L DILEBO 076 788 9856	<b>0</b>	20/05/20
<b>SURVEYOR</b>	<b>REV</b>	<b>SURVEY DATE</b>	

Reference	CAD-Line Survey-10U
Effective Date	15/10/2015
Revision	01

TEBERIUS 702 LR  
PORTION 16

SCHOOL

TRACK

EXISTING GLB140/2  
16kVA TRFR

REPLACE EXISTING  
WITH NEW  
GLB140/1  
11m POLE  
13m POLE

74m

GLB138  
EXISTING POLE  
SWITCH

GLB139  
EXISTING POLE

GLB140  
REPLACE EXISTING 11m POLE  
WITH NEW 13m POLE

GLB141  
EXISTING POLE  
16kVA TRFR

NATURE CONSERVATION

TEBERIUS 702 LR  
REMAINDER

GOVERNMENT OF LEBOWA  
MATSOBANE STANFORD LEKALAKALA  
082 068 7285  
(TRIBAL OFFICE CLOSED BECAUSE  
OF LOCKDOWN, NO STAMP AVAILABLE)



THIS DRAWING IS THE  
PROPERTY OF Eskom  
Unauthorized Release to  
Third Parties is Not  
Permitted

MGL331594480  
MR KELVIN BULANGA  
SHEET 2 OF 2  
1 : 2 500