

SASELAMANI VILLAGE (TSHIKUNDU 262MT)

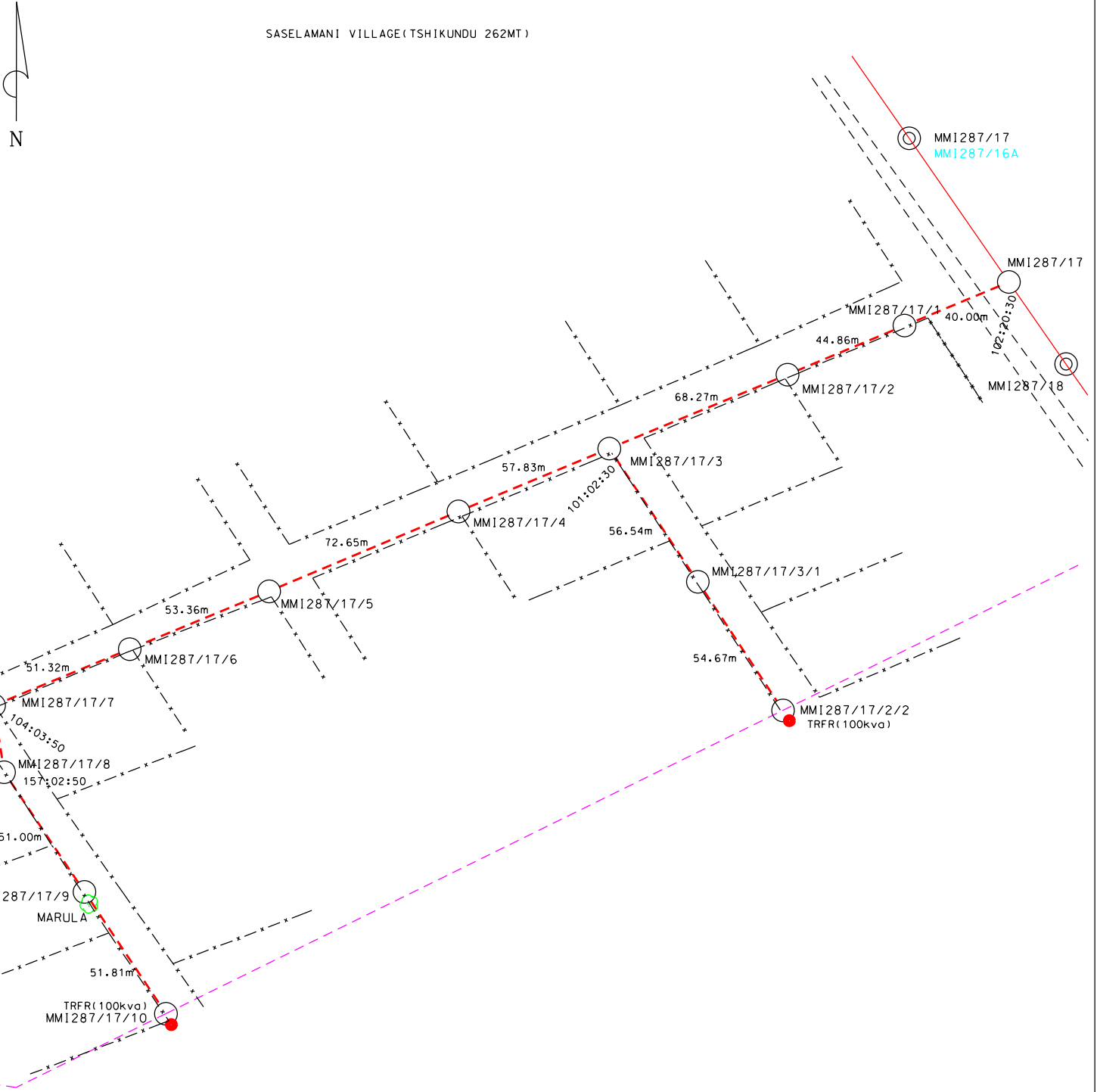

DISTRIBUTION
ENGINEERING
LIMPOPO OPERATING UNIT
LAND DEVELOPMENT



P.O. BOX 3499
POLOKWANE 0700
TEL. (015) 230 1723
FAX. (086) 537 4844
CELL. 082 635 5499

FEEDER: MALAMULELE/MHINGA

CUSTOMER: ESKOM

PROJECT NO: MMI287/17

PROPERTY: TSHIKUNDU 262MT

CONDUCTOR:

LENGTH OF LINE: 0.617 km.

COMPILATION: 2230 DC

SURVEYOR: MOSES

SCALE:

DRAUGHTSPERSON: MOSES

PAGE: ___ OF ___