

FIGTREE / NKOMAZI 132kV Overhead Line

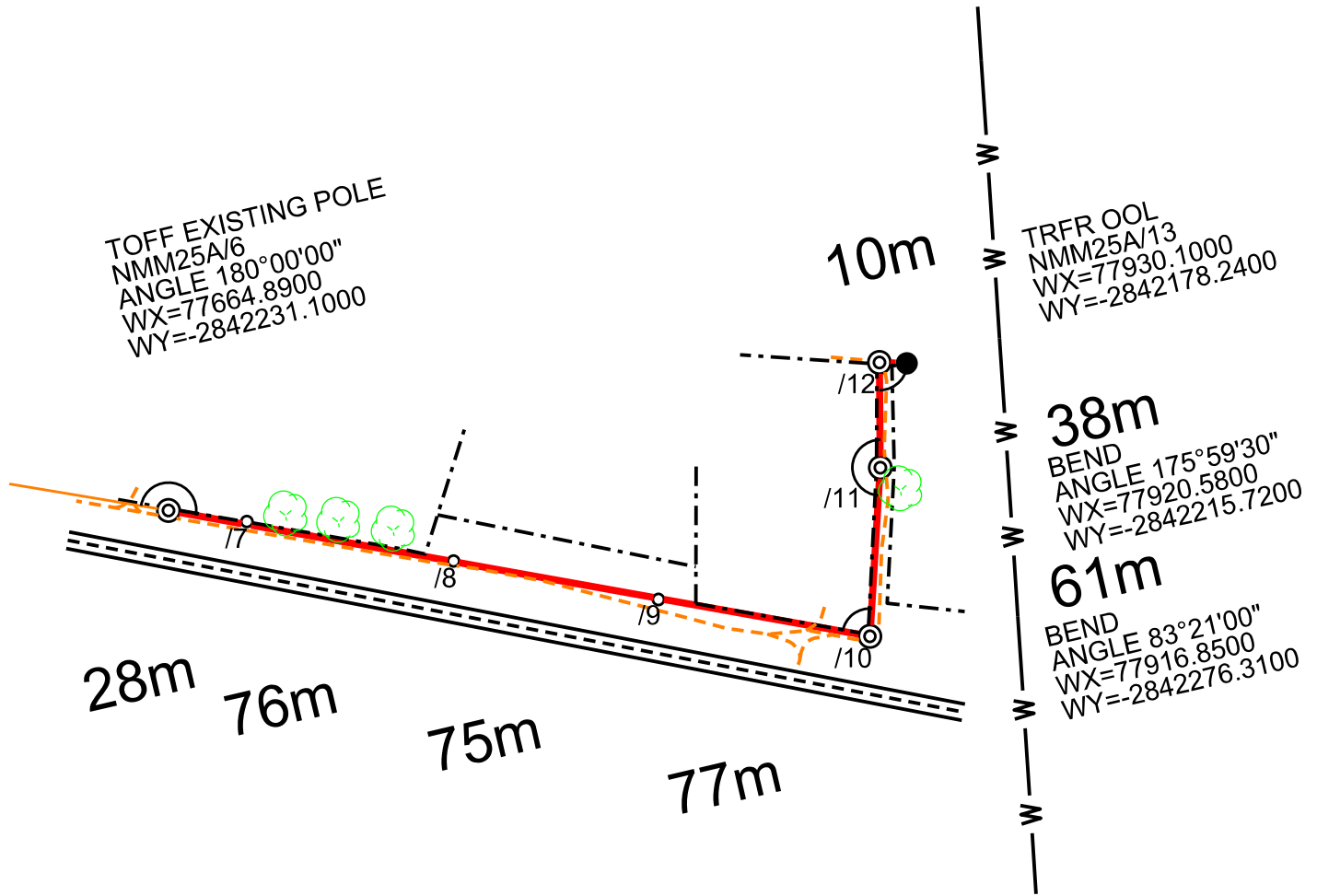

R/E  
MATEBULA 701-JU

Accepted as correct by Surveyor \_\_\_\_\_

REV.0 06/03/2020

TRFR Size:	16kVA 10	Project no:	MMK326330638
Toff Pole no:	NMM25A/6	Project Name:	LUCKY TREASURE MNGOMEZULU
Toff:	LAT: -25° 41' 8.2", LONG: 31° 46' 25.3"	Feeder name:	Mzinti 22kV
Tee off angle:	180°00'00"	CNC:	Kamhlushwa
Total Length of line:	0.375km	Surveyor:	Janro de Lange
Portion of map:	2531DBS	Geographic mapping:	Annelize van Niekerk

**NOTE:**  
No protected trees/plants may be cut/trimmed/removed unless the applicable tree permit is issued and handed to the construction contractor.

**NOTE:** Check for special conditions on Way leave

**COORDINATE SYSTEM: LO84/31**



(Medium Order Accuracy ±10m)