

MOOIPLAATS 185 IT Portion 7

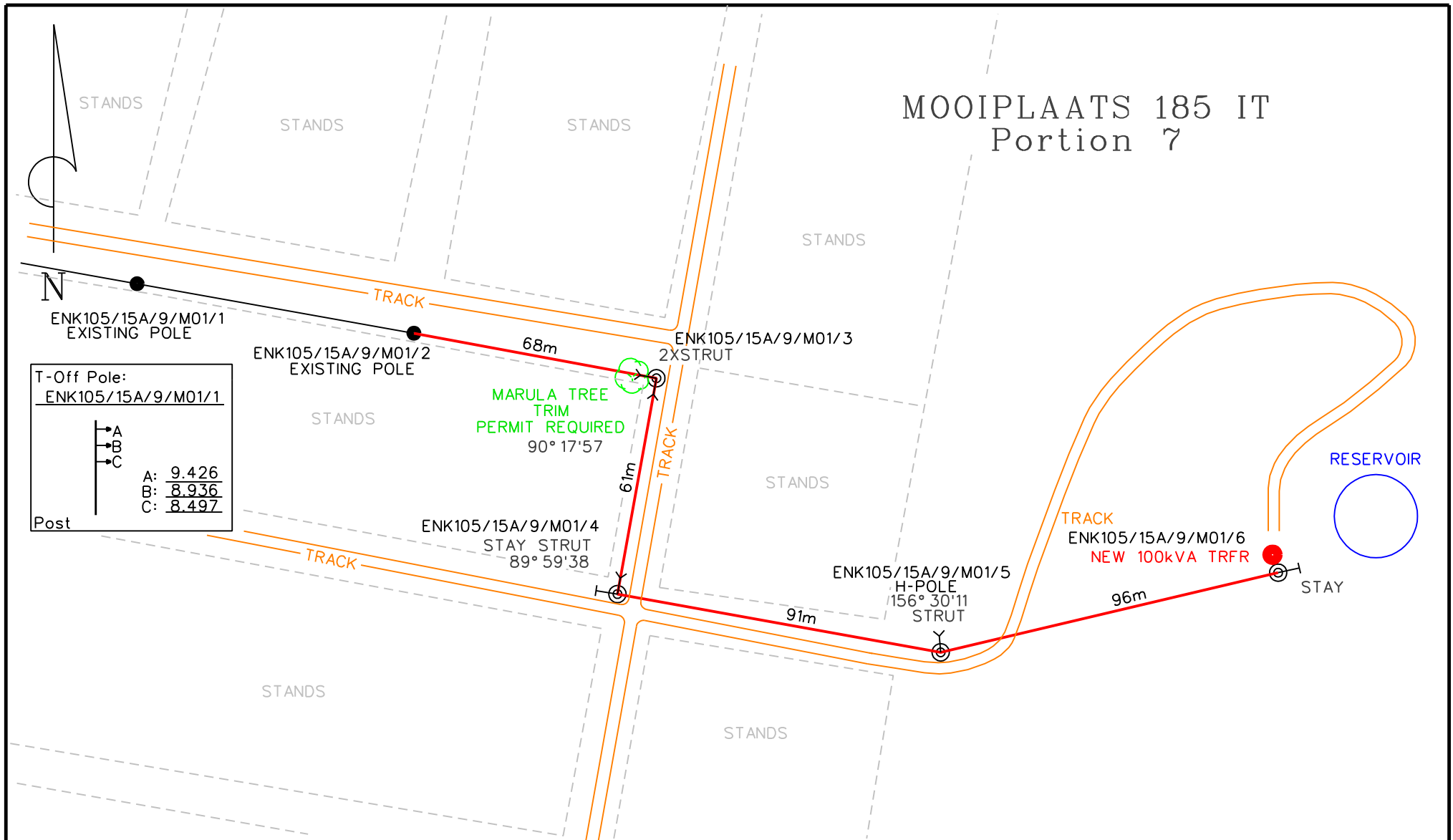

T-Off Pole:
ENK105/15A/9/M01/1

→A	A: 9.426
→B	B: 8.936
→C	C: 8.497

Post

LJCC ENGINEERING SURVEY TEL. 015 297 7457 EMAIL: admin@ljcc.co.za P.O. BOX 12452 BENDOR 0699	FEEDER: MSAULI/OVERBERG 22kV	CUSTOMER: TSEMOKGO ENGINEERING SOLUTIONS
	PROJECT NO: MOOIPLAATS RESERVOIR	PROPERTY: MOOIPLAATS 185 IT
	CONDUCTOR: FOX	PORTION 7
	LENGTH OF LINE: 0.316 km.	COMPILATION: 2630 BB
	SURVEYOR: A NEETHLING	SCALE: 1:1500
	DRAUGHTSPERSON: A NEETHLING	PAGE: 1 OF 1