

**2. UPPER FLOOR PLAN**  
SCALE 1:100

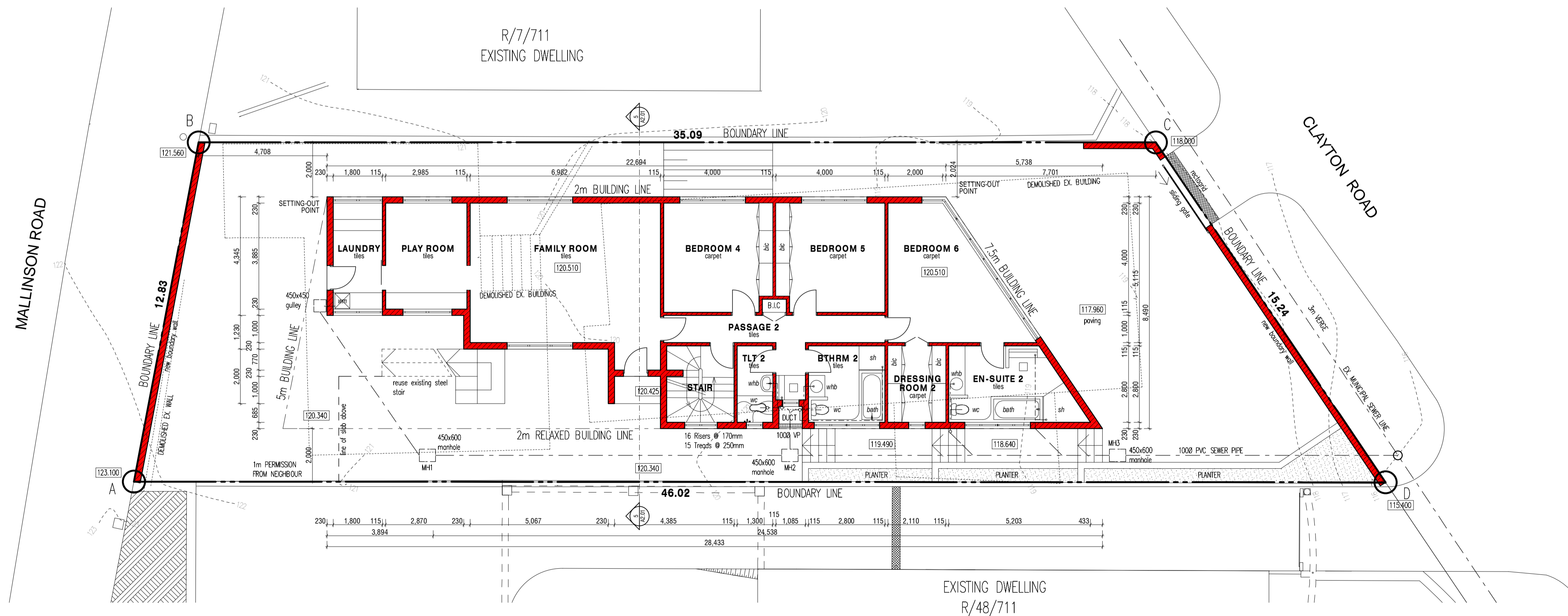

**1. GROUND FLOOR PLAN & SITE PLAN**  
SCALE 1:100

SCHEDULE OF AREAS	
SITE AREA	504.2m <sup>2</sup>
PERMISSIBLE P.A.R	N/A
PERMISSIBLE COVERAGE	252.1m <sup>2</sup>
PROPOSED P.A.R	
GROUND FLOOR	179m <sup>2</sup>
UPPER FLOOR	179m <sup>2</sup>
TOTAL P.A.R	358m <sup>2</sup>
PROPOSED COVERAGE	225m <sup>2</sup>

SIGNATURES	
ARCHITECT	CLIENT
DATE 15 May 2015	DATE 20 May 2015
NO. REVISIONS BY DATE	
ZONING	Special Residential 400
FACILITY CODE	H4
NAME	House Mosam
CADASTRAL REF.	REM of Portion 49 ERF 711 of the farm Brickfield
STREET	147 Clayton Road
CITY	Sydenham
ZIP CODE	4081
PROJECT TITLE	<b>NEW RESIDENTIAL DWELLING FOR FAIYAZ &amp; AMINA MOSAM</b>
DRAWING TITLE	<b>SITE PLAN, GROUND FLOOR PLAN &amp; UPPER FLOOR PLAN</b>
DATE	10 April 2015
DESIGNED BY	GM Khan
DRAWN BY	TK Mingsoma
CHECKED BY	GM Khan
FILE NAME	RES-2015-MOS.pln
DRAWING NO.	REVISION NO.
<b>A1.01</b>	
NO. OF PAGES	SHEET SIZE
<b>1 OF 2</b>	<b>A1</b>
<p><b>GM Khan Architect</b> YAC-433014F56 Suite 203 Lupin House 101 Dr. K. D. Hooley Drive Overport 4091 +27 31 207 3131 +27 31 207 3132 gmkhon@resies.co.za</p>	