

**NORTH WEST PROVINCE
LOCALITY MAP**



LOCALITY MAP: PROPOSED MINING PERMIT ON A CERTAIN PORTION OF THE REMAINING EXTENT OF PORTION 1 OF THE FARM CHRISTIANA TOWN & TOWNLANDS 325 REGISTRATION DIVISION HO, IN CHRISTIANA, NORTH WEST PROVINCE.
TOTAL EXTENT: 4.9 ha

**APPLICANT:
VERONICA DINEO
NTSEKELE TSA**

Signature:

Date:



Adopted from the 1:50 000 Topographical Maps-2725CC

**GPS:
27°54'28.257"S
25°08'14.546"E**

**Datum: D_WGS_1984
Spheroid: WGS_1984
1:25,000**

REFERENCE	
International Boundary and Season.....	
Provincial Boundary.....	
Protected Area.....	
Perennial River.....	
Non-perennial River.....	
Dry Water Course.....	
Dry Pan.....	
Marsh and Vlei.....	
Pipeline (above ground).....	
Water Tower; Reservoir; Water Point.....	
Coastal Rocks.....	
Prominent Rock Outcrop.....	
Friction Sand.....	
Woodland.....	
Cultivated Land.....	
Orchard or Vineyard.....	
Recreation Ground.....	
Row of Trees.....	

REFERENCE	
National Freeway; National Route.....	
Arterial Route.....	
Main Road.....	
Secondary Road; Bench Mark.....	
Other Road; Bridge.....	
Track and Hiking Trail.....	
Railway; Station or Stopping.....	
Other Railway; Tunnel.....	
Embankment; Cutting.....	
Power Line.....	
Build-up Area (High, Low Density).....	
Buildings; Ruin.....	
Post Office; Police Station; Store.....	
Place of Worship; School; Hotel.....	
Fence; Wall.....	
Windpump; Monument.....	
Communication Tower.....	
Mine Dump; Excavation.....	
Trigonometrical Station; Marine Beacon.....	
Lighthouse and Marine Light.....	
Cemetery; Grave.....	

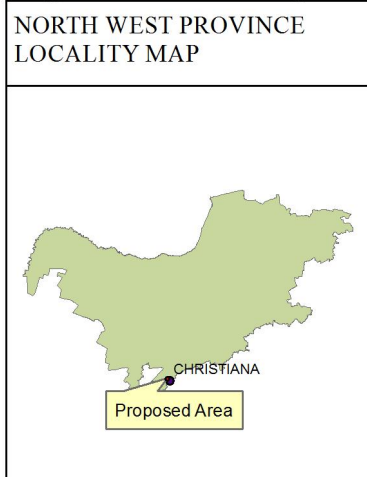
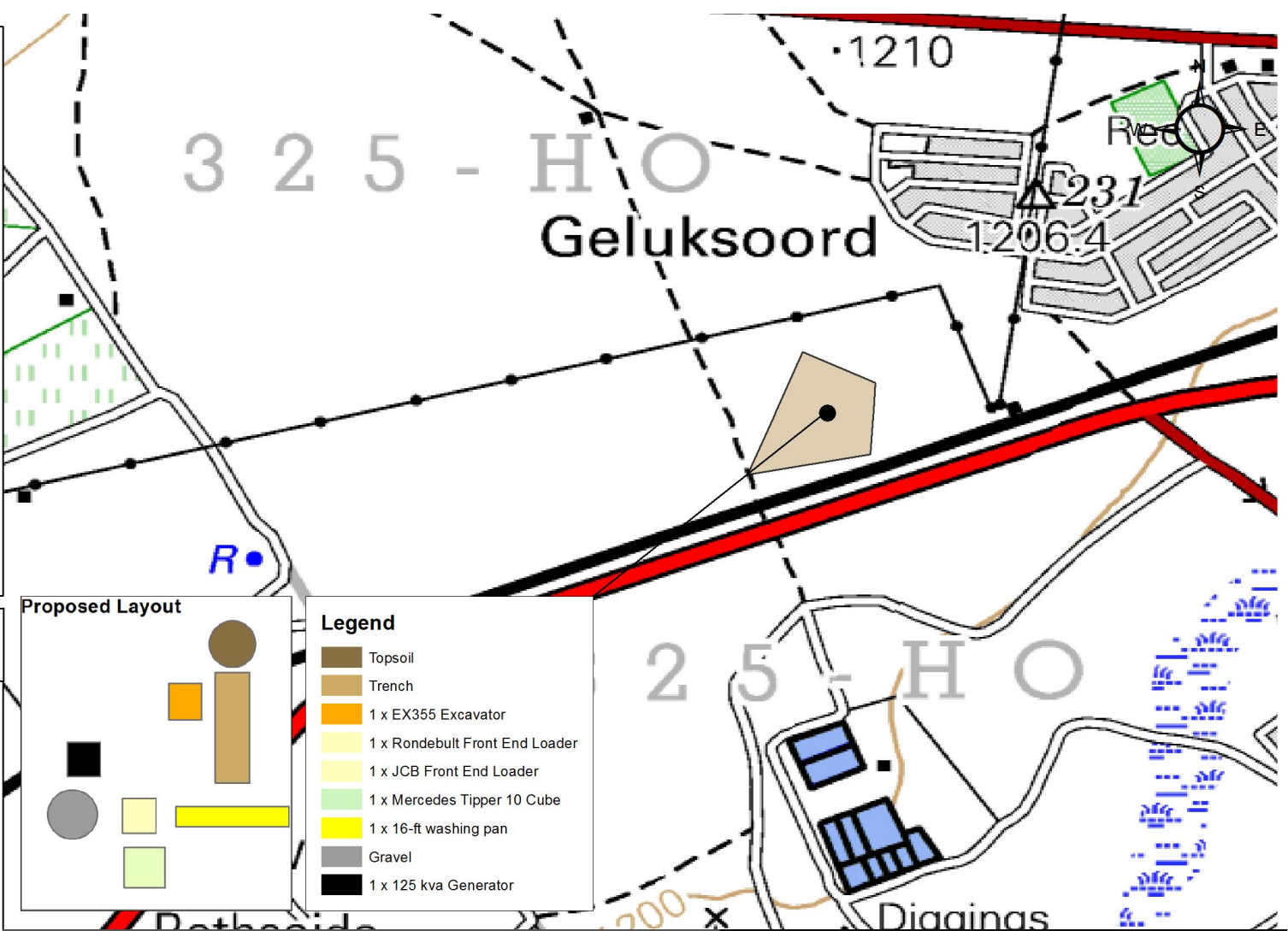

Proposed Layout

Legend

- Topsoil
- Trench
- 1 x EX355 Excavator
- 1 x Rondebult Front End Loader
- 1 x JCB Front End Loader
- 1 x Mercedes Tipper 10 Cube
- 1 x 16-ft washing pan
- Gravel
- 1 x 125 kva Generator

SITE LAYOUT MAP: PROPOSED MINING PERMIT ON A CERTAIN PORTION OF THE REMAINING EXTENT OF PORTION 1 OF THE FARM CHRISTIANA TOWN & TOWNLANDS 325 REGISTRATION DIVISION HO, IN CHRISTIANA, NORTH WEST PROVINCE.
TOTAL EXTENT: 4.9 ha

APPLICANT:
VERONICA DINEO
NTSEKELE TSA

Signature:
Date:

GPS:
 27°54'28.257"S
 25°08'14.546"E

Datum: D_WGS_1984
Spheroid: WGS_1984
1:10,000



Adopted from the 1:50 000 Topographical Maps-2725CC

REFERENCE	
International Boundary and Beacon.....	
Provincial Boundary.....	
Protected Area.....	
Perennial River.....	
Non-perennial River.....	
Dry Water Course.....	
Dry Pan.....	
Marsh and Vlei.....	
Pipeline (above ground).....	
Water Tower; Reservoir; Water Point.....	
Coastal Rocks.....	
Prominent Rock Outcrop.....	
Friction Sand.....	
Woodland.....	
Cultivated Land.....	
Orchard or Vineyard.....	
Recreation Ground.....	
Row of Trees.....	

REFERENCE	
National Freeway; National Route.....	
Arterial Route.....	
Main Road.....	
Secondary Road; Bench Mark.....	
Other Road; Bridge.....	
Track and Hiking Trail.....	
Railway; Station or Stopping.....	
Other Railway; Tunnel.....	
Embankment; Cutting.....	
Power Line.....	
Build-up Area (High, Low Density).....	
Buildings; Ruin.....	
Post Office; Police Station; Store.....	
Place of Worship; School; Hotel.....	
Fence; Wall.....	
Windpump; Monument.....	
Communication Tower.....	
Mine Dump; Excavation.....	
Trigonometrical Station; Marine Beacon.....	
Lighthouse and Marine Light.....	
Cemetery; Grave.....	

Legend	
LANDTYPE	
	1
	2
	3
	4
	5
	6
	7
	8
	Number Null
	Water

NORTH WEST PROVINCE LOCALITY MAP



LAND CAPABILITY MAP: PROPOSED MINING PERMIT ON A CERTAIN PORTION OF THE REMAINING EXTENT OF PORTION 1 OF THE FARM CHRISTIANA TOWN & TOWNLANDS 325 REGISTRATION DIVISION HO, IN CHRISTIANA, NORTH WEST PROVINCE.
 TOTAL EXTENT: 4.9 ha

Adopted from the 1:50 000 Topographical Maps-2725CC

APPLICANT:
 VERONICA DINEO
 NTSEKELE TSA

GPS:
 27°54'28.257"S
 25°08'14.546"E

Signature:
 Date:

Datum: D_WGS_1984
 Spheroid: WGS_1984
 1:10,000



REFERENCE	
International Boundary and Season.....	
Provincial Boundary.....	
Protected Area.....	
Perennial River.....	
Non-perennial River.....	
Dry Water Course.....	
Dry Pan.....	
Marsh and Vlei.....	
Pipeline (above ground).....	
Water Tower; Reservoir; Water Point.....	
Coastal Rocks.....	
Prominent Rock Outcrop.....	
Friction Sand.....	
Woodland.....	
Cultivated Land.....	
Orchard or Vineyard.....	
Recreation Ground.....	
Row of Trees.....	

REFERENCE	
National Freeway; National Route.....	
Arterial Route.....	
Main Road.....	
Secondary Road; Bench Mark.....	
Other Road; Bridge.....	
Track and Hiking Trail.....	
Railway; Station or Stopping.....	
Other Railway; Tunnel.....	
Embankment; Cutting.....	
Power Line.....	
Build-up Area (High, Low Density).....	
Buildings; Ruin.....	
Post Office; Police Station; Store.....	
Place of Worship; School; Hotel.....	
Fence; Wall.....	
Windpump; Monument.....	
Communication Tower.....	
Mine Dump; Excavation.....	
Trigonometrical Station; Marine Beacon.....	
Lighthouse and Marine Light.....	
Cemetery; Grave.....	

Name	X	Y	X2	Y2
A	25.138487	-27.908548	25° 8' 18.553" E	27° 54' 30.773" S
B	25.138596	-27.90706	25° 8' 18.946" E	27° 54' 25.416" S
C	25.137088	-27.906429	25° 8' 13.517" E	27° 54' 23.144" S
D	25.135941	-27.908976	25° 8' 9.388" E	27° 54' 32.314" S

Christiana

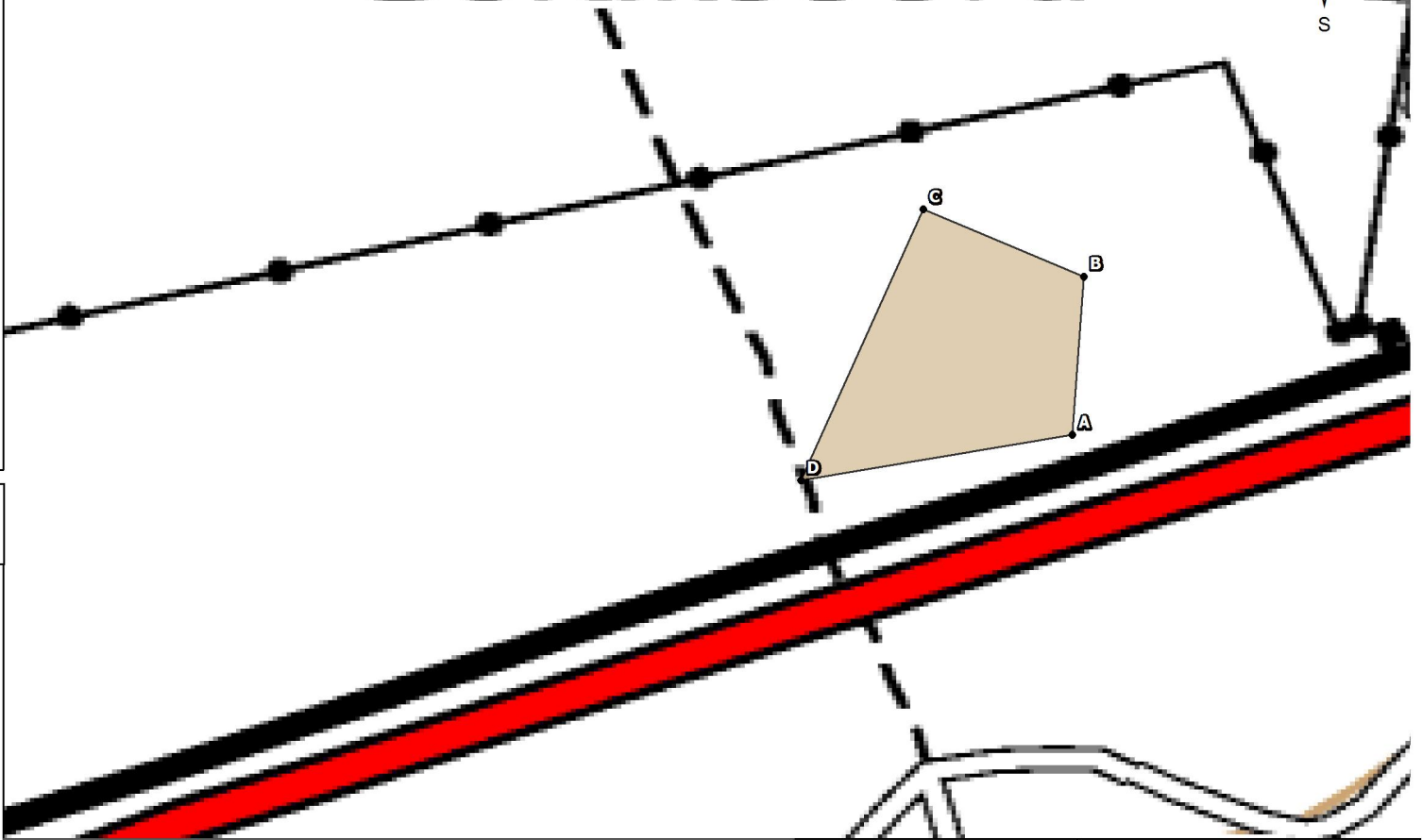
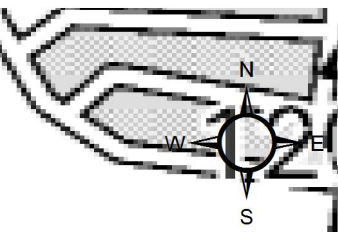

NORTH WEST PROVINCE LOCALITY MAP



REGULATION 2.2 MAP: PROPOSED MINING PERMIT ON A CERTAIN PORTION OF THE REMAINING EXTENT OF PORTION 1 OF THE FARM CHRISTIANA TOWN & TOWNLANDS 325 REGISTRATION DIVISION HO, IN CHRISTIANA, NORTH WEST PROVINCE.
TOTAL EXTENT: 4.9 ha

Adopted from the 1:50 000 Topographical Maps-2725CC

APPLICANT:
VERONICA DINEO
NTSEKELE TSA

Signature:

Date:

GPS:
27°54'28.257"S
25°08'14.546"E

Datum: D_WGS_1984
Spheroid: WGS_1984
1:5,000

REFERENCE	
International Boundary and Beacon.....	
Provincial Boundary.....	
Protected Area.....	
Perennial River.....	
Non-perennial River.....	
Dry Water Course.....	
Dry Pan.....	
Marsh and Vlei.....	
Pipeline (above ground).....	
Water Tower; Reservoir; Water Point.....	
Coastal Rocks.....	
Prominent Rock Outcrop.....	
Friction Sand.....	
Woodland.....	
Cultivated Land.....	
Orchard or Vineyard.....	
Recreation Ground.....	
Row of Trees.....	

REFERENCE	
National Freeway; National Route.....	
Arterial Route.....	
Main Road.....	
Secondary Road; Bench Mark.....	
Other Road; Bridge.....	
Track and Hiking Trail.....	
Railway; Station or Stopping.....	
Other Railway; Tunnel.....	
Embankment; Cutting.....	
Power Line.....	
Build-up Area (High, Low Density).....	
Buildings; Ruin.....	
Post Office; Police Station; Store.....	
Place of Worship; School; Hotel.....	
Fence; Wall.....	
Windpump; Monument.....	
Communication Tower.....	
Mine Dump; Excavation.....	
Trigonometrical Station; Marine Beacon.....	
Lighthouse and Marine Light.....	
Cemetery; Grave.....	

Legend

	Natural
	Waterbodies
	Cultivation
	Degraded
	Urban Built-up
	Plantations
	Mines

Proposed Layout

Legend	
	Topsoil
	Trench
	1 x EX355 Excavator
	1 x Rondebult Front End Loader
	1 x JCB Front End Loader
	1 x Mercedes Tipper 10 Cube
	1 x 16-ft washing pan
	Gravel
	1 x 125 kva Generator

NORTH WEST PROVINCE LOCALITY MAP



SUPERIMPOSED LANDCOVER MAP: PROPOSED MINING PERMIT ON A CERTAIN PORTION OF THE REMAINING EXTENT OF PORTION 1 OF THE FARM CHRISTIANA TOWN & TOWNLANDS 325 REGISTRATION DIVISION HO, IN CHRISTIANA, NORTH WEST PROVINCE.
TOTAL EXTENT: 4.9 ha
 Adopted from the 1:50 000 Topographical Maps-2725CC

APPLICANT:
 VERONICA DINEO
 NTSEKELE TSA

GPS:
 27°54'28.257"S
 25°08'14.546"E

Signature:

Date:

Datum: D_WGS_1984
Spheroid: WGS_1984
1:10,000