

**Project Details:**

**QUAGGA KOP 213  
SURVEY PLAN**

The Remainder and Portion 1 of the farm Quagga Kop 213, the farm 214 and Zandrakal C 98

Office reference: LWC007/MG/SUR

**Applicant:**

MEERA DIAMONDS (PTY) LTD

**Contact Details:**

11th Floor, Sandton City Office Towers  
Corner Rivonia Road and 5th Street  
Sandton  
2196

Tel: 011 783 6666  
Cell:  
Fax: 011 783 6669

**Client Signature:**

Signed:

Date: 22 April 2016

Scale:

1:100 000



8 Atkinson Street • Cassandra • Kimberley  
PO Box 3226 • Kimberley • 8300  
Tel: 072 141 4164 • Fax: 086 606 6315  
indlawiehatn@gmail.com

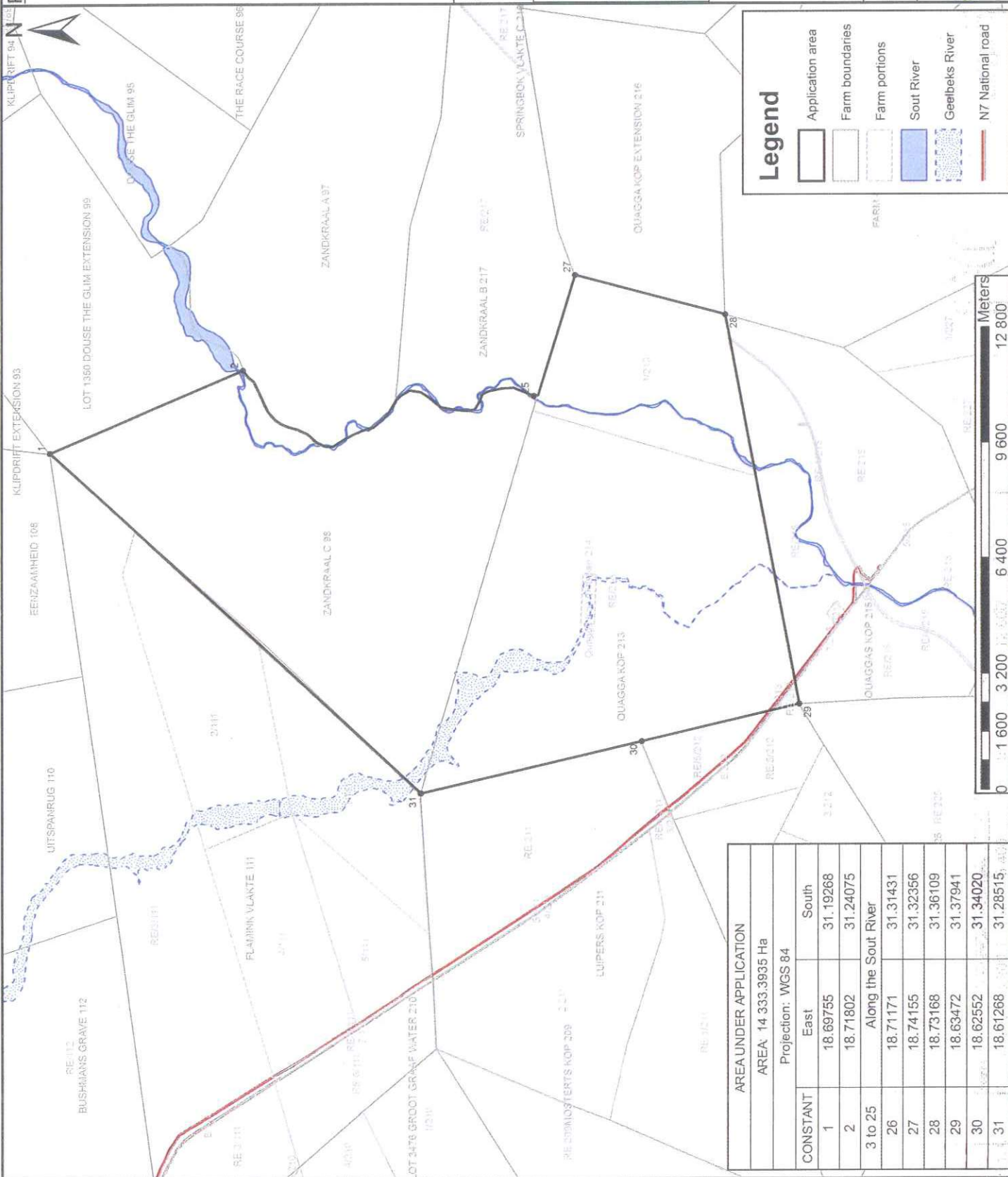

AREA UNDER APPLICATION	
AREA: 14 333.3935 Ha	
Projection: WGS 84	
CONSTANT	East
1	18.69755
2	18.71802
Along the Sout River	
26	18.71171
27	18.74155
28	18.73168
29	18.63472
30	18.62552
31	18.61268
	South
1	31.19268
2	31.24075
26	31.31431
27	31.32356
28	31.36109
29	31.37941
30	31.34020
31	31.28515

**Project Details:**

**QUAGGA KOP 213**

**TOPOGRAPHIC PLAN**

The Remainder and Portion 1 of the farm Quagga Kop 213, the farm 214 and Zandkraal C 98

Office reference: LWC007/WG/TOP

**Applicant:**

MEERA DIAMONDS (PTY) LTD

**Contact Details:**

11th Floor, Sandton City Office Towers  
Corner Rivonia Road and 5th Street  
Sandton  
2196

Tel: 011 783 6666

Cell:

Fax: 011 783 6669

**Client Signature:**

Signed:

Date: 22 April 2016

Scale:

1:100 000

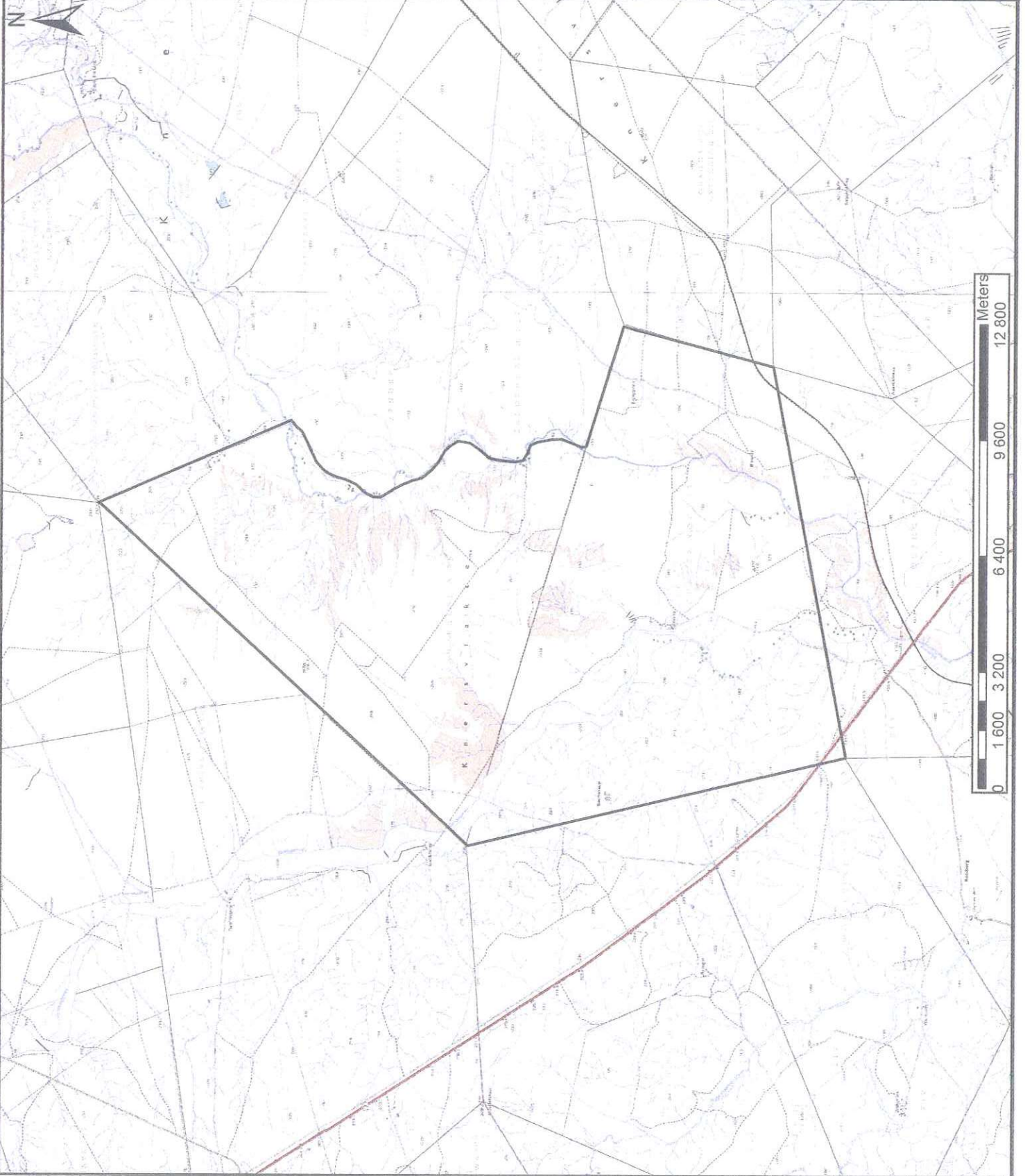

3D CONSULTANTS  
8 Atkinson Street • Cassandara • Kimberley  
PO Box 3226 • Kimberley • 8300  
Tel: 072 141 4164 • Fax: 086 606 6315  
lindiewehahn@gmail.com

**Project Details:**

**QUAGGA KOP 213**

**LOCALITY PLAN**

The Remainder and Portion 1 of the farm Quagga Kop 213, the farm 214 and Zandrakal C 98

Office reference: LWC007/WG/LOC

**Applicant:**

MEERA DIAMONDS (PTY) LTD

**Contact Details:**

11th Floor, Sandton City Office Towers  
Corner Rivonia Road and 5th Street  
Sandton  
2196

Tel: 011 783 6666

Cel:

Fax: 011 783 6669

**Client Signature:**

Signed:

Date: 22 April 2016

Scale: 1:250 000



**SD CONSULTANTS**  
8 Alkenson Street • Cassandra • Kimberley  
PO Box 3226 • Kimberley • 8300  
Tel: 072 141 4164 • Fax: 086 606 6315  
indlawiehahn@gmail.com

