



**Environmental Management Consultants**

NATIONAL PREMIUM AWARD 2002 & 2004  
INTERNATIONAL ASSOCIATION FOR IMPACT ASSESSMENT  
SOUTH AFRICAN CHAPTER

P O Box 503, Mtunzini, 3867 South Africa  
Suites 5 & 6, Golden Penny Centre  
26 Hely Hutchinson Rd  
Tel: 035 340 2715 • 035 340 2245  
Fax: 035 340 2232  
International Code: +27  
Website: [www.acerafrica.co.za](http://www.acerafrica.co.za)  
E-mail: [info@acerafrica.co.za](mailto:info@acerafrica.co.za)

15 May 2013

Mr Len van Schalkwyk  
eThembeni Cultural Heritage  
P.O. Box 20057  
Ashburton  
3213

Fax: 086 672 8557  
Email: [thembeni@iafrica.com](mailto:thembeni@iafrica.com)

Dear Len,

**RICHARDS BAY INDUSTRIAL DEVELOPMENT ZONE: WIDENING OF MEDWAY ROAD**

**REQUEST FOR PROPOSAL AND COST ESTIMATE TO UNDERTAKE A HERITAGE ASSESSMENT  
FOR THE PROPOSED WIDENING OF MEDWAY ROAD AND ASSOCIATED INTERCHANGES  
WITHIN RICHARDS BAY, KWAZULU-NATAL**

Please provide a proposal and cost estimate to undertake a Heritage Assessment of the area affected by the proposed widening of Medway Road and Associated Interchanges within Richards Bay, KwaZulu-Natal.

Please prepare your proposal and cost estimate as per the accompanying terms of reference (Appendices 1 and 2).

There is an imperative to have the specialist studies completed as soon as possible (from a design and planning perspective). Therefore, it would be appreciated if you could submit your proposal by Friday 17 May 2013.

Should you require any further information regarding the proposed development, please contact me on 082 907 9738 or 035 340 2715.

Yours sincerely,

**ACER (Africa) Environmental Management Consultants**  
Giles Churchill  
Environmental Consultant

## APPENDIX 1

### 1. INTRODUCTION

On behalf of the proponent, the Richards Bay Industrial Development Zone (RBIDZ), ACER (Africa) Environmental Management Consultants (ACER) would like to commission a Heritage Assessment of the area affected by the proposed widening of Medway Road and Associated Interchanges within Richards Bay.

### 2. PROJECT DESCRIPTION

RBIDZ is planning to improve access to the RBIDZ Phase 1A, which is a purpose built and secure industrial estate in Richards Bay, within the uMhlathuze Municipality. The proposed improvements to access the RBIDZ Phase 1A include the widening of Medway Road and Associated Interchanges, which are managed by the City of uMhlathuze.

The project is located in Richards Bay within the uMhlathuze Local Municipality, which is one of the local government administrative areas within the uThungulu District Municipality. The primary objectives of the proposed project are to improve the road service infrastructure to Phase 1A of the RBIDZ in an effort to support the various development scenarios for Phase 1A as well as to encourage investment in export-orientated manufacturing industries, thereby creating opportunities for employment.

The proposed upgrades to Medway Road will include the widening of the existing two lane road to a four lane road (Figure 1); the provision of a road median between the traffic lanes; the provision of a 1.5 m wide sidewalk; the widening of associated interchanges, including the intersection with the John Ross Highway (Plate 1) and the widening of the existing bridge structure across the Ngodweni River (Plate 2).

**It is important to note that the proposed project area is located within an area dominated by swamps and intertidal flats which were reclaimed during the construction of the Port of Richards Bay in the 1970s. As such a heritage assessment may not be required and should be investigated by the Heritage Specialist**

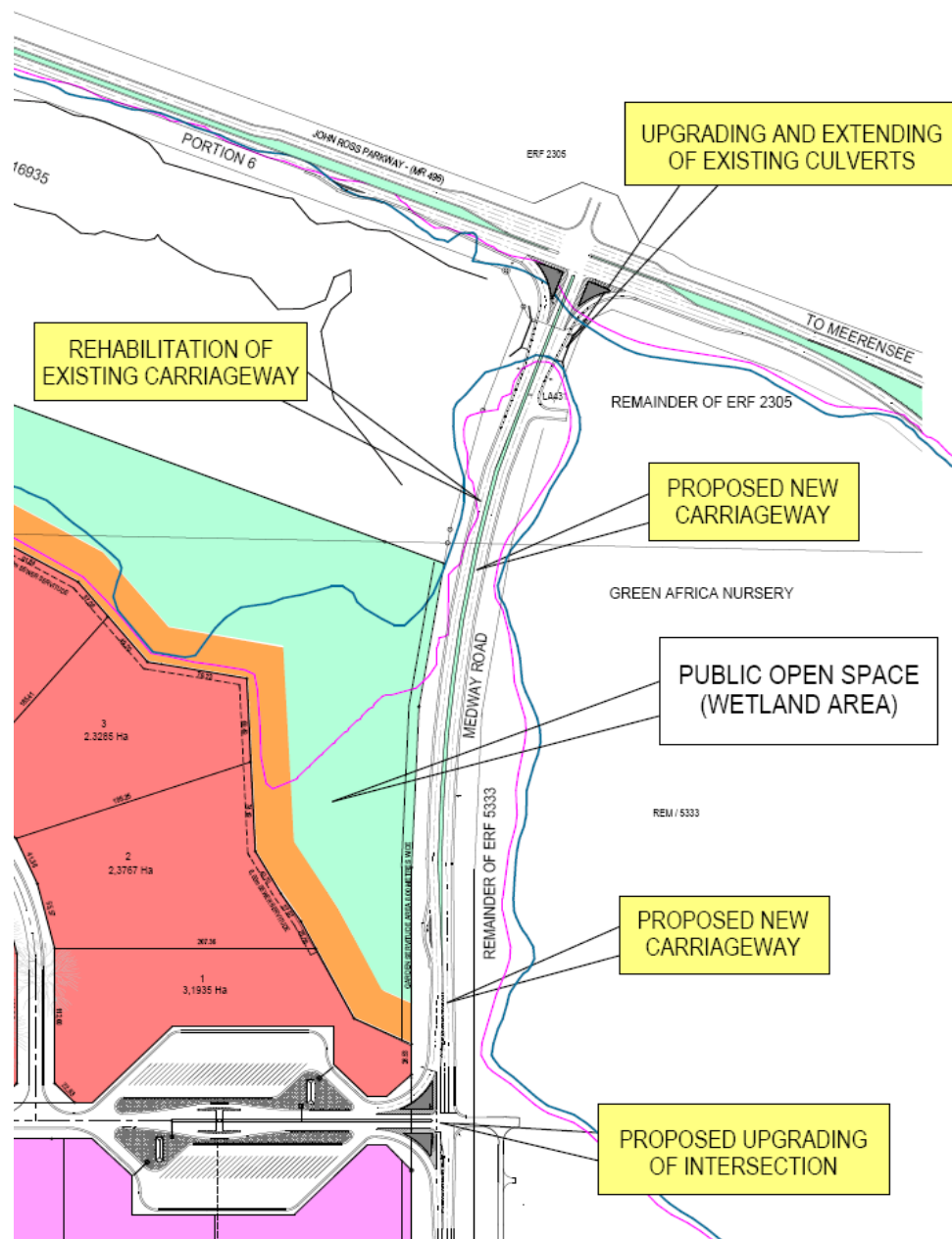

**Figure 1** Proposed Upgrades to Medway Road and Associated Intersections



**Plate 1      Medway – John Ross Highway Intersection**



**Plate 2      Medway Road Bridge over the Ngodweni River**

The proposed widening of Medway Road will involve the following:

- ❑ Widening of the existing bridge over the Ngodweni River.
  - Widening of the bridge to accommodate a four lane road.
  - Construction within the intertidal areas will require the construction of suitable drainage structures and stabilising walls.
- ❑ Widening of Medway Road.
  - Construction will include the provision of a 6 m wide road median.
  - The construction of two additional traffic lanes to the east of the existing alignment of Medway Road.
  - The raising of the development footprint with fill material to obtain the required road height.
  - Removal of vegetation and infilling of some wetlands to the east of Medway Road directly adjacent to the road.

---

Construction, operation and maintenance may include the following activities:

- ☐ Movement of people, vehicles and machinery over the development sites.
- ☐ Stockpiling of materials.
- ☐ Possible hydrocarbon spillages (fuels and oils).
- ☐ Generation of solid waste during construction.
- ☐ Clearance of vegetation.
- ☐ Excavation of soils, trenching, cut and fill.
- ☐ Importation of material (for example, sand, stone and gravel).
- ☐ Compaction of soils.
- ☐ Spoiling of material.

### **3. LOCATION AND SIZE**

Medway Road and the proposed development footprint are located to the north of the Port of Richards Bay and to the south of the John Ross Highway, which, for this section, connects the city centre to Meerensee. The approximate footprint for the proposed widening of Medway Road comprises 1.7 ha of terrestrial low-lying coastal plain and wetlands adjacent to the existing road footprint (Figure 1).

### **4. PROPOSED WORK PLAN**

In order to fast-track specialist investigations it is proposed that all specialist assessments be completed within 21 days of commencement. Please indicate if this time frame is problematic for your specialist study.

### **5. USE OF EXISTING INFORMATION AND SUPPORTING DOCUMENTS**

All specialists are required to apprise themselves of existing information. Upon appointment, specialists must undertake a literature review and desktop investigation to collate relevant information and assess gaps in knowledge. The following material will be provided:

- ☐ Maps and diagrams (as available).

### **6. PROJECT SCHEDULE AND DELIVERABLES**

The following deliverables are required:

- ☐ One draft and one final copy of the report – electronically (MS Word).
- ☐ The draft report is to be handed to the Project Manager at the end of the 3-week period.
- ☐ A final report will be required approximately two weeks after submission of the draft report (once comments have been provided by RBIDZ and ACER).

## **7. ON-SITE AND REPORTING PROCEDURES**

Please be advised that the site falls within and adjacent to the road reserves of the John Ross Highway and Medway Road and, as such, the following health and safety rules must be adhered to:

- ☐ Required PPE – reflective vest.
- ☐ No parking is permitted alongside the John Ross Highway or Medway Road (make use of existing parking at Green Africa Nursery).
- ☐ Beware of passing vehicles on the John Ross Highway and Medway Road.
- ☐ Obey all road safety regulations and traffic signs.
- ☐ Be observant for snakes, hippos and crocodiles, especially in undeveloped areas.

## **8. COST ESTIMATE AND PAYMENT**

Please provide ACER with an estimate of cost for professional fees and disbursements to undertake this work by 17 May 2013. Approval will be sought immediately from the client, with the assignment commencing immediately thereafter. Payment will be made on completion of the work, once the client has accepted the final report, and within three working days of ACER receiving payment from the client.

Please note the following:

- ☐ Accommodation and subsistence on-site will be for your own account, and should form part of your cost estimate.
- ☐ Travel to, from and around site will be for your own account, and should form part of your cost estimate.

## **9. CONCLUDING REMARKS**

ACER is responsible for the submission of a Basic Assessment Report to DAEA for purposes of environmental authorisation. This specialist study will form an integral component of this Basic Assessment and will help to ensure that the approach can be shown to meet current environmental management best practise in terms of sustainable development.

## APPENDIX 2

### Terms of Reference

#### Terms of Reference

In order to assess potential environmental impacts of construction activities associated with the proposed widening of Medway Road and Associated Interchanges, and to meet the requirements of the Environmental Impact Assessment (EIA) Regulations of 2010, a Basic Assessment must be undertaken to obtain an Environmental Authorisation (EA) for this proposed project. ACER has undertaken an initial Scoping exercise, which is to be followed by the Basic Assessment.

Arising from the preliminary investigations is the following question:

***What are the potential impacts on heritage resources in the area to be affected by the proposed widening of Medway Road, interchanges and associated construction activities?***

Heritage resources that may be impacted on by the proposed project must be identified according to the process specified in the KwaZulu-Natal Heritage Act, 1997. This requires a Level 1 Heritage Resources Assessment (excluding consultation) to attend to the following:

- ❑ The identification and mapping of all heritage resources in the area affected, as defined in Section 2 of the National Heritage Resources Act, 1999, including archaeological and paleontological sites on or close (within 100 m) to the proposed development.
- ❑ The assessment of the significance of such resources in terms of the heritage assessment criteria as set out in the regulations.
- ❑ An assessment of the impact of development on such heritage resources.
- ❑ An evaluation of the impact of the development on heritage resources relative to the sustainable social and economic benefits to be derived from the development.
- ❑ The identification of heritage resources that will be adversely affected by the proposed development.

#### Key Deliverables

- ❑ A report detailing the above aspects, according to the aforementioned requirements.
- ❑ Recommendations for mitigation and further studies, including a list of all necessary permit applications, which may be required.
- ❑ A map, indicating all heritage resources and significance, within 100 m of the proposed development, at a scale of 1:500.

In addition, your specialist study report must include:

- ❑ Details of:
  - The person who prepared the report.
  - The expertise of that person to carry out the specialist study or specialised process.
- ❑ A declaration that the person is independent in a form as may be specified by the competent authority.
- ❑ An indication of the scope of, and purpose for which, the report was prepared.

- 
- ❑ A description of the methodology adopted in preparing the report, or carrying out the specialised process.
  - ❑ A description of any assumptions made and any uncertainties or gaps in knowledge.
  - ❑ A description of the findings and potential implications of such findings on the impact of the proposed activity, including identified alternatives, on the environment.
  - ❑ Recommendations in respect of any mitigation measures that should be considered by the applicant and the competent authority.
  - ❑ Any other information requested by the competent authority.