



**THE DEPARTMENT OF MINERALS AND ENERGY**

COBID: 1555

Private Bag X 9467, Polokwane, 0700.  
101 Dorp Street, Polokwane, 0699  
Tel no: (015) 287 4700; Fax no: (015) 287 4729

**Directorate: Mineral Regulation - Limpopo Region**

Enquiries: Mapula Mashile  
E-mail address: Mapula.Mashile@dme.gov.za  
Reference nr: LP 30/5/1/3/3/2/1/ 311 EM

**REGISTERED MAIL**

**The Provincial Manager  
SAHRA- Limpopo  
P. O. Box 137  
POLOKWANE  
0700**

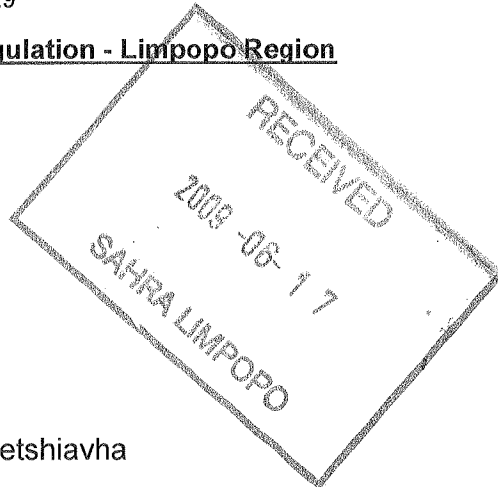

Attention: Mr. Donald Lithole/ Victor Netshiavha

**CONSULTATION OF CLOSURE CERTIFICATE APPLICATION IN TERMS OF SECTION 43 OF THE MINERAL AND PETROLEUM RESOURCES DEVELOPMENT ACT 2002, (ACT 28 OF 2002) IN RESPECT OF THE BORROW PITS FOR UPGRADING (FROM GRAVEL TO TAR) OF ROAD D3180 FROM MODJADJI-MOKWAKWAILA-BAMBENI-NKOMO, SITUATED IN THE MAGISTERIAL DISTRICT OF MOPANI. APPLICANT: ROADS AGENCY LIMPOPO.**

Attached herewith, please find a document submitted in support of a closure certificate application received from the above-mentioned applicant, for your comments.

It would be appreciated if you could forward any comments or requirements your Department may have in the case in hand to this office and to the applicant within 60 days of this letter **i.e. on or before 14 August 2009**, failure of which will lead to the assumption that your Department has no objection(s) or comments with regard to this application and this Department will in that instance proceed with the finalisation thereof.

In an attempt to expedite the consultation process please contact **Ms. Mapula Mashile** of this office to make arrangements for a site inspection or for any other enquiries with regard to this application.

Your co-operation will be appreciated.

  
P.P. MOKOENA  
**THE REGIONAL MANAGER  
LIMPOPO REGION – POLOKWANE  
DATE: 15 JUNE 2009**



**DEPARTMENT: MINERALS AND ENERGY  
REPUBLIC OF SOUTH AFRICA**

**APPLICATION FOR CLOSURE CERTIFICATE**

[in terms of section 43(3) of the Mineral and Petroleum Resources Development Act, 2002 (Act No. 28 of 2002)]

**Note:**

The application is to be made within 180 days of lapsing, abandonment, cancellation, cessation, relinquishment or rehabilitation completed in terms of the closure plan as contemplated in section 43(3) of the Act.

**REGIONAL MANAGER / DESIGNATED AGENCY**

**REGION**

M O P A N I L I M P O P O

**1 Number of permission, permit or right**

L P 3 0 / 5 / 1 / 3 / 1 / 3 1 1

**2 Name of applicant**

R O A D S A G E N C Y L I M P O P O

**3 Type of permission, permit or right in terms of the Act**

Reconnaissance permission ☐  
 Prospecting right ☐  
 Mining right ☐  
 Mining permit ☒

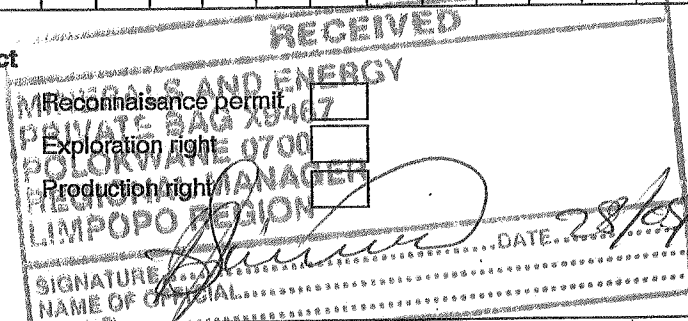

**4 Type of mineral or minerals**

GRAVEL MATERIAL FOR ROAD CONSTRUCTION

**5 Over the following land or area of offshore licence block**

M O D J A D J I A R E A

(attached a plan of land, area or offshore licence blocks applied for, if necessary)  
 Minerals and Energy for Development and Prosperity

## **BACKGROUND**

Eskom Holdings Ltd, being responsible for the provision of reliable and affordable power to its consumers in South Africa, has initiated the proposed project in order for the capacity to keep up with both electricity generation capacity and the distribution of electricity generated to meet the demand. Eskom Distribution (Dx) is committed to and responsible for supplying end-users with a reliable network. For Eskom Dx to keep to its commitment, it has to plan, establish and expand its distribution power lines infrastructure on an on-going basis, in support of the Generation process and Transmission networks.

## **PROJECT DESCRIPTION**

The proposed new substation and power lines will strengthen and supply the Dennilton area with electricity

### **Technical details:**

- The construction of the new Dennilton substation
- The substation will be approximately be 100m x 100m in size
- The construction of 1x 132kV power line from the existing Grobblersdeal substation to the new Dennilton substation
- The construction of 1x 132kV power line from the existing Kwaggafontein substation to the new Dennilton Substation
  - The pole structure will be a steel monopole design
  - The height will vary between 21m – 24m above ground
  - The average span length 250m
- The servitude will be 15.5m on each side =31m for the line
- Construction of a telecommunications tower in the substation

### **Route and Side Selection**

As part of the study, preferred route for the new power line and preferred site for the new substation will be identified on the basis of stakeholder inputs, environmental specialist investigations and technical feasibility. Currently there are two sites and route alignments.

If the site for the distribution and alignment for the lines are recommended, they will be presented to the decision making authority, Department of Environmental Affairs

### **PROJECT LOCATION**

Project location is indicated in the attached maps

### **PROJECT TEAM**

Eskom Holdings Limited is the applicant  
Margen Industrial Services is the lead consultant, PBAI is the Independent Environmental Assessment Practitioner (EAP) AND Margen Communications is the Independent Public Participation Practitioners

### **PUBLIC PARTICIPATION PROCESS (PPP)**

#### **PPP PROVIDES:**

- Opportunities for I&APs and the authorities to obtain clear, accurate and understandable information regarding the proposed project and the anticipated environmental impacts it may have
- Members of the public with the opportunity to voice their concerns and to raise questions regarding the project
  - Affected parties with the opportunity to suggest ways for reducing or mitigating any negative impacts of the project, and for enhancing its potential benefits
- The project proponent with opportunities to consider the needs, preferences and values of affected parties in their decisions
- The sharing of information forms the basis of any stakeholder engagement process and offers I&APs the opportunity to become actively involved in the project from the outset. It also plays an important role in the understanding of environmental impact, as inputs from I&APs are considered in the study.

### **HOW TO REGISTER**

- Respond to relevant newspaper advertisements
- Complete and submit the registration sheet
  - Provide us with your contact details
  - Attend the public participation events
  - Review the project documentation

**Contact Persons:** Solly Mohlala & Chris Le Roux

**Tel Nr:** 013 6561212 fax 013 6562233 **Cell:** 084 6092881

**Address:** P O Box 12822 Leraatsfontein, 1038

**Email:** [chris@margen.co.za](mailto:chris@margen.co.za) & [solly@margen.co.za](mailto:solly@margen.co.za)



# Map

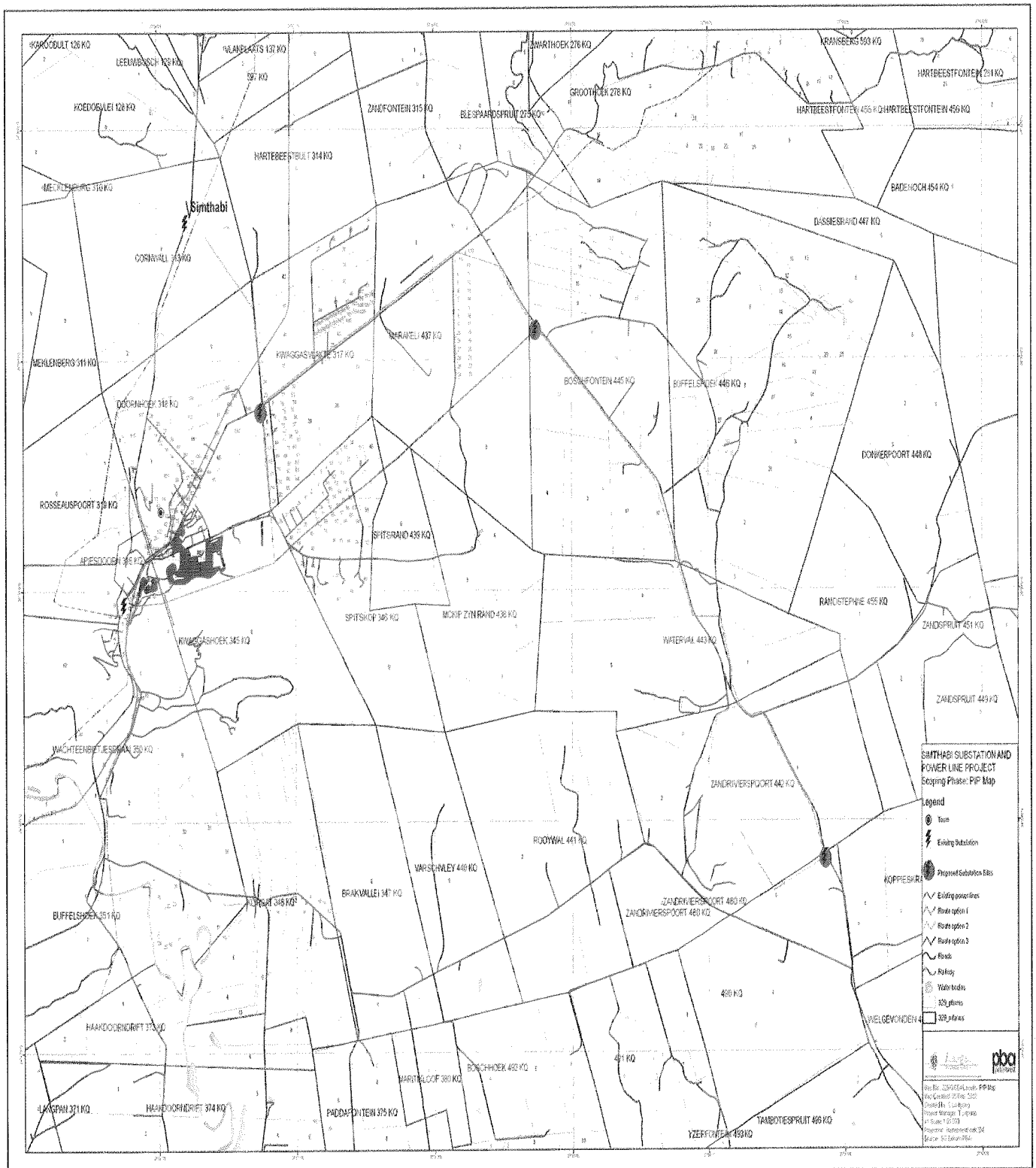



# Map

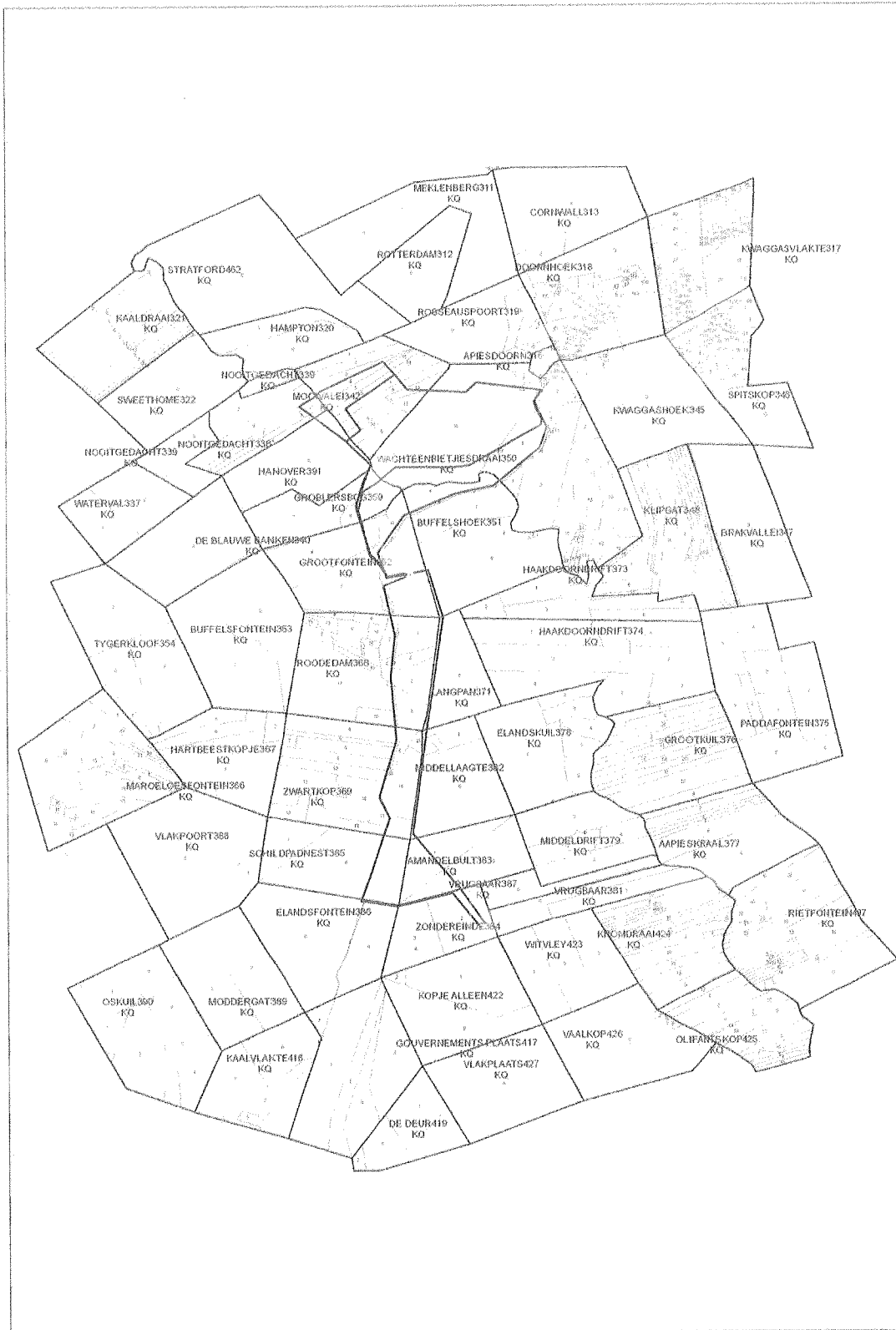



## ENVIRONMENTAL IMPACT ASSESSMENT PROCESS (BASIC ASSESSMENT)

PROPOSED ESKOM DISTRIBUTION ACTIVITY: (DEAT REF: 12/12/20/1888)

### CONSTRUCTION OF:

- 2 X 10 MVA, 88/11KV AND 2 X 20 MVA, 88/22KV TRANSFORMER UNITS, AND 2 X 22KV MV TRANSFORMER BAYS.
- ONE NEW ±300M LONG 88KV DOUBLE CIRCUIT CHICKADEE "LILO" DISTRIBUTION POWER LINE.
- CONSTRUCTION OF COMMUNICATION TOWER.
- DISMANTLING THE EXISTING UITKYK SUBSTATION.

## Basic Assessment BACKGROUND INFORMATION DOCUMENT

### PURPOSE OF THIS DOCUMENT

The purpose of this document is to announce and provide an overview of the proposed Eskom Distribution Northern Region's project, which includes establishment of a new substation and a new power line, and related substations infrastructure.

Information provided in this document will assist Interested and Affected parties (I&APs) to participate meaningfully in this study by giving:

- An overview of the proposed project
- A map of the study area showing the various route corridors for the Eskom Distribution lines and /or substation alternatives

The study is being conducted in terms Regulation 56, Government Notice R385 under the Environmental Impact Assessment Regulations promulgated under Section 24(5) and 24D of the National Environmental Management Act, No. 107 of 1998, the listed activity is applicable under the Government Notice: R387 of 21 April 2006, Activity 1(I). An Environmental authorisation is expected to be granted by the Competent Authority (National Department of Environmental Affairs and Tourism)

### REGISTRATION OF I&APs

*In order to ensure that you are registered as an I&AP, and receive further information regarding the project, please submit your contact details to:*

Mr. Solly Mohlala  
Morgen Industrial Services  
P.O. Box 12822  
Leraatsfontein, 1038

Tel: (013) 656 1212  
Fax: (013) 656 2233  
E-mail: [mohlalass@telkomsa.net](mailto:mohlalass@telkomsa.net)

### BACKGROUND TO THE PROJECT

Eskom Distribution Northern Region proposes to construct the new Hillside substation (2 x 10MVA and 2 x 20MVA transformer units and 2 x 11kV and 2 x 22kV MV transformer bays) that will be located south of the Old Middelburg road (R555) on the farm Elandspruit 291 JS. New double circuit 88kV power line (±300m in length) is proposed to be connected from the existing Middelburg-Olifants Trac 88kV line located on the same farm to the new Hillside substation. A telecommunications tower is also to be constructed at the new Hillside substation and the existing Uitkyk substation will be dismantled. This project is proposed in the Mpumalanga Province under the jurisdictions of Steve Tshwete Local Municipality in Middelburg.

EIA studies for the project were conducted in 2007 and the project was authorised on **24 April 2008 with authorization Register Number 12/12/20/1019**

#### Project Motivation:

The proposed new substation and power line will strengthen the existing electricity network in the area.

#### Technical details: Hillside Substation

- New 2 x 10MVA, 88/11kV and 2 x 20MAV, 88/22kV transformer units to be installed
- New 2 x 11kV and 2 x 22kV MV transformer bays to be installed
- The substation yard will be approximately 100m X 100m in size
- Telecommunications tower to be constructed

#### Technical details: The Double Circuit 88kV Distribution power line

- Pole Structure will be a steel monopole design
- The Height will vary between 21m - 24m above ground
- Average Span Length of 250m
- The Servitude will be 15.5m on each side =31m for the line

#### Routes and Sites Selection:

As part of the study, preferred route for the new double circuit 88kV power line and preferred site for the new substation will be identified on the basis of stakeholder inputs, environmental specialist investigations and technical feasibility. Currently, there are two sites and route alignments on the farm Elandspruit 291 JS identified by the project team as being technically and economically feasible. However, the study proposes to focus on a study area that includes this farm and alternative routes and substation sites on the farm Elandspruit 291 JS.

If the site for the distribution substation and alignment for the lines are recommended, they will be presented to the decision making authority, the Department of Environmental Affairs (DEA)

## ISSUES RAISED DURING THE INITIAL EIA PROCESS

A list of issues that were raised during the initial EIA study is herewith attached to act as catalyst for further identification of issues through the public participation process

Themes	Issues, Concerns and Comments	Responses
Improvement of Reliability of supply	The dismantling of Uitkyk SS should not disrupt the supply of electricity to the communities in the surrounding area	<p>Comment noted. Eskom is requested to explain how the switch on of the new substation and the switch off of the existing substation will occur. What disruption will occur?</p> <p>Should such interruption be encountered a well in-advance notice will be given to customer. The Hillside project will not interfere with their network as they are being fed from another source, (Confirmed by Joe Ramphore – Project Specialist)  <b><i>This will apply to the new project.</i></b></p>
Project lifespan and Timeframes	What is the time frame of this project	The Record of Decision is expected early February 2008 and construction will start immediately there after. <b><i>The project was authorised on 24/04/2008. This RoD is not valid for the project as it is now proposed on new sites</i></b>
Technical information and line routing	<p>Where will the Telecommunication Tower be constructed?</p> <p>The proximity of the substation and the proposed lines to the mine is a concern to Shanduka Mine</p>	<p>It was confirmed that the telecommunication tower will be within Eskom yard. <b><i>This will apply to the new project.</i></b></p> <p>The comment was noted and a full copy of the report (CD) was sent to the mine officials</p>
Health, Safety and Wellbeing	No objection to the power line and substation being built on the farm Elandspruit but it was suggested that the infrastructure must be fenced.	Power lines will not be fenced, but the substation will be fenced. <b><i>This will apply to the new project.</i></b>
Compensation for Servitude	<p>Compensation for existing power lines on the farm Elandspruit was not paid.</p> <p>Who is going to evaluate the land</p>	<p>Comment noted. For this project a negotiator will contact the affected landowner to negotiate for the servitude. Compensation form part of negotiation. <b><i>This comment still holds for the new project on another site on the farm.</i></b></p> <p>Eskom will appoint an independent evaluator to do the valuation. If the</p>

### **SPECIALIST STUDIES ENVISAGED FOR THIS DETAILED STUDY**

The following specialist investigations are being undertaken as part of this Detailed Study. These have been identified through the project team's experience on similar projects and critical issues that have been identified through an initial site visit. The scope of these may be subject to change on the basis of the information gathered through the Public Participation Process and initial specialist input:

- Ecology
- Heritage
- A Geotechnical Specialist and Avifauna Specialist will be approached to provide input regarding the impact of the substation and the proposed lines for their respective fields

### **ACTIVITIES AND PROGRAMME FOR THE DETAILED STUDY**

The following activities have been undertaken as part of the Detailed Study:

- Preparation and submission of Notice of Intent to the Department of Environmental Affairs [15 April 2010]
- Development of a stakeholder database [Started in April 2010 and is still continuing until Basic Assessment Report is submitted].
- Preparation of documentation to notify stakeholders about the project and process to be followed: [ May 2010 ]
- Notification of the stakeholders through advertisements, site notices and background information documents:[May 2010]

The following activities are proposed for the future:

- Holding of information sharing/public meetings:
- Specialist investigations:
- Preparation of a Basic Assessment Report, summary thereof and Comment and Response Document & Distribution of Basic Assessment Report for public comment:
- Incorporation of comments and finalization of the report. This will then be submitted to DEAT for an authorization decision: It is anticipated that the scope of the Detailed Study will meet the information requirements of the regulatory authority. Should this not be sufficient, however, scoping and environmental impact assessment may need to be undertaken. Interested and affected parties will be informed of the decision taken by DEAT.

**In order to ensure that you are registered as an Interested and/or Affected Party and obtain further information, please submit your name and contact details to the consultant detailed below:**

**Attention: Solly Mohlala or Moses Mahlangu**

PERSONAL DETAILS:			
TITLE (Prof, Dr, Mr, Mrs Ms)		FIRST NAME	
INITIALS		SURNAME	
ORGANISATION			
CAPACITY			
ADDRESS			
POSTAL CODE		TEL NO	
CELL NO		FAX NO	
E-MAIL ADDRESS			

[illegible]

**Margen**  
INDUSTRIAL SERVICES

**plood**  
INTERNATIONAL (SA)  
Engineering & Environmental  
Consultants

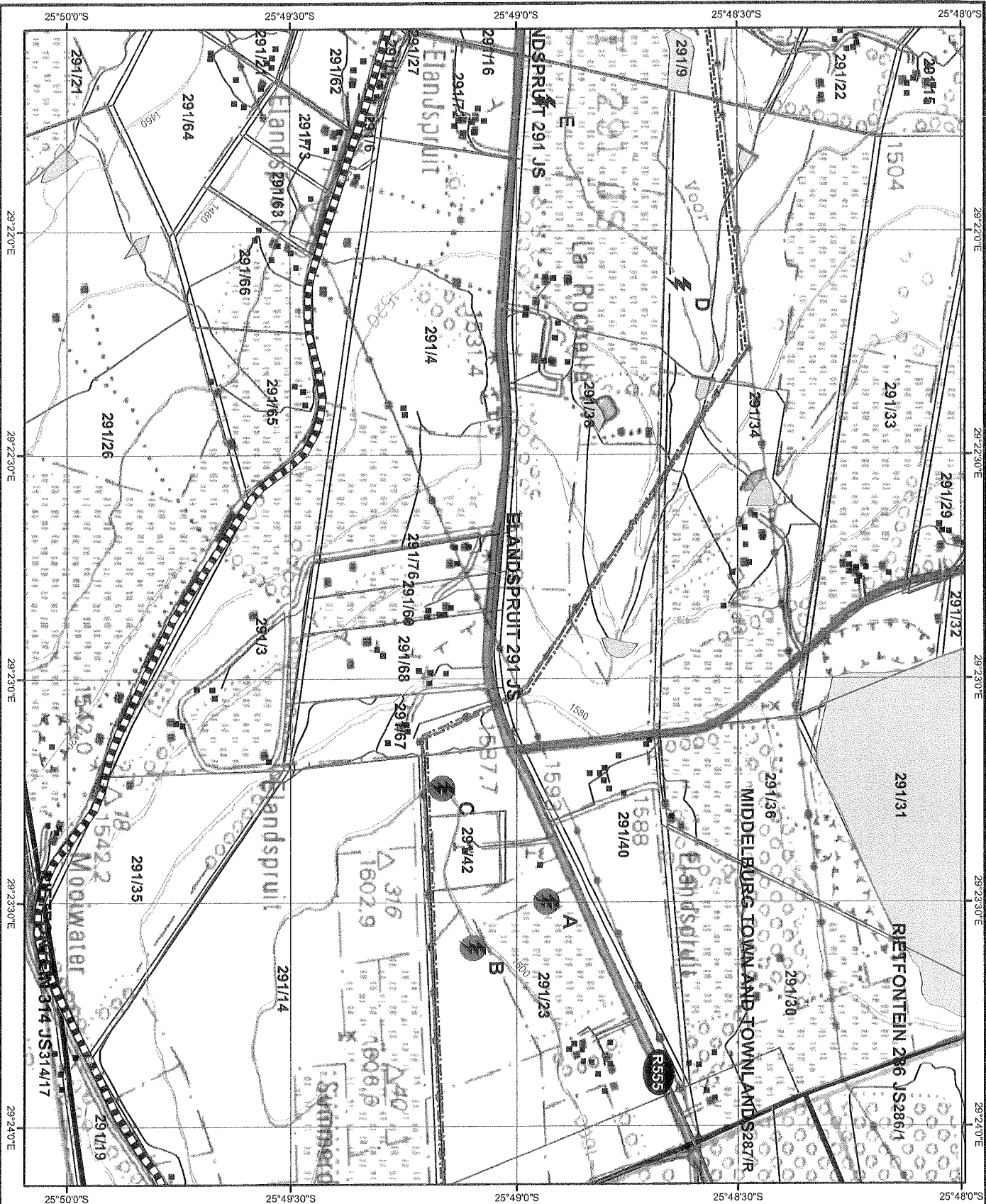

# HILL SIDE SUBSTATION AND POWER LINE PROJECT Locality Map

## Legend

- Buildings
- New Proposed Sites
- Old Proposed Sites
- Existing Power lines
- Railway line
- Contour
- River
- Main Roads
- Secondary Roads
- Water body
- Farms
- Farm portions



0 125 250 500 Meters



Map No. 360/G/007/Locality Map  
Map Created: 26 Oct. 2010  
Created by: C Lo-Jiyong  
Project Manager: T Lepono  
A3 Scale: 1:15,000  
Projection: Hartebesthoek 94  
Source: SG/Eskom/PBAI