

## **APPENDIX 2**

# **APPLICATION MAP AND SATELITE VIEW OF APPLICATION AREA**

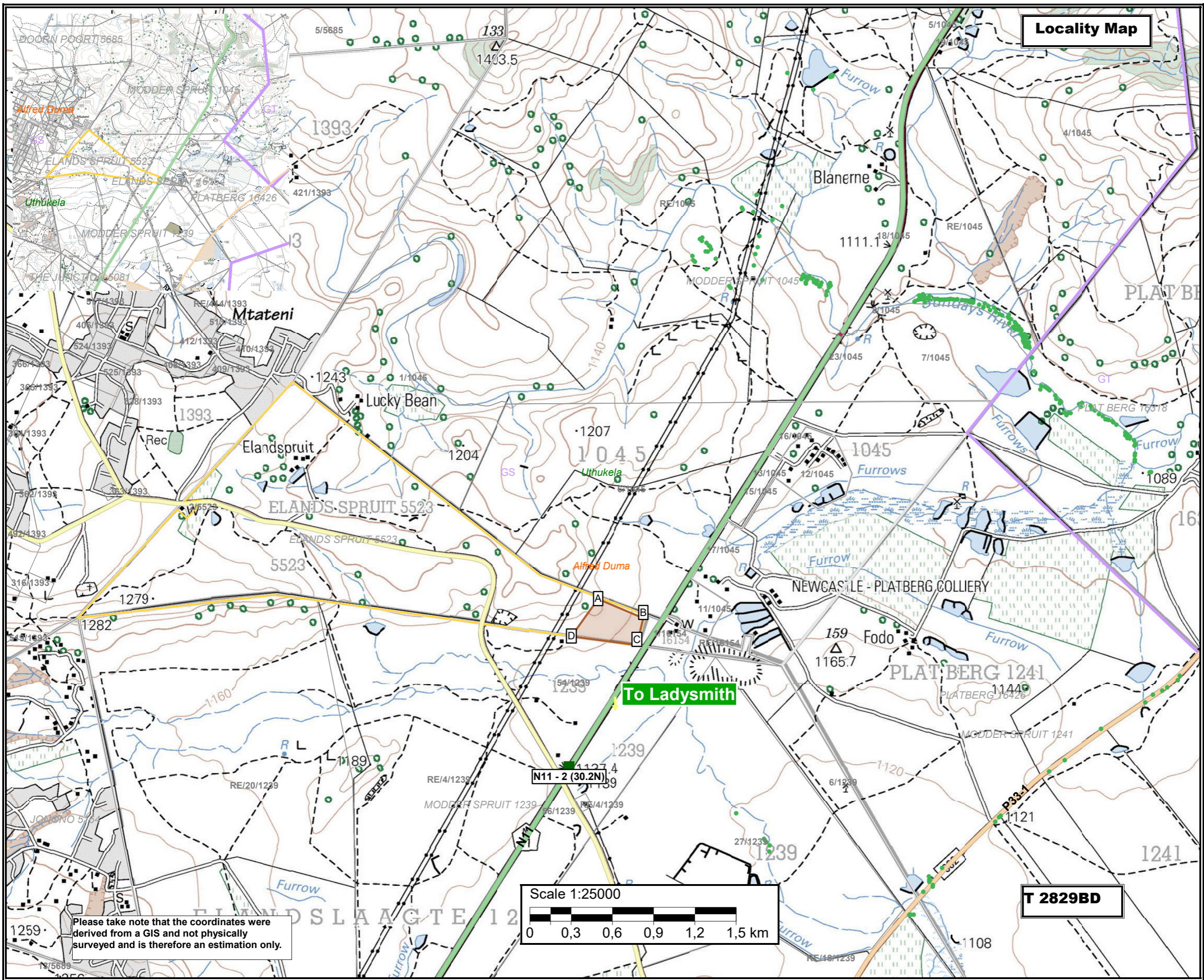



**Locality Map**

- Legend**
- A Parent farms
  - Farm portions
  - Administrative regions
  - Municipal boundaries
    - KwaZulu-Natal
    - Uthukela District Municipality
    - Alfred Duma Local municipality
    - Remaining Extent of Elands Spruit 5523
  - N11
  - P33 Secondary Road 602
  - P263 - Tertiary Road (Colling Pass Road)
  - tree
  - wetland
  - rail
  - farm
  - Direction towards Ladysmith
  - Road Marker
  - Proposed Stockpile Area

Proposed stockpile area coordinates:  
 A28°22'0,2294"S; 29°56'51,1253"E  
 B28°22'4,7356"S; 29°57'3,1374"E  
 C28°22'11,0474"S; 29°57'1,436"E  
 D28°22'9,0098"S; 29°56'43,9994"E

Stockpile application area:  
 10.5 ha

Client:



Consultant:



Please take note that the coordinates were derived from a GIS and not physically surveyed and is therefore an estimation only.

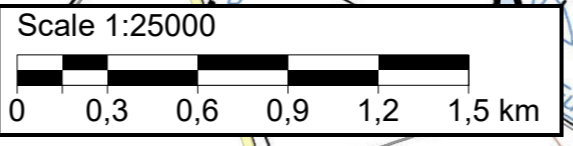

**T 2829BD**



