

LEGEND				 <small>THIS DRAWING IS THE PROPERTY OF ESCOM. UNLESS OTHERWISE STATED, IT IS NOT TO BE REPRODUCED OR TRANSMITTED IN ANY FORM OR BY ANY MEANS WITHOUT THE WRITTEN PERMISSION OF ESCOM.</small>	
	Existing MV		Telkom		Existing MV Structure
	New MV		Road		New MV Structure Bend/T Off
	Fence/Stand		Water Pipeline		New TRF
			Protected Tree		Existing TRF
					New MV Structure - Intermediate

PROJECT NO: MHINGA SASELAMANI FEEDER SPLIT	 T-Off Pole: MMI405 A: 9.356 B: 8.773 C: 8.235 Staggered Vertical					
FEEDER: MHINGA/SASELAMANI 22kV		3				
CONDUCTOR: FOX		2				
LENGTH OF LINE: 2.876km		1				
SURVEYOR: LJCC ENGINEERING SURVEYS		0	A NEETHLING	082 463 1253	10/09/21	
DRAUGHTSPERSON: A NEETHLING (082 448 2641)		SURVEYOR REV SURVEY DATE				
CUSTOMER: MS MAEPA						
PROPERTY: MHINGA'S LOCATION 258 LT						
CONTACT DETAILS: (015) 297 7457						
SCALE: 1 : 2 500	PAGE: 1 of 1					

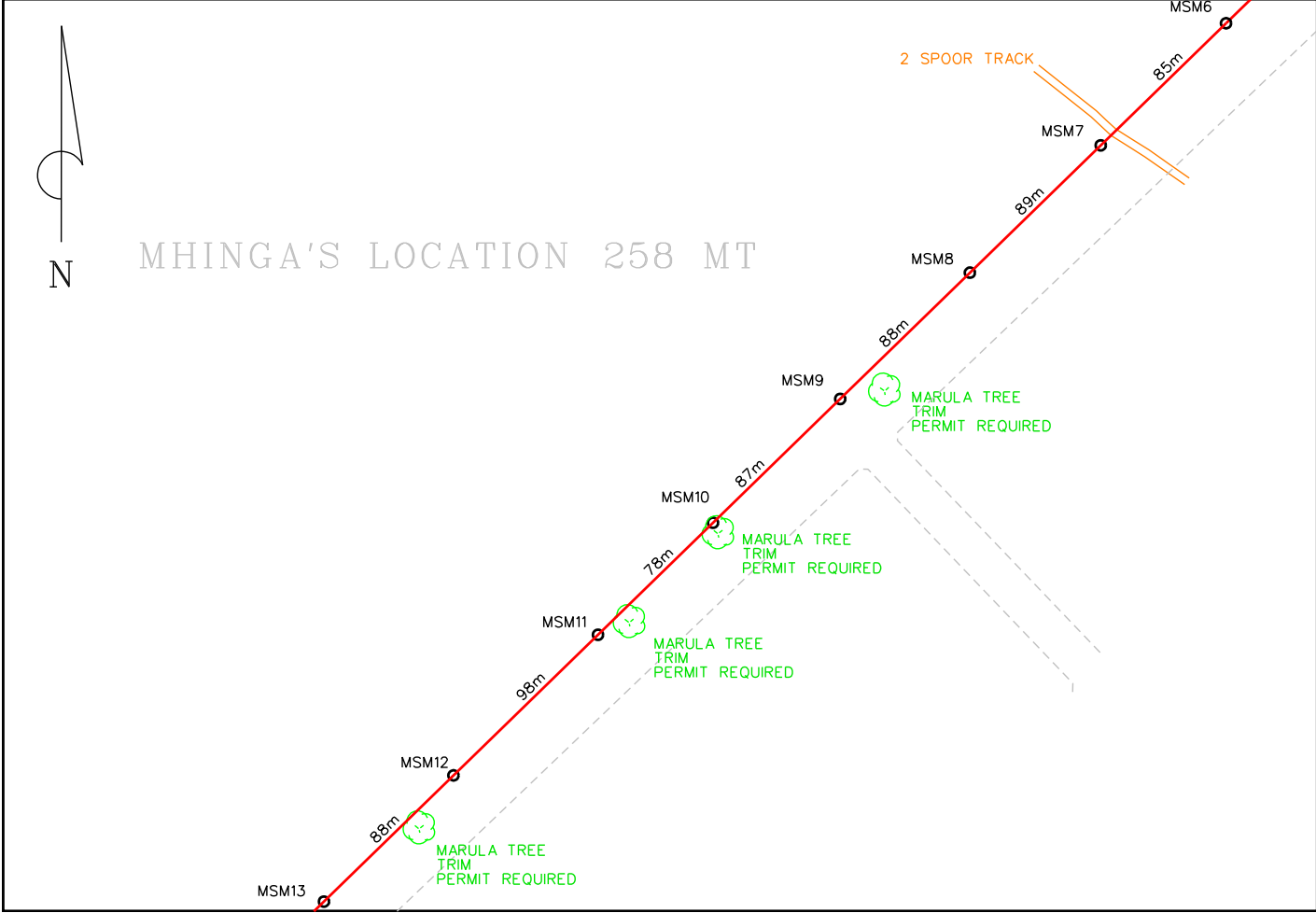



MHINGA'S LOCATION 258 MT

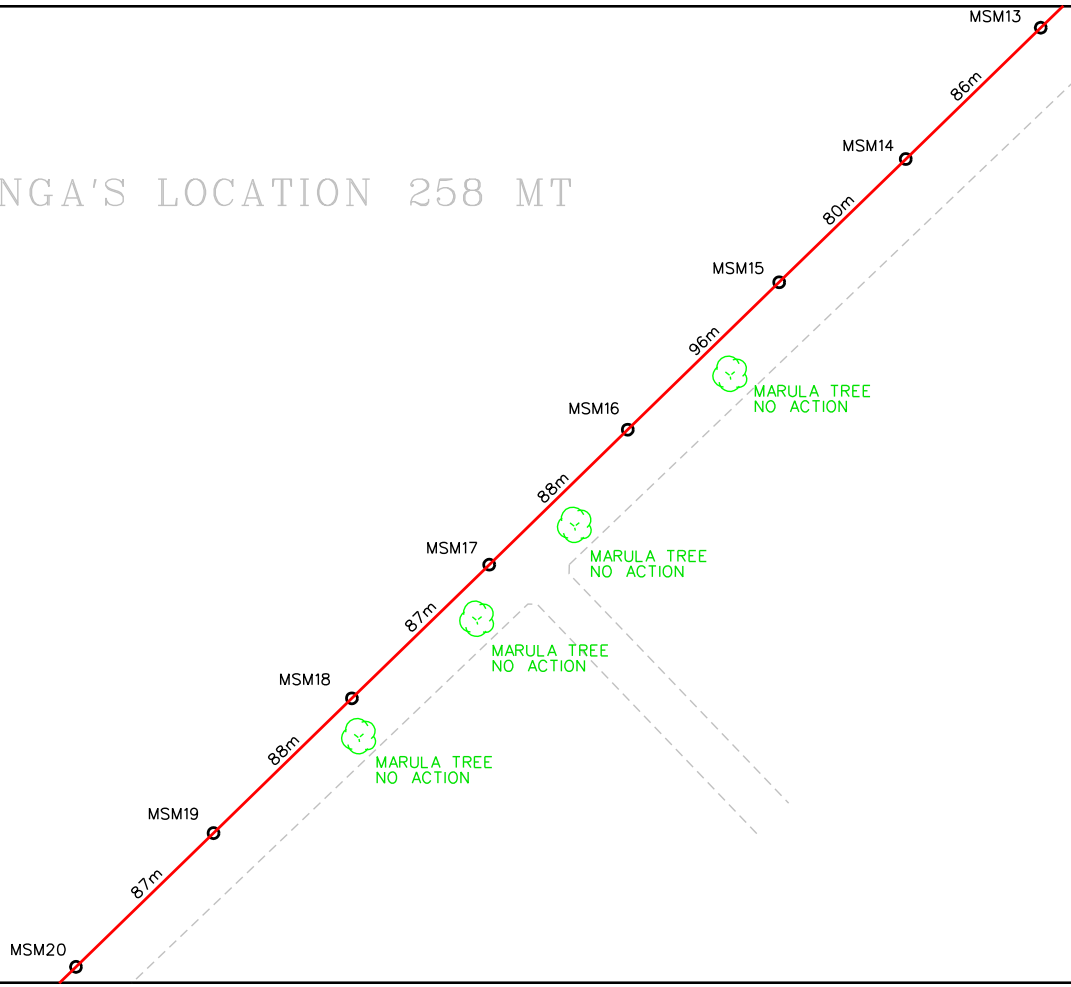

MHINGA'S LOCATION 258 MT

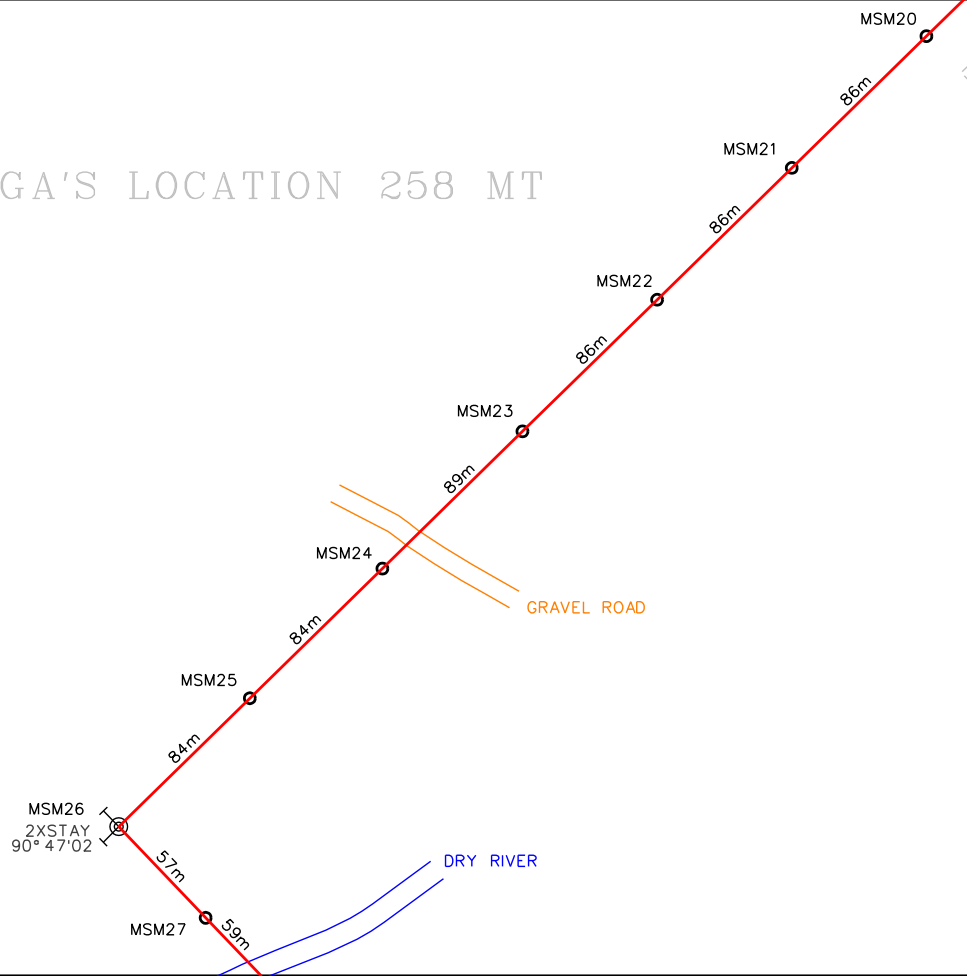

MHINGA'S LOCATION 258 MT

