

Newcastle Justice Complex Establishment of a Community Court Newcastle KwaZulu-Natal



Photo Documentation

Appendix A

General Information:

Magisterial District: Amajuba District Municipality.

GPS Coordinates: 27°45'20.49"S
29°55'55.30"E

Current use: Magistrates Court.

Owner: Local & Central Government.

Proposed work: Addition of new Court building. Restorations to existing buildings.



Image 1: Aerial View of Site (Google Earth 2012)

Motivation:

The National Department of Public Works have appointed MNI Architects to design the extension and upgrading of the current Newcastle Magistrates Court. The existing buildings on the site (older than 60 years) will be restored and renovated to accommodate support staff and the Family Court, pending approval by AMAFA, the buildings will be treated in a sensitive manner to retain heritage value. The alterations will be minimally invasive of the original structure. The following alterations are proposed:

Demolition of a few internal walls to provide space for doors; Addition of new internal walls; New finishes and fittings to allow for the accommodation of offices; A covered passage (connecting the existing building with the new buildings); as well as the Demolition of a portion of the Magistrates Court building (the cell block) that is regarded as an "insensitive" addition and does not fall within the heritage category.

This addition was done much later (around the 1980's) and does not add any significant value to the building. The existing Family Court (old Police Station) needs some major restoration work, especially on the roof. Our aim is to restore the existing buildings to their rightful glory and not apply any major changes to their structures.

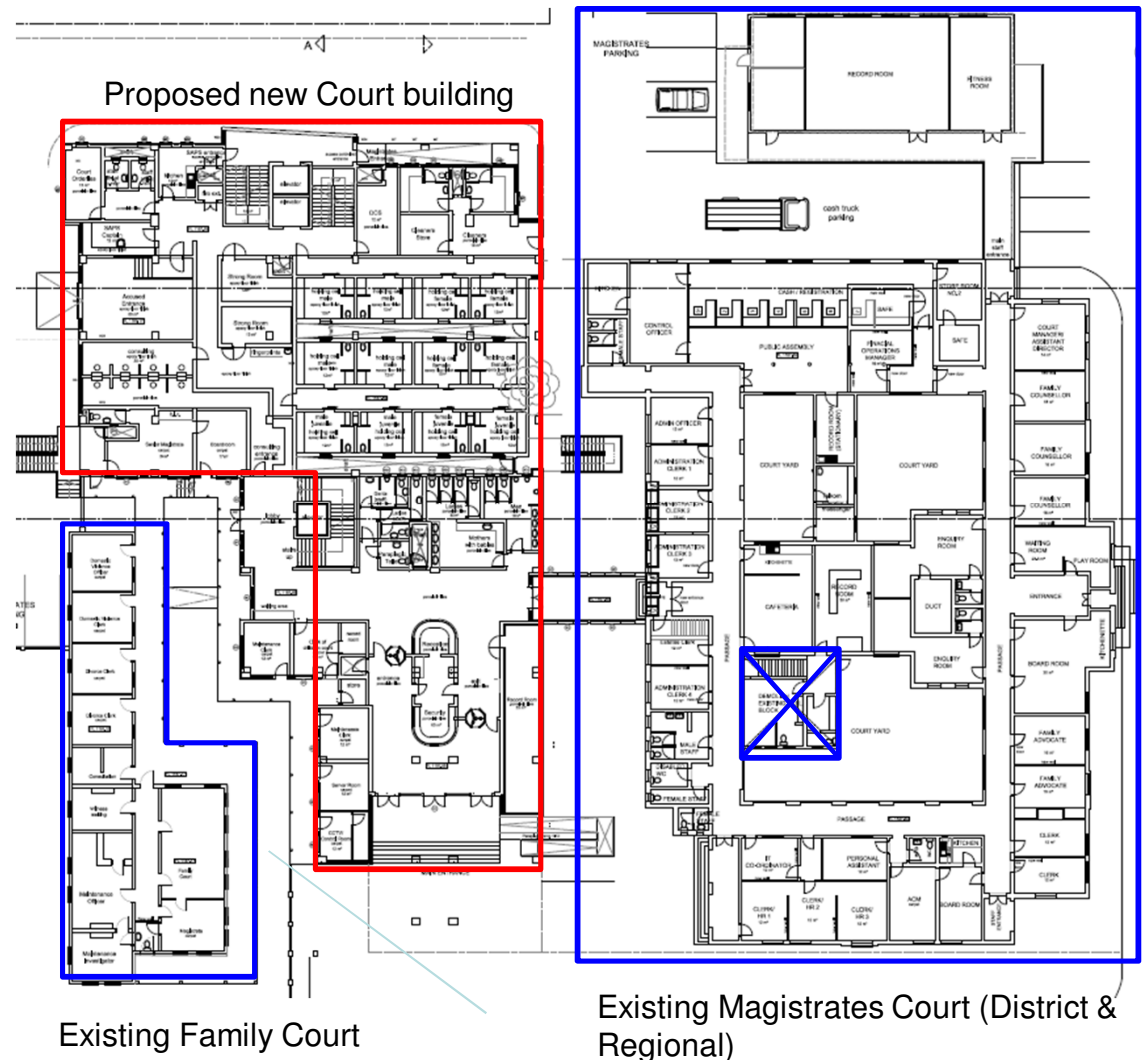

Floor Plan

North-West



Image 2: Street view of existing Family Court (Old Police Station)



Image 3: Elevation of the stoep area



Image 4: Family Court to be restored (old Police Station)

South-East



Image 5: Street View of Family Court Verandah (this part is a later addition).



Image 6: Main Building Family Court



Image 7: Northern view of Family Court building – original building



Image 9: North Eastern view – back of building

Elevations

Family Court – Old Police Station



Image 10: Entrance to existing Magistrates Court



Image 11: South Western View of pedestrian entrance



Image 12: South Easter Elevation – link between regional court building (later addition) and Magistrates Court



Image 13: North Eastern elevation of Magistrates Court and added Regional Court Building



Image 14: View from parking area towards Magistrates Court – South Western view



Image 15: Northern view of addition (to be demolished)

Elevations

Existing Magistrates Court



Image 16: Proposed area on site for new building – Note neighboring building at the back (3 to 4 storeys in height)



Image 17: Image illustrating the height of surrounding buildings



Image 18: New Municipal Buildings in progress



Image 19: View from Murchison street (main entrance) towards existing buildings



Image 20: View towards proposed parking area and Carnegie Art Gallery
At Eastern side of site



Image 21 & 22: Murchison street and Walkot Centre Commercial Area

Site and Surroundings