

**SOFT WINK PROPERTIES 126 (PTY) LTD**

**NOTICE OF PROSPECTING RIGHT APPLICATION IN TERMS OF SECTION 16 OF  
THE MINERALS AND PETROLEUM RESOURCES DEVELOPMENT ACT, 2002 (ACT  
28 OF 2002) ON PORTION 1 OF THE FARM HALFGEWONNEN 190 IS IN THE  
MAGISTERIAL DISTRICT OF BETHAL, MPUMALANGA**

**DMR Ref. No.: MP30/5/1/1/2/10844 PR**

August 2012

Att: Interested and Affected Parties,

Soft Wink Properties 126 (Pty) Ltd has submitted a prospecting right application in terms of Section 16 of the Minerals and Petroleum Resources Development Act (Act 28 of 2002) on Portion 1 of the farm Halfgewonnen 190 IS (title deed number: T57727/2002). The farm is situated roughly 23km north/north east of Bethal in the Gert Sibande District Municipality of Mpumalanga.

The mineral commodity applied for is code C: Coal

The prospecting work will consist of an initial phase of conventional diamond drilling resulting in a core size of 60mm in diameter (TNW) in order to assess the possible viability of the reserve. Drilling will be conducted on an adequate grid survey basis sufficient to aid in the compilation of a comprehensive Geological Report in accordance with the SAMREC Code. Accordingly, Robust Drilling and Exploration (Pty) Ltd have been appointed as relevant drilling contractors who have considerable experience in all fields of coal exploration. It is envisaged that a total of 6 cored boreholes will be drilled during Phase 1 in order to quantify the coal reserve in terms of the economic feasibility thereof. Borehole depth is expected to range from approximately 40 metres to 60 metres in order to intersect the 4 and 2 seams, if present.

Casing will be removed from the borehole on completion thereof and the borehole sealed in accordance with "Standard Borehole Sealing Procedure" i.e.: each borehole certificated in terms of this procedure. Borehole sumps will be rehabilitated in accordance with existing legislation and any extraneous material removed from site. Where water is to be used for drilling purposes this will be managed in accordance with the surface owners' permission to draw from existing water points.

Drilling personnel (4) will be housed in caravans on site during the prospecting phase and will make use of sanitary chemical toilets and all such waste disposed of via the approved manner. Potable / drinking water will be provided to the drill crew by the Contractor.

Cabanga Concepts cc have been contracted as the independent environmental consultants appointed to conduct the necessary studies and oversee the various processes required in accordance with the Act listed above.

You are hereby invited to register as an Interested & Affected Party and to participate in the Public Participation Process. Should you have any comments, concerns or queries with regards to this project please do not hesitate to contact us on the following:

Ian Troskie – Cabanga Concepts

E-mail: [Ian@cabangaconcepts.co.za](mailto:Ian@cabangaconcepts.co.za)

Postnet Suite 470,

Private Bag X3,

Northriding,

2162

Fax: 011 794 6946

# SOFT WINK PROSPECTING RIGHT APPLICATION ON PORTION 1 OF HALFGEWONNEN 190 IS: RESPONSE SHEET

Please assist us by filling this response sheet and returning it by fax, to (011) 794 6946

## Question 1: Personal Information

Name and Surname

Farm Name/Organisation

## Question 2: Please specify what aspects of the project you are interested in.

Please tick (✓) one (1) of the following:

All aspects

Eco-tourism

Air pollution, noise, dust visual pollution

Ground and/or surface water pollution

Natural habitat: land and animal Life

Health, safety and security

Other (please specify)

☐

Employment opportunities

☐

Business opportunities

☐

Local economic development

☐

Mine closure and rehabilitation

☐

Future of your town

☐

Please specify the town:

☐
☐
☐
☐
☐
☐

## Question 3: Are you aware of any of the following with regards to the proposed project (please specify details below):

Please tick (✓) which is applicable and detail below (if need be please attached separate page):

Potential Physical Impacts

Potential Social Impacts

Potential sites of cultural significance (potential heritage sites, graves etc.)

Rare or endangered animals and / or plants

☐
☐
☐
☐

## Question 4: Are there any other questions or concerns that you have about the project?

[Kindly specify below and the project team will respond to these in due course]

## Question 5: Are there any other parties or organisations that you think should know about the project?

## Question 6: Do you want to be kept informed about the future stages of this study and remain registered as an I&AP?

Please tick (✓) one (1) of the following:

No thank you!

☐

Yes please!

☐

Tel:

Fax:

Cell:

Email:

Postal Address:

# AREA FOR PROSPECTING RIGHT APPLICATION (PRA) HALFGEWONNEN 190 PTN 01

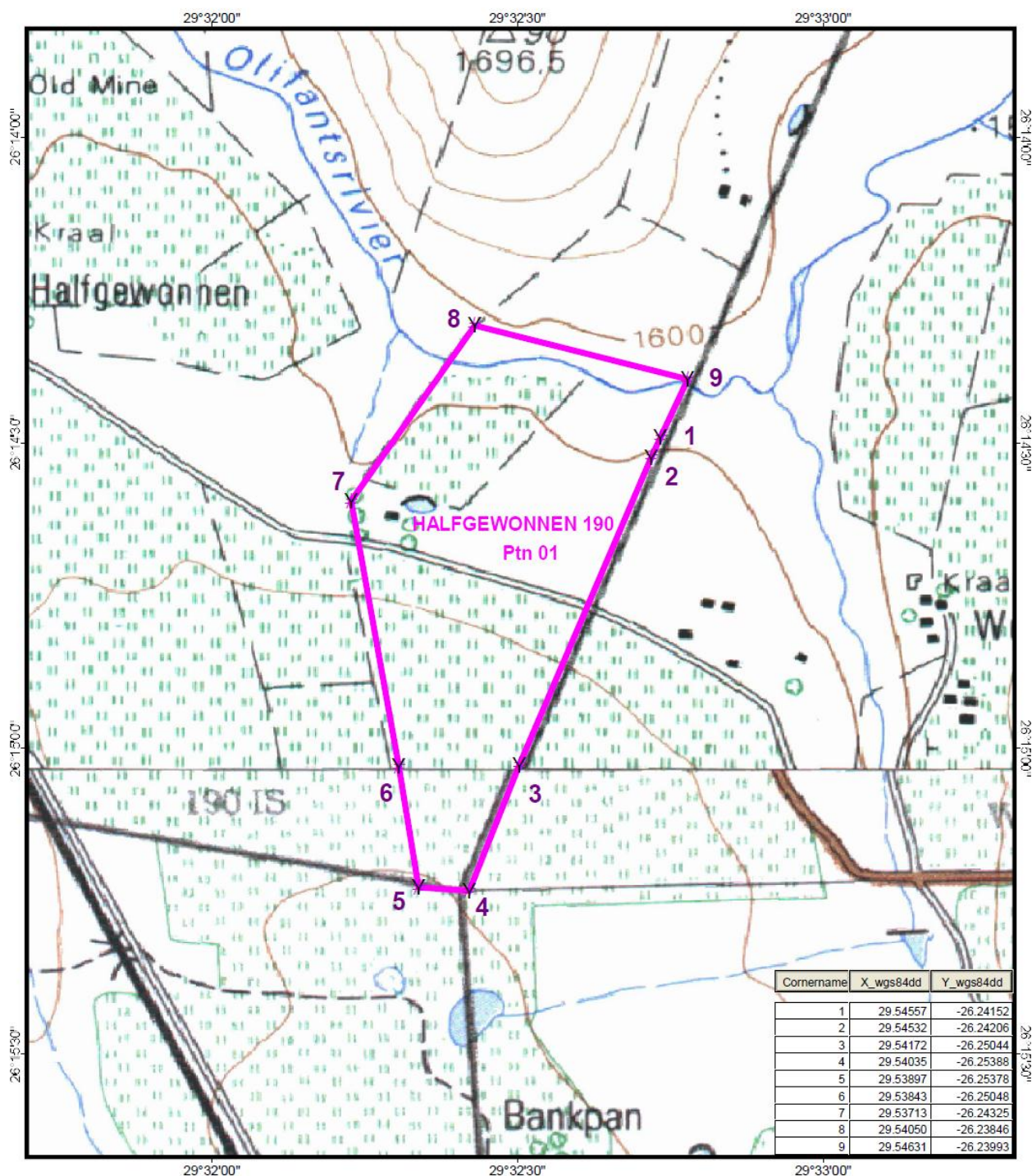

## LEGEND:

- Y Corners
- Farm for PRA
- Image Wgs2629ba.tif
- Image Wgs2629bc.tif

Sg_code	Farmname	Farmno	Subdivno	Hectares
T0IS0000000019000001	HALFGEWONNEN	00000190	00001	84.678

Two sheets from Surveyor General of 2007.  
(SHT between 2 sheets) as received.  
Cadastral data from Surveyor General MP 2006.

Coordinates derived from this existing  
GIS cadastral dataset  
- not physically surveyed  
- therefore an estimation only  
MC Swart accepts no liability  
for the inaccuracy, incompleteness,  
or non usefulness of any data used  
on this map.

*[Signature]*

M.C. SWART Pr.Gisc. (PGP0041)  
(GIS Specialist)

Applicant: Soft Wink Properties (Pty) Ltd Date

Department of Minerals and Resources

Figure 1

0.2 0 0.2 Kilometers



Project: Soft Wink Properties PRA

Date Printed: 14/7/2012

File: G:\Projects\Mpumalanga\Hendrina\SoftWink\_Properties\APR  
lpra\_softwink\_20120714\_fg1\_final.apr

Datum: WGS84  
Spheroid: WGS84  
Projection: Geographic

Marna Swart  
GIS Specialist, KookGIS  
Cell 083 456 3739  
Email: kookgis@bigfoot.com



© Copyright MC Swart