

SITE PLAN

SHEET 1/6 COPY 1
ETHEKWINI MUNICIPALITY
 (CENTRAL)
 194 02 10
 APPLICATION NO.

BUILDING APPLICATION
 APPROVED in terms of Section 7 of The National Building Regulations and Building Standards Act No. 103 of 1977
 15 APR 2010
 LOCAL AUTHORITY
 DATE: This plan is approved on the basis of the information shown herein. Attention is drawn to the attached documentation & that this approval shall lapse ONE year after the above approval date, unless the erection of the building in terms of ASR Act 103 of 1977 is commenced.

GENERAL NOTES :

- ROOF:**
- GANGNAILED ROOF TRUSSES TO SPEC. DETAILS, PITCH 35°
 - PROVIDE 114 X38 WALL PLATES TO EXTERNAL WALLS ONLY.
 - PROVIDE 38X38 TILTING BATTERNS
 - PROVIDE ROOF PLASTIC, TO SABS STD.
 - PROVIDE DOUBLE ROOF TILES TO MATCH EXISTING.
- ALL RAINWATER GOODS TO BE SEAMLESS PREPAINTED ALUMN.
 - FASICA BOARDS TO BE PREPAINTED ALUMN.
 - RAINWATER DOWNPIPES TO BE SEAMLESS BOX SECTIONS.
- WALLS :**
- WALLS TO BE BOTH PLASTER AND PAINT AND FACERICKS AS PER DRAWINGS.
 - COLOUR AND TYPE OF FACEBRICKS TO ARCH. SPEC.
 - PROVIDE BRICKFORCE AT DOOR HEAD AND WINDOW CILL HEIGHTS.
 - INNER SKIN OF ALL FACEBRICK WALLS TO BE BAGGED AND SEALED TO ARCH. APPROVAL.
 - PROVIDE BRICK ON EDGE TO ALL OPENINGS TO FACEBRICK WALLS.
 - EXTERNAL WINDOW CILLS TO BE BRICK ON EDGE 60°.
 - PROVIDE PC LINTOLS TO ALL OPENINGS TO PLASTERED WALLS.
- WINDOWS:**
- ALL WINDOWS TO BE EPOXY POWDER COATED ALUMN. WITH FIXED AND OPENING SECTIONS AS SHOWN ON ELEVATIONS.
- DOORS:**
- TIMBER SOLID DOORS AND FRAMES - EXTERNAL
 - ALUMN. SLIDING DOOR - EXTERNAL
 - SEMI SOLID DOORS - INTERNAL
 - ALL TIMBER DOORS AND FRAMES TO BE PAINTED - COLOUR TO ARCH. SPEC.
- FLOOR FINISHES:**
- AS PER FLOOR PLAN
 - MAKE PROVISIONS IN THE FLOOR LEVELS, FOR THE VARIES FINISHES.
- FLOOR SLAB:**
- 100mm CONCRETE FLOOR SLAB - BRC MESH.
 - ON, DPM ON 50mm SANDBLINDING, 150mm WELL COMPACTED (95 MOD ASH) EARTH.
 - FIRST FLOOR SLAB TO ENG. DETAILS.
- * ALL RETAINING WALLS AND FOUNDATIONS TO RET. WALLS TO ENG. DETAILS.
 * ALL PLUMBING TO BE INSTALLED AS PER NRB.
 * ALL LEVELS TO BE CONFIRMED ON SITE.

EXISTING OUT-BUILDING TO BE DEMOLISHED ALL SERVICES TO BE TERMINATED AND BLOCKED OFF

SITE AREA	780m²
EXISTING DWELLING	165.0m ²
EXISTING OUTBUILDING (demolished)	-39.0m ²
PROPOSED DWELLING	147.4m ²
PROPOSED GARAGE	35.0m ²
TOTAL ADDITIONS	182.4m²
TOTAL	308.4m²
PROPOSED FAR COVERAGE	147.4m ²
PROPOSED COVERAGE	108.6m ²
TOTAL FAR COVERAGE	263.4m²
TOTAL COVERAGE	283.7m²

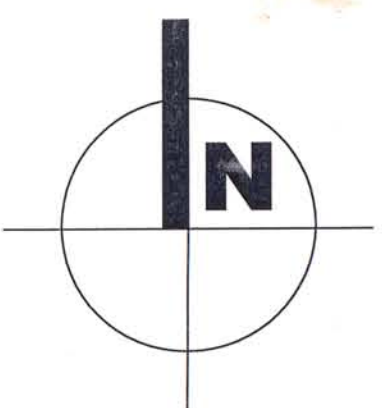
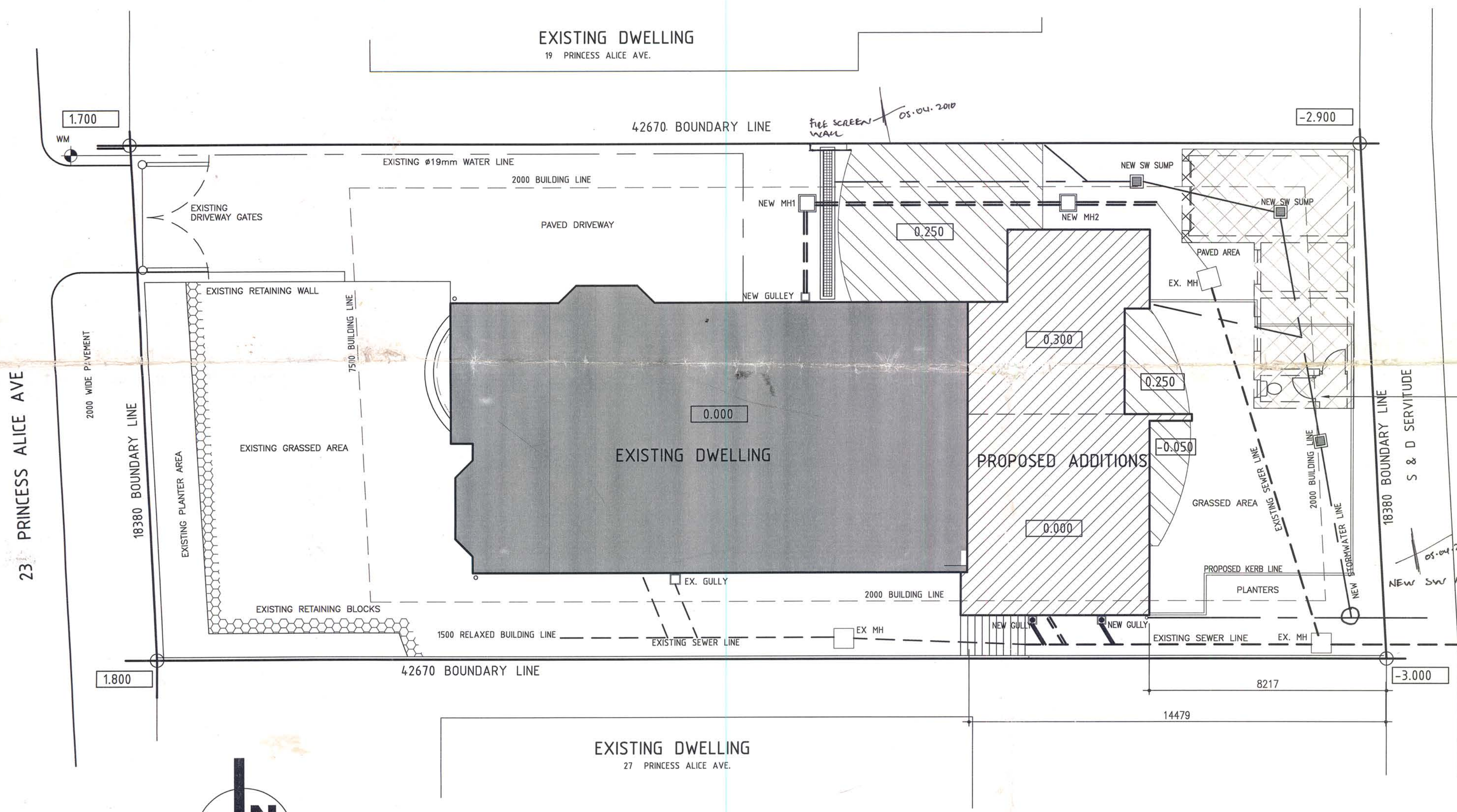

SITE PLAN
 SCALE 1: 100

THIS DRAWING IS THE PROPERTY OF DESIGN SQUARE COPYRIGHT PATENTS AND ALL INDUSTRIAL RIGHTS RESERVED

No.	DATE	INIT.	REVISIONS

- GENERAL**
- ALL WRITTEN DIMENSIONS TO TAKE PREFERENCE OVER SCALED DIMENSIONS
 - ALL LEVELS AND DIMENSIONS TO BE CHECKED ON SITE BEFORE ANY WORK COMMENCES

15a KILLIN ROAD
 WESTVILLE, DURBAN
 TEL: 031 2623960
 CELL: 082 5529 234

d e s i g n
S Q U A R E

PROJECT
 ERF 5246 DURBAN
 23 PRINCESS ALICE AVENUE
 GLENWOOD
 DURBAN

RATE NUMBER : 03-15055080-0

PROPOSED ADDITIONS AND ALTERATIONS

SITE PLAN

CLIENT **Mr A Naidoo & Ms K Reddy**

SIGNED *[Signature]*

DESIGNED	NA
PROF. REG. NO.	ST 1463
DRAWN	NA
CHECKED	KB
DATE	OCT 2009
CAD REF.	0514-0-001
ARCHITECTURAL DRAWING No.	001 000
	DS0519