

REVISION	DATE	AMENDMENTS

ALL WORK TO BE DONE IN ACCORDANCE WITH THE NBR
 FIGURED DIMENSIONS TO BE TAKEN IN PREFERENCE TO SCALED DIMENSIONS. REPORT ANY DISCREPANCIES DIRECT TO THE ARCHITECT BEFORE COMMENCING WORK
 THIS DRAWING IS COPYRIGHT AND REMAINS WITH THE ARCHITECT

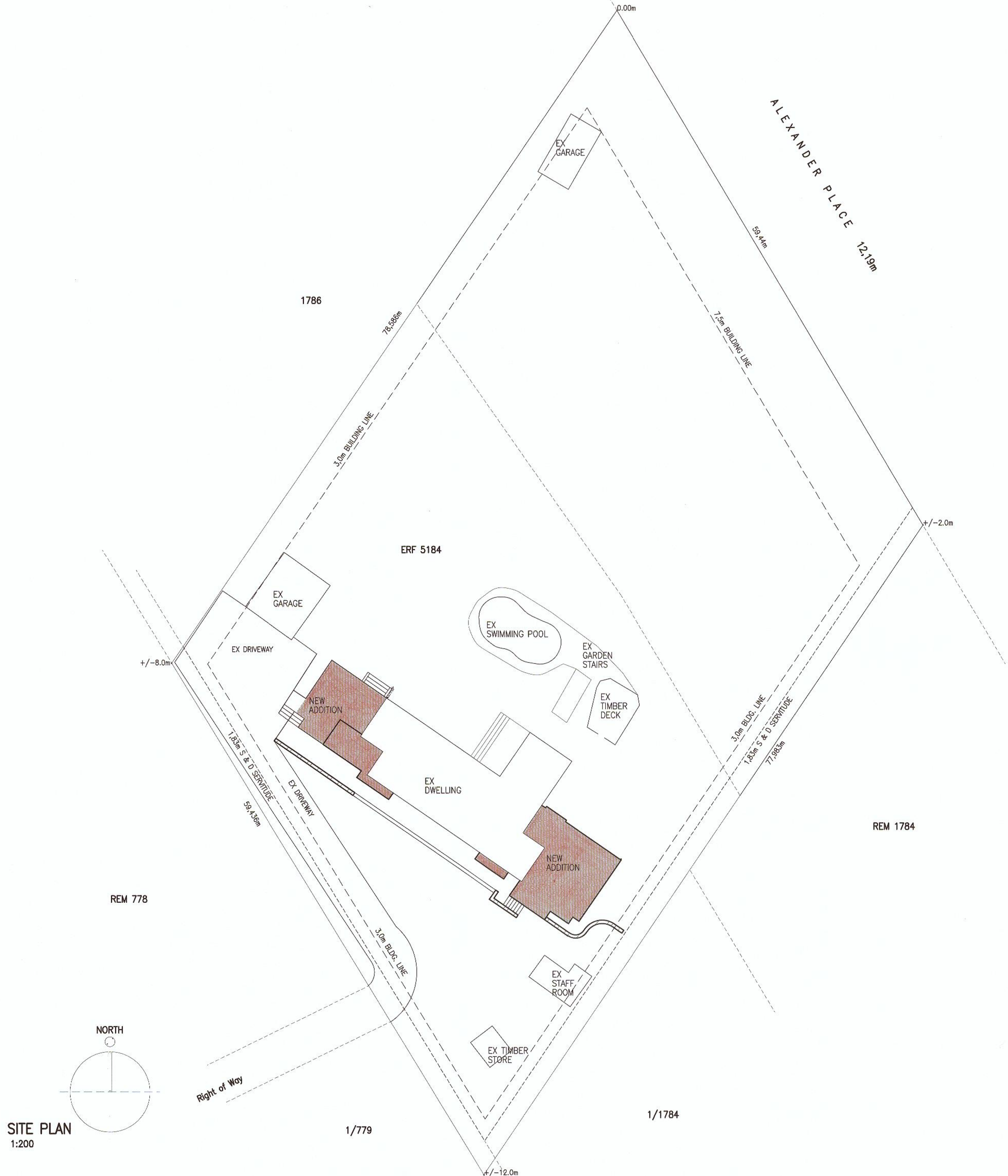

OWNER'S SIGNATURE: *C. Oelofse*
 ENGINEER'S SIGNATURE:
 ENGINEER'S SIGNATURE:
 ARCHITECT'S SIGNATURE: *J. Forster*

PROJECT
PROPOSED ALTERATIONS & ADDITIONS TO EXISTING DWELLING ON ERF 5184 KLOOF, 5 KRANTZVIEW ROAD FOR CATHERINE GRACE OELOFSE

DRAWING
 SAHRIS SUBMISSION DRAWINGS
 SITE PLAN

SCALE: 1:200 DATE: MAY 2013 DRAWN: JF

PROJECT NO: COMS 1 DRAWING NO: COMS 1 01 REVISION: PAGE 1 OF 3

FORSTER FORD
 ARCHITECTS
 30a KENILWORTH DRIVE
 KLOOF
 3610
 TEL: 7645932, 7645319, 0847486235
 SACAP REG. NO. 7355 JANET FORSTER
 email : jforster@mweb.co.za

SITE PLAN
 1:200