

Demolish existing Ocean Terminal offices and helicopter hanger facility
shown dotted and provide new car stacking for car terminal

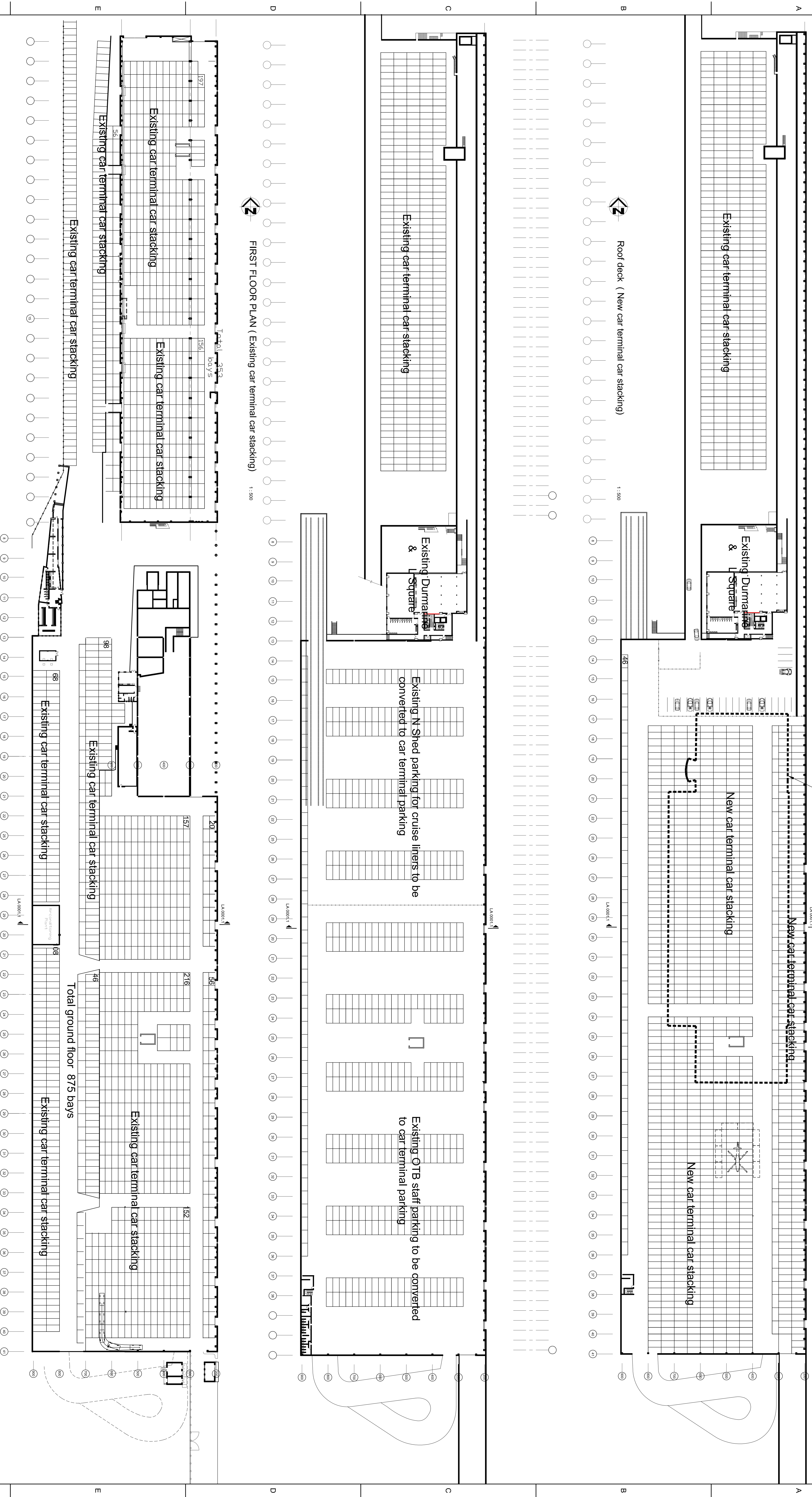

GROUND FLOOR PLAN (Existing car terminal car stacking) 1:500

FIRST FLOOR PLAN (Existing car terminal car stacking) 1:500

- NOTES
1. DO NOT SCALE DRAWING - ONLY DIMENSIONS SHOWN TO BE USED.
 2. THE CONTRACTOR SHALL VERIFY ALL CONDITIONS, DIMENSIONS AND LEVELS ON THE SITE AND NOTIFY THE SUPERVISOR OF ANY VARIATIONS BEFORE COMMENCING WORK.

APPLICATION FOR AMARA APPROVAL

DRAWING NO.		REFERENCE
DRAWING NO.		REFERENCE

NO.	REVISIONS	DATE	BY	CHKD	APPD	DATE

CONTRACTOR/CONSULTANT		TRANSMET GROUP CAPITAL	
NAME	SON	NAME	SON
DATE	DATE	DATE	DATE

DESIGNED	
CHECKED	

PR ENG / PR TECH / PR ARCH	

PROJECT NUMBER	

CAR TERMINAL EXPANSION
CONVERSION OF OCEAN TERMINAL BUILDING TO
CAR TERMINAL ADDITIONAL PARKING
Layout Plans
PORT OF DURBAN
T JETTY
TRANSMET
Group
Tel: 031 961 9666
Fax: 031 961 9665