

Reference	CAD-Line Survey-LOU
Effective Date	15/10/2015
Revision	01

Portion 1 (Remaining Extent) of Pankoppen 36 JR

**Bush Clearing required (70%)
Sandy soil
Beware of Water pipes**

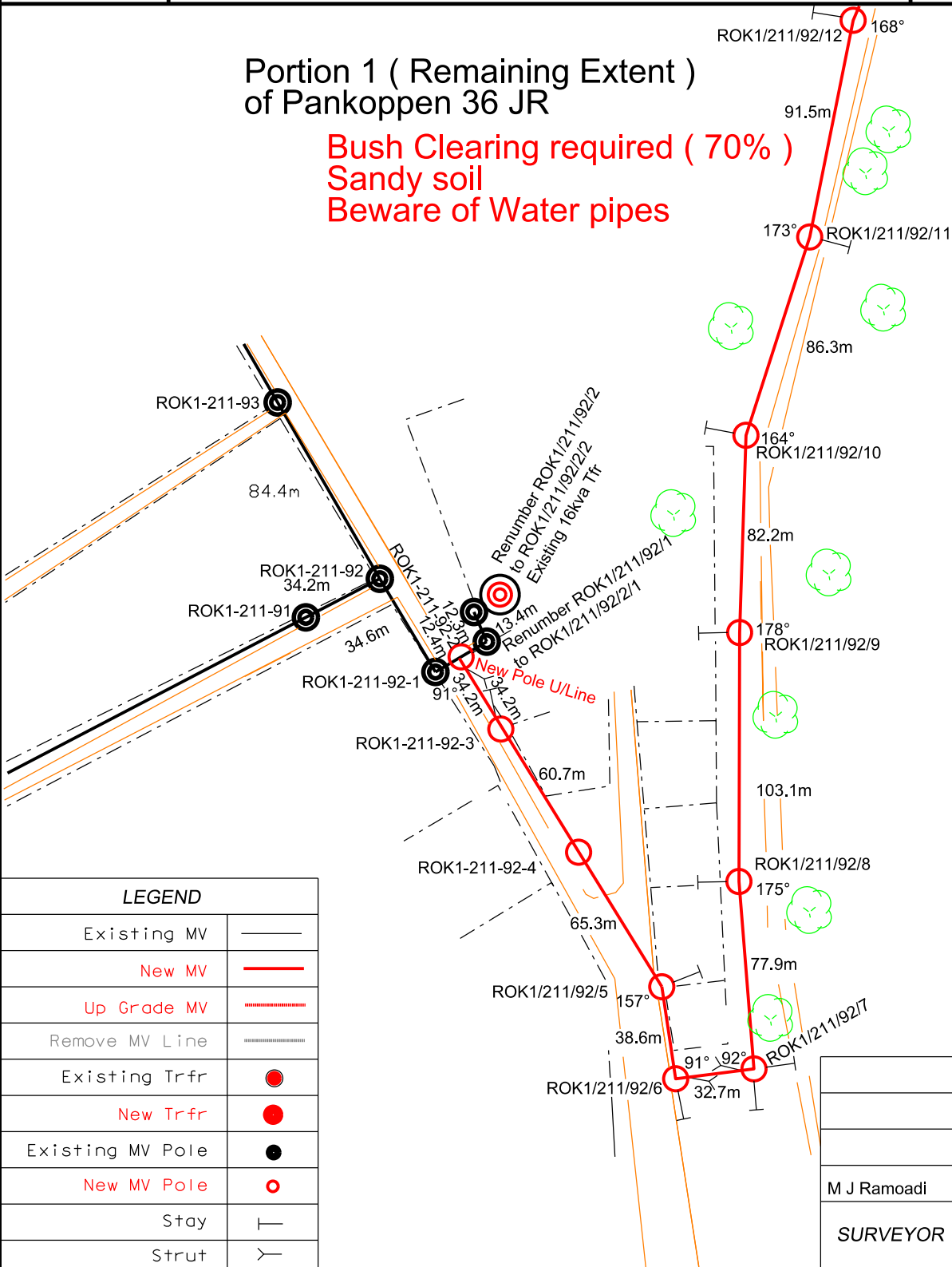

LEGEND

Existing MV	—
New MV	—
Up Grade MV	—
Remove MV Line	—
Existing Trfr	●
New Trfr	●
Existing MV Pole	●
New MV Pole	○
Stay	—
Strut	—

	3	
	2	
	1	
M J Ramoadi	0	12/05/2022
SURVEYOR	REV	SURVEY DATE

FEEDER: Okamelang 22kv
PROJECT NO: ROK-WR Interconnector
CONDUCTOR:
LENGTH OF LINE: 2 644.2m
SURVEYOR: Cheetah Surveyors
DRAUGHTSPERSON: M J Ramoadi

CUSTOMER: Eskom
PROPERTY: Portions 4 & 5 of Turflaagte 35 JR and Portion 1 (Remaining Extent) of 36 JR
CONTACT DETAILS 081 551 9682
SCALE: 1 : 2500
PAGE: 1 of 4

THIS DRAWING IS THE PROPERTY OF ESKOM
Disclaimer: Eskom is not responsible for any errors displayed on this drawing

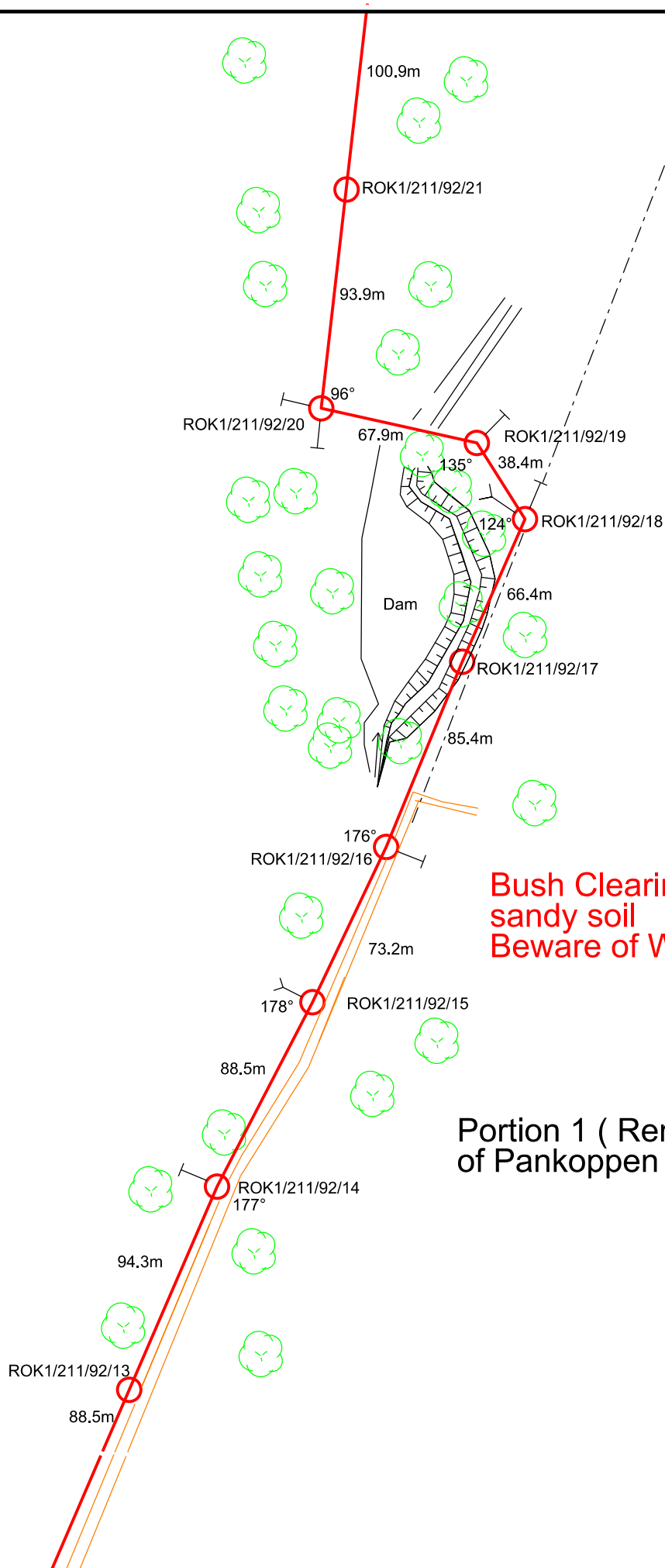

**Bush Clearing required (80%)
sandy soil
Beware of Water pipes**

**Portion 1 (Remaining Extent)
of Pankoppen 36 JR**



Portion 1 (Remaining Extent) of Pankoppen 36 JR

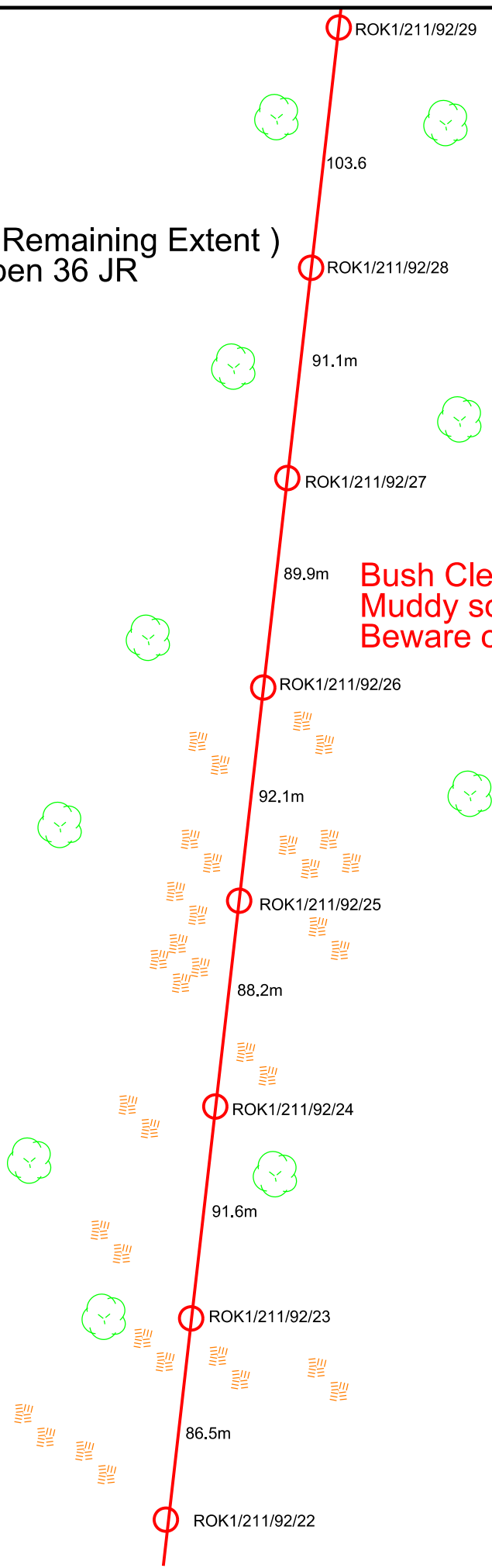

**Bush Clearing required (90%)
Muddy soil during rainy season
Beware of Water pipes**



Portion 4 of Turflaagte 35 JR

Portion 5 of Turflaagte 35 JR

Maize Field
Muddy soil

Portion 1 (Remaining Extent)
of Pankoppen 36 JR

Bush Clearing required (90%)
Muddy soil during rainy season
Beware of Water pipes

