

Reference	CAD-Line Survey-LOU
Effective Date	15/10/2015
Revision	01

Description	Quantity
Shrubs > 40 cm	
Trees	
Trees to Trim	
Bushclearing required (m)	

**RWW513658848**  
**F AND R FARMING CC**  
**PORTION 15 AND 31 VAALBOSCHKUIL 66 JR**

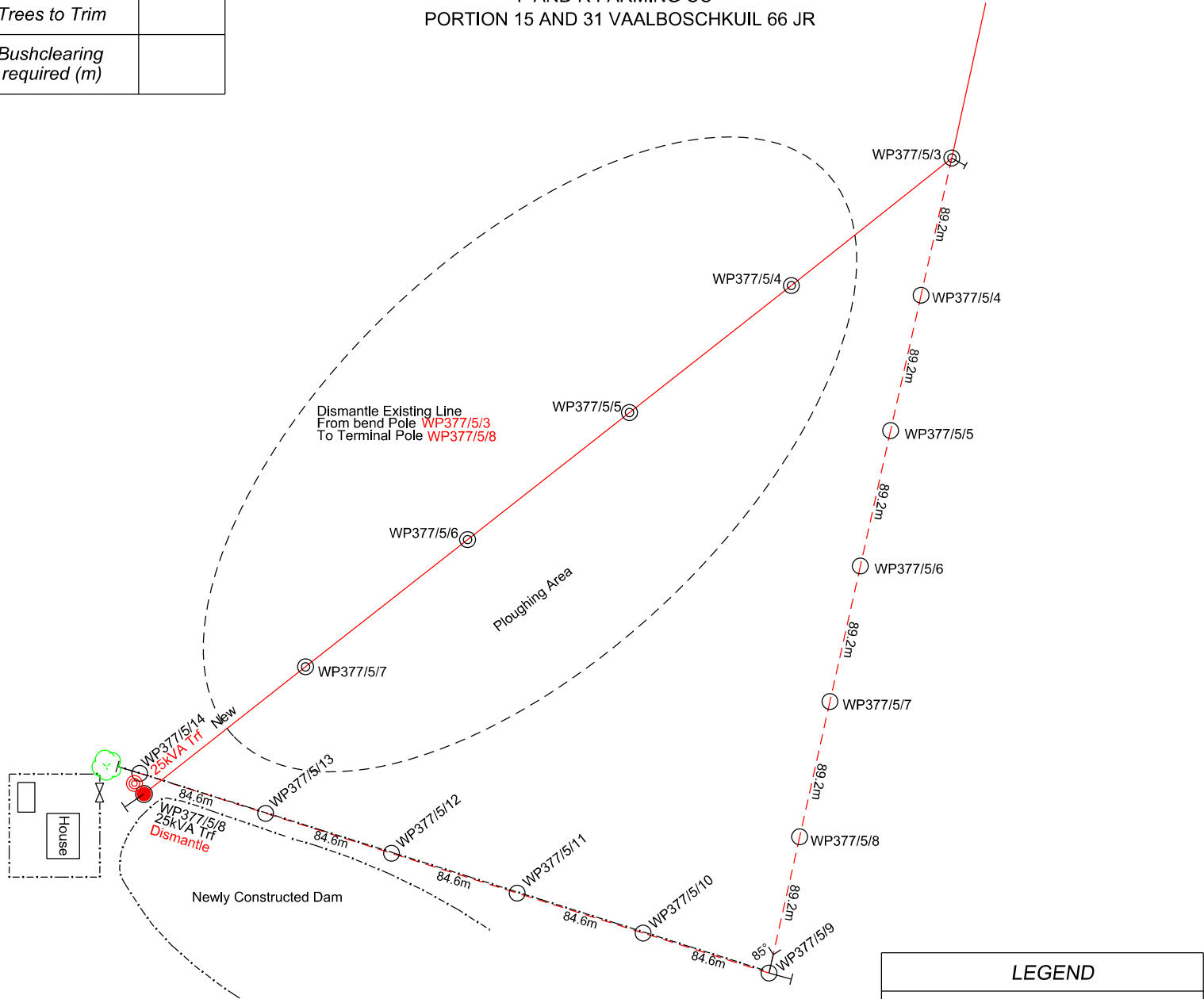

	3	
	2	
	1	
T M Lebea	0	25/08/2022
<b>SURVEYOR</b>	<b>REV</b>	<b>SURVEY DATE</b>

LEGEND	
	New Pole
	New Transformer
	Existing Pole
	Existing Transformer
	New Line
	Existing MV Line
	Tree

<b>FEEDER:</b>	WARMBRON-PIENAARS 22kV
<b>PROJECT NO:</b>	RWW513658848
<b>CONDUCTOR:</b>	( 3 Phase)
<b>LENGTH OF LINE:</b>	958m
<b>SURVEYOR:</b>	Tshepo Lebea
<b>DRAUGHTSPERSON:</b>	Tshepo Lebea

<b>CUSTOMER:</b>	F AND R FARMING CC
<b>PROPERTY:</b>	PORTION 15 AND 31 VAALBOSCHKUIL 66JR BELA-BELA/PIENAARS RIVIER
<b>CONTACT DETAILS</b>	+2764 517 4825
<b>SCALE:</b>	[1:2 500]
<b>PAGE:</b>	[1] of [1]

**N**

THIS DRAWING IS THE PROPERTY OF Eskom  
 Disclaimer: Eskom is not responsible for any errors displayed on this drawing