



AREA: <u>BELABELLA LOCAL MUNICIPALITY</u>	PROJECT NUMBER: <u>RZ-WL INTERCONNECTOR</u>
FEEDER: <u>Warmbron/Lehau</u>	ITEM <u>1</u> OF <u>2</u>
SUPPLY TO: <u>ESKOM</u>	
ESKOM REPRESENTATIVE: <u>M.J. RAMBADI</u>	TEL: <u>0815519682</u>
DISTRIBUTION	Email: <u>rambadij@gmail.com</u>

**WAYLEAVE CONTRACT  
POWERLINE AND/OR CABLE AND ASSOCIATED INFRASTRUCTURE**

**1. GENERAL**

**1.1 Identification of parties:**

1.1.1 Contractor means any entity appointed as an independent contractor to execute works on the Property in the exercise of the Rights, as set out herein.

1.1.2 Eskom means Eskom Holdings SOC Ltd, a public company with registration number 2002/015527/30 with its head office at Megawatt Park, 2 Maxwell Drive, Sunninghill, Sandton.

1.1.3 Owner means Reint Dykema & Seuns PTY LTD  
(ID 04/01373/07), a company / close corporation / trust / partnership / natural person / Government department / tribal authority of

λ address DE KUIL 28 JR,

× Postal Code 0420, Tel No. 0828918823 herein represented

× by HENDRIK DYKEMA in my capacity as

× OWNER/DIRECTOR of REINT DYKEMA & SEUNS,

γ (ID 5710055012081), who through signature here below, warrants his or her authority to sign on behalf of the Owner.

1.1.4 Property means: Portion 5 of De Kuil 28 JR

Title Deed No.: T26284/1961PTA Extent: 481,0067 H

Local Authority: Bela Bela Local Municipality

**2 THE RIGHTS**

2.1 The Owner grants, generally, an irrevocable right (herein the "Rights"), in perpetuity and free of charge, to Eskom and over the Property, for the distribution and transmission of electricity and related purposes, substantially along the route indicated by letters A B C D on the attached sketch plan, comprising an area of nine meters on either side of the centre line of the Goods, once they are built (the "Wayleave Area"), and the Rights include those set out in paragraph 0 hereof.

x

x

HD

x HD  
x

- 2.2 To the extent necessary to give effect hereto, the Owner's spouse, Lessee and/or Usufructuary agrees to the granting of the Rights by signing below.
- 2.3 The Rights, specifically, include the rights to:
- 2.3.1 convey electricity and telecommunication across the Property;
  - 2.3.2 erect structures, conductors, cables, appliances and, without limitation, everything else as may be necessary or convenient in exercising the Rights (herein referred to as the "Goods") and the Owner agrees that structure-supporting mechanisms may reasonably extend beyond the Wayleave Area where it is necessary to safely secure the Goods;
  - 2.3.3 enter and be upon the Property at any time in order to construct, erect, operate, use, maintain, repair, re-erect, alter or inspect the Goods or in order to gain access to any adjacent property in the exercise of rights similar to the Rights;
  - 2.3.4 have these Goods remain on the Property for so long as either Eskom or the Owner requires them to;
  - 2.3.5 extend the Goods to other customers, suppliers or contracting parties of Eskom, over the Property;
  - 2.3.6 use existing roads and gates giving access to and running across the Property and to erect in any fence such gates as may be necessary or convenient to gain access to or exit from the Property and the Goods or in order to gain access to any adjacent property in the exercise of rights similar to the Rights;
  - 2.3.7 remove any material or structures, and cut or trim any tree, bush or grass within the Wayleave Area or to the extent necessary where the Goods extends beyond the Wayleave Area, in order to comply with the restrictions referred to in paragraph 3.2 hereof;
  - 2.3.8 every ancillary right necessary or convenient for the proper exercise of the Rights granted to Eskom; and
  - 2.3.9 At Eskom's election, have this wayleave registered as a servitude against the title deed of the Property.
- 2.4 The Rights will apply to all electricity infrastructure on the Property and the area which such infrastructure covers will be deemed to be included in the Wayleave Area and/or Restricted Area. It is agreed that the Owner herewith grants permission for all electricity infrastructure on the Property to remain on the Property.
- 2.5 Any expenses to be incurred, which are necessitated by a change to or removal of the Goods in the Wayleave Area required by the Owner, are for the Owner's account and must be paid for by the Owner in advance. Eskom will effect such changes or removals after receipt of such payment, if such changes or removal are technically possible.
- 2.6 The Contractor may exercise any of the Rights.
- 2.7 Eskom may:
- 2.7.1 let any portion of the Goods to any third party on such conditions as Eskom may deem fit;
  - 2.7.2 cede all or any of the Rights granted in terms of this Wayleave to any third party.

X  
X

HD  
me

### 3. THE OBLIGATIONS

3.1 Eskom must:

3.1.1 ensure that any of Eskom's gates that it had used is closed after use;

3.1.2 pay reasonable compensation for intentional damage or damage caused through a negligent act or omission, caused by Eskom, its employees or agents in pursuit of the Rights, save where Eskom is acting in accordance with sub-clause 2.3.7 of this document; and

3.1.3 where a Contractor exercises the Rights, ensure that the Contractor complies with the obligations contained in this sub-clause 3.1.1.

3.2 The Owner must ensure that no:

3.2.1 building or structure is erected or installed above or below the surface of the ground within the Wayleave Area and no tree or bush is planted within the Wayleave Area or within nine metres from any structure-supporting mechanism (the "Restricted Area");

3.2.2 tree, which could grow to a height in excess of the horizontal distance of that tree from the nearest conductor of any power line is planted or allowed to continue growing, regardless if it is outside of the Wayleave or Restricted Area;

3.2.3 material which may in the opinion of Eskom endanger any electricity infrastructure is placed within the Wayleave or Restricted Area.

3.3 The Owner must bring the existence of this wayleave contract to the attention of any purchaser or other transferee of the Property (or of any portion of the Property) before the Property (or any portion thereof) is sold and/or transferred to such purchaser or transferee, or if the Owner grants any further rights in or to the Property to any other third party, to such third Party.

3.4 The Owner must inform Eskom in writing if it is going to sell the Property.

3.5 The Owner's attention is drawn to the provisions of section 10.17.1 of the regulations promulgated in terms of the Explosives Act 26 of 1956, which prescribes that when blasting is to be done within 500 (five hundred) metres of any electricity infrastructure, written confirmation must first be obtained from Eskom concerning the protection of electricity infrastructure.

### 4. SPECIAL REMARKS

---

---

---

---

---

---

---

X

X

*[Handwritten signature]*

110

X Signed at DE WIL on 13 of MAY 2022.

X The Owner [Signature]

[Signature]  
Witness 1

[Signature]  
Witness 2

X Signed at \_\_\_\_\_ on \_\_\_\_\_ of \_\_\_\_\_ 20\_\_\_\_.

X Spouse of the Owner if married in community of property or second owner

\_\_\_\_\_  
Witness 1

\_\_\_\_\_  
Witness 2

Signed at \_\_\_\_\_ on \_\_\_\_\_ of \_\_\_\_\_ 20\_\_\_\_.

\_\_\_\_\_  
Tribal Authority

\_\_\_\_\_  
Witness 1

\_\_\_\_\_  
Witness 2

Stamp:

Signed at \_\_\_\_\_ on \_\_\_\_\_ of \_\_\_\_\_ 20\_\_\_\_.

\_\_\_\_\_  
Eskom Holdings SOC Limited

\_\_\_\_\_  
Witness 1

\_\_\_\_\_  
Witness 2

[Signature] [Signature]



# WAYLEAVE AGREEMENT SKETCH

Reference	EAD Wayleave LOU
Effective Date	15/10/2015
Revision	01

DE KUIL 28

4/28

DE KUIL 28

5/28

DE KUIL 28

6/28

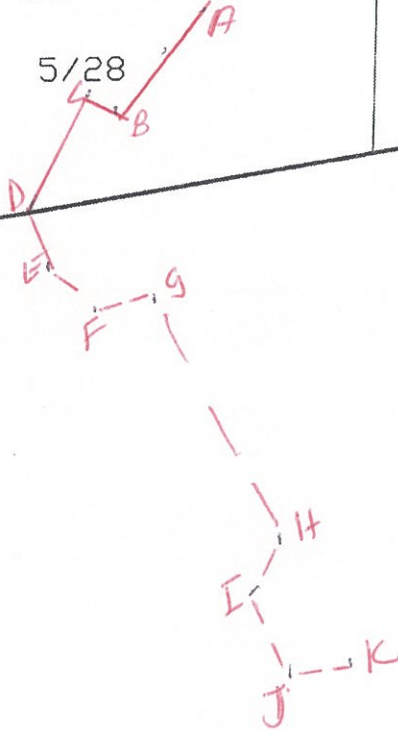

Bultfontein 174 JR Ptn 1 & 5

REGISTERED OWNER  
WITNESS

1.

*[Signature]*

2.

SUPPLY TO: Eskom  
 PROJECT No. RZ-WL Interconnector  
 PROPERTY: Portions of De Kuil 28JR

DATE 13/05/2022

REV:

SCALE

THIS DRAWING IS THE PROPERTY OF Eskom



*[Handwritten marks]*

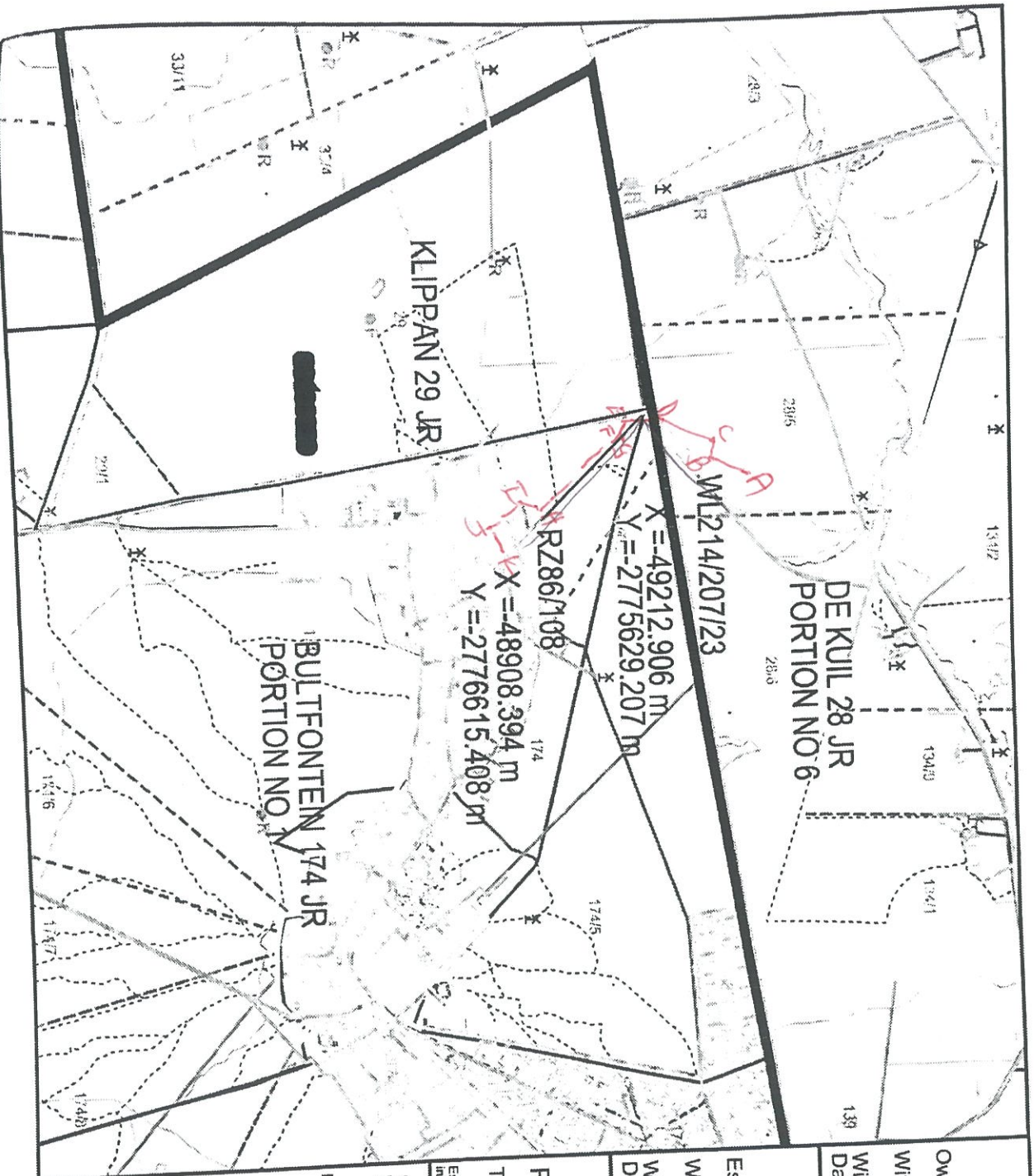

Owner: X  
 Witness: X  
 Witness: [Signature]  
 Date: 20 22 / 05 / 13

Eskom: \_\_\_\_\_  
 Witness: \_\_\_\_\_  
 Witness: \_\_\_\_\_  
 Date: 20 /    /   

**Wayleave Sketch**  
**RZ-WL Interconnector**  
 The route depicted by:  
 Eskom is not responsible for any errors in the information displayed on this map.

Scale: 1:50000

Projection: L084/29 (cm)

Author: Azwifaneli Netshifhehe  
 Map Number: 2528BA  
 Revision: \_\_\_\_\_  
 Date: 2022-03-30





**agriculture, land reform  
& rural development**

Department:  
Agriculture, Land Reform and Rural Development  
REPUBLIC OF SOUTH AFRICA

Deeds Registration Office

# DeedsWEB

## Property Report

Farm Enquiry

### General Information

Date Requested 2022-05-04  
Deed Office Limpopo  
Information Source Deed Office

### Property Details

Deeds registry LIMPOPO  
Property type FARM  
Farm name DE KUIL  
Farm number 28  
Portion 5  
Province LIMPOPO  
Registration division/Administrative district JR  
Local authority BELA-BELA LOCAL MUNICIPALITY  
Previous description OF PRTN 1  
Diagram deed number T5415/957  
Extent 481.0067 H  
LPI Code TQJR0000000002800005

### Deeds Title Details

#	Document	Registration Date	Purchase Date	Amount (R)
1	T26284/1961PTA	19611208	-	-

### Owner Information

#	Document	Full name	Identity Number	Share
1	T26284/1961PTA	REINT DYKEMA & SEUNS PTY LTD	07/01373/07	-

### Endorsements/Encumbrances

#	Endorsement	Holder	Amount (R)	Microfilm Reference
1	B48440/1984PTA	BARCLAYS NATIONAL IND	R500000.00	-
2	CONVERTED FROM PTA	-	-	-
3	JR.28.5	-	-	-

### Historic Documents

No data found for this search criteria

### Disclaimer:

The Office of the Chief Registrar of Deeds hereby confirms that, on the basis of information at the Deeds Office's disposal that the contents of this report accurately reflects property information held in our records. As per Deeds Registration process, this information is valid for seven (7) days.

Photocopies of this report are not valid

This report is issued subject to costs as specified in the fee schedule. <http://deeds.dated.gov.za/fees.php>



# Wayleave Agreement Checklist

2017 Rev 01

Consultant M. J. Ramoadi  
Cheetah surveyors PROJECT No.: RZ-WL Interconnector Item 1 of 2  
 Eskom \_\_\_\_\_

		Reference	Consultant	Eskom
1	Item no	Office	✓	
2	Eskom representative, the person presenting the wayleave	Office	✓	
3	Owners name, address, id number and contact details	1.13	✓	
4	Property Details	1.14	✓	
5	Letters indicating route at	2.1	✓	
6	Initial Signature on Pages 1 to 3 by owner and witnesses	Initial Sign	✓	
7	Date signed	Sign	✓	
8	Signature of property owner	Sign	✓	
9	Signature of witnesses	Sign	✓	
10	Signature on sketch	Sign	✓	
11	Witnesses on sketch	Sign	✓	
12	North sign	Office	✓	
13	Scale	Office	✓	
14	Proposed Route	Sketch	✓	
15	Route marked by letters (a, b, c...) on sketch	Sketch	✓	
16	Parallel distance from border or other powerlines	Sketch	✓	
17	Property Details on sketch	Office	✓	
18	Deeds report attached	Deeds	✓	
19	Property Schedule Submitted	Schedule	✓	

Signed by Consultant Juda Ramoadi (Cheetah Surveyors) Date: 04/07/2022

Signed by Eskom \_\_\_\_\_ Date: \_\_\_\_\_

### NOTES

- 1.1 If the owner is the registered owner of an Institution, a Government Department, or a Company etc, the full names and capacity of the undersigned must also completed. The full names and capacity also applies for a Lessee, Buyer, User, Heir, Occupant, Guardian etc.
- 1.2 In the event of Closed Corporation, the member signing for the CC, must have power of attorney for all members.
- 1.3 Please "Highlight" the portion number, border and farm name on the plan.
- 1.4 All alterations made on the Wayleave form must be initialled.