

AREA: <u>Bela Bela & Dr SS Moroka local Municip</u>	PROJECT NUMBER: <u>RZ-WL Interconnector</u>
FEEDER: <u>Zola-Lehau 22kV</u>	ITEM <u>2</u> OF <u>2</u>
SUPPLY TO: <u>ESKOM</u>	
ESKOM REPRESENTATIVE: <u>M.J. Ramoadi</u>	TEL: <u>0815519682</u>
DISTRIBUTION	Email: <u>ramoadimj@gmail.co</u>

**WAYLEAVE CONTRACT
POWERLINE AND/OR CABLE AND ASSOCIATED INFRASTRUCTURE**

1. GENERAL

1.1 Identification of parties:

1.1.1 Contractor means any entity appointed as an independent contractor to execute works on the Property in the exercise of the Rights, as set out herein.

1.1.2 Eskom means Eskom Holdings SOC Ltd, a public company with registration number 2002/015527/30 with its head office at Megawatt Park, 2 Maxwell Drive, Sunninghill, Sandton.

1.1.3 Owner means Republic of Bophuthatswana
(ID _____), a company / close corporation / trust / partnership / natural person / Government department / tribal authority of

x address 767 Mmakau Section

x Postal Code 0432 Tel No. 0726141685 herein represented

x by DIPERIE Justice MOKGOKO in my capacity as

x acting Chief of Mmasoganyeny

x (ID 640422615485), who through signature here below, warrants his or her authority to sign on behalf of the Owner.

1.1.4 Property means: Portion 1 (Remaining Extent) of Bultfontein 174 JR

Title Deed No.: T15195/1944BP Extent: 1201,1629H

Local Authority: DR J.S. Moroka Local Municipality

2 THE RIGHTS

2.1 The Owner grants, generally, an irrevocable right (herein the "Rights"), in perpetuity and free of charge, to Eskom and over the Property, for the distribution and transmission of electricity and related purposes, substantially along the route indicated by letters NEFGHJK on the attached sketch plan, comprising an area of nine meters on either side of the centre line of the Goods, once they are built (the "Wayleave Area"), and the Rights include those set out in paragraph 0

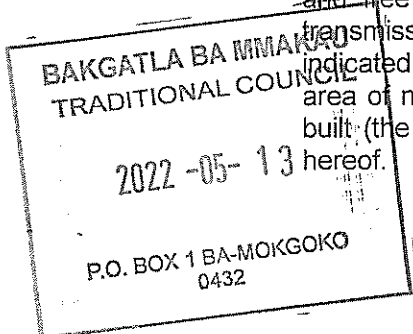

x M.A. MOKGOKO
x M.A. MOKGOKO

x DIPERIE Justice MOKGOKO
M.A. MOKGOKO

- 2.2 To the extent necessary to give effect hereto, the Owner's spouse, Lessee and/or Usufructuary agrees to the granting of the Rights by signing below.
- 2.3 The Rights, specifically, include the rights to:
- 2.3.1 convey electricity and telecommunication across the Property;
- 2.3.2 erect structures, conductors, cables, appliances and, without limitation, everything else as may be necessary or convenient in exercising the Rights (herein referred to as the "Goods") and the Owner agrees that structure-supporting mechanisms may reasonably extend beyond the Wayleave Area where it is necessary to safely secure the Goods;
- 2.3.3 enter and be upon the Property at any time in order to construct, erect, operate, use, maintain, repair, re-erect, alter or inspect the Goods or in order to gain access to any adjacent property in the exercise of rights similar to the Rights;
- 2.3.4 have these Goods remain on the Property for so long as either Eskom or the Owner requires them to;
- 2.3.5 extend the Goods to other customers, suppliers or contracting parties of Eskom, over the Property;
- 2.3.6 use existing roads and gates giving access to and running across the Property and to erect in any fence such gates as may be necessary or convenient to gain access to or exit from the Property and the Goods or in order to gain access to any adjacent property in the exercise of rights similar to the Rights;
- 2.3.7 remove any material or structures, and cut or trim any tree, bush or grass within the Wayleave Area or to the extent necessary where the Goods extends beyond the Wayleave Area, in order to comply with the restrictions referred to in paragraph 3.2 hereof;
- 2.3.8 every ancillary right necessary or convenient for the proper exercise of the Rights granted to Eskom; and
- 2.3.9 At Eskom's election, have this wayleave registered as a servitude against the title deed of the Property.
- 2.4 The Rights will apply to all electricity infrastructure on the Property and the area which such infrastructure covers will be deemed to be included in the Wayleave Area and/or Restricted Area. It is agreed that the Owner herewith grants permission for all electricity infrastructure on the Property to remain on the Property.
- 2.5 Any expenses to be incurred, which are necessitated by a change to or removal of the Goods in the Wayleave Area required by the Owner, are for the Owner's account and must be paid for by the Owner in advance. Eskom will effect such changes or removals after receipt of such payment, if such changes or removal are technically possible.
- 2.6 The Contractor may exercise any of the Rights.
- 2.7 Eskom may:
- 2.7.1 let any portion of the Goods to any third party on such conditions as Eskom may deem fit;
- 2.7.2 cede all or any of the Rights granted in terms of this Wayleave to any third party.

x 
*i. V.H. Mahalefa

3. THE OBLIGATIONS

- 3.1 Eskom must:
 - 3.1.1 ensure that any of Eskom's gates that it had used is closed after use;
 - 3.1.2 pay reasonable compensation for intentional damage or damage caused through a negligent act or omission, caused by Eskom, its employees or agents in pursuit of the Rights, save where Eskom is acting in accordance with sub-clause 2.3.7 of this document; and
 - 3.1.3 where a Contractor exercises the Rights, ensure that the Contractor complies with the obligations contained in this sub-clause 3.1.1.
- 3.2 The Owner must ensure that no:
 - 3.2.1 building or structure is erected or installed above or below the surface of the ground within the Wayleave Area and no tree or bush is planted within the Wayleave Area or within nine metres from any structure-supporting mechanism (the "Restricted Area");
 - 3.2.2 tree, which could grow to a height in excess of the horizontal distance of that tree from the nearest conductor of any power line is planted or allowed to continue growing, regardless if it is outside of the Wayleave or Restricted Area;
 - 3.2.3 material which may in the opinion of Eskom endanger any electricity infrastructure is placed within the Wayleave or Restricted Area.
- 3.3 The Owner must bring the existence of this wayleave contract to the attention of any purchaser or other transferee of the Property (or of any portion of the Property) before the Property (or any portion thereof) is sold and/or transferred to such purchaser or transferee, or if the Owner grants any further rights in or to the Property to any other third party, to such third Party.
- 3.4 The Owner must inform Eskom in writing if it is going to sell the Property.
- 3.5 The Owner's attention is drawn to the provisions of section 10.17.1 of the regulations promulgated in terms of the Explosives Act 26 of 1956, which prescribes that when blasting is to be done within 500 (five hundred) metres of any electricity infrastructure, written confirmation must first be obtained from Eskom concerning the protection of electricity infrastructure.

4. SPECIAL REMARKS

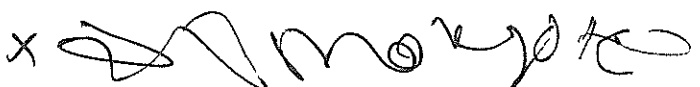
X. HA. MOKGOTLA

Signed at _____ on _____ of _____ 20_____.

X _____
The Owner

X _____
Witness 1

Witness 2

X Signed at _____ on _____ of _____ 20_____.

X _____
Spouse of the Owner if married in community of property
or second owner

X _____
Witness 1

Witness 2

Signed at At Mmerikau on 13 of May 2022.

T/C Mmerikau
Tribal Authority

H.D. Mmerikau
Witness 1

Witness 2

Stamp:

Signed at _____ on _____ of _____ 20_____.

Eskom Holdings SOC Limited

Witness 1

Witness 2



WAYLEAVE AGREEMENT SKETCH

Reference	CAD-Wayleave-LOU
Effective Date	15/10/2015
Revision	01

DE KUIL 28

4/28

DE KUIL 28

5/28

DE KUIL 28

6/28

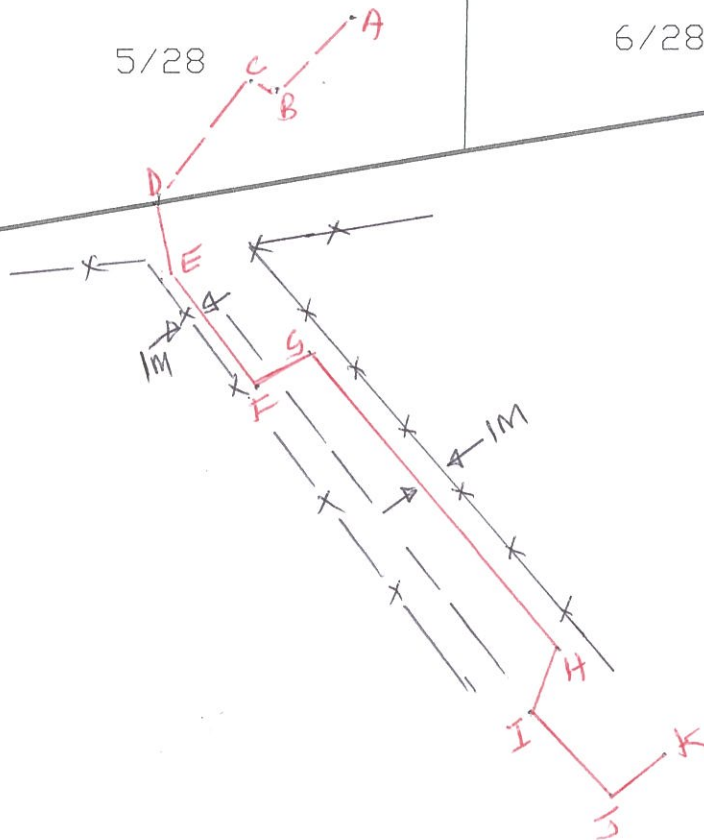

Bultfontein 174 JR Ptn 1 & 5

 REGISTERED OWNER

WITNESS

1. _____
2. _____

SUPPLY TO:	Eskom		
PROJECT No.	RZ-WL Interconnector		
PROPERTY:	Portion 1 (remaining extent) of Bultfontein 174 JR		
DATE	13 May 2022	REV:	SCALE



THIS DRAWING IS THE PROPERTY OF ESKOM

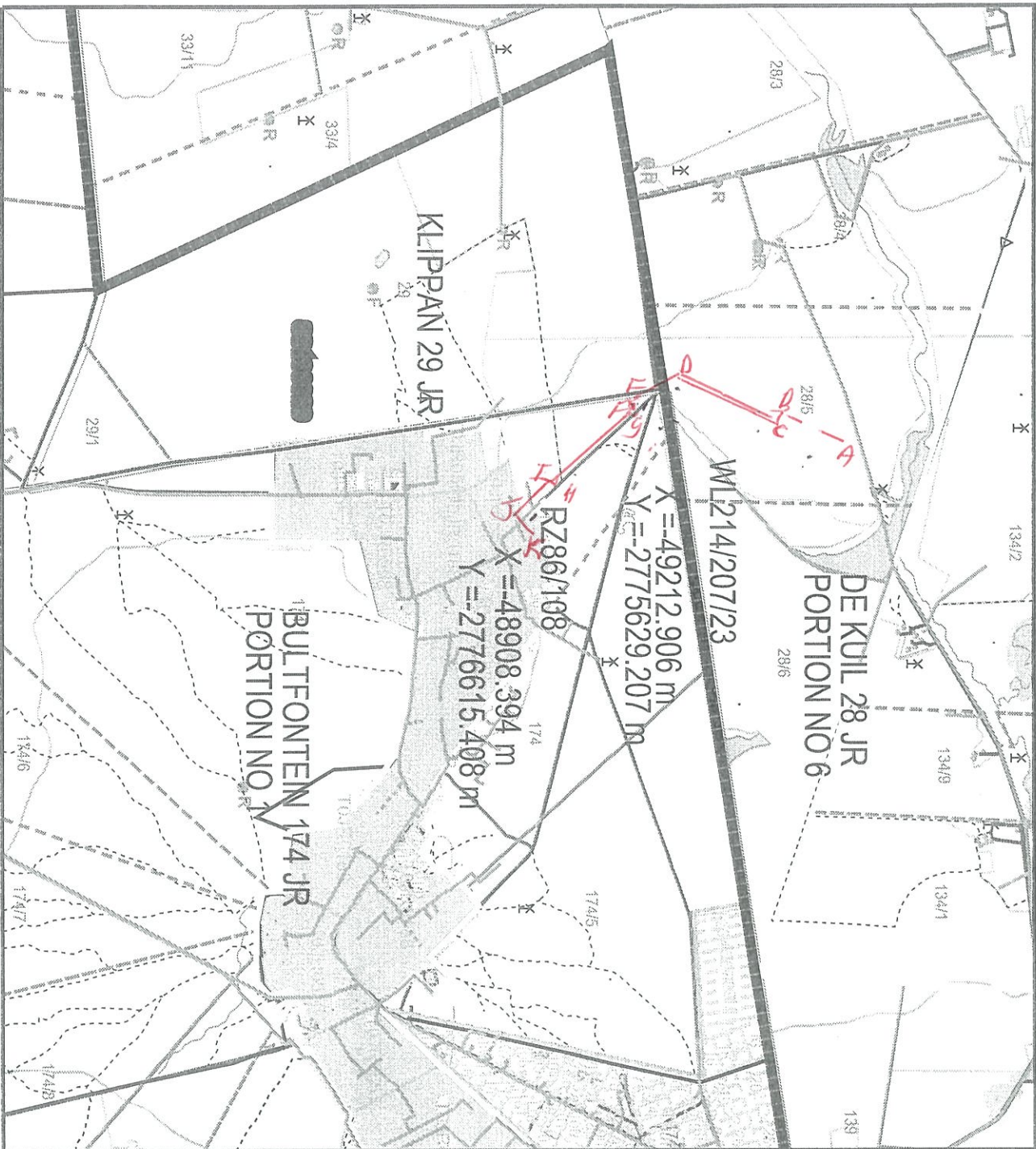

Owner: *[Signature]*
 Witness: *[Signature]*
 Witness: *[Signature]*
 Date: 2022/05/15

Eskom: _____
 Witness: _____
 Witness: _____
 Date: 20 / /

Wayleave Sketch
 RZ-WL Interconnector
 The route depicted by:
 Eskom is not responsible for any errors in the information displayed on this map.

Scale: 1:50000

Projection: L084/29 (cm)

Author: Azwifaneli Netshifhefhe
 Map Number: 2528BA
 Revision: _____
 Date: 2022-03-30



Any personal information obtained from this search will only be used as per the Terms and Conditions agreed to and in accordance with applicable data protection laws including the Protection of Personal Information Act, 2013 (POPI), and shall not be used for marketing purposes.

SEARCH CRITERIA			
Search Date	2022/05/04 11:41	Farm Number	174
Reference	-	Registration Division	JR
Report Print Date	2022/05/04 11:42	Portion Number	1
Farm Name	-	Remaining Extent	NO
Deeds Office	Pretoria	Search Source	WinDeed Database

PROPERTY INFORMATION			
Property Type	FARM	Diagram Deed Number	T15195/1944BP
Farm Name	BULTFONTEIN	Local Authority	DR JS MOROKA LOCAL MUNICIPALITY
Farm Number	174	Province	GAUTENG
Registration Division	JR	Remaining Extent	NO
Portion Number	1 (REMAINING EXTENT)	Extent	1201.1629H
Previous Description	-	LPI Code	TOJR00000000017400001

OWNER INFORMATION (2)			
REPUBLIC OF BOPHUTHATSWANA			Owner 1 of 2
Company Type	GOVERNMENT	Document	T15195/1944BP
Registration Number	-	Microfilm / Scanned Date	-
Name	REPUBLIC OF BOPHUTHATSWANA	Purchase Price (R)	-
Multiple Owners	YES	Purchase Date	-
Multiple Properties	NO	Registration Date	1944/06/09
Share (%)	-		

DISCLAIMER

This report contains information provided to LNRM by content providers and LNRM cannot control the accuracy of the data nor the timely accessibility. LNRM will not be held liable for any claims based on reliance of the search information provided. This report is subject to the terms and conditions of LexisNexis Risk Management Agreement. LexisNexis Risk Management (Pty) Ltd is a registered credit bureau (NCRCB26).

OWNER INFORMATION (2)			
REPUBLIC OF BOPHUTHATSWANA			Owner 2 of 2
Company Type	GOVERNMENT	Document	T201/1989BP
Registration Number	-	Microfilm / Scanned Date	-
Name	REPUBLIC OF BOPHUTHATSWANA	Purchase Price (R)	TRANSFER BY ENDO
Multiple Owners	NO	Purchase Date	-
Multiple Properties	NO	Registration Date	1989/04/17
Share (%)	-		

ENDORSEMENTS (4)				
#	Document	Institution	Amount (R)	Microfilm / Scanned Date
1	VA29/1988BP	NATIONAL GOVERNMENT OF THE REPUBLIC OF SOUTH AFR	-	-
2	I-17140/2000LG	-	Unknown	-
3	K353/1944RMBP	-	Unknown	-
4	JR,174,1-BP	-	Unknown	2000 1166 1867

HISTORIC DOCUMENTS (1)				
#	Document	Institution	Amount (R)	Microfilm / Scanned Date
1	T15195/1944BP	BAKGATLA-BA-MAKAU TRIBE	-	-

DISCLAIMER

This report contains information provided to LNRM by content providers and LNRM cannot control the accuracy of the data nor the timely accessibility. LNRM will not be held liable for any claims based on reliance of the search information provided. This report is subject to the terms and conditions of LexisNexis Risk Management Agreement. LexisNexis Risk Management (Pty) Ltd is a registered credit bureau (NCRCB26).



Wayleave Agreement Checklist

2017 Rev 01

Consultant M.J. Ramoadi Cheetah Surveyors PROJECT No.: RZ-WL Interconnection Item 2 of 2
 Eskom _____

		Reference	Consultant	Eskom
1	Item no	Office	✓	
2	Eskom representative, the person presenting the wayleave	Office	✓	
3	Owners name, address, id number and contact details	1.13	✓	
4	Property Details	1.14	✓	
5	Letters indicating route at	2.1	✓	
6	Initial Signature on Pages 1 to 3 by owner and witnesses	Initial Sign	✓	
7	Date signed	Sign	✓	
8	Signature of property owner	Sign	✓	
9	Signature of witnesses	Sign	✓	
10	Signature on sketch	Sign	✓	
11	Witnesses on sketch	Sign	✓	
12	North sign	Office	✓	
13	Scale	Office	✓	
14	Proposed Route	Sketch	✓	
15	Route marked by letters (a, b, c...) on sketch	Sketch	✓	
16	Parallel distance from border or other powerlines	Sketch	✓	
17	Property Details on sketch	Office	✓	
18	Deeds report attached	Deeds	✓	
19	Property Schedule Submitted	Schedule	✓	

Signed by Consultant M.J. Ramoadi (Cheetah Surveyors) Date: 04/07/2018

Signed by Eskom _____ Date: _____

NOTES

- 1.1 If the owner is the registered owner of an Institution, a Government Department, or a Company etc, the **full names and capacity** of the undersigned must also completed. The full names and capacity also applies for a Lessee, Buyer, User, Heir, Occupant, Guardian etc.
- 1.2 In the event of Closed Corporation, the member signing for the CC, must have power of attorney for all members.
- 1.3 Please "Highlight" the portion number, border and farm name on the plan.
- 1.4 All alterations made on the Wayleave form must be initialled.