

GREATER EMALAHLENI YOUTH FORUM COOPERATIVE APPLICATION FOR MINING PERMIT AREA

A portion of portion 1 (remaining extent) of the farm Kleinzuikerboschplaat 5 IS

Co-ordinates Decimal Degree		Co-ordinates WG 29	
A	26.05391 S 29.05375 E	A	-5378.87 Y 2882808.28 X
B	26.05697 S 29.05603 E	B	-5606.89 Y 2883147.39 X
C	26.05829 S 29.05590 E	C	-5593.82 Y 2883293.63 X
D	26.05437 S 29.05275 E	D	-5278.78 Y 2882859.21 X
A	26.05391 S 29.05375 E	A	-5378.87 Y 2882808.28 X

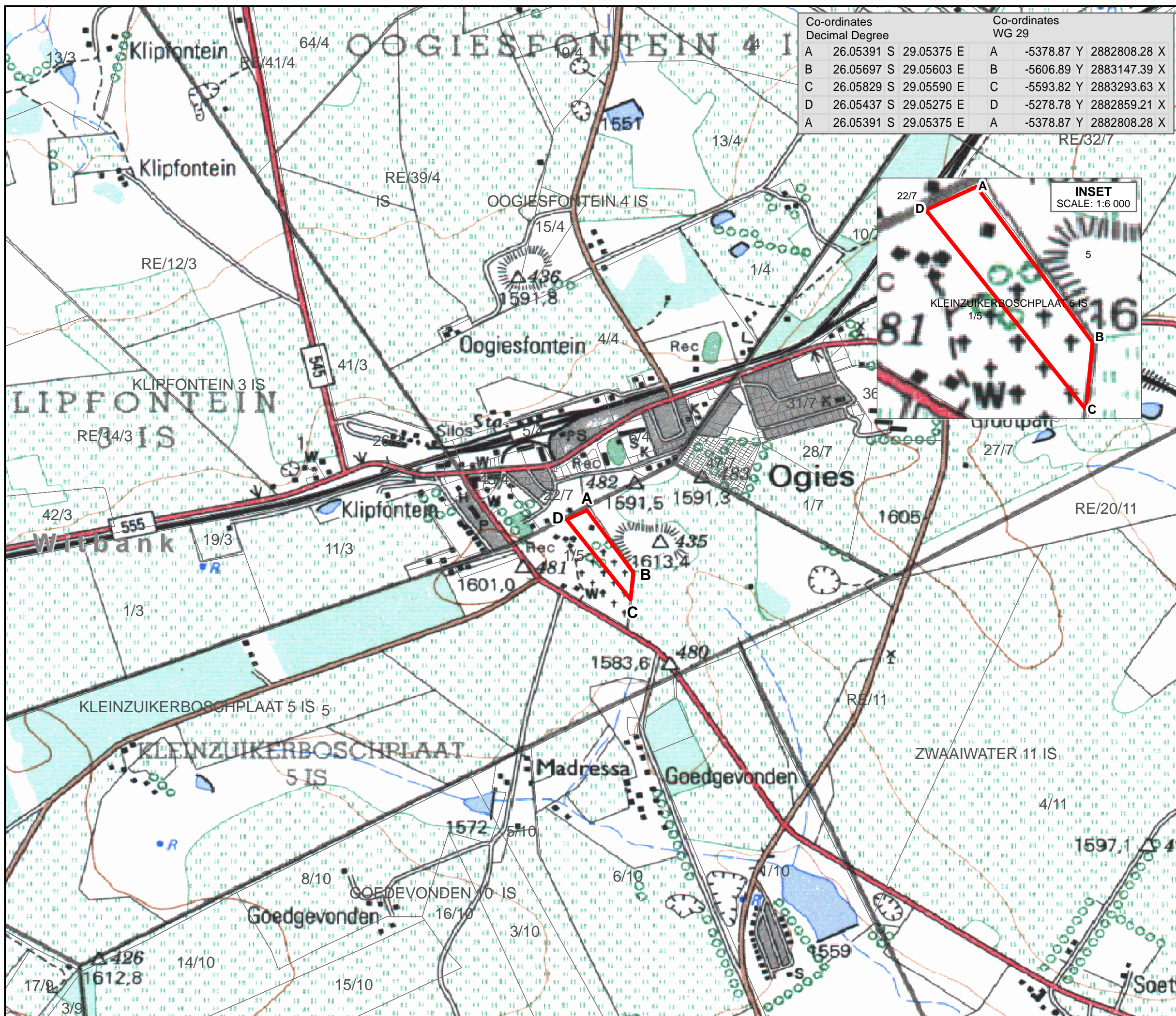

Legend

- Mining Permit Area
- Cadastral boundaries
- Magisterial District

1:50 000 Map Reference

VERKLARING	REFERENCE
Internasionale Grens en Baken	International Boundary and Beacon
Provinciale Grens	Provincial Boundary
Wild- en Natuurreservaat en Staatsbosgrens	Game, Nature Reserve & State Forest Boundary
Standhoudende Rivier	Perennial River
Nie-standhoudende Rivier	Non-perennial River
Droë Pan	Dry Water Course
Moeras en Vlei	Marsh and Vlei
Pylyn (bo die grond)	Pipeline (above ground)
Wateroring; Reservoir; Waterpunt	Water Tower; Reservoir; Water Point
Kuslynroete	Coastal Rocks
Prominente Klipbank	Prominent Rock Outcrop
Erosie; Sand	Erosion; Sand
Beboste Gebied	Woodland
Bewerkte Land	Cultivated Land
Boord of Wingerd	Orchard or Vineyard
Ontspanningsterrein	Recreation Ground
Rye Bome	Row of Trees

The figure lettered A, B, C, D, A represents an area in extent of 4,8525 hectares, comprising of a portion of portion 1 (remaining extent) of the farm Kleinzuikerboschplaat 5 IS, Magisterial District of Witbank, in respect of which Greater Emalahleni Youth Forum Cooperative apply for a Mining Permit in terms of Section 27 of the Mineral and Petroleum Resources Development Act, 2002 (Act 28 of 2002), subject to Regulation 17 of the Mine Health and Safety Act, 1996 (Act 29 of 1996), excluding any area within 100 metres of any public road, railway, cemetery, residential area or public area

Co-ordinates supplied by the client and were not physically surveyed and are therefore an estimation only

C. Mc Gee

C Mc Gee - Compiled and Drawn	Date
Greater Emalahleni Youth Forum Cooperative	Date
Regional Manager Mpumalanga Region	Date

LOCALITY PLAN COMPILED IN ACCORDANCE WITH REGULATION 2(2) OF THE MINERAL AND PETROLEUM RESOURCES DEVELOPMENT ACT, 2002 (ACT 28 OF 2002)

1:50000 map: 2629AA
Map Co-ordinate System: Decimal Degree
Spheroid and Datum: WGS84/WGS84

Please take note that the co-ordinates and area were derived from a GIS and were not physically surveyed and are therefore an estimation only

