

The Pa. a/c, d/c, f/c, g/c, h/c, i/c, j/c, k/c, l/c, m/c, n/c, o/c, p/c, q/c, r/c, s/c, t/c, u/c, v/c, w/c, x/c, y/c, z/c each represent an S.P.T. Section
 and can be used as shown
 35/1981
 1. 11. 1982

11/11/1982
 D/S 10/11/1982

NO. OF	EXTENT	TRANSFER NO.	INTD.	DATE
1	2249/1069 702/1069 9983 sq.m	140,4718 ha.	16686/1973	24-10-1973
2	2772/1078 885/1078 16101 ha	138,8527 ha	17142/1075	7-11-75
3	374/1983 160/1983 1,0796 ha	137,7731 ha	12518/1974	1982-6-8
4	466/1982 1534/1982 1,3656 ha	126,4075 ha	13595/1984	1982-8-2
5	2535/1984 1264/1984 3,3015 ha	128,1060 ha	8150/1985	1985-5-8
6	3498/2000 1194/2000 4,7474 ha	113,3582 ha	40230/2000	62-11-1982
7	3498/2000 1194/2000 4,7474 ha	113,3582 ha	40230/2000	62-11-1982

10 Road Serv. Lett. S1
 HAS BEEN LAID DOWN AS SHOWN
 26.19/1960 DATE 24-10-1973

11/11/1982
 D/S 1232/1973

FOR SURVEYOR GENERAL
 D/T 1400/1960
 Act 10/1944

2172/1978
 7-11-75

FOR SURVEYOR GENERAL
 D/S 395/1965
 2029/1973 DATE 15-4-1980
 WIDE HAS BEEN LAID DOWN AS SHOWN
 15/4/1980

FORM 10-11 (OF 3) ROAD
 B. HANDELMAN
 2000.03.12
 C. HANDELMAN

.....
The Rail Siding Serv 1210 S³
.....
with

S.O. No. 751/1982

1987 09 23

.....
for S.O. No. 751/1982
DS 220/1987^s

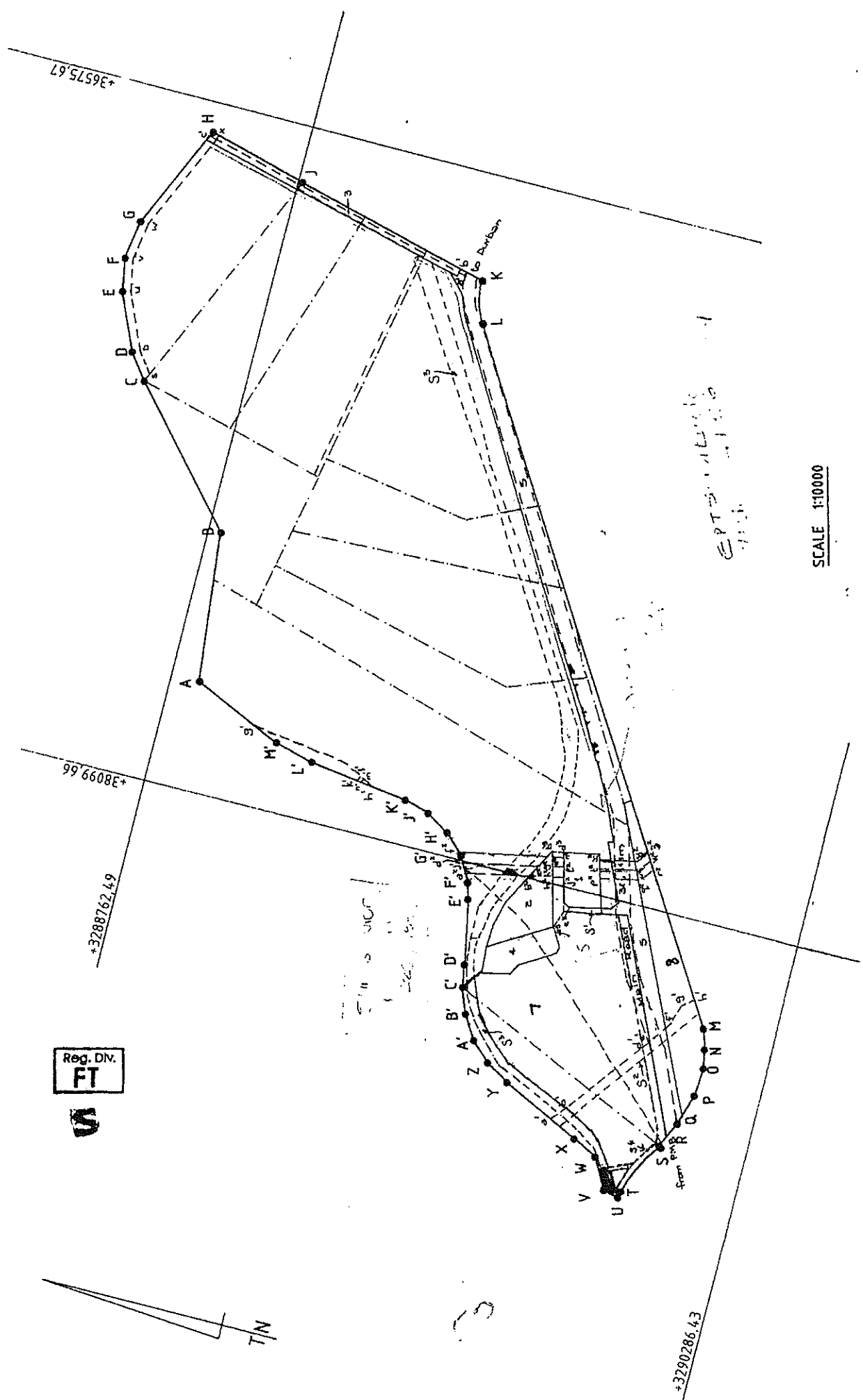

Reg. Div.
FT

S



EPT 3-11-11

SCALE 1:10000

+36575.67

+3288762.49

+3290286.43

3

Can...

40232/2007
2007.11.29

40232/2007

109.6810

3.676409

1194/2006

8

A water pipeline servitude

letter 54

WIDE HAS BEEN LAID DOWN AS SHOWN

S.G. I.P.O. 3546/1997

DATE 2007.11.29

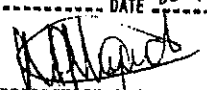

for SURVEYOR-GENERAL
D/540238/2007