

GENERAL NOTES

1. All work must be done in accordance with the building department conditions and National Building Regulations.
2. No dimensions may be taken from elevations or sections for construction purposes. The dimensions shown on this plan are to be taken from the center of mass of the building.

APPROPRIATE TO THE REPRESENTATIONS OF THE ABOVE PERSONS TO THE BUILDING DEPARTMENT.
SUBDIVISION N. 02020:
APPLYING TO comply with SANS 10400 Part 1 clause 4.2.1.
Show dimensions to be in accordance with Table 1 in clause 4.1.5.

APPROPRIATE TO THE REPRESENTATIONS OF THE ABOVE PERSONS TO THE BUILDING DEPARTMENT.
SUBDIVISION N. 02020:
APPLYING TO comply with SANS 10400 Part 1 clause 4.2.1.
Show dimensions to be in accordance with Table 1 in clause 4.1.5.

APPROPRIATE TO THE REPRESENTATIONS OF THE ABOVE PERSONS TO THE BUILDING DEPARTMENT.
SUBDIVISION N. 02020:
APPLYING TO comply with SANS 10400 Part 1 clause 4.2.1.
Show dimensions to be in accordance with Table 1 in clause 4.1.5.

APPROPRIATE TO THE REPRESENTATIONS OF THE ABOVE PERSONS TO THE BUILDING DEPARTMENT.
SUBDIVISION N. 02020:
APPLYING TO comply with SANS 10400 Part 1 clause 4.2.1.
Show dimensions to be in accordance with Table 1 in clause 4.1.5.

APPROPRIATE TO THE REPRESENTATIONS OF THE ABOVE PERSONS TO THE BUILDING DEPARTMENT.
SUBDIVISION N. 02020:
APPLYING TO comply with SANS 10400 Part 1 clause 4.2.1.
Show dimensions to be in accordance with Table 1 in clause 4.1.5.

APPROPRIATE TO THE REPRESENTATIONS OF THE ABOVE PERSONS TO THE BUILDING DEPARTMENT.
SUBDIVISION N. 02020:
APPLYING TO comply with SANS 10400 Part 1 clause 4.2.1.
Show dimensions to be in accordance with Table 1 in clause 4.1.5.

APPROPRIATE TO THE REPRESENTATIONS OF THE ABOVE PERSONS TO THE BUILDING DEPARTMENT.
SUBDIVISION N. 02020:
APPLYING TO comply with SANS 10400 Part 1 clause 4.2.1.
Show dimensions to be in accordance with Table 1 in clause 4.1.5.

APPROPRIATE TO THE REPRESENTATIONS OF THE ABOVE PERSONS TO THE BUILDING DEPARTMENT.
SUBDIVISION N. 02020:
APPLYING TO comply with SANS 10400 Part 1 clause 4.2.1.
Show dimensions to be in accordance with Table 1 in clause 4.1.5.

APPROPRIATE TO THE REPRESENTATIONS OF THE ABOVE PERSONS TO THE BUILDING DEPARTMENT.
SUBDIVISION N. 02020:
APPLYING TO comply with SANS 10400 Part 1 clause 4.2.1.
Show dimensions to be in accordance with Table 1 in clause 4.1.5.

APPROPRIATE TO THE REPRESENTATIONS OF THE ABOVE PERSONS TO THE BUILDING DEPARTMENT.
SUBDIVISION N. 02020:
APPLYING TO comply with SANS 10400 Part 1 clause 4.2.1.
Show dimensions to be in accordance with Table 1 in clause 4.1.5.

APPROPRIATE TO THE REPRESENTATIONS OF THE ABOVE PERSONS TO THE BUILDING DEPARTMENT.
SUBDIVISION N. 02020:
APPLYING TO comply with SANS 10400 Part 1 clause 4.2.1.
Show dimensions to be in accordance with Table 1 in clause 4.1.5.

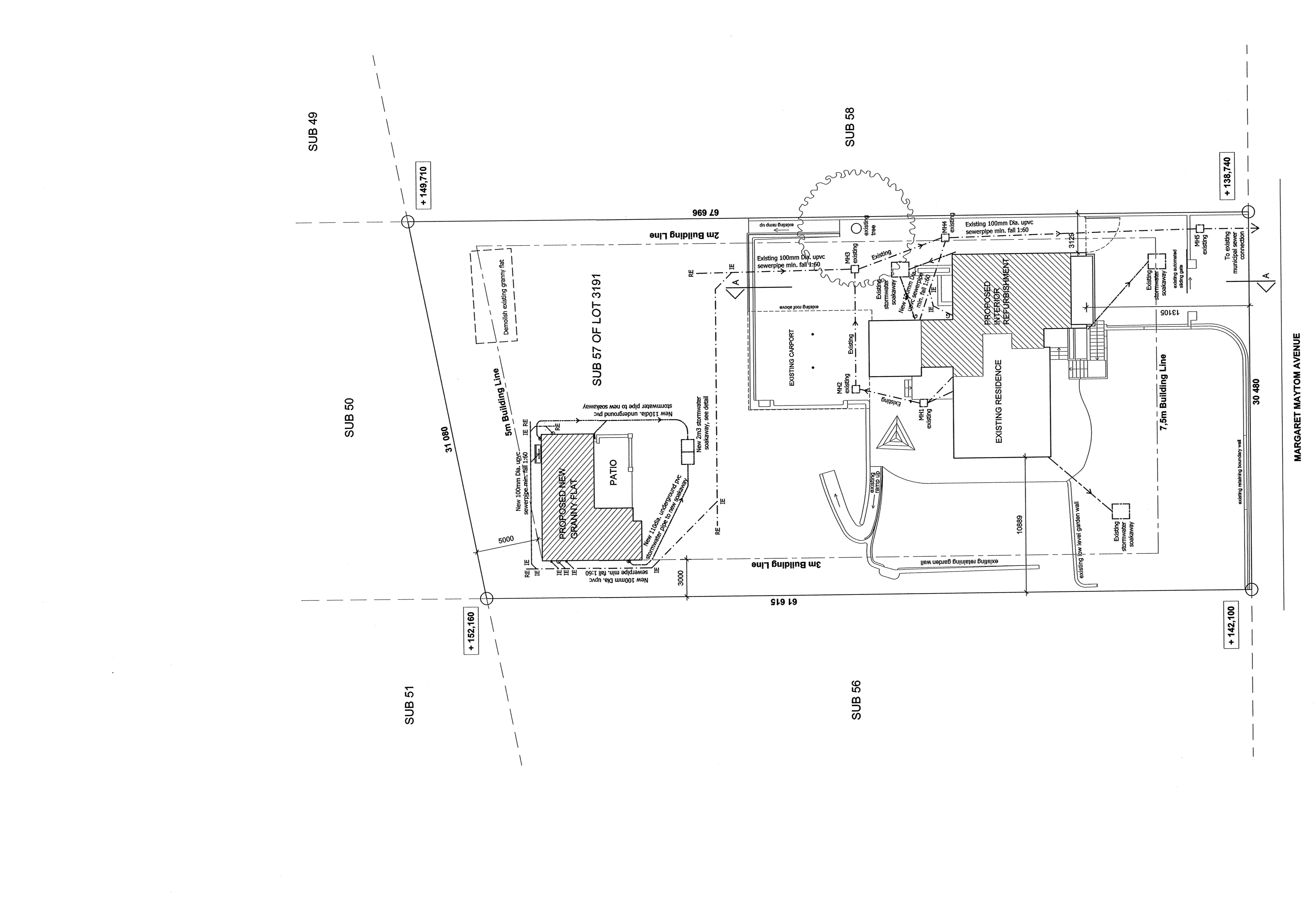
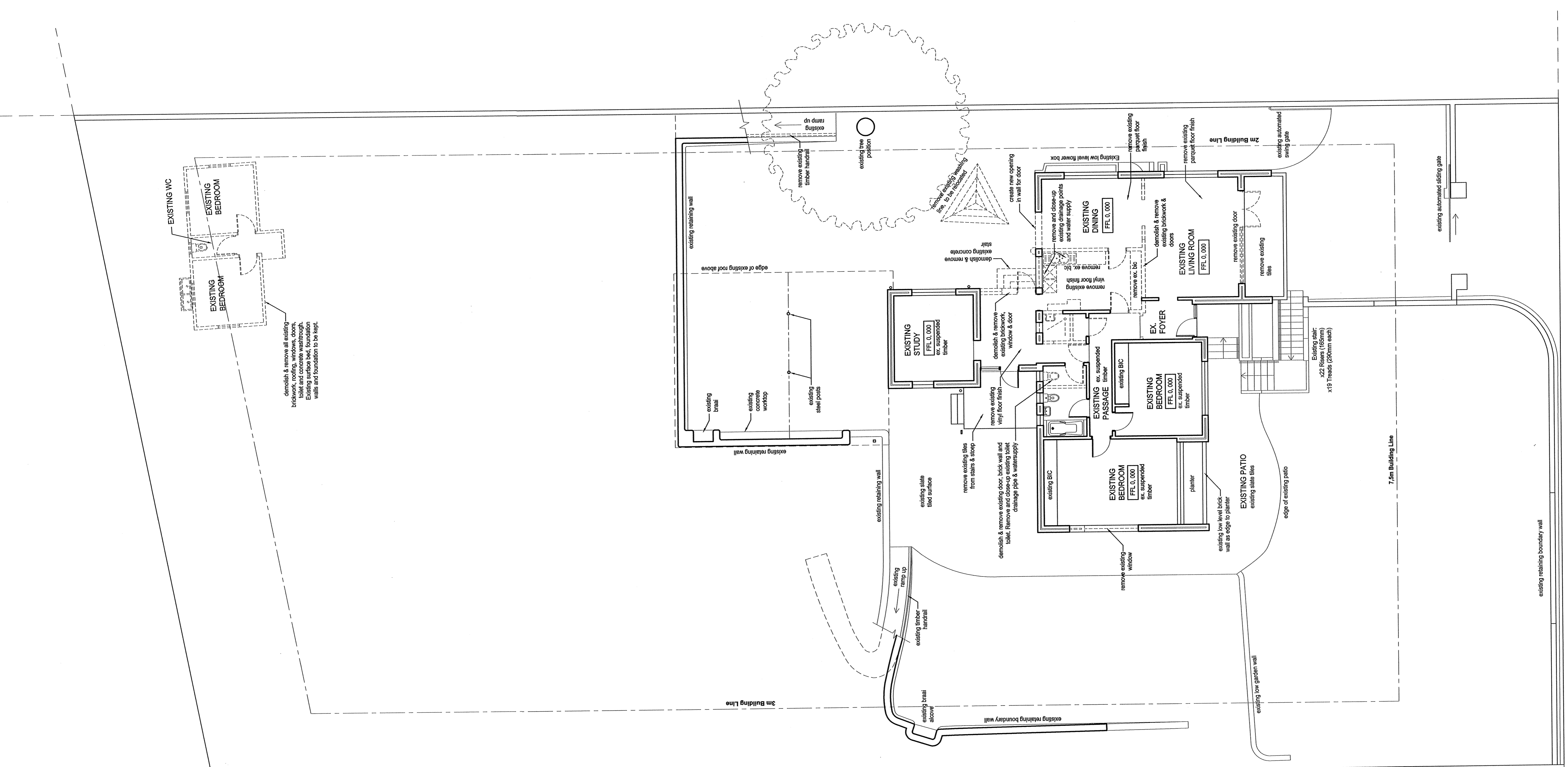

AREA SCHEDULE	
Site Area	= 1979m ²
Building F.A.S.	= 107.25m ² - 24,68m ² - 58,58m ² / 1979m ²
Plot Area	= 242,27m ² / 1979m ²
Plot F.A.S.	= 167,25m ² - 45,32m ² - 121,93m ² / 1979m ²
Plot Coverage	= 8,44% (100% Max Allow - Staff Accommodation) / 65m Area
Plot Coverage	= 167,25m ² - 24,68m ² - 142,57m ² / 1979m ²
Plot Coverage	= 167,25m ² - 24,68m ² - 142,57m ² / 1979m ²
Plot Coverage	= 167,25m ² - 24,68m ² - 142,57m ² / 1979m ²

SITE PLAN
1:200

MARGARET MATYOM AVENUE

Jim Building Line

2m Building Line

7m Building Line

30 480

13105

10100

15100

51 615

31 050

51 615

152 000

152 700

152 700

138 740

142 100

142 100

OWNER: Ernest and Madeline van der Linde
Telephone: 021 2 657 1234

DATE: 17 April 2013

ARCHITECT: H.M. Marais
SACAP registration number: 7768
DATE: 17 April 2013

STATUS: STATUTORY SUBMISSION

PROJECT: PROPOSED ADDITIONS & ALTERATIONS TO EXISTING RESIDENCE
SUB 57 OF LOT 3191, BROADWAY
15 MARGARET MATYOM AVENUE,
MIDVALE, CAPETOWN
BYE LAW: 26/2002

SCALE: 1:200 / 1:100
DATE: April 2013
DRAWING NO.: 008
SHEET NO.: S100
REVISION NO.: A

DRAWING: SITE PLAN & DEMOLITION PLAN

HMA
J.H. MARAIS (S. Arch)
h.marais@hmarais.com
8 Sylvania Road, Westville

DATE PLOTTED: 17 April 2013

DEMOLITION PLAN:
GROUND STOREY
1:200

MARGARET MATYOM AVENUE