

THIS DRAWING IS COPYRIGHT RICHARD STRETTON. ALL BUILDING WORK TO COMPLY WITH SANS 10400. ALL DIMENSIONS TO BE CHECKED ON SITE. ANY DISCREPANCIES TO BE CHECKED WITH THE ARCHITECT / ENGINEER BEFORE COMMENCING WORK. WRITTEN DIMENSIONS TO BE TAKEN IN PREFERENCE TO SCALING.

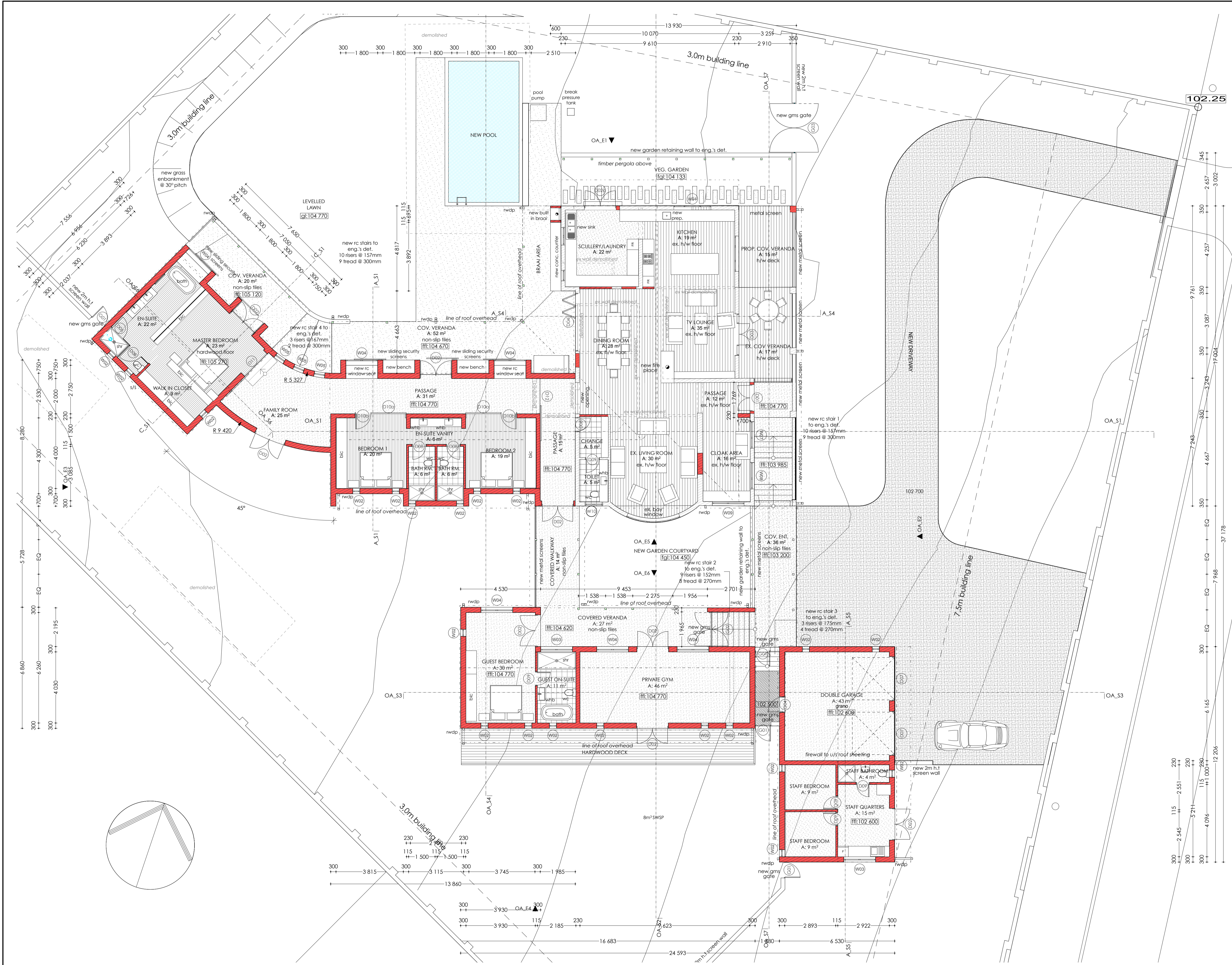

PROJECT:	PROPOSED ADDITIONS & ALTERATIONS
PROJECT NO:	A201
DRAWING TITLE:	GROUND FLOOR PLAN
DRAWING:	SB101
SCALE:	1:100, 1:200 @ A1
DATE:	2013/10/24
AUTHOR:	RAS
PROPERTY:	8 BOTHA ROAD ON REM OF LOT 98 BOTHA'S HILL
OWNER:	MR. S.D. MHAKA & MRS. M.N. MAGOSO
ENGINEER:	ALAN LAMB
OWNER SIGNATURE:	
ARCHITECT'S SIGNATURE:	
R. STRETTON	PR. ARCH. 21/042
FOR OFFICE USE:	2_SBSMESHUP/ARCH/CAD/2013/08/14_S4_07.dwg Thursday, 26 October 2013

GROUND FLOOR PLAN

1:100