

	AREA	PARKING RATIO	PROVIDED BAYS
TRUCK STOP			
Covered Forecourt	190m ²	1bay/50m ²	4bays
PETROL FILLING STATION			
Covered Forecourt	400m ²	1bay/50m ²	8bays
Convenience Shop	300m ²	1bay/30m ²	10bays
RESTAURANTS			
Ablutions	100m ²	6bay/100m ²	6bays
Fastfood Restaurants	675m ²	6bay/100m ²	41bays
CAR WASH			
2 bay car wash	50m ²	6bay/100m ²	3bays
TOTAL BAYS REQUIRED			71Bays
EXCESS BAYS			7Bays
TOTAL BAYS PROVIDED			78Bays
9m x4m LOADING BAYS PROVIDED			2Bays

ULUNDI PETROL FILLING STATION		
Site area	8003m ²	
Low Impact Mixed Use Development		
Permitted Floor Area Ratio	6.402m ²	0.8%
Permitted Coverage	3.201m ²	40%
Truckstop Forecourt	190	
Petrol Filling Station Forecourt	400	
PFS Convenience Shop	300	
Fastfood Restaurants	675	
Ablutions	100	
Car Wash	50	
Total Development Area 1 715m²		
Proposed Floor Area Ratio	1715m ²	0.21%
Proposed Coverage	1715m ²	21.4%

SIGNATURES

Owner.....

For KHOB0 Investments Properties

Architect.....

**DRAWING: SITE DEVELOPMENT PLAN
PROPOSED NEW PFS & RESTAURANTS
ULUNDI 19 INTERSECTION**

Low Impact Mixed Use Development

Drawing Name
**Ground Floor,
Ground Floor (1)
SDP SUBMISSION**

Drawn by
W. CHIMANGO Date
MARCH 2021

Pr.Arch (SACAP)
3 MOTTRAMDALE RD
BEREA WEST 3629
WESTVILLE, DURBAN
wavell@kjwc.co.za
083 718 0201

Revision
REV. D

Layout ID
SDP-001

Drawing Scale
1:250

Drawing Name
**Ground Floor,
Ground Floor (1)
SDP SUBMISSION**

Drawing Name
**Ground Floor,
Ground Floor (1)
SDP SUBMISSION**



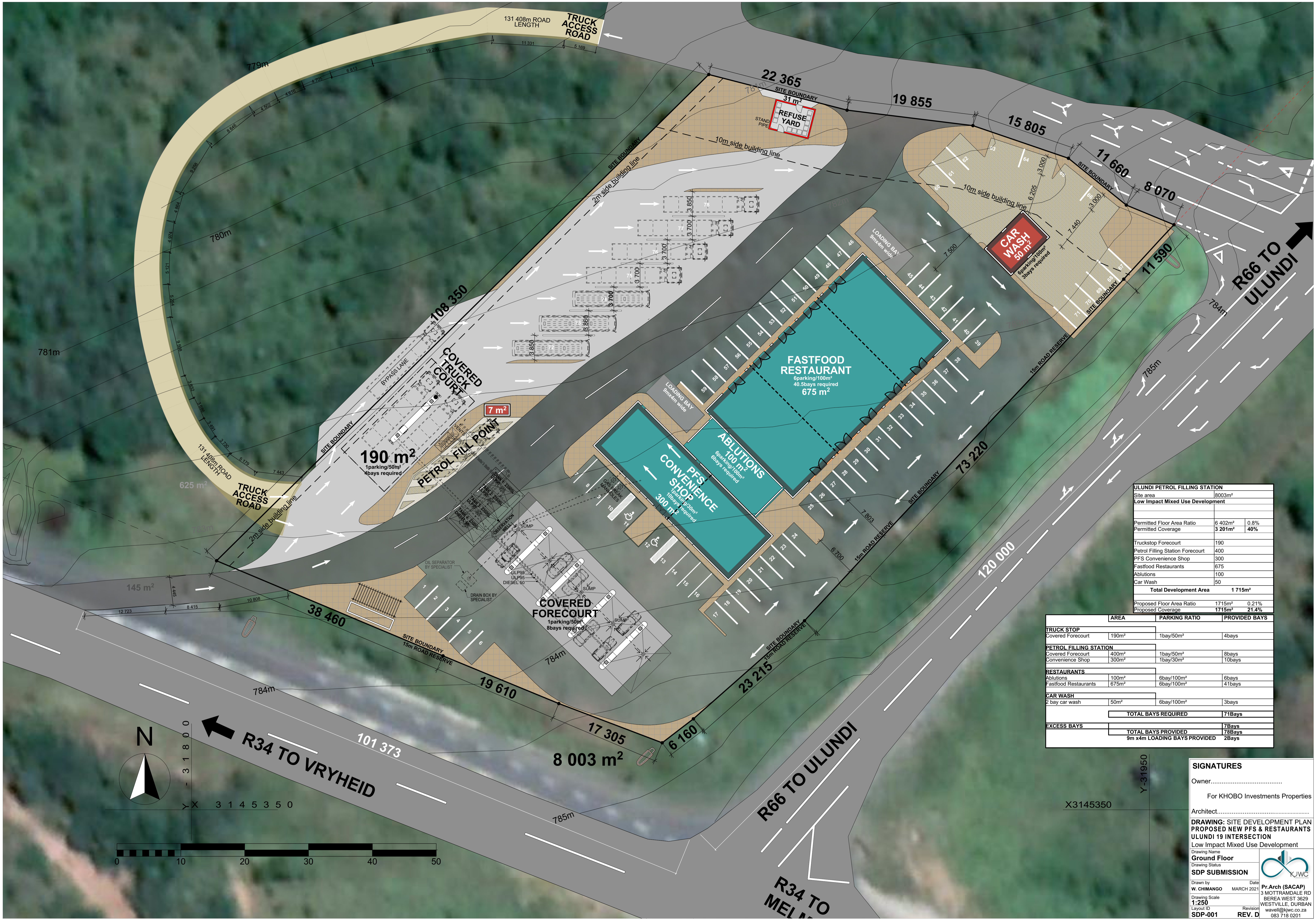

ULUNDI PETROL FILLING STATION	
Site area	8003m ²
Low Impact Mixed Use Development	
Permitted Floor Area Ratio	6 402m ² 0,8%
Permitted Coverage	3 201m ² 40%
Truckstop Forecourt	190
Petrol Filling Station Forecourt	400
PFS Convenience Shop	300
Fastfood Restaurants	675
Ablutions	100
Car Wash	50
Total Development Area	1 715m²
Proposed Floor Area Ratio	1715m ² 0,21%
Proposed Coverage	1715m ² 21,4%

AREA	PARKING RATIO	PROVIDED BAYS
TRUCK STOP		
Covered Forecourt	1bay/50m ²	4bays
PETROL FILLING STATION		
Covered Forecourt	1bay/50m ²	8bays
Convenience Shop	1bay/30m ²	10bays
RESTAURANTS		
Ablutions	6bay/100m ²	6bays
Fastfood Restaurants	6bay/100m ²	41bays
CAR WASH		
2 bay car wash	6bay/100m ²	3bays
TOTAL BAYS REQUIRED		71Bays
EXCESS BAYS		7Bays
TOTAL BAYS PROVIDED		78Bays
9m x4m LOADING BAYS PROVIDED		2Bays

SIGNATURES

Owner.....

For KHOB0 Investments Properties

Architect.....

**DRAWING: SITE DEVELOPMENT PLAN
PROPOSED NEW PFS & RESTAURANTS
ULUNDI 19 INTERSECTION**
Low Impact Mixed Use Development

Drawing Name
Ground Floor
Drawing Status
SDP SUBMISSION

Drawn by
W. CHIMANGO Date
MARCH 2021

Pr.Arch (SACAP)
3 MOTTRAMDALE RD
BEREA WEST 3629
WESTVILLE, DURBAN
wavell@kjwc.co.za
083 718 0201

Revision
REV. D

Scale
1:250

Layout ID
SDP-001

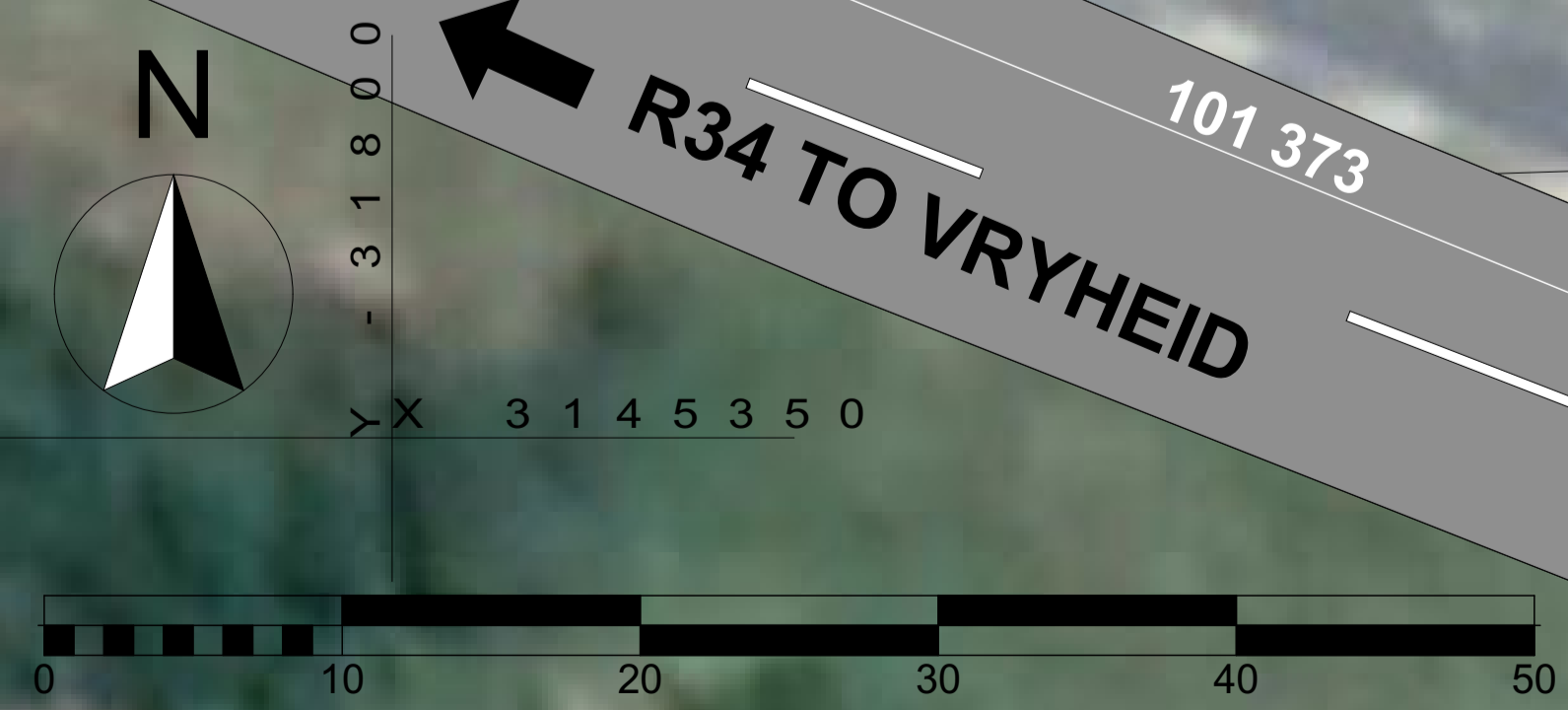

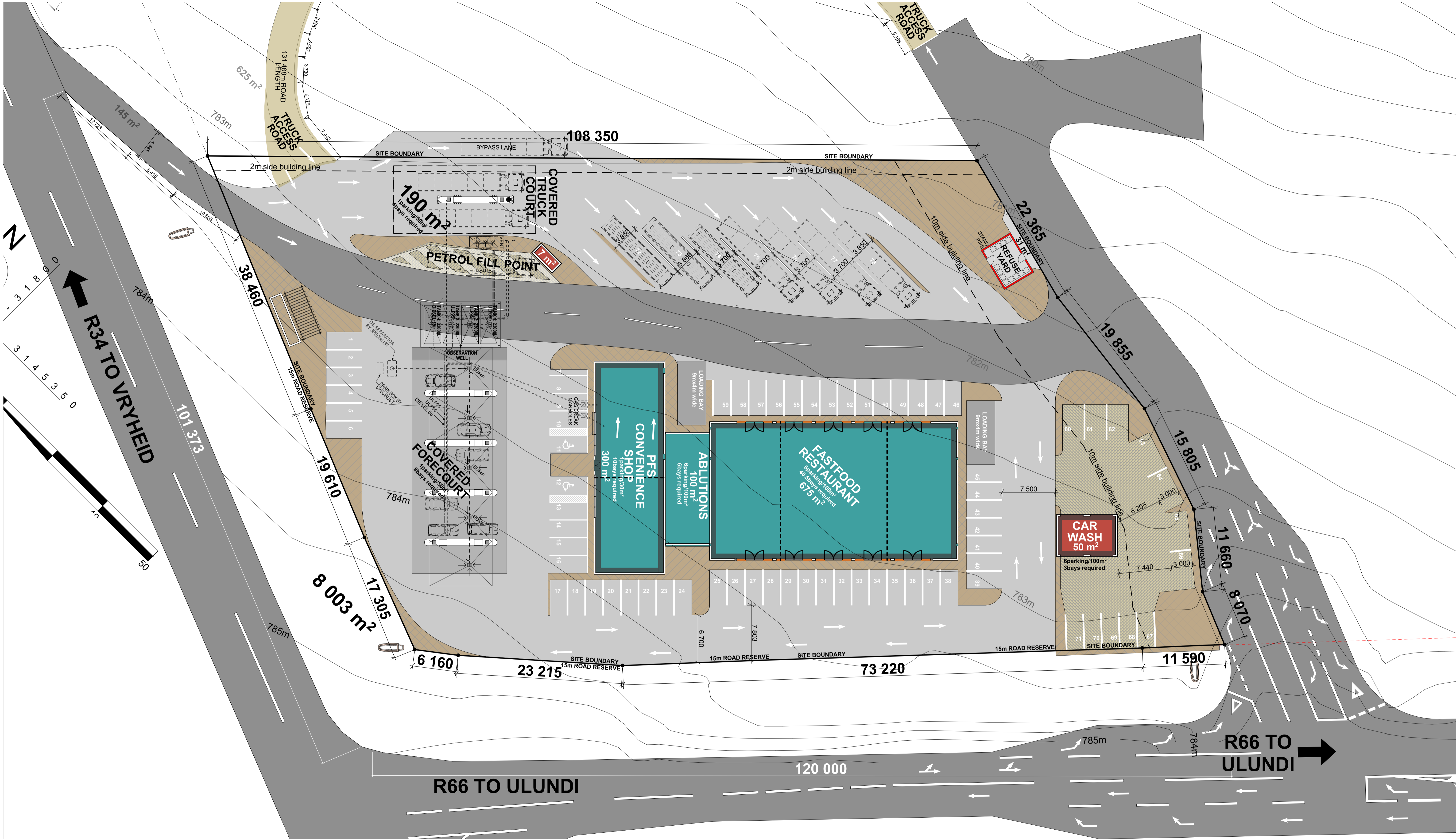

	AREA	PARKING RATIO	PROVIDED BAYS
TRUCK STOP			
Covered Forecourt	190m²	1bay/50m²	4bays
PETROL FILLING STATION			
Covered Forecourt	400m²	1bay/50m²	8bays
Convenience Shop	300m²	1bay/30m²	10bays
RESTAURANTS			
Ablutions	100m²	6bay/100m²	6bays
Fastfood Restaurants	675m²	6bay/100m²	41bays
CAR WASH			
2 bay car wash	50m²	6bay/100m²	3bays
TOTAL BAYS REQUIRED			71Bays
EXCESS BAYS			7Bays
TOTAL BAYS PROVIDED			78Bays
9m x4m LOADING BAYS PROVIDED			2Bays

ULUNDI PETROL FILLING STATION		
Site area	8003m²	
Low Impact Mixed Use Development		
Permitted Floor Area Ratio	6 402m²	0.8%
Permitted Coverage	3 201m²	40%
Truckstop Forecourt	190	
Petrol Filling Station Forecourt	400	
PFS Convenience Shop	300	
Fastfood Restaurants	675	
Ablutions	100	
Car Wash	50	
Total Development Area 1 715m²		
Proposed Floor Area Ratio	1715m²	0.21%
Proposed Coverage	1715m²	21.4%

SIGNATURES

Owner.....

For KHOB0 Investments Properties

Architect.....

**DRAWING: SITE DEVELOPMENT PLAN
PROPOSED NEW PFS & RESTAURANTS
ULUNDI 19 INTERSECTION**

Low Impact Mixed Use Development

Drawing Name
**Ground Floor,
Ground Floor (1)
SDP SUBMISSION**

Drawn by
W. CHIMANGO Date
MARCH 2021

Pr.Arch (SACAP)
3 MOTTRAMDALE RD
BEREA WEST 3629
WESTVILLE, DURBAN
wavell@kjwc.co.za
083 718 0201

Revision
1:250

Layout ID
SDP-001

Revision
REV. D



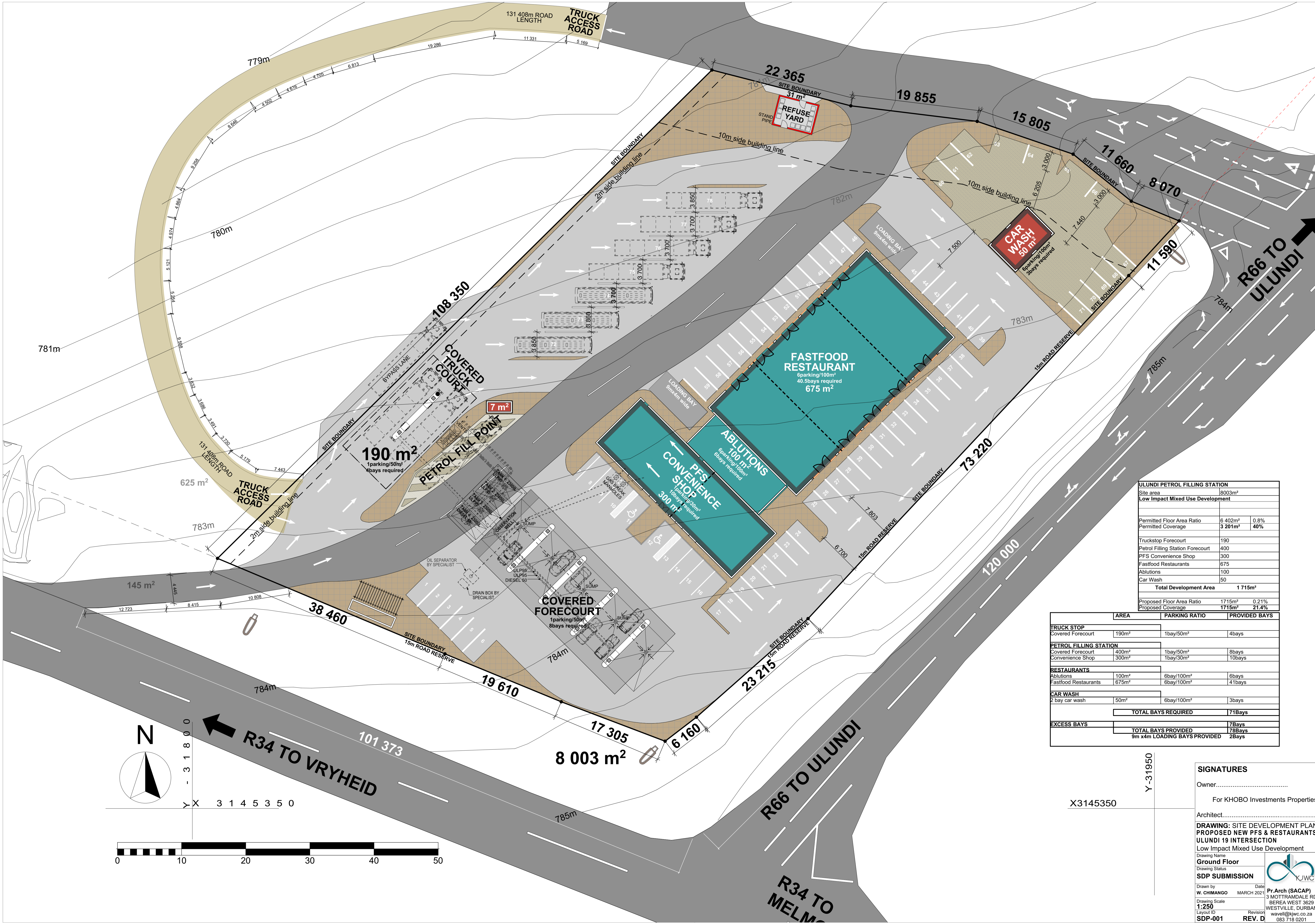

ULUNDI PETROL FILLING STATION		
Site area	18003m ²	
Low Impact Mixed Use Development		
Permitted Floor Area Ratio	6 402m ²	0.8%
Permitted Coverage	3 201m ²	40%
Truckstop Forecourt	190	
Petrol Filling Station Forecourt	400	
PFS Convenience Shop	300	
Fastfood Restaurants	675	
Ablutions	100	
Car Wash	50	
Total Development Area	1 715m²	
Proposed Floor Area Ratio	1 715m ²	0.21%
Proposed Coverage	1 715m ²	21.4%

AREA	PARKING RATIO	PROVIDED BAYS
TRUCK STOP		
Covered Forecourt	1bay/50m ²	4bays
PETROL FILLING STATION		
Covered Forecourt	1bay/50m ²	8bays
Convenience Shop	1bay/30m ²	10bays
RESTAURANTS		
Ablutions	6bay/100m ²	6bays
Fastfood Restaurants	6bay/100m ²	41bays
CAR WASH		
2 bay car wash	6bay/100m ²	3bays
TOTAL BAYS REQUIRED		71Bays
EXCESS BAYS		7Bays
TOTAL BAYS PROVIDED		78Bays
9m x4m LOADING BAYS PROVIDED		2Bays

SIGNATURES

Owner.....

For KHOB0 Investments Properties

Architect.....

**DRAWING: SITE DEVELOPMENT PLAN
PROPOSED NEW PFS & RESTAURANTS
ULUNDI 19 INTERSECTION**
Low Impact Mixed Use Development

Drawing Name
Ground Floor
Drawing Status
SDP SUBMISSION

Drawn by
W. CHIMANGO Date
MARCH 2021

Pr.Arch (SACAP)
3 MOTTRAMDALE RD
BEREA WEST 3629
WESTVILLE, DURBAN
wavell@kjwc.co.za
083 718 0201

Revision
REV. D

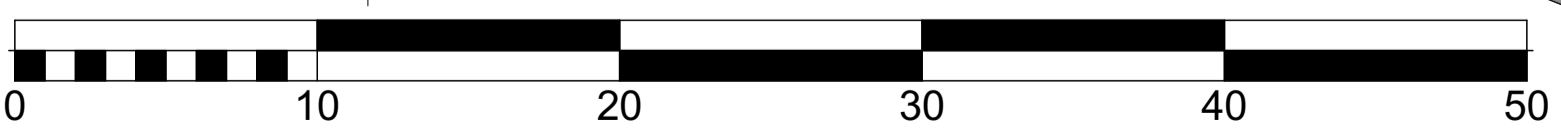
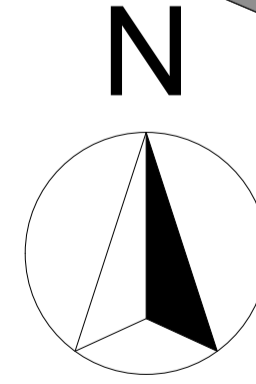

Y X 3 1 4 5 3 5 0

X3145350

Y-31950