

Reference	CAD-Line Survey-LOU
Effective Date	15/10/2015
Revision	01

Description	Quantity
Shrubs > 40 cm	
Trees	4
Trees to Trim	4
Bushclearing required (m)	65.4m

SEL375803749 (SEL346974479)

Portion 5 of the farm Rietfontein, 573 LQ

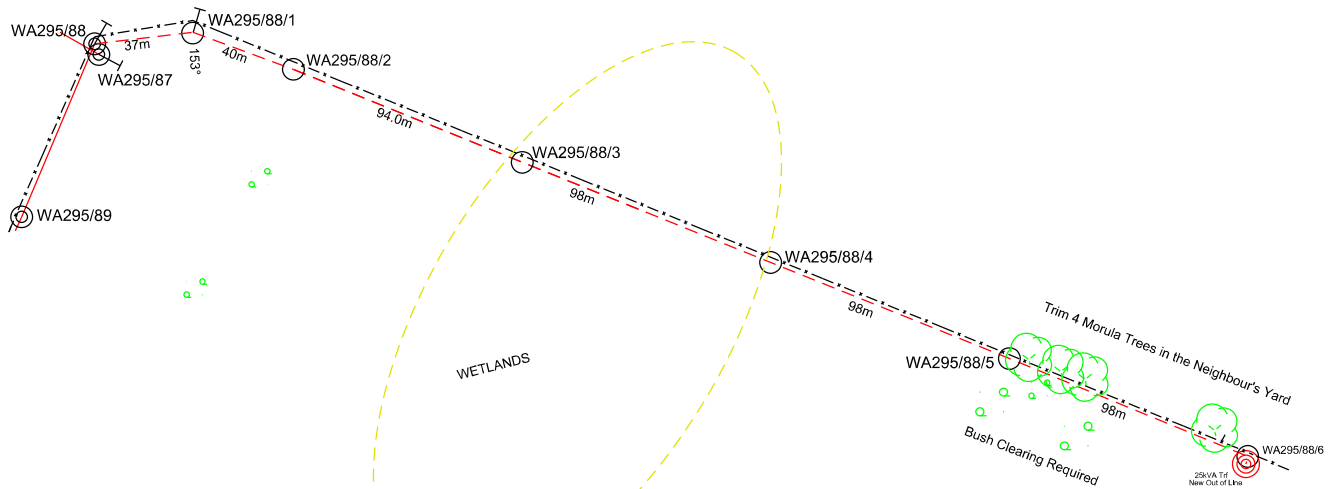

LEGEND		
	New Pole	
	New Transformer	
	Existing Pole	
	Existing Transformer	
	New Line	
	Existing MV Line	
	Tree	
	3	
	2	
	1	
T M Lebea	0	17/11/2020
SURVEYOR	REV	SURVEY DATE

FEEDER:	WATERBERG -AFGUNS 22kV	CUSTOMER:	N L Fourie
PROJECT NO:	SEL375803749 (SEL346974479)	PROPERTY:	Portion 5 of the farm Rietfontein, 573 LQ
CONDUCTOR:	(3 Phase)	CONTACT DETAILS	+2779 479 1104
LENGTH OF LINE:	470m	SCALE:	[1:2 500]
SURVEYOR:	Tshepo Lebea	PAGE:	[1] of [1]
DRAUGHTSPERSON:	Tshepo Lebea		



THIS DRAWING IS THE PROPERTY OF ESKOM
Disclaimer: Eskom is not responsible for any errors displayed on this drawing