

*W.A.B.*

S.G.O.  
Sub. Vol. 466 Fol. 1

*W.A.B.*  
Es. of D.

Reg. Div.  
FU

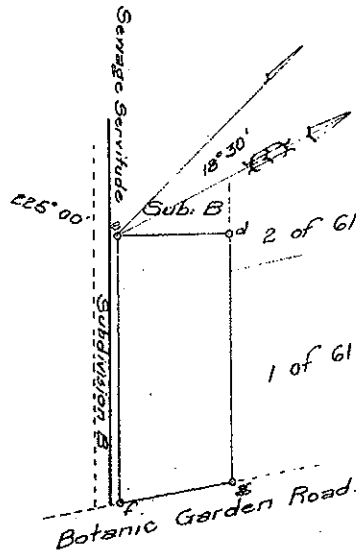

SIDES.		ANGLES	
f/e	164.07	f	79° 43
e/d	69.63	e	90 10
d/g	151.56	d	90 00
g/h	71.22	g	100 07

Now SUB 1 of  
LOT 2451 DURBAN

Now known as: Sub A of Lot 2451 Block B of the Town Lands of Durban No 1737

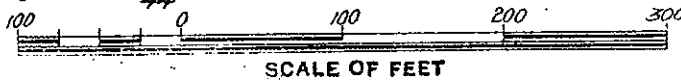

The above Diagram lettered f e d g.  
represents — Acres 1 Roods 0.497 Perches of land  
known as Subdivision A of Lot ~~2451~~ Block B  
situated in the Town Lands of the Borough of Durban,  
Province of Natal.  
Bounded as indicated above.

*D/T 4019/1920*

Surveyed by me, *Carl Hall*

Government Land Surveyor,

January 1920

*Shen Q 41 6246*