

Approved

W. A. Anderson
Surveyor General.

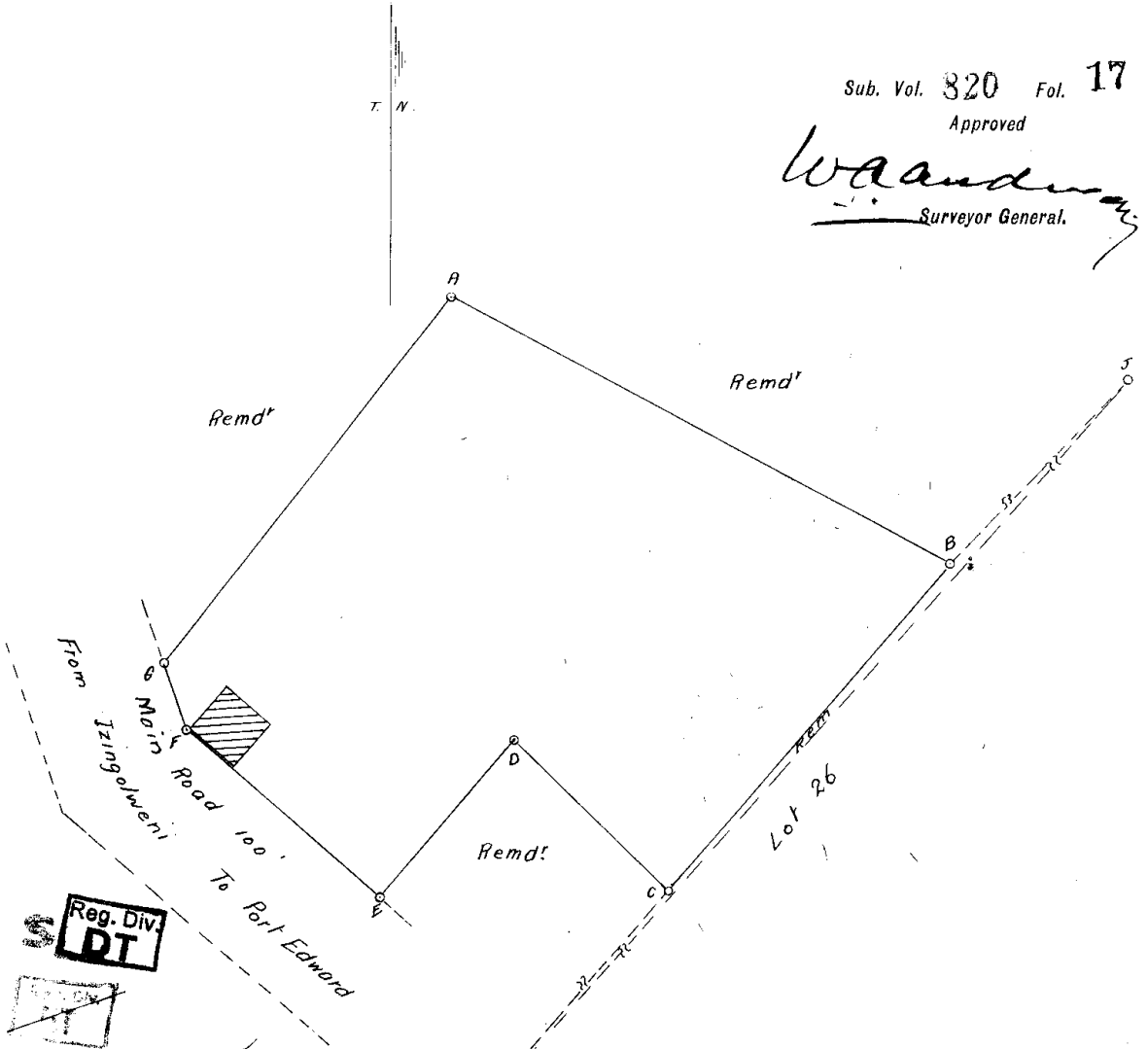

Co-ordinates.		
	Y	X
A	+ 867.83	+ 1581.69
B	+1213.93	+1399.93
C	+1021.30	+1170.80
D	+ 912.96	+1274.25
E	+ 820.46	+1165.75
F	+ 685.70	+1281.89
G	+ 671.01	+1326.33
H	0	0
J	+1000.00	+ 4339.80

Sides.	Direction Angles.	
AB	390.93	117-42-30
BC	299.35	220-3-20
CD	149.80	313-40-30
DE	142.60	220-27-30
EF	177.90	310-45-10
FG	46.80	341-41-30
GA	322.41	37-37-30
BJ	1007.30	19-25-30
JH	5902.10	222-40-0
HC	1553.70	41-5-50
CI	4050.31	43.27.40.



The Figure *ABCDEFGHIJ* Represents *2* Acres *38050* Square Feet *2/15*
of land called *Subdivision A of 27 Umtamvuna No 10259* LOT *215*
situate in the County of *Alfred* Province of *Natal*. *Bannars Rest.*

Surveyed in *November* 1930 by me

P. W. Stott
Land Surveyor

This diagram is annexed to deed of *Transfer*
No. *1545/1931*.
Dated *9 May 1931*.

(Sgd) *L. V. R. Luyt*
Registrar Deeds

Original diagram is annexed to
Deed of *Grant* No. *10259*
Dated *11th Aug 1923*
G
Sub. Vol. *353* Fol. *18*
S. Vol. *546* Fol. *9*
S.G. 504.

DTWA