

S.G. No.

226/2009

Approved

for Surveyor-General

2009.01.30

SHEET 2 OF 2 SHEETS

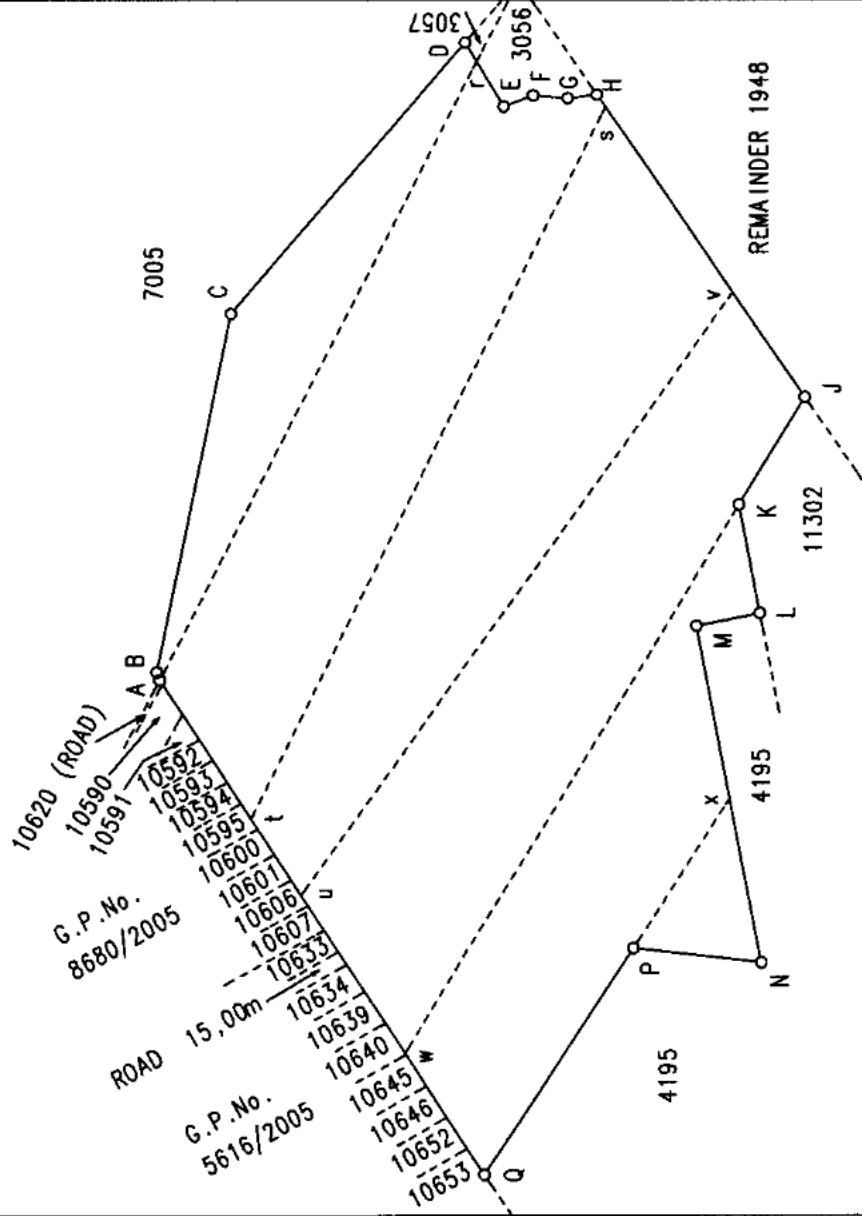
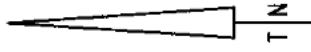

SCALE 1:7500

ERF 11305 WALMER

and comprises components (1) to (4) quoted on Sheet 1
 situate in the Nelson Mandela Bay Municipality
 Administrative District of Port Elizabeth
 Province of Eastern Cape
 Compiled in AUGUST 2007 , by me .

JOHAN MEIRING (PLS 0393)
 Professional Land Surveyor

Erf 11305 Walmer