

SIDES Metres		ANGLES OF DIRECTION		CO-ORDINATES Y System Lo 19° X			S.G. No 2363/1996
		Constant		±	0,00	+3 700 000,00	Approved <i>[Signature]</i> for Surveyor-General 1996-05-24
AB	200,82	270 45 20	A	-	2 140,81	+ 28 718,45	
BC	16,32	277 23 40	B	-	2 341,61	+ 28 721,10	
CD	12,59	282 54 00	C	-	2 357,79	+ 28 723,20	
DE	14,39	291 29 00	D	-	2 370,06	+ 28 726,01	
EF	10,59	301 29 00	E	-	2 383,45	+ 28 731,28	
FG	97,55	307 38 10	F	-	2 392,48	+ 28 736,81	
GH	15,27	318 57 20	G	-	2 469,73	+ 28 796,38	
HJ	13,94	326 46 00	H	-	2 479,76	+ 28 807,90	
JK	10,95	335 19 50	J	-	2 487,40	+ 28 819,56	
KL	33,43	346 14 30	K	-	2 491,97	+ 28 829,51	
LM	34,39	349 02 10	L	-	2 499,92	+ 28 861,98	
MN	34,43	351 59 10	M	-	2 506,46	+ 28 895,74	
NP	7,69	273 12 20	N	-	2 511,26	+ 28 929,83	
PQ	24,90	272 30 30	P	-	2 518,94	+ 28 930,26	
QR	53,53	294 11 40	Q	-	2 543,82	+ 28 931,35	
RS	91,97	41 54 20	R	-	2 592,65	+ 28 953,29	
ST	74,73	10 34 40	S	-	2 531,22	+ 29 021,74	
TU	34,76	78 39 00	T	-	2 517,50	+ 29 095,20	
UV	41,52	352 01 10	U	-	2 483,42	+ 29 102,04	
VW	366,27	96 30 10	V	-	2 489,18	+ 29 143,16	
WX	93,81	176 05 50	W	-	2 125,27	+ 29 101,68	
XA	290,47	184 19 50	X	-	2 118,88	+ 29 008,09	
Excluded Figure							Sheet No 1 of 2 Sheets
YZ	41,15	259 49 20	Y	-	2 437,14	+ 28 882,44	
ZA1	25,70	344 20 10	Z	-	2 477,64	+ 28 875,17	
A1B1	40,90	79 46 30	A1	-	2 484,58	+ 28 899,92	
B1Y	25,76	163 47 40	B1	-	2 444,33	+ 28 907,18	
Connection							
PC1	5,81	272 30 30	C1	-	2 524,74	+ 28 930,51	
C1Q	19,09	272 30 30					
		90 Diemersfontein	△	-	1 395,34	+ 26 397,05	
		28 Hawequas	△	-	6 994,99	+ 31 239,92	

Servitude Note:

The figure a b c d represents a Servitude Area vide Dgm No 6840/1986 D/S K781/1987^S.

The figure **ABCDEFGHIJKLMNOPQRSTUVWXYZ** excluding the figure **YZA1B1** represents **14,9471 hectares** of land being **Portion 9 of the Farm No 1576**

situate in the

Administrative District of **Paarl**

Province of the Western Cape

Surveyed in **January and February 1996**

[Signature]

by me,

D S HELLIG
Land Surveyor
PLS 0256

This diagram is annexed to	The original diagram is	File No. Par1. 1576
No. dated i.f.o.	No. 2354 /1996 annexed to	S.R. No.E854/1996
Registrar of Deeds	Transfer No.	Comp. BI-5CAC (3843) BI-5CCA (3847)

Portion 9 of the Farm No 1576. Administrative District of Paarl

S.G. No
2363/1996

Beacon Description

All beacons are 20 mm iron peg in stone cairn, except:

- A 20 mm iron peg at intersection of fences
- B iron rail fence post
- P not beacons
- Q 20 mm iron peg next to conical cement beacon
- R conical cement beacon
- Y Z A1 B1 corner of wall
- C1 20 mm iron peg

Approved

Approved
for Surveyor-General
1996-05-24

**Sheet No 2 of
2 Sheets**

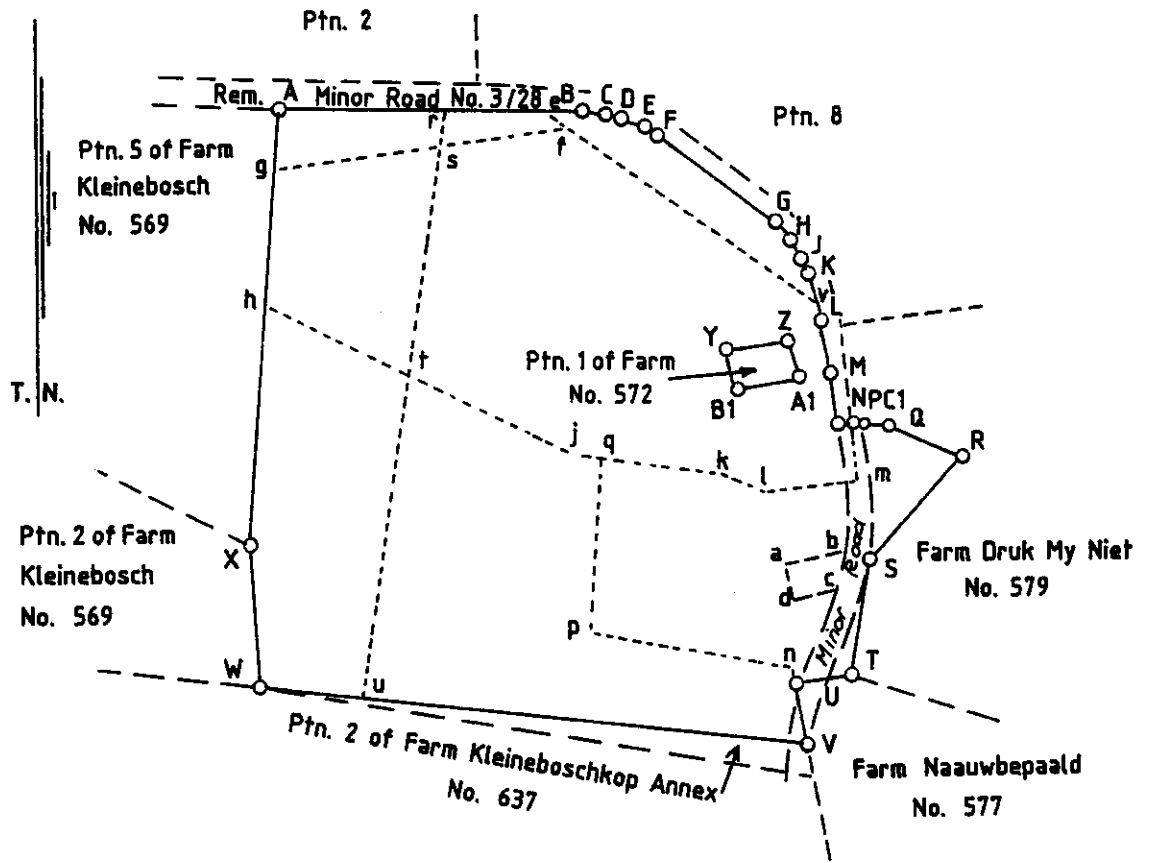

Surveyed in January and February 1996 by me.

D.S. Hellig
D.S. HELLIG

Land Surveyor
PLS 0256

Scale 1 : 5 000