

SECTIONAL DIAGRAM

System Lo 31°

3.0.1963

S.G. No. 3522/1963

SIDES ENGLISH FEET	ANGLES OF DIRECTION	CO-ORDINATES	
		Y	X
	Constant		+10,830,000.00
AB	100 . 00	298° 41' . 40"	A - 2927 . 14 + 1002 . 23
BC	123 . 00	28 . 39 . 40	B - 3014 . 86 + 1050 . 25
CD	200 . 00	118 . 41 . 40	C - 2955 . 87 + 1158 . 18
DE	22 . 00	208 . 39 . 40	D - 2780 . 43 + 1062 . 15
EF	14 . 14	343 . 40 . 40	E - 2790 . 98 + 1042 . 85
FG	90 . 00	298 . 41 . 40	F - 2794 . 95 + 1056 . 42
GA	111 . 00	208 . 39 . 40	G - 2873 . 90 + 1099 . 63
EH	131 . 00	208 . 39 . 40	H - 2853 . 82 + 927 . 90
CJ	0 . 20	208 . 39 . 40	J - 2955 . 97 + 1158 . 00
CK	216 . 00	298 . 41 . 40	K - 3145 . 34 + 1261 . 89
KL	10 . 00	208 . 41 . 40	L - 3150 . 14 + 1253 . 12

Approved

J. G. S. G. S.
Surveyor General

10 4. 1964

The figure M.N.C.D. represents an Overhead and Underground Electric Cable Servitude 8 ft. wide.

The figure Q.G.R.S.C.P. represents a Sewer and Drain Servitude 10 ft. wide.

The figure S.L.K.C. represents a Sewer and Drain Servitude 10 ft. wide over the Remainder.

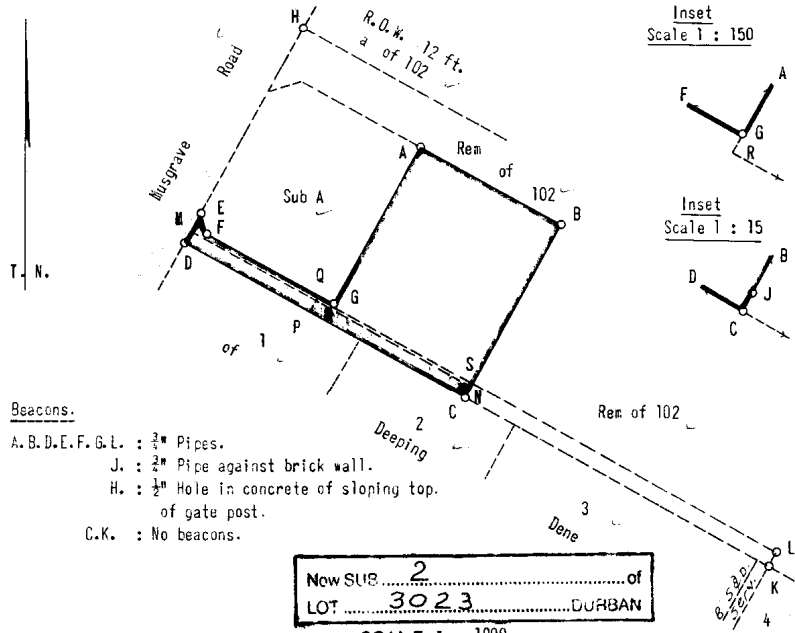

Beacons.

- A, B, D, E, F, G, L. : 2" Pipes.
- J. : 2" Pipe against brick wall.
- H. : 2" Hole in concrete of sloping top of gate post.
- C, K. : No beacons.

Now SUB 2 of
LOT 3023 DURBAN

SCALE 1: 1000

The figure A.B.C.D.E.F.G. represents 13551 Square Feet of land being

SUB B OF 102 BLOCK B OF THE TOWN LANDS OF DURBAN NO. 1737

situate in the City of Durban, Province of Natal

Surveyed in November and December, 19 63, by me *M. B. Jacobs*

Land Surveyor

This Diagram relates to <i>3522/1963</i> No. <i>3522/1963</i>	The original diagram is S.V. No. 57 Fol. 104 relating to Deed of <i>Transfer</i> No. <i>1238/1981</i>	File No. <i>8/14</i> Survey Records <i>889/63</i> Compilation <i>11/8/45</i> Degree Sheet <i>59</i> Tracing General Plan <i>Dbn. 76</i>
---------------------------------------------------------------------	----------------------------------------------------------------------------------------------------------------	-------------------------------------------------------------------------------------------------------------------------------------------------------------------

H. & H. LTD. - 71995