

SITE PLAN



DESIGN CONCEPT:

1. Placement of buildings so they are not visible from the park.
2. The design links up with the axis of existing Chief's compound / ancestors' day visitor centre.
3. Clearly defined access point & entrance route from bus drop-off.
4. Secure, grassed arrival & waiting area for check-in and room allocation of large groups.
5. Centrally located cafeteria block with kitchen & support services.
6. Secure grassed playground & dance area.
7. Hostel broken up into smaller, single storey buildings with courtyards in between.
8. Proposed security line integrated with building edges for safety and minimum visual impact.
9. Sustainable design:
 - Buildings face north with generous shading overhangs.
 - Roof rainwater collected for irrigation, showers & toilets.
 - Solar geysers.
10. Teachers & drivers block provides flexible accommodation (1/2 persons per room) and can be used for other overnight visitors.
11. x5 hostel units composed of 2x 12 bed rooms with ablutions (= 24 beds / unit=120 beds total).

Note:
Can be divided into 2 bus groups and proportionally between boys & girls.
This is a flexible arrangement for managing various types of groups (large/small, boys/girls, older/younger).

Note:
Each 12 Bed room units consists of 4 single beds and 4 double bunk beds.

AREA:

1. DINING BLOCK	= 410 M ²
2. HOSTEL 5x 149M ²	= 745 M ²
3. TEACHERS BLOCK	= 155 M ²
GROSS TOTAL M²	= 1310 M²
(excl. walkways)	

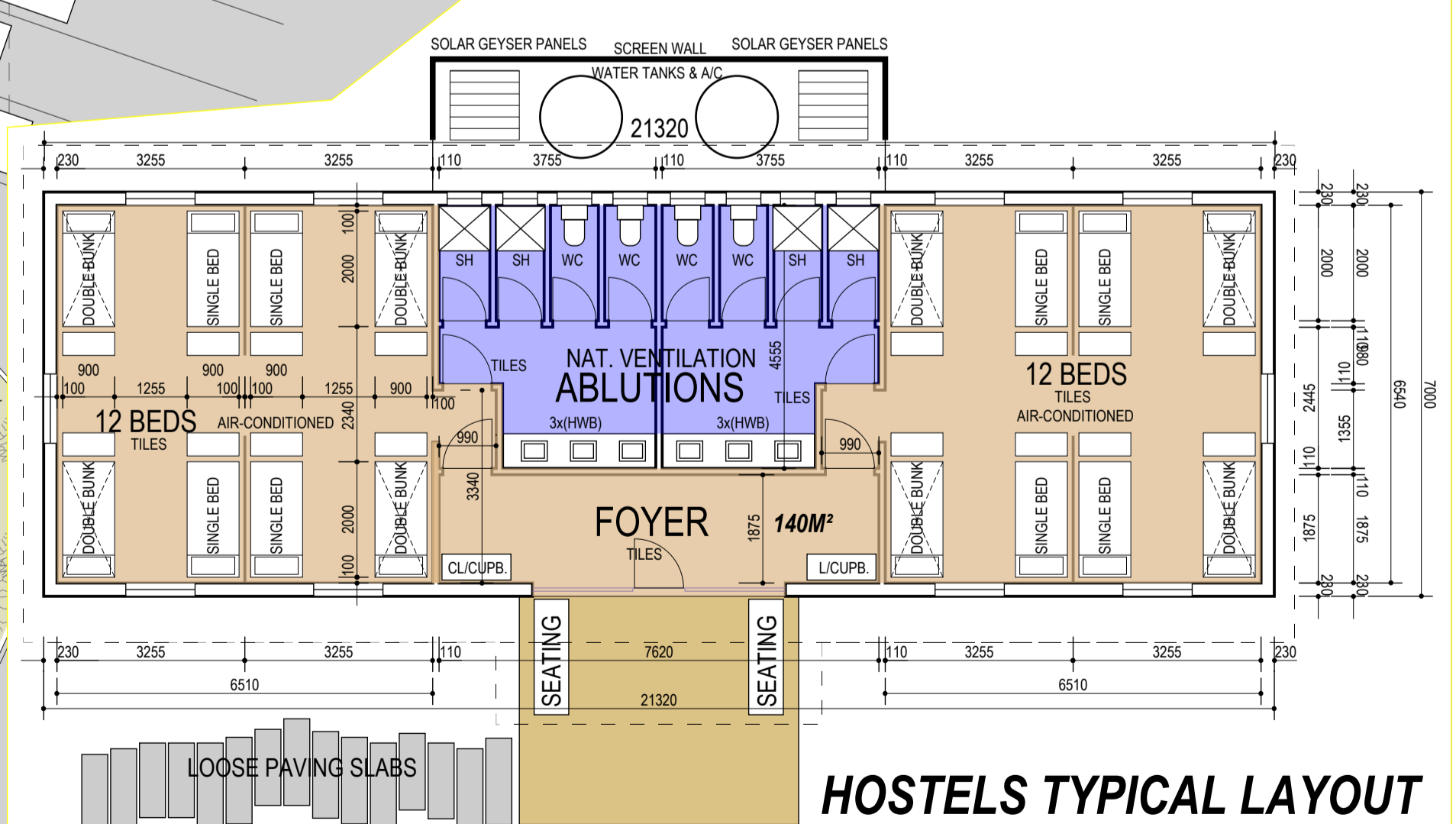

HOSTELS TYPICAL LAYOUT

NEW HOSTELS FOR MAPUNGUBWE NATIONAL PARK

SKETCH PLAN PROPOSAL 2015-5-15

REVISION A (2015-05-15): -MOVE HOSTELS ±7METERS EAST AND 17METERS NORTH TO ACCOMMODATE BUS PARKING AREA BY ENGINEER
-ENLARGE HOSTELS BY ±14M² ON SIDES

