

GVKK75/16
 28° 46' 51.5" E
 26° 41' 38.6" S

NEW 200KVA TRFR
 @ GVKK75/16/7
 28° 47' 13.0" E
 26° 41' 43.9" S

PLEASE NOTE: TREES/PLANTS MAY BE CUT/TRIMMED/REMOVED UNLESS THE APPLICABLE TREE PERMIT IS ISSUED AND HANDED TO THE CONSTRUCTION CONTRACTOR.
 Note: RED PEGS on site indicate structure position.

WITPOORT 545 - IR

200KVA Trfr
 Project no: BS102566709
 P BEZUIDENHOUT (LPU)
 Drwn by: THULI THEBE
 Date: 02/04/2014
 Surveyed by: ALEX MAHLANGU

T-Off Pole no: GVKK75/16
 T-Off angle 80:04:16
 11KV Line
 616.31m Length of Line

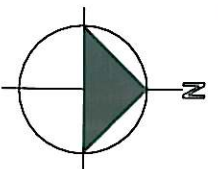

GVKK75/16
28° 46' 51.5" E
26° 41' 38.6" S

EXISTING 11KV
POWERLINE

GVKK75/17

46.28m

GVKK75/16/1

115.10m

GVKK75/16/2

82.88m

GVKK75/16/3

104.72m

GVKK75/16/4

97.59m

GVKK75/16/5

93.82m

GVKK75/16/6

75.92m

NEW 200KVA TRFR
@ GVKK75/16/7
28° 47' 13.0" E
26° 41' 43.9" S

GRAVEL ROAD

PORTION 4

PORTION 3

STREAM

STREAM

DAM

DAM

WITPOORT 545 - IR

200KVA TRFR
Project no: BS102566709
P BEZUIDENHOUT (LPU)
Drawn by: THULI THEBE
Date: 02/04/2014
Surveyed by: ALEX MAHLANGU

PLEASE NOTE:
NO PROTECTED TREES/PLANTS MAY BE CUT/TRIMMED/REMOVED UNLESS THE APPLICABLE TREE PERMIT IS ISSUED AND HANDED TO THE CONSTRUCTION CONTRACTOR.

Note: RED PEGS on site indicate structure position.

T-Off Pole no: GVKK75/16
T-Off angle 80:04:16
11KV Line
616.31m Length of Line

DASHED RED LINE INDICATES POWERLINE ROUTE

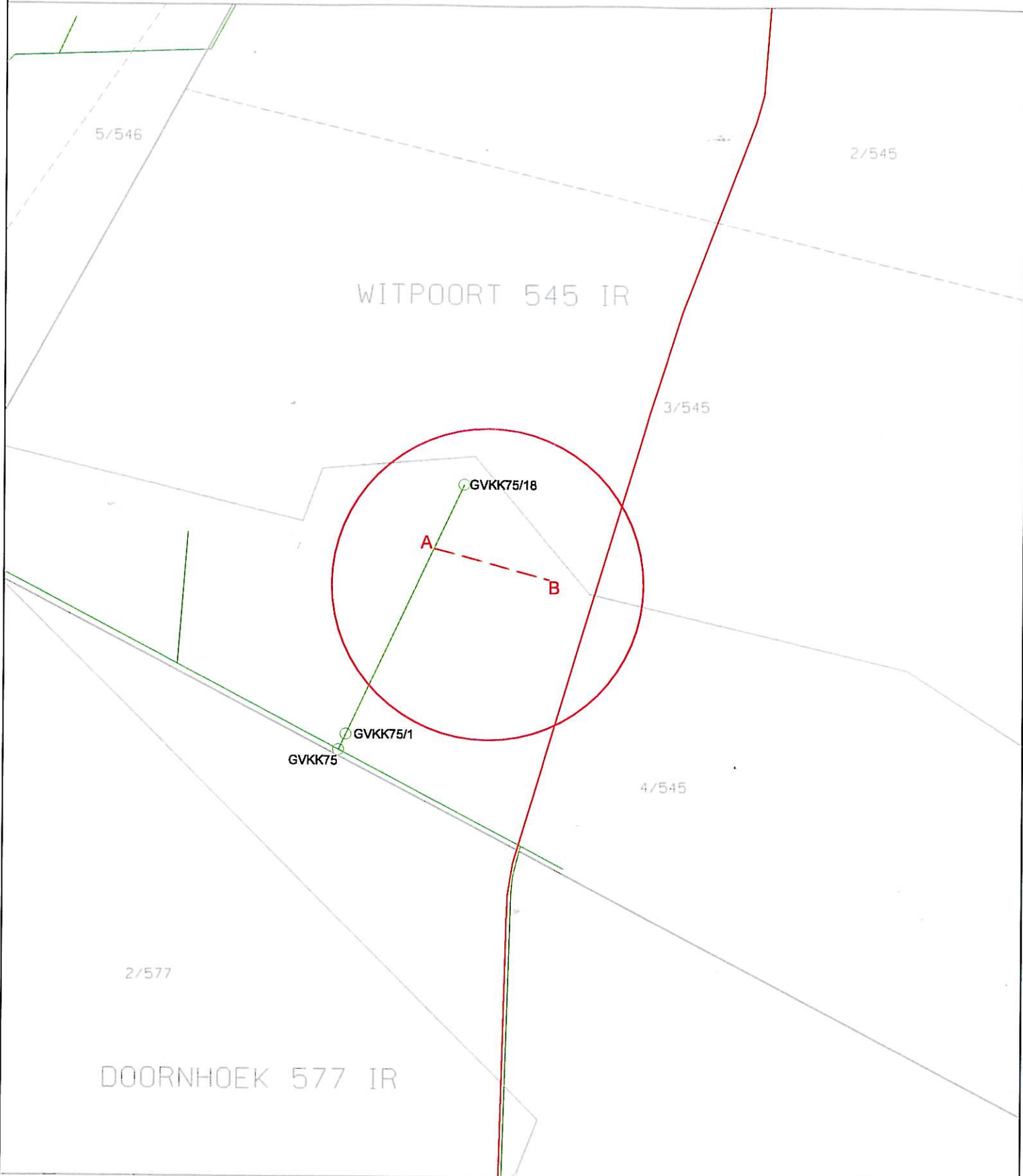

Route plan
Northern Region

Disclaimer
Geographic Mapping Witsark are not responsible for any errors in external datasets displayed on this map. The following external datasets were used:
Cadastral and Topographical

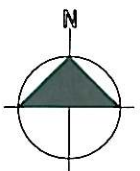

WG884

| | |
|-----------------|--------------------------------------|
| Feeder: | GREYLINGSTAD / VAN KOLDERSKOP 1 11kV |
| Customer: | P BEZUIDENHOUT(LPU) |
| Project No: | BS102566709 |
| FSA / TSA Area: | SECUNDA FSA / GROOTFLEI TSA |

Portion of map no: 2628 DB S

Scale: 1:25 000

DASHED RED LINE INDICATES POWERLINE ROUTE

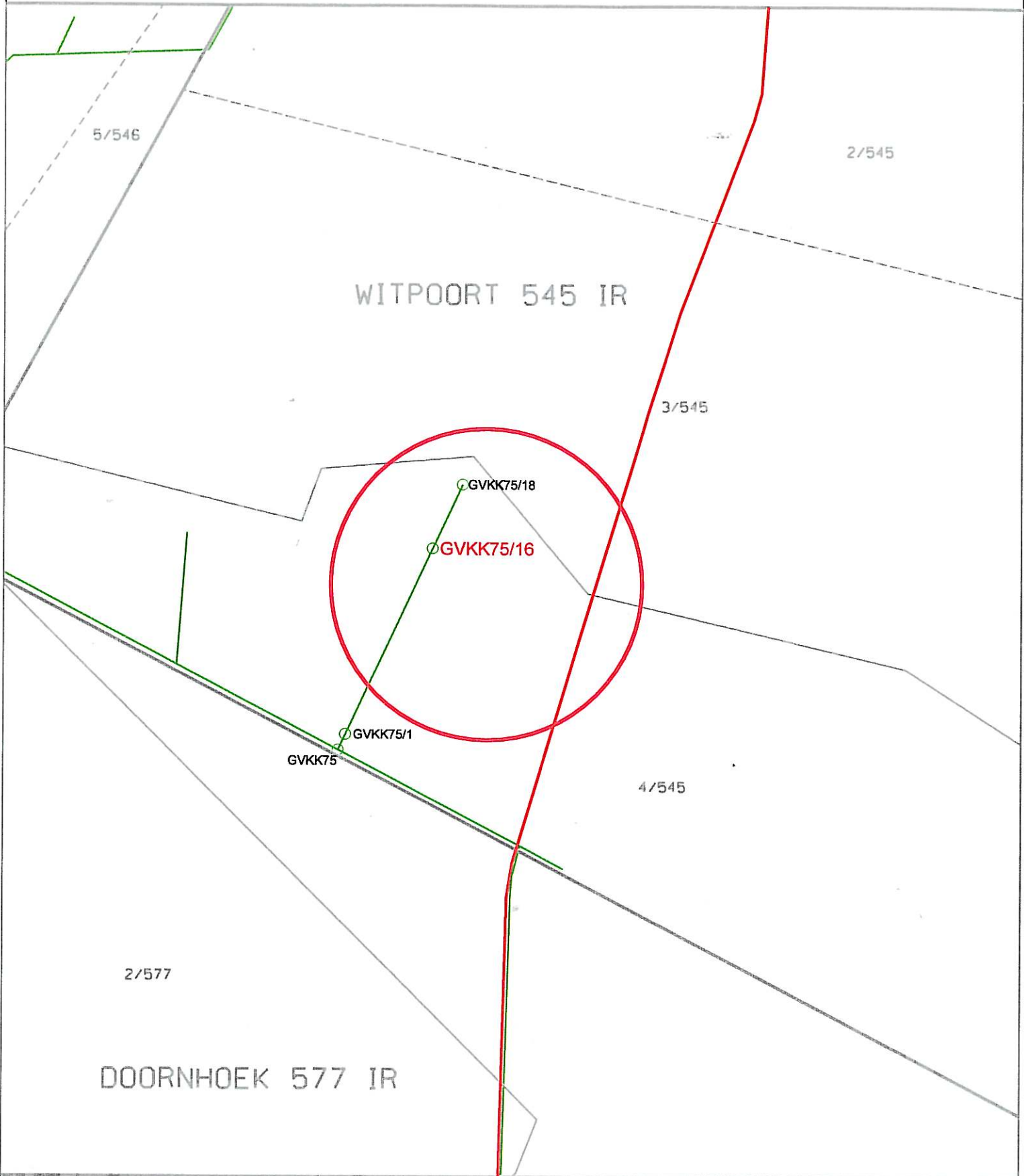

Route plan
Northern Region

Disclaimer
Geographic Mapping Witbank are not responsible for any errors in external datasets displayed on this map. The following external datasets were used:
Cadastral and Topographical

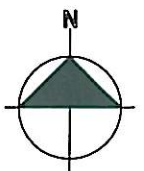

WG884

Feeder: GREYLINGSTAD / VAN KOLDERSKOP 1 11kV

Customer: P BEZUIDENHOUT(LPU)

Project No: BS102566709

FSA / TSA Area: SECUNDA FSA / GROOTFLEI TSA

Portion of map no: 2628 DB S

Scale: 1:25 000

DASHED RED LINE INDICATES POWERLINE ROUTE

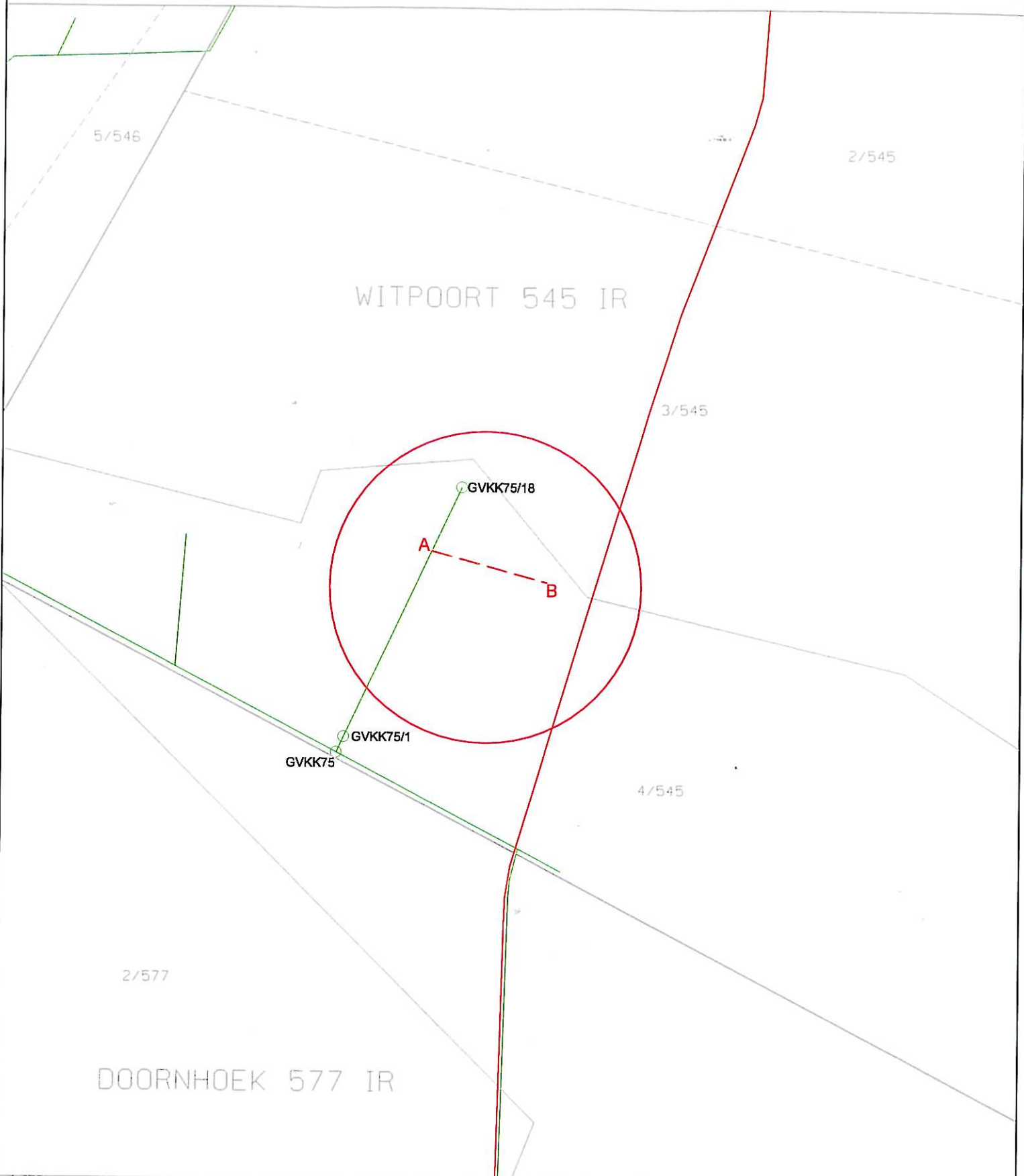

Route plan
Northern Region

Disclaimer
Geographic Mapping Wikitrack are not responsible for any errors in external datasets displayed on this map. The following external datasets were used:
Cadastral and Topographical

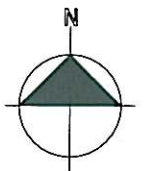

W0004

Feeder: GREYLINGSTAD / VAN KOLDERSKOP 1 11kV

Customer: P BEZUIDENHOUT(LPU)

Project No: BS102566709

FSA / TSA Area: SECUNDA FSA / GROOTFLEI TSA

Portion of map no: 2628 DB S

Scale: 1:25 000

LOCALITY PLAN

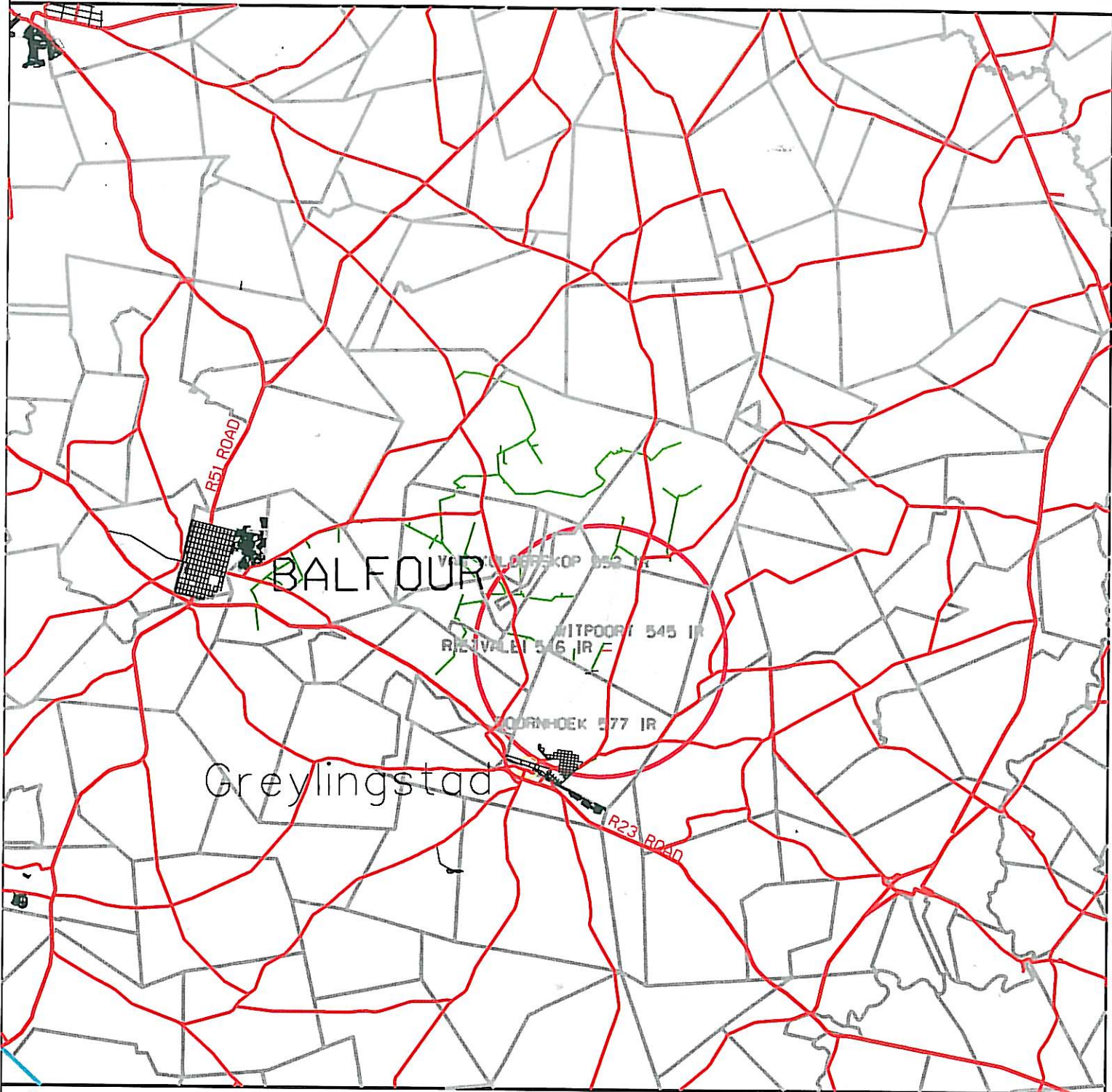

Disclaimer
Geographic Mapping Witbank
are not responsible for any errors
in external datasets displayed on this map.



COORDINATE SYSTEM: LO84/29

SCALE 1:250 000

Information from official maps reproduced under Government printers copyright authority No. 4138 of 28/03/1989



Northern Region
Land Development

P.O.Box 223
Witbank 1035
Tel 013 - 693 3121
Fax 013 - 693 3261

| | | | |
|--------------------|--------------------------------------|---------------------|--|
| Feeder: | GREYLINGSTAD / VAN KOLDERSKOP 1 11kV | Surveyor: | |
| Customer: | P BEZEIDENHOUT (LPU) | Geographic mapping: | A MABESELE |
| Project No: | BS102566709 | Date compiled: | 07/03/2014 |
| Portion of map no: | 2828 DB S | T-OFF POLE COORD: | Y=21876.5210 28° 48' 48.7" E X=2953917.1296 26° 41' 44.0" S |
| Page: | 1 of 3 | Revised by: | |
| | | Revision date: | |