

LOCALITY PLAN

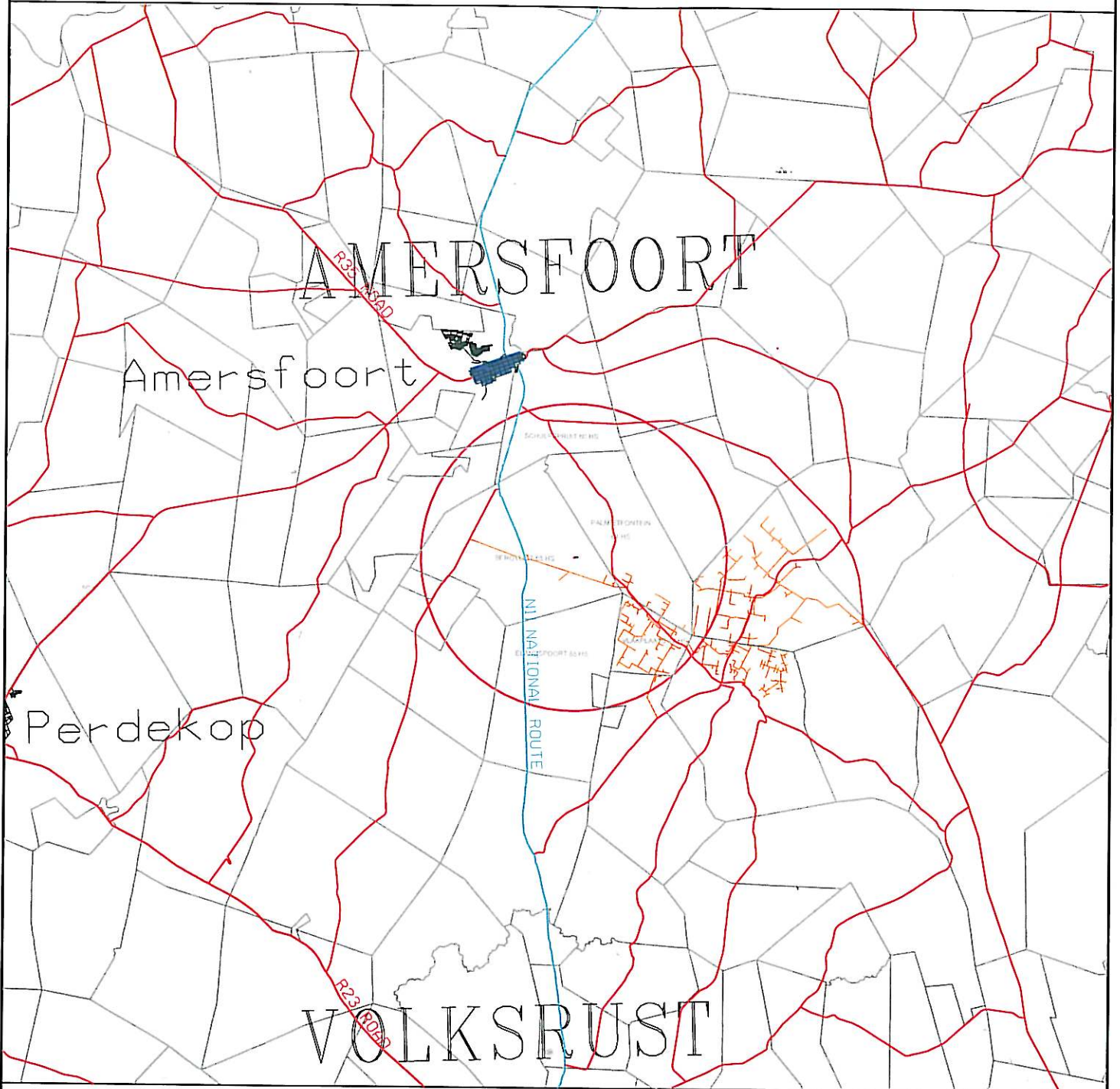



Disclaimer  
 Geographic Mapping Witbank  
 are not responsible for any errors  
 in external datasets displayed on the map.
 

**COORDINATE SYSTEM: LO84/31**

**SCALE 1:250 000**

Information from official maps reproduced under Government printers copyright authority No. 4138 of 28/03/1989

	Northern Region Land Development	P.O.Box 223 Witbank 1035 Tel 013 - 693 3121 Fax 013 - 693 3261
---	-------------------------------------	---

Feeder: Bergvliet NB122 22kV Line	Surveyor:
Customer: MP KHUMALO	Geographic mapping: NTOMBI MASANGO
Project No: BV104530873B	Date compiled: 24/04/2014
Portion of map no: 2529 BB N	T-OFF POLE COORD: Y=108879.2240 29° 54' 7.9"E X2998065.9290 27° 5' 23.6"S
Page: 1 of 3	Revised by:
Revision date:	

DASHED RED LINE INDICATES POWERLINE ROUTE

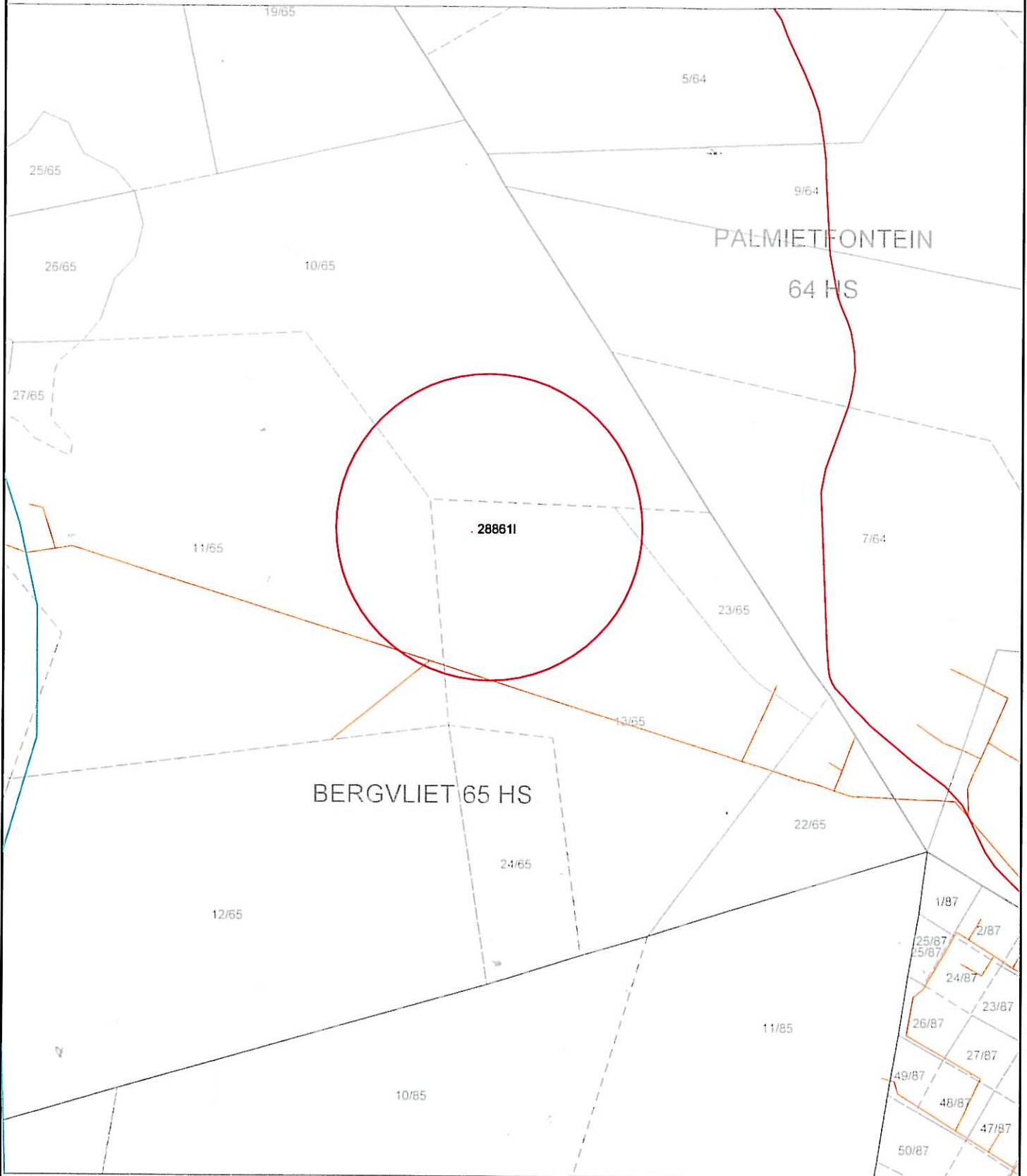

Route plan  
Northern Region

**Disclaimer**  
Geographic Mapping Wikians are not responsible for any errors in external datasets displayed on this map. The following external datasets were used: Cadastral and Topographical

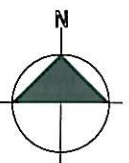

WGS84

Feeder:	Bergvliet NB122 22kV Line
Customer:	MP KHUMALO
Project No:	BV104530873B
FSA / TSA Area:	SECUNDA FSA / VOLSKRUST CNC

Portion of map no: 2529 BB N

Scale: 1:25 000

BV104530873B MP KHUMALO.DGN 24/04/2014 11:42:36 AM