



AREA: <u>NAAUWPOORT</u>	PROJECT NO. <u>SE CLARR</u>
FEEDER: <u>LANDAU 4 TEE / LANDAU 4 11kV</u>	
SUPPLY TO: <u>LANDAU 4 TEE CECIARRK</u>	
ESKOM REPRESENTATIVE: <u>TF Khangale</u>	TEL: <u>013 693 3148</u>
*DISTRIBUTION/*TRANSMISSION	FAX: <u>NONE</u>

WAY LEAVE AGREEMENT OVERHEAD POWER LINE/UNDERGROUND CABLE(S)

I/We, the undersigned (full names)

u X Philippus Jacobus
Du Plessis

(* If Company/CC/Trust, complete capacity of authorised persons)

u X (Identity number: 4805295108086 married out of community of property with/without accrual/marital power)

u X Address: GEDEELTE 31, Naauwpoort District
Mullerbank Postal Code 1035

Tel No.: 0825520520

being the REGISTERED OWNER/S
and

N/A

(Identity number: married out of community of property with/without accrual/marital power)

Address: Postal Code

Tel No.:
being the *PURCHASER/LESSEE/USUFRUCTUARY/HEIR/OCCUPANT

(hereinafter referred to jointly or individually as the "Owner") of the following property/properties:

Portion 31 Farm Naauwpoort
335 JS

X IF *u* J.D.N.

- 2 -

situate in the Administrative District of Witbank
Emahlaleni held by virtue of Title
 Deed/s
 number/s T 65253/1988 extent 60 ha 61 ha

(* Delete if not applicable)

(hereinafter referred to as the "Property") hereby grant/s to Eskom Holdings Limited, Registration Number 2002/015527/06, its successors in title, assignees, licensees, (hereinafter referred to as "Eskom") an irrevocable right of way leave in perpetuity free of charge to transmit electricity over the property:

1. The right of WAY LEAVE shall be binding on the Owner, its heirs, assignees and successors in title and shall include the following rights in favour of Eskom:

- X
TF
J.J.N.
- 1.1 the right to erect an overhead power line/underground cable(s) together with such structures, works, appliances, apparatus, conductors and overhead cables ("works") on the property or to erect or lead such conductors or appliances or other equipment on, under or over the property substantially on the route as indicated by the letters A..B..and..C on the sketch attached hereto, as may at any time be necessary or convenient in exercising the right of way leave for overhead power line(s) / underground cable(s) (hereinafter together with the restriction area referred to in 3.1, referred to as the "Servitude Area").
 - 1.2 the right to enter and be upon the property at any time in order to construct, erect, operate, use, maintain, repair, re-erect, remove, alter or inspect the structures, works, appliances, apparatus, conductors or cables ("works") on the property, or in order to gain access to any adjacent properties in the exercise of similar rights.
 - 1.3 the right to have access to and egress from the power lines and the right to use existing roads giving access to and egress from the property or roads running across the property and gates on the property and to erect in any fence such gates as may be necessary or convenient to gain access to and egress from any power line/underground cable or accessory equipment.
 - 1.4 the right to remove any trees, bush, grass, material or structures within the restricted area defined in clause 3 hereof and the right to cut or trim any trees in order to comply with the restrictions referred to in clause 3 hereof, after consultation with the land owner/s.

2. Eskom shall exercise its rights subject to the following terms and conditions -

- 2.1 Eskom shall ensure that any gates used by its personnel shall be kept closed.
 - 2.2 Eskom shall pay compensation:
 - 2.2.1 where damage is caused intentionally to any property by Eskom, its employees or contractors, to enable Eskom to use or continue to use the servitude area for its intended purpose.
- X TF J.J.N.

2.2.2 where damage or injury is caused by any negligent act or omission on the part of Eskom, its employees or contractors;

3. The following special restrictions are placed on the use of the property namely -

- 3.1 No building or structure may be erected or installed above or below the surface of the ground, neither may any material which might endanger the safety of this power line/underground cable be placed within metres of the centre line of this power line/underground cable without the prior written permission of Eskom.
- 3.2 No mining activities or blasting operations shall be permitted within 500 metres of any power line/underground cable without the prior written permission of Eskom.
- 3.3 The Owner shall not plant or allow to grow any tree in the servitude area nor plant or allow to grow in the vicinity of a power line/underground cable any tree that could grow to a height in excess of the horizontal distance of that tree from the nearest conductor of such power line or allow it to grow in such a manner as to endanger that line should it fall or be cut down.

X M.

4. The right of way leave hereby granted to Eskom -

- 4.1 shall be binding on the heirs, assignees and successors in title of the owner.
- 4.2 shall be brought to the attention of any purchaser or transferee of the property (or of any portion of the property) by the owner or the seller (at that time) of the property before the property (or any portion thereof) is sold and/or transferred to such purchaser or transferee.
- 4.3 shall, if Eskom so requests, be incorporated into a notarial deed of servitude and be registered against the title deed under which the property is held; on Eskom's costs the owner and/or its heirs, assignees and successors in title shall perform all necessary actions and sign all necessary documents to achieve the notarial execution and registration (in the office of the Registrar of Deeds) of a deed of servitude, as envisaged above.

5. Remarks / Special Conditions:

.....

X M. J.S.N.

X Signed at Witbank on this 4th day of June 20.....

AS WITNESSES:

X 1. [Signature]
2. _____

X [Signature]
REGISTERED OWNER(S)/PURCHASER/
LESSEE/USUFRUCTUARY/HEIR/
OCCUPANT*/SPOUSE IF MARRIED IN
COMMUNITY OF PROPERTY

Signed at _____ on this _____ day of _____ 20.....

AS WITNESSES:

1. _____
2. _____

REGISTERED OWNER(S)/PURCHASER/
LESSEE/USUFRUCTUARY/HEIR/
OCCUPANT*/SPOUSE IF MARRIED IN
COMMUNITY OF PROPERTY

Signed at WITBANK on this 13 day of JUNE 2014

AS WITNESSES:

1. [Signature]
2. [Signature]

[Signature]
for and on behalf of
ESKOM HOLDINGS LIMITED

(* Delete whichever is not applicable)

DASHED RED LINE INDICATES POWERLINE ROUTE

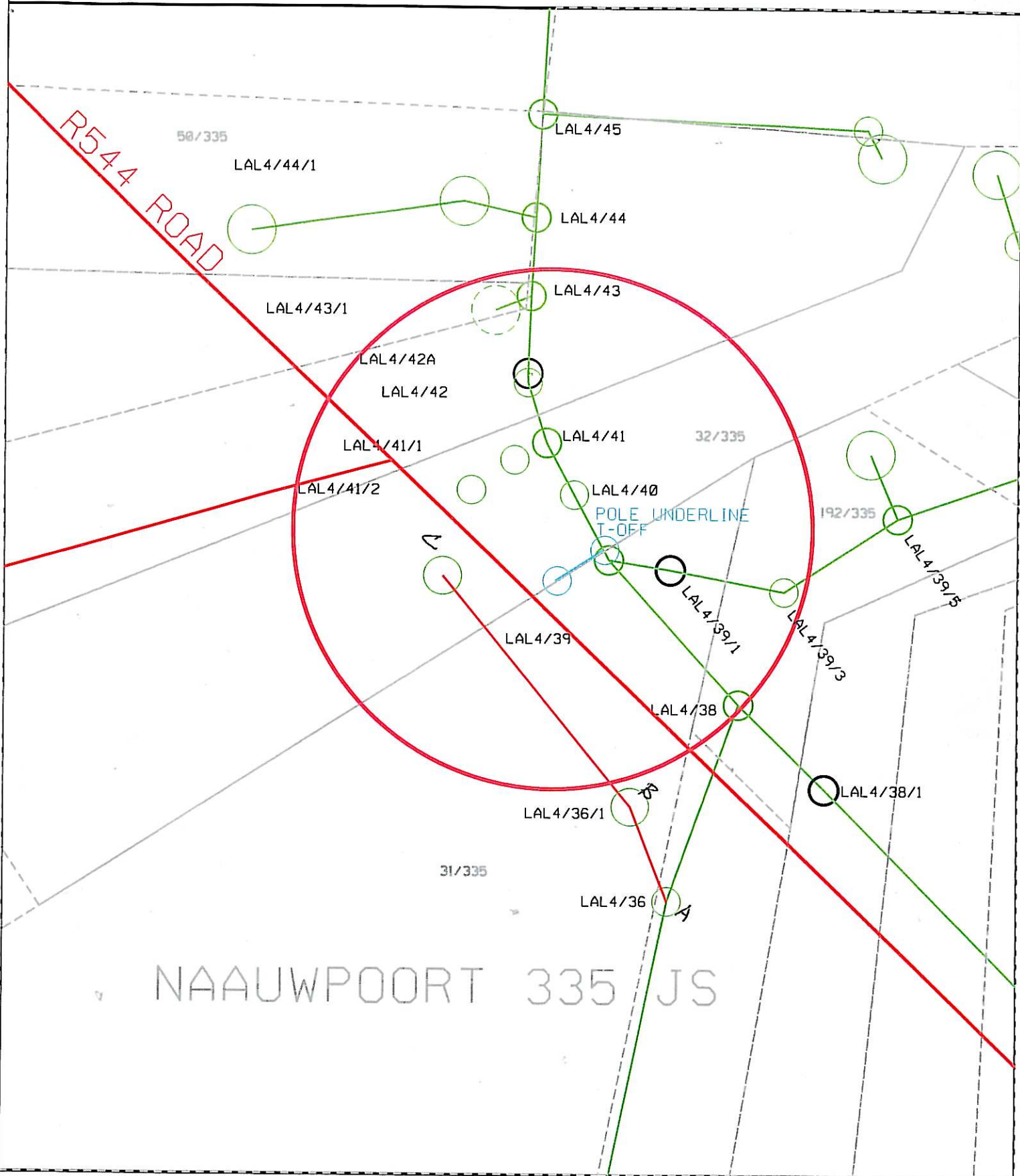

Wayleave
Northern-Region

Property description:

Disclaimer
Geographic Information Systems
are not responsible for any errors
in external datasets displayed
on this map.

Registered Owner: *[Signature]*
Witness: 1. *[Signature]*
Witness: 2. _____

Eskom: *[Signature]*
Witness: 1. _____
Witness: 2. *[Signature]*

Project No: SE CLARK
Date: _____
Portion of map no: 2529 CD S
Scale: 1:25 000



