

LOCALITY PLAN

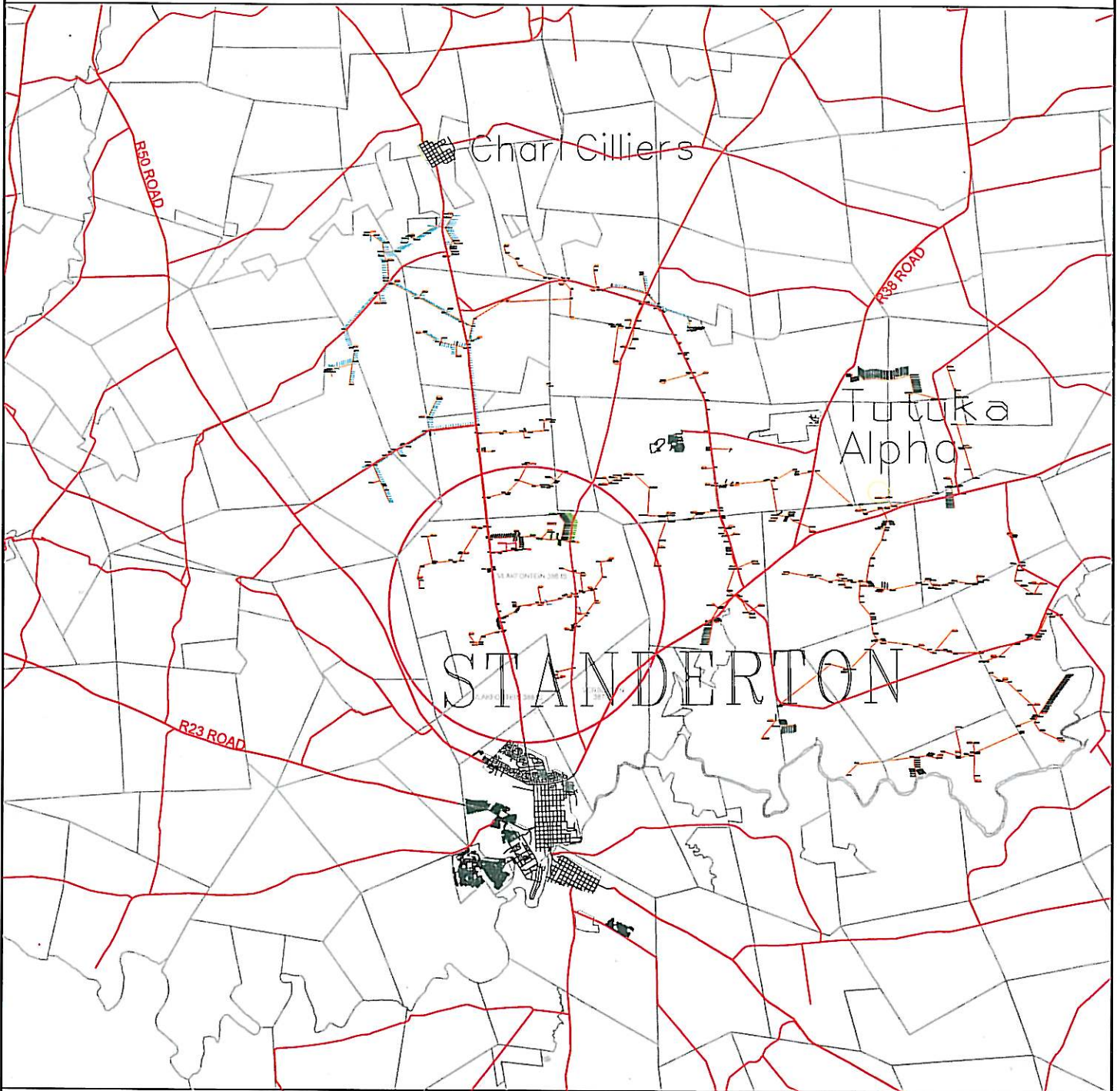

Disclaimer
Geographic Mapping information
are not responsible for any errors
in external documents displayed on this map.



COORDINATE SYSTEM:LO84/29

SCALE 1:250 000

Information from official maps reproduced under Government printers copyright authority No. 4138 of 28/03/1969



Mpumalanga Operating Unit
Land Development

P.O.Box 223
eMalaheni 1035
Tel 013 - 693 3121
Fax 013 - 693 3261

Feeder:	NEW DENMARK-NEW DENMARK 22kV	Surveyor:	
Customer:	GERT KOCH EIEINDOMME (COMPLEX)	Geographic mapping:	NTOMBI MASANGO
Project No:	BS120324401	Date compiled:	15/07/2014
Portion of map no:	2629 CC N	T-OFF POLE COORD:	Y=22971.6978 29° 13' 52.1"E X=2971476.9148 26° 51' 14.3"S
Page:	1 of 3	Revised by:	

DASHED RED LINE INDICATES POWERLINE ROUTE

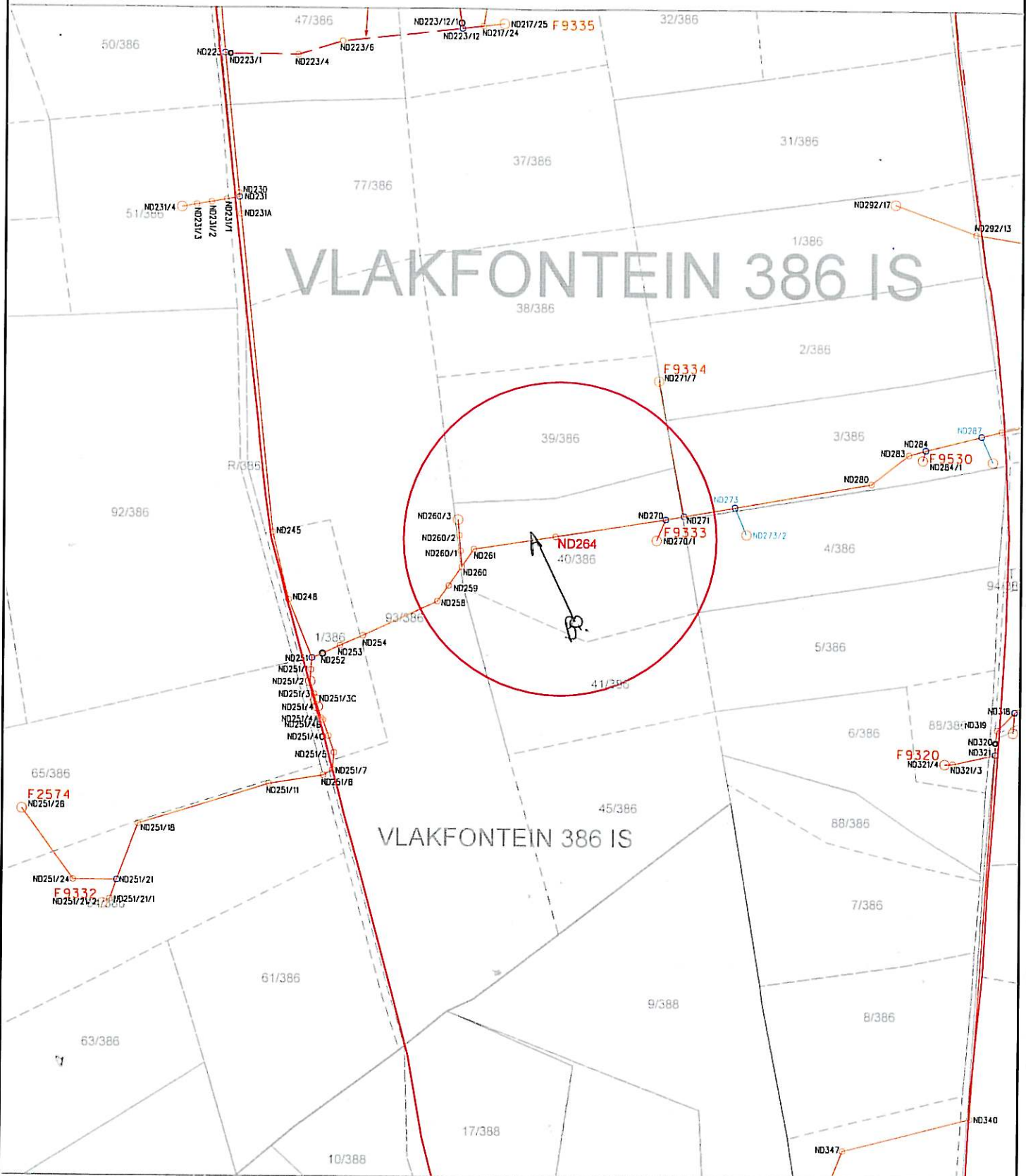

Route plan
Mpumalanga Operating Unit

Disclaimer
Geographic Mapping establishments are not responsible for any errors in external datasets displayed on this map. The following external datasets were used:
Cadastral and Topographical

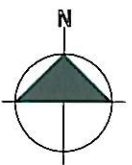

Feeder:	NEW DENMARK-NEW DENMARK 22kV
Customer:	GERT KOCH EIEINDOMME
Project No:	BS120324401
FSA / TSA Area:	SECUNDA FSA / STANDERTON TSA

Portion of map no: 2629 CC N

Scale: 1:25 000

BS120324401 - GERT KOCH EIEINDOMME (COMPLEX).DGN 15/07/2014 09:07:42 AM

DASHED RED LINE INDICATES POWERLINE ROUTE

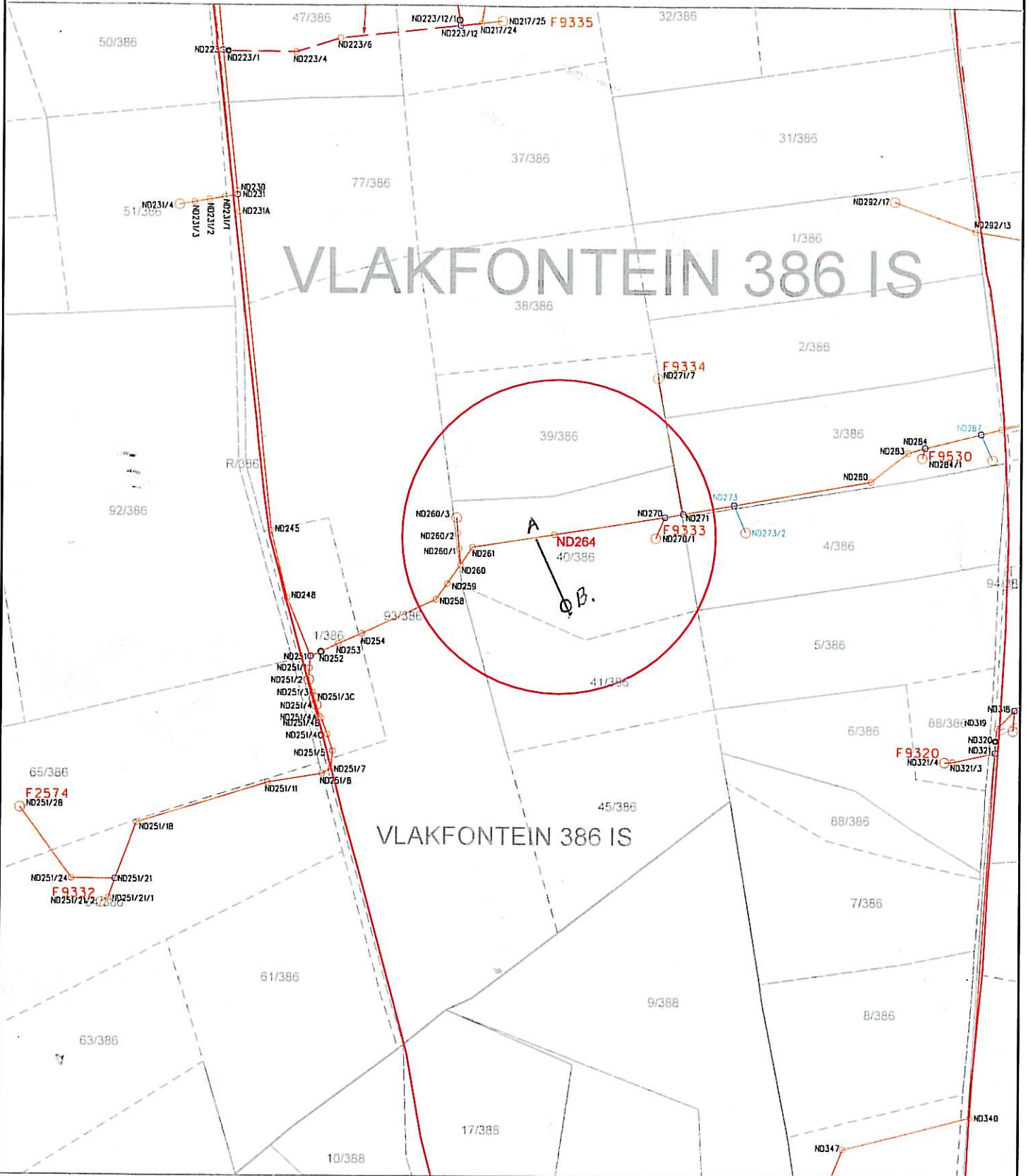

VLAKFONTEIN 386 IS

VLAKFONTEIN 386 IS



Wayleave
Mpumalanga Operating Unit

Property description:

Disclaimer
Geographic information elaborations
are not responsible for any errors
in material obtained displayed
on this map.

Registered Owner:	<i>[Signature]</i>	Eskom:	_____	Project No:	BS120324401
Witness 1:	<i>[Signature]</i>	Witness 1:	_____	Date:	_____
Witness 2:	<i>[Signature]</i>	Witness 2:	_____	Portion of map no:	2629 CC N
				Scale:	1:25 000

