

WG304

SCALE 1:5000

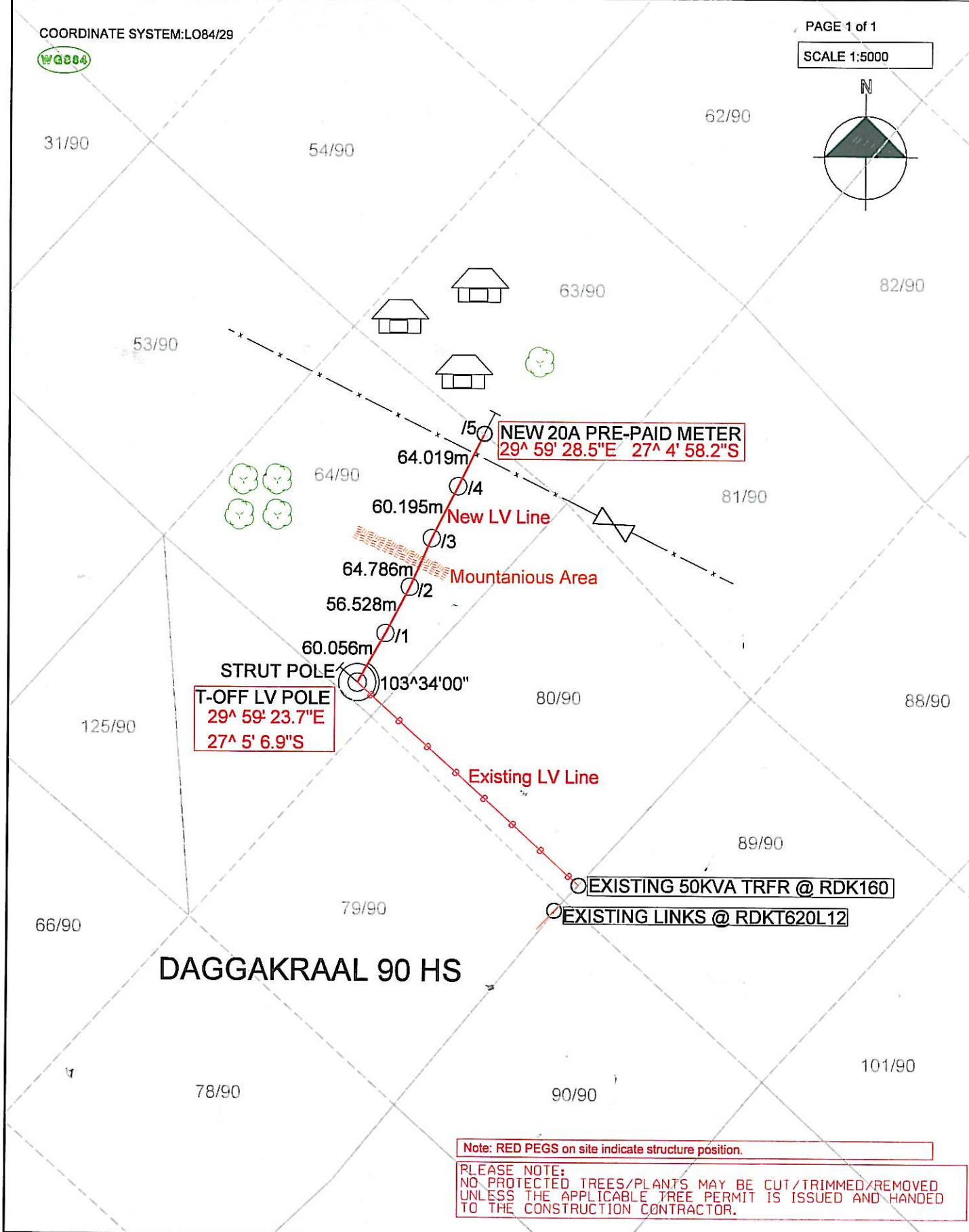
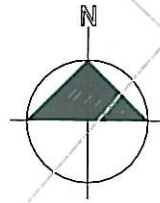

Note: RED PEGS on site indicate structure position.

PLEASE NOTE:
NO PROTECTED TREES/PLANTS MAY BE CUT/TRIMMED/REMOVED
UNLESS THE APPLICABLE TREE PERMIT IS ISSUED AND HANDED
TO THE CONSTRUCTION CONTRACTOR.

PRE-PAID METER	T-Off Pole no: LV POLE (NOT PROVIDED)
Project no: BV126785739	T-Off angle 103:34:00
THETHIWE MARIA DLAMINI	BUNDLE CONDUCTOR
Drawn by: NTOMBI MASANGO	305.584m Length of Line
Date: 06/10/2014	
Surveyed by: SUNNY MAHLANGU 0836566266	
BV126785739 - DHLAMINI(OVER 80m).dgn 07/10/2014 09:03:05 AM	

LOCALITY PLAN

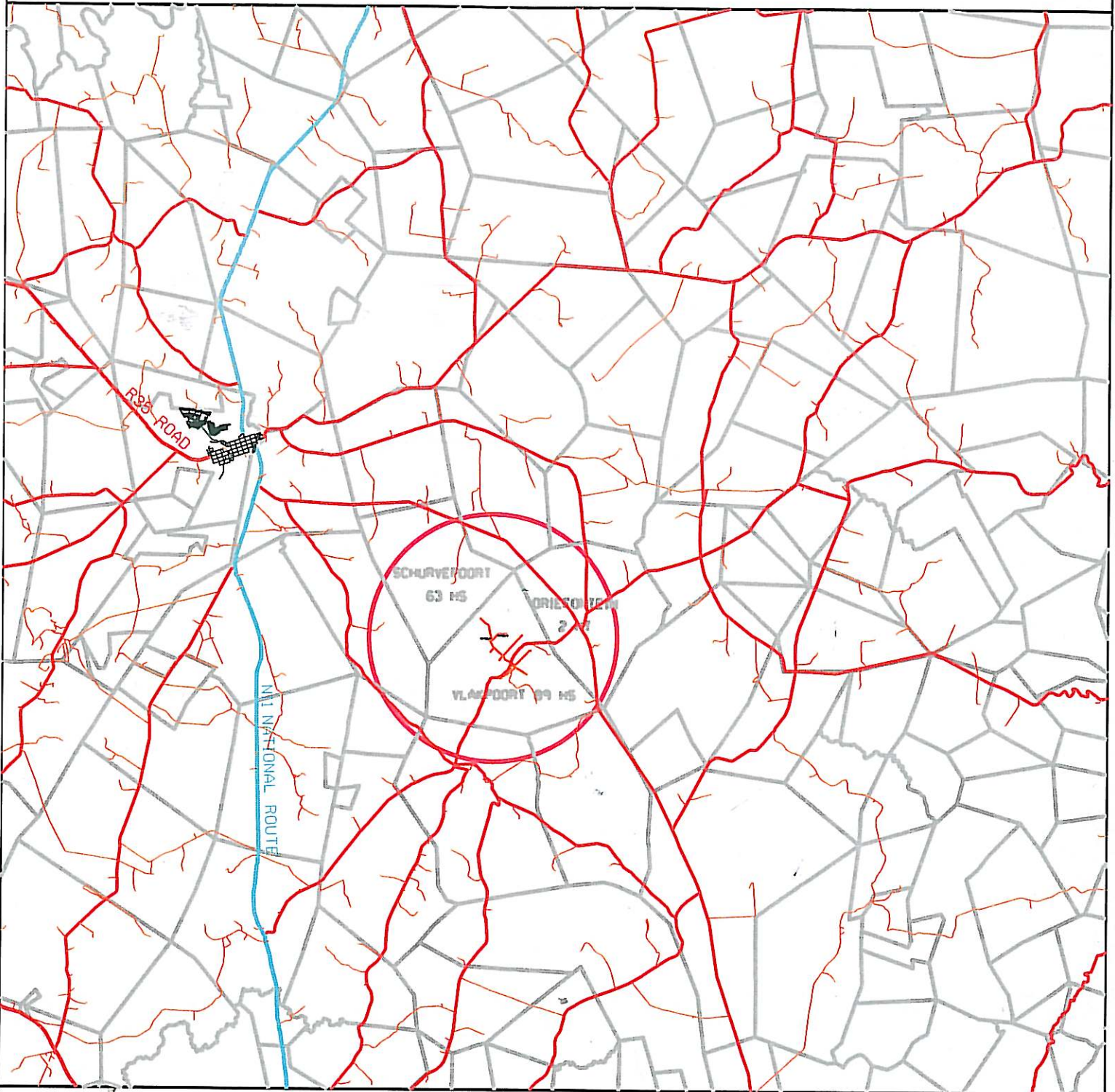

Disclaimer
Geographic Mapping eMalahleni
are not responsible for any errors
in external datasets displayed on this map.

WGS84

COORDINATE SYSTEM: LO84/29

SCALE 1:250 000

Information from official maps reproduced under Government printers copyright authority No. 4138 of 28/03/1989



Mpumalanga Operating Unit
Land Development

P.O.Box 223
eMalahleni 1035
Tel 013 - 693 3121
Fax 013 - 693 3261

Feeder:	Bergvliet NB122 22kV Line	Surveyor:	
Customer:	DHLAMINI	Geographic mapping:	A MABESELE
Project No:	BV126785739	Date compiled:	12/09/2014
Portion of map no:	2729 BB N	T-OFF POLE COORD:	Y=-98422.1750 29° 59' 32.5" E X=2997679.7570 27° 05' 13.9" S
Page:	1 of 3	Revised by:	
		Revision date:	