

CO-ORDINATES
PROJECTION : GAUSS CONFORM (WG 27)

POINT	X	Y
A	2996026.84	-58638.25
B	2995948.12	-60657.95
C	2995435.70	-60887.03
D	2995873.32	-63958.10
E	2997147.26	-64185.17
F	2997472.04	-62380.91
G	2997577.46	-60262.17
H	3000980.29	-60588.65
J	3001001.38	-60495.66
K	3002431.24	-60512.38
L	3002564.86	-59562.38
M	3003139.63	-58250.22
N	2999108.90	-57565.24

Legend
Application Area
Farm Boundaries
Subdivisions

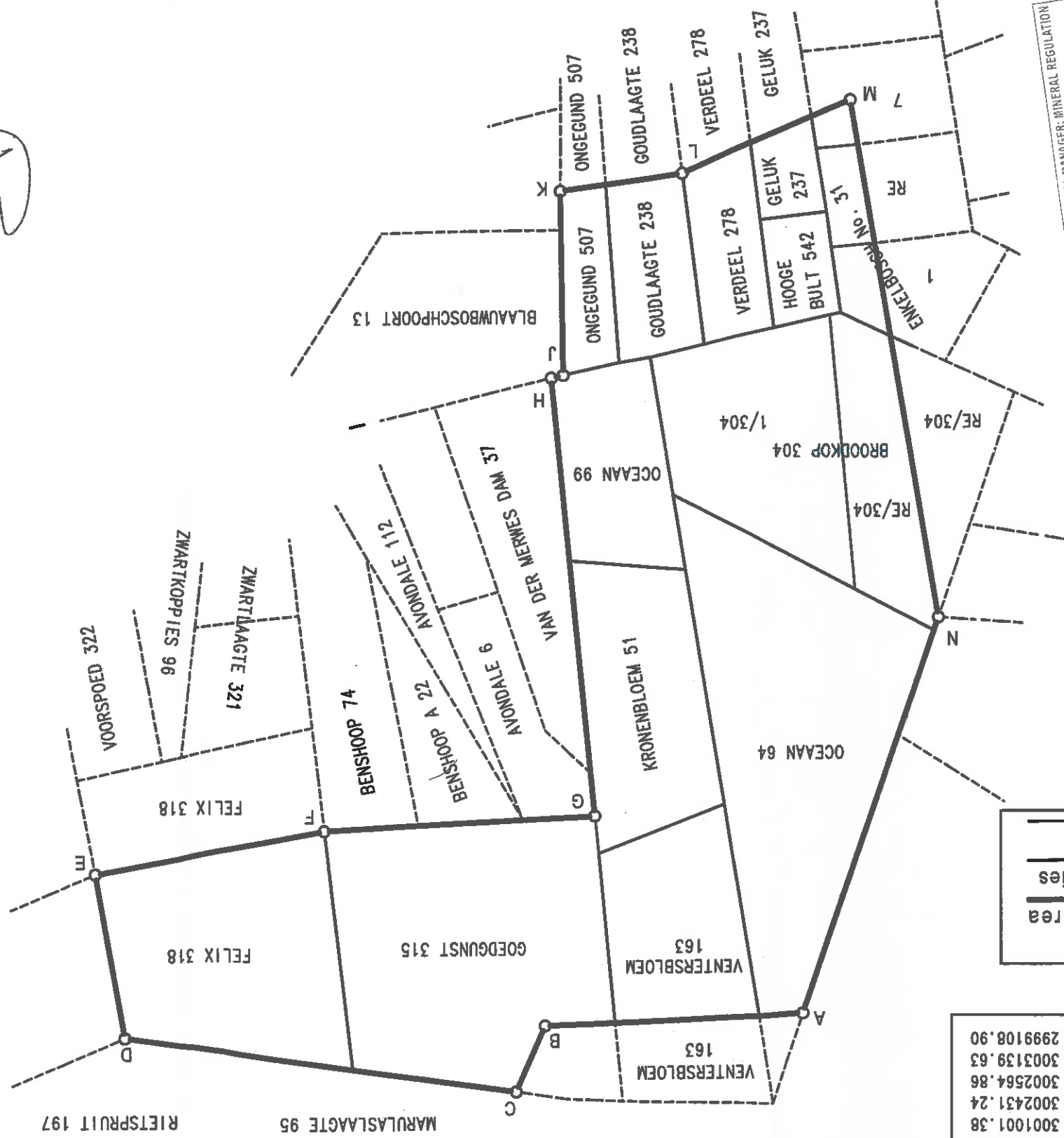

PROPERTY SCHEDULE

FARM NAME	FARM No.	PORTION	DISTRICT
Broodkop	304	P0	Vredfort
Broodkop	304	1	Vredfort
Enkelbosch	31	P0	Vredfort
Enkelbosch	31	P1	Vredfort
Enkelbosch	31	P7	Vredfort
Felix	318	P0	Vredfort
Geluk	237	P0	Vredfort
Goedgunst	315	P0	Koppies
Goudlaagte	238	P0	Vredfort
Hoog Bult	542	0	Vredfort
Kronenbloem	513	0	Vredfort
Ocean	64	P0	Koppies
Ocean	99	0	Koppies
Ongkund	7	P0	Vredfort
Ventersbloem	163	P0	Koppies
Verdeel	278	P0	Vredfort

* 'P' denotes 'Part of'

LENGANA HEALTH SA (Pty) Ltd

PLAN OF LAND UNDER
CO-OPERATION PERMIT

The figure ABCDEFGHJKLMNA represents the Application Area being a total Area of 2292,4646 Hectares, in the District of Koppies and Vredfort for which Lengana Health SA (Pty) Ltd has applied for a Technical Co-operation Permit in terms of Section 76 of the Mineral and Petroleum Resources Development Act, 2002 (Act No. 28 of 2002).

SCALE 1: 40 000 (A3)

NOTES:
1. 1:50 000 Topographical Map: 2727BA
2. Final area can only be determined by survey.
3. Compiled by calculation and compilation from Surveyor General data.

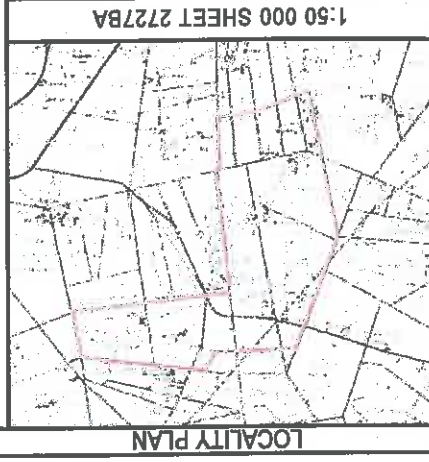

[Signature]
Lengana Health SA (Pty) Ltd
Sign _____ Date 29/09/2020

[Signature]
REGIONAL MANAGER
Petroleum Agency
South Africa
Sign _____ Date 29/9/2020

[Signature]
N. Khatleli
Professional Land Surveyor (PLS 1358)
Sign _____ Date _____

REGIONAL MANAGER: MINERAL REGULATION
FREE STATE REGION
2020-08-31
DEPARTMENT OF MINERAL RESOURCES
PRIVATE BAG X33, WELKOM 9460