

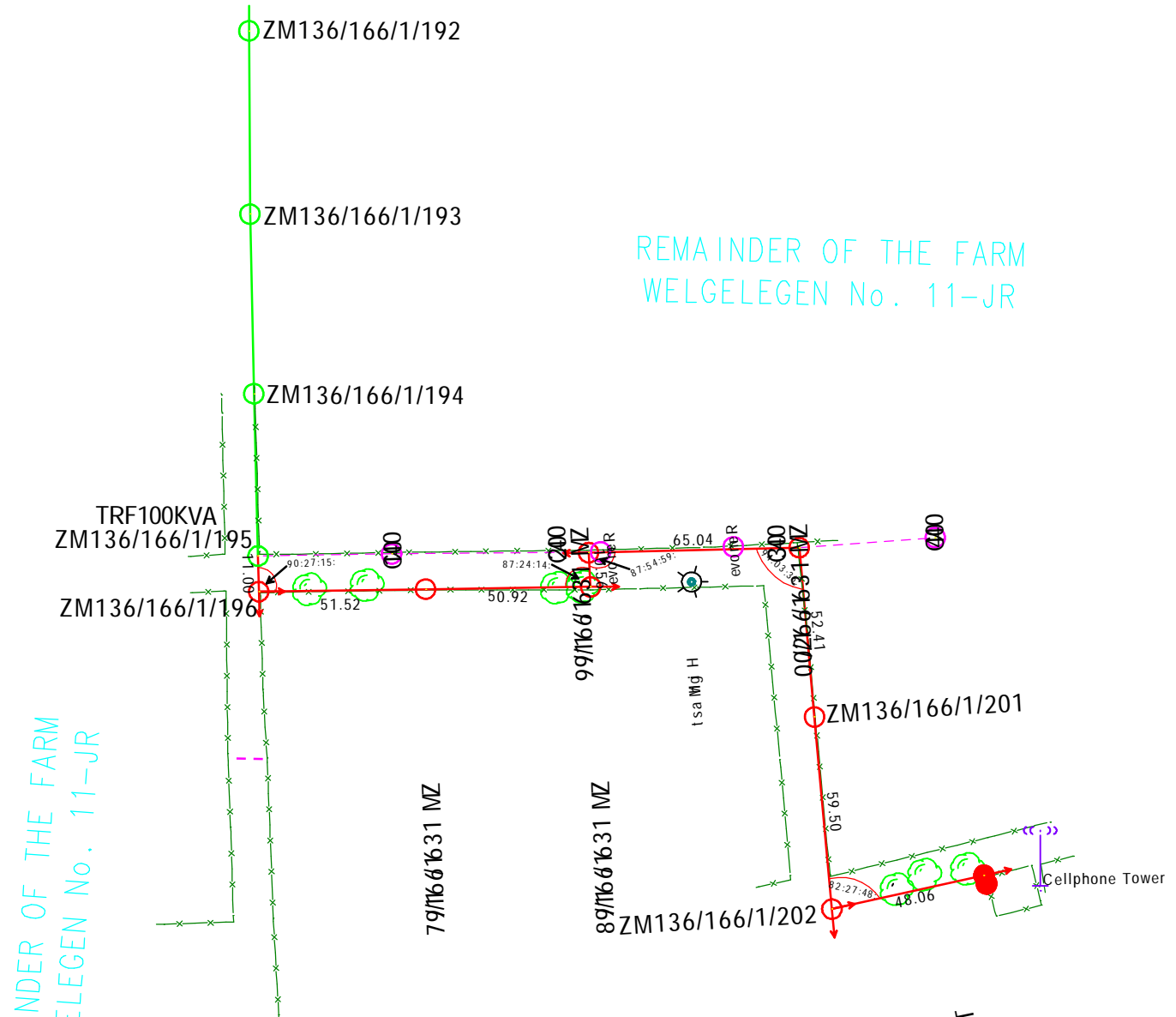

DIPETLELWANE PEGGING  
 SCALE 1 : 2 000  
 BUSH CLEARING REQUIRED



REMAINDER OF THE FARM  
 WELGELEGEN No. 11-JR

REMAINDER OF THE FARM  
 WELGELEGEN No. 11-JR

LEGEND	
NEW MVLIN	43.26
EXISTING MVLIN	
TELEPHONE LINE	
MESH FENCE	
TREE	
HIGH MAST	

AVK52 FRT  
 302 V 66 V 631 MZ

CO-ORDINATE SYSTEM : L084/WG29

ESKOM LIMPOPO OPERATING UNIT LAND DEVELOPMENT	MATIBE AND ASSOCIATES	SUITE 12 2010 CENTRE PRENISES ERF 18 THOHAYANDOU-D LIMPOPO PROVINCE
FEEDER:	CUSTOMER: ESKOM LIMPOPO OPERATING UNIT	
PROJECT No: ATC SA WIRELESS INFRASTRUCTURE	PROPERTY: REMAINDER OF THE FARM WELGELEGEN No. 11-JR	
CONDUCTOR:	DATE: MAY 2020	
LENGTH OF LINE: MV =0.349 KM LV= 0.00 KM	COMPILATION:	
SURVEYOR: P. MATIBE	SCALE: 1 : 2 000	
DRAUGHTSPERSON: T.M MAEPA		