

SHEET 11L COPY 3
 CITY OF DURBAN
 PLAN NUMBER
 0765/06/92/3

AS BUILT
 20-9-92
 INCORPORATING
 APPROVALS
 NO. 0017/14/95 APP. 30/12/1996
 NO. 074/67/86/ APP. 24/11/86
 NO. 112/8/84 APP. 17/11/85
 No. No. No.

Del. 07/06
 APPROVED: R. W. MOORE
 EXECUTIVE DIRECTOR: PHYSICAL
 ENVIRONMENT SERVICE UNIT
 DATE 1-SEP 1992 FOR *Resignations*

ELECTRICITY SERVICES
 Any person undertaking electrical operations shall be qualified in terms of the following:
 1) The holder of a valid certificate of competence in the relevant field of the electrical work.
 2) The holder of a valid certificate of competence in the relevant field of the electrical work, and a valid certificate of competence in the relevant field of the electrical work, and a valid certificate of competence in the relevant field of the electrical work.

DEVELOPMENT CONTROL DEPT.
 TOWN PLANNING AUTHORITY
GRANTED
 1992-08-27
 Signature: *[Signature]*
 Checked: *[Signature]*

"It should be noted that this plan has been approved on the basis of information thereon."

DATE ISSUED
 24-06-1992

amendments to app. plan no. 0017/12/90/5 at 24/32 venice road, durban for CHRISHLTON PROPERTIES (CC)

CHRISHLTON
 design for modern living
 dwg no 127-1b

scale 1:500 1:100 date 20/7/92

- LIST OF AMENDMENTS:
- 1) lobby and v.c combined to form bathroom and 1 window bricked up
 - 2) lounge converted to bedroom
 - 3) partition added to bedroom and new entrance created to first floor
 - 4) window changed
 - 5) porch enclosed
 - 6) window to bedroom bricked up
 - 7) POOL ADDED BETWEEN LOUNGE & BEDROOM
 - 8) DOOR BETWEEN PORCH & BEDROOM REMOVED AND OPENING WIDENED TO 2,100

25/8/92

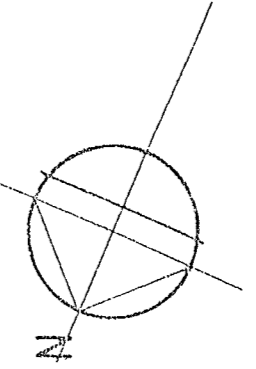
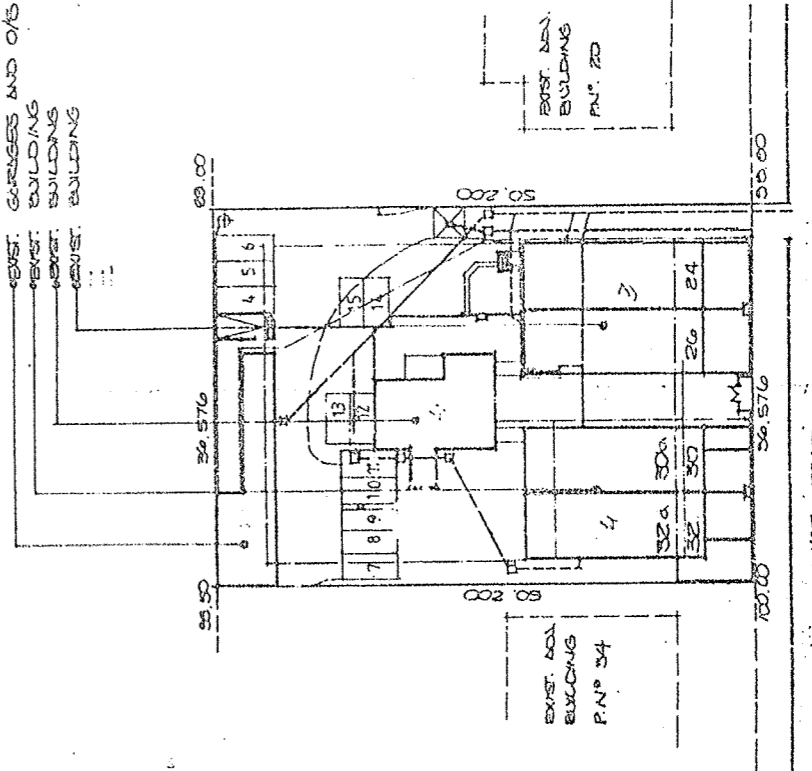

VEHICLE ROAD (27 M. WIDE)
 RATE NO. - 7406047
 SUB. D AND D OF LOT 122 C/F D OF TOWNSHIPS NO 1771
 SITE AREA - 1036 m²
 NO SECTIONAL AREA.

site plan