







**PROPOSED  
CONSTRUCTION OF THE  
HEUWELTJIES WIND  
ENERGY FACILITY**  
**NEAR BEAUFORT WEST,  
WESTERN CAPE PROVINCE**  
**SITE LOCALITY**

**Legend**

-  National Routes
-  Existing High Voltage Power Lines (400kV)
-  Farm Portions
-  Heuveltjies WEF Application Site
-  Preliminary Turbine Development Area
-  Proposed Substation Site Alternatives

**Source:**  
DEMARCATION BOARD, 2016  
ESKOM, 2012  
NGI, 2014

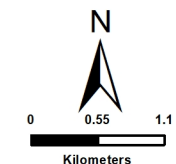

**ENVIRONMENTAL DIVISION**  
4 PENCARROW CRESCENT  
LA LUCIA RIDGE OFFICE ESTATE  
UMHLANGA ROCKS  
4320  
Phone: +27 31 581 1500  
Fax: +27 31 581 2371  
e-mail: info@sivest.co.za

<b>Project No</b> 16170	<b>Prepared By</b> SB	<b>Date</b> 30/09/2022
<b>Map Ref No</b> 16170	<b>Revision</b> 0	<b>Date</b> 
"COPYRIGHT IS VESTED IN SIVEST IN TERMS OF THE COPYRIGHT ACT (ACT 98 OF 1978) AND NO USE OR REPRODUCTION OR DUPLICATION THEREOF MAY OCCUR WITHOUT THE WRITTEN CONSENT OF THE AUTHOR"		
THIS MAP HAS BEEN PREPARED UNDER THE CONTROLS ESTABLISHED BY THE SIVEST QUALITY MANAGEMENT SYSTEM WHICH HAS BEEN CERTIFIED ISO 9001:2015 COMPLIANT		

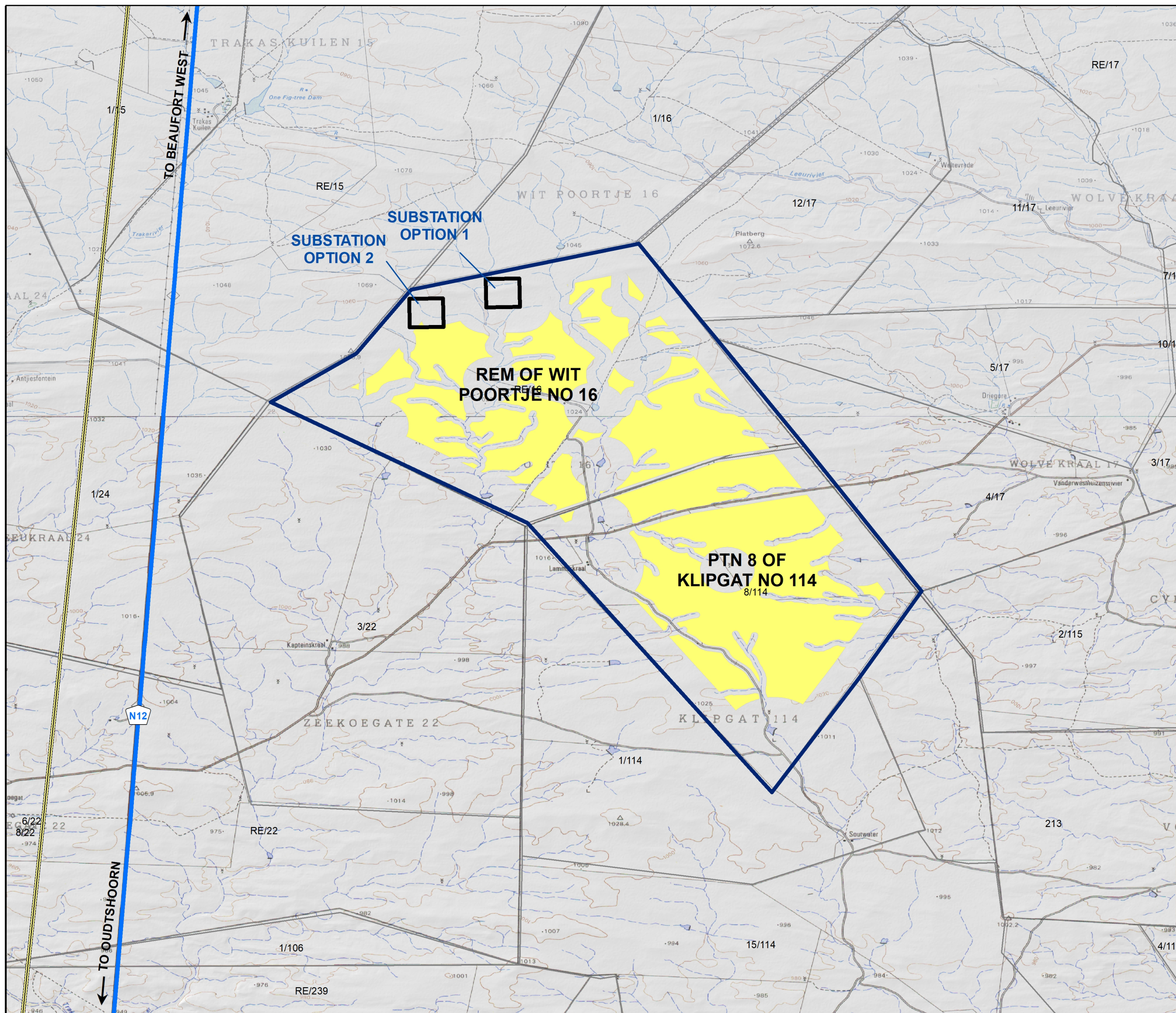



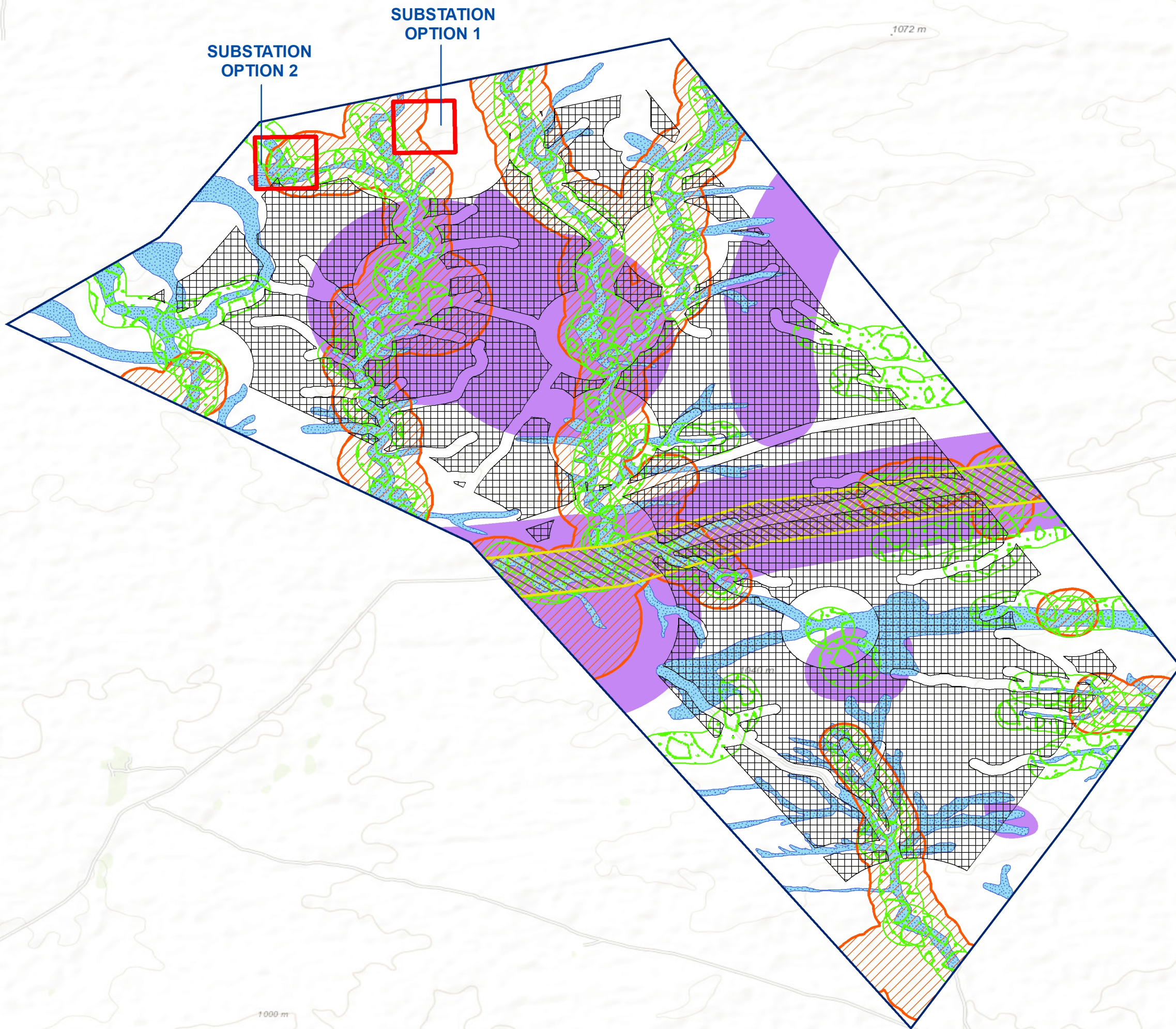

# PROPOSED CONSTRUCTION OF THE HEUVELTJIES WIND ENERGY FACILITY

NEAR BEAUFORT WEST,  
WESTERN CAPE PROVINCE

## SENSITIVITY LAYOUT

### Legend

 Heuveltjies WEF Application Site

### Proposed WEF Components

 Preliminary Turbine Development Area

 Proposed Substation Site Alternatives

### Environmental Sensitivities (No-Go)

 Aquatic & Terrestrial

 Archaeology

 Avifauna

 Bat

 Cultural

### Limited Development Area

 Visual

Source:  
NGI, 2014

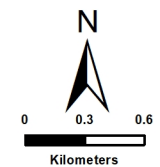

**ENVIRONMENTAL DIVISION**  
4 PENCARROW CRESCENT  
LA LUCIA RIDGE OFFICE ESTATE  
UMHLANGA ROCKS  
4320

Phone: +27 31 581 1500  
Fax: +27 31 581 2371  
e-mail: info@sivest.co.za

<b>Project No</b> 16170	<b>Prepared By</b> SB	<b>Date</b> 14/12/2022
<b>Map Ref No</b> 16170	<b>Revision</b> 0	<b>Date</b> _____

"COPYRIGHT IS VESTED IN SIVEST IN TERMS OF THE COPYRIGHT ACT (ACT 98 OF 1978) AND NO USE OR REPRODUCTION OR DUPLICATION THEREOF MAY OCCUR WITHOUT THE WRITTEN CONSENT OF THE AUTHOR"

THIS MAP HAS BEEN PREPARED UNDER THE CONTROLS ESTABLISHED BY THE SIVEST QUALITY MANAGEMENT SYSTEM WHICH HAS BEEN CERTIFIED ISO 9001:2015 COMPLIANT