

Revision Schedule		
Rev	Date	Description
A	09/02/2013	Ready for Council Submission
B	21/11/2012	Costing
C	29/01/2013	Revised Design
D	28-01-2014	Cement Screed note added to ramp, folding stacking doors from foyer/dinning area into examination space omitted, solar geyser to supply kitchen and staff wc, existing floor finish in storage space, existing entrance to be kept as is.

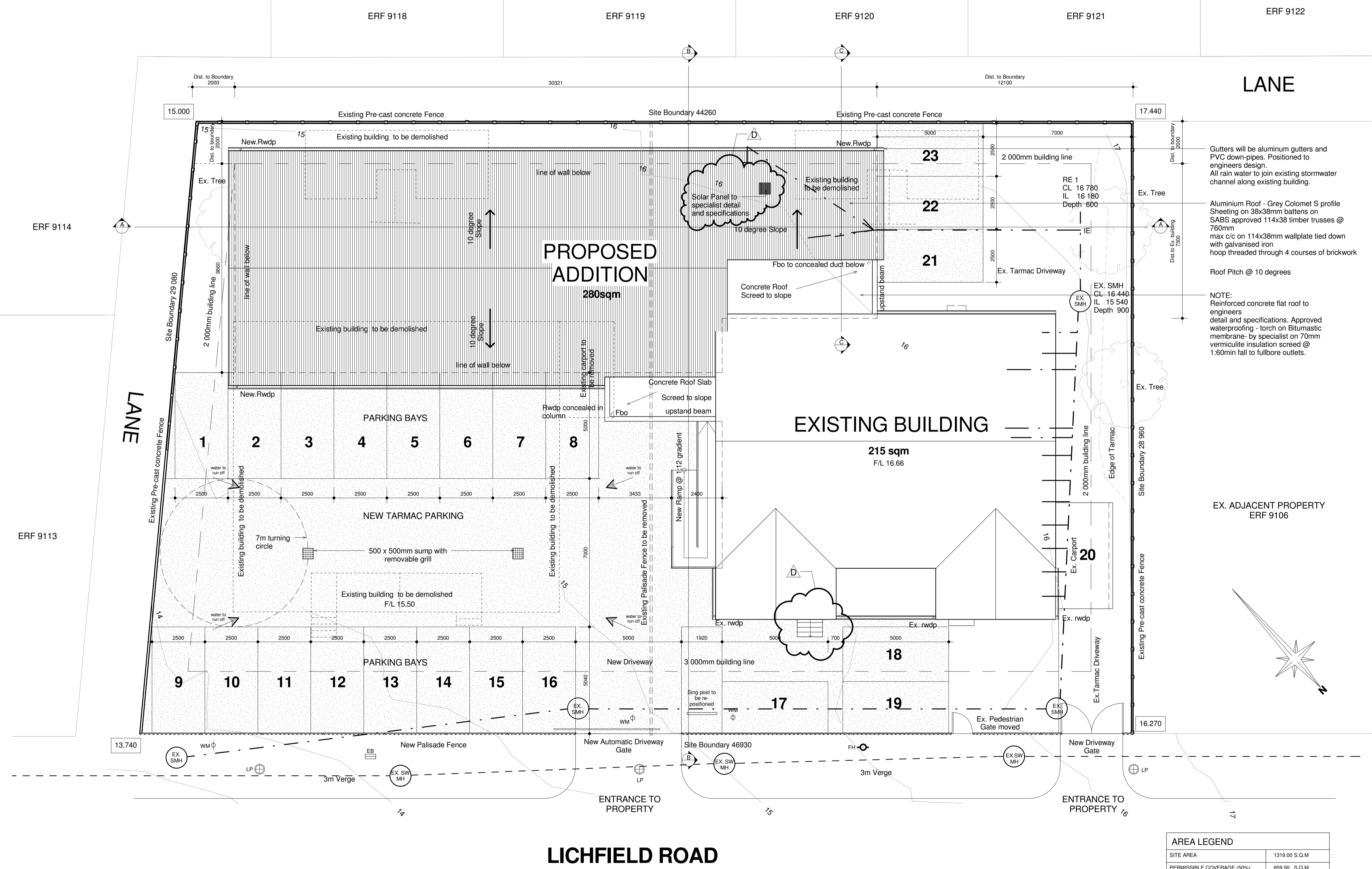

Gutters will be aluminum gutters and PVC down-pipes. Positioned to engineers design. All rain water to join existing stormwater channel along existing building.

Aluminium Roof - Grey Colomet S profile Sheeting on 38x38mm battens on SABS approved 114x38 timber trusses @ 760mm max c/c on 114x38mm wallplate tied down with galvanised iron hoop threaded through 4 courses of brickwork

Roof Pitch @ 10 degrees

NOTE: Reinforced concrete flat roof to engineers detail and specifications. Approved waterproofing - torch on Bitumastic membrane- by specialist on 70mm vermiculite insulation screed @ 1:60min fall to fullbore outlets.

SIGNED FOR CONSTRUCTION

ARCHITECT:

CLIENT:

IF THIS DRAWING IS NOT SIGNED BY THE ARCHITECT IT IS NOT FOR CONSTRUCTION PURPOSES

PROJECT
 Colleges of Medicine South Africa, Phase 1, ERF 9107/ 9108/ 9109/ 9110 Umbilo. 10/12/14/16 Lichfield Road

DESCRIPTION
 Site and Roof Plan

C A ARCHITECTS CC
 Suite E MGA HOUSE
 Wimble Close
 Ballito Business Park
 Po Box 6438 Zimbali 4418
 Tel: +27 32 946 3830/1
 Fax: +27 86624 9592
 email: llewellyn@caarchitects.co.za
 reg no 2621



AREA LEGEND	
SITE AREA	1319.00 S.Q.M
PERMISSIBLE COVERAGE (50%)	659.50 S.Q.M
EXISTING COVERAGE (16%)	216.00 S.Q.M
PROPOSED COVERAGE (23%)	307.00 S.Q.M
TOTAL COVERAGE (39%)	523.00 S.Q.M
PERMISSIBLE F.A.R (N/A)	1319.00 S.Q.M
EXISTING F.A.R (15%)	215.00 S.Q.M
PROPOSED F.A.R (21%)	280.00 S.Q.M
TOTAL F.A.R (36%)	495.00 S.Q.M

Areas
 1 : 50

1 Site and Roof Plan
 1 : 100

Drawn Denise G	Project nr: 347	Date: 2014/01/28 10:19:29 AM
Sheet nr: 347-WRK01-100	Rev Nr: D	