

Foot Print			
Site	263 ha	Office Room	200 m2
EIA	288 ha	Staff Room	200 m2
Lay down area	1950 m2	Security Room	56 m2
Reserved Area for BESS	60000 m2	Substation	3600 m2

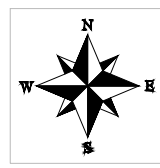

TRENCH DETAILS (Illustrative Purpose)
 Note: The trench details are for illustrative purpose only. Actual parameters may change during detailed engineering.

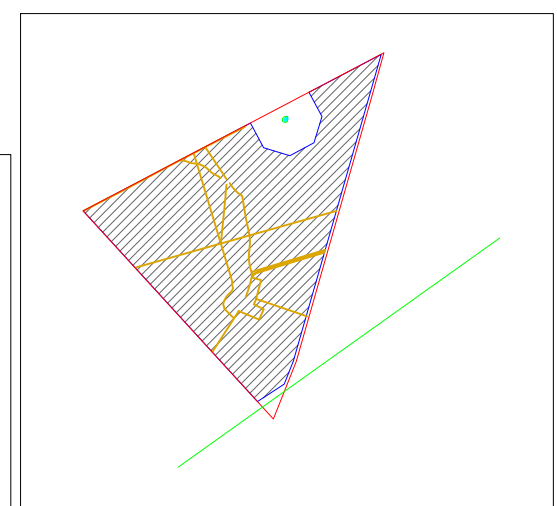
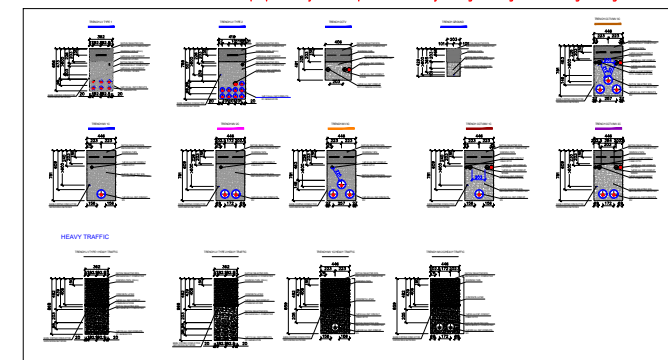

Legends

- Coordination of point: 26°59'36.87"S , 24°41'14.45"E
- PV plant land Border, 263 Hectares
- EIA land Border, 288 Hectares
- Existing Barrier / Fences
- 2.8 MWac (2x1.4) Inverter & Transformer Station
- Rack 2V28
- Proposed Connection line Route
- Site Access Road Width: 10 - 12 m
- Perimeter Road Width: 10 m Total Length: 8145 m
- Internal Roads Width: 6 m Total Length: 9935 m

Subsolar Company Address :	Project : Sonbesie Solar Power Plant 152.9 MWdc Photovoltaic Power Plant	Title : Preliminary Layout of PVP	Scale : 1:5000 Unit : Meter	Electrical Parameters DC capacity of plant 152.9 MW Number of modules 368 480 each 415 Wp (Modules are Bifacial type) Number of Inverters 47 each 2.8 MWac
	DWG No:	Project Name : <i>Sonbesie</i> Design : Technical Department of Subsolar Co.	DATE : 2020.11.20	