

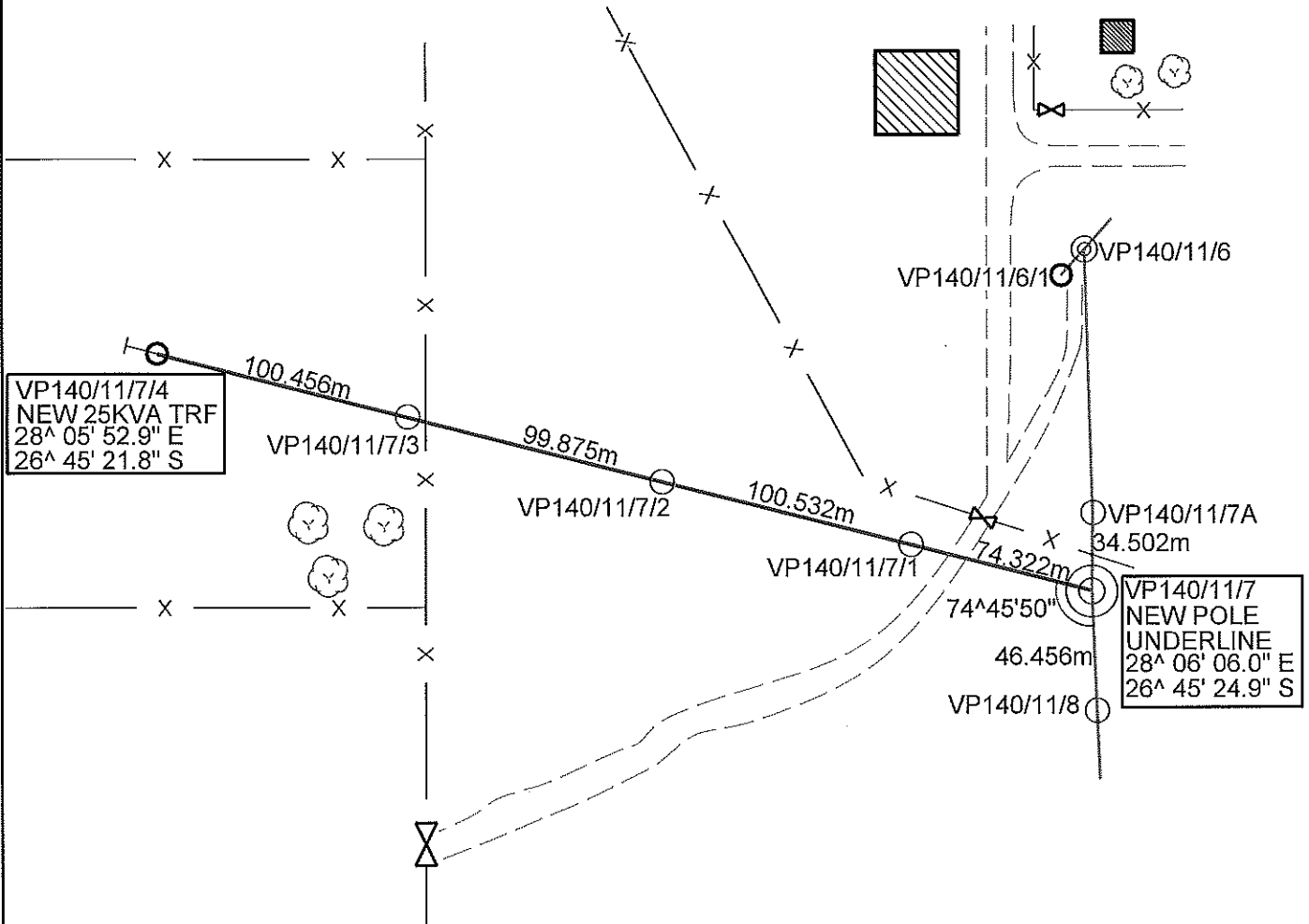

SCALE 1:2500

REMUNBER VP140/11/7 TO VP140/11/7A IN THE FIELD

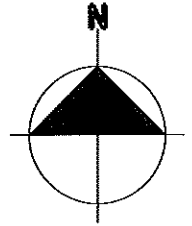

REMAINDER

VLAKFONTEIN 466 IR

Note: RED PEGS on site indicate structure position.

PLEASE NOTE:
 No protected trees/plants may be cut/trimmed/removed unless the applicable tree permit is issued and handed to the construction contractor.

25kVA Trfr.
 Project no : BG138810265
 NAME : NICOLAAS ROOS
 Drawn by : A MABESELE
 Date : 25/05/2015
 Surveyed by : Sunny(Alex) Mahlangu
 083 656 6266

T-Off Pole no: VP140/11/7
 T-Off angle 74° 45' 50"
 22kV Line
 375.185m Length of Line