

NEW WINDOWS - AIR EXISTING TO EXISTING UNPAVED SAFETY GLASS	
type	net glazing area
W001	4.20 sqm
W002	0.81 sqm
W003	13.00 sqm
W004	10.89 sqm
W005	2.71 sqm
W006	1.17 sqm
W007	0.81 sqm
W008	4.20 sqm
W009	1.45 sqm

NEW WINDOWS - AIR EXISTING TO EXISTING SAFETY GLASS	
type	net glazing area
W010	2.94 sqm
W011	1.15 sqm
W012	0.45 sqm
W013	1.40 sqm
W014	0.76 sqm Opaque glazing
W015	0.38 sqm Opaque glazing
W016	1.05 sqm
W017	1.14 sqm
W018	0.84 sqm
W019	1.29 sqm
W020	0.72 sqm

NEW DOORS - AIR EXISTING TO EXISTING UNPAVED SAFETY GLASS	
type	net glazing area
D001	1.99 sqm
D002	3.70 sqm
D003	9.00 sqm
D004	18.00 sqm

EXISTING WINDOWS	
type	net glazing area
E001	1.35 sqm
E002	2.79 sqm
E003	0.35 sqm
E004	0.86 sqm
E005	1.26 sqm
E006	0.76 sqm
E007	2.14 sqm
E008	3.13 sqm
E009	5.79 sqm

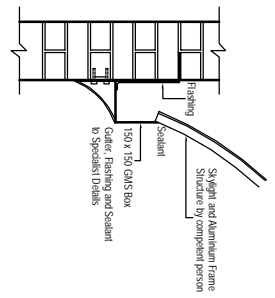
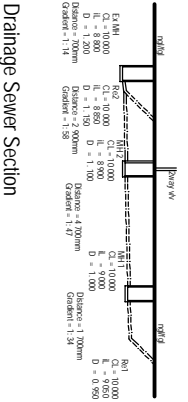

Skylight Gutter Detail 1:10

- Disability notices to comply with part 5
- SS4 - Doors
 - SS5 - Operation length of hand
 - SS6 - Force
 - SS7 - Operation length of hand
 - SS8 - Weight of operation
 - SS9 - Weight of operation
 - SS10 - Weight of operation
 - SS11 - Weight of operation
 - SS12 - Weight of operation
 - SS13 - Weight of operation
 - SS14 - Weight of operation
 - SS15 - Weight of operation
 - SS16 - Weight of operation
 - SS17 - Weight of operation
 - SS18 - Weight of operation
 - SS19 - Weight of operation
 - SS20 - Weight of operation
 - SS21 - Weight of operation
 - SS22 - Weight of operation
 - SS23 - Weight of operation
 - SS24 - Weight of operation
 - SS25 - Weight of operation
 - SS26 - Weight of operation
 - SS27 - Weight of operation
 - SS28 - Weight of operation
 - SS29 - Weight of operation
 - SS30 - Weight of operation
 - SS31 - Weight of operation
 - SS32 - Weight of operation
 - SS33 - Weight of operation
 - SS34 - Weight of operation
 - SS35 - Weight of operation
 - SS36 - Weight of operation
 - SS37 - Weight of operation
 - SS38 - Weight of operation
 - SS39 - Weight of operation
 - SS40 - Weight of operation

NOTE: CLASSIFICATION
 Small Shops = F2
 Offices = G1
 Dormitory = H2

SCHEDULE OF AREAS :	
SAFE AREA	16,110.52M ²
EX-GR - Guard Storey	8071.6952M ²
TOTAL EX-GR	11510.52M ²
EX COVERAGE	1085.2652M ²
PROPOSED EX-GR - Guard Storey	847.52M ²
TOTAL PROPOSED EX-GR	625.55M ²
PROPOSED COVERAGE	799.752M ²
TOTAL COVERAGE	1185.2252M ²
TOTAL AREA PROPOSED	705.5752M ²

SCHEDULE OF AREAS :	
SAFE AREA	16,110.52M ²
EX-GR - Guard Storey	8071.6952M ²
TOTAL EX-GR	11510.52M ²
EX COVERAGE	1085.2652M ²
PROPOSED EX-GR - Guard Storey	847.52M ²
TOTAL PROPOSED EX-GR	625.55M ²
PROPOSED COVERAGE	799.752M ²
TOTAL COVERAGE	1185.2252M ²
TOTAL AREA PROPOSED	705.5752M ²

Other:

GRAHAM BRAUM
 PRS: principal designer
 eng. no. ST/0010

ADDITONS AND ALTERATIONS and Conversion of Existing Church to Business and Residential Purpose, at 43 Maduat Street on P/R/ 10726 Durban and Portion of 10726 Durban for Donfield Investments CC

Rate no: 0060 2980/000
 Rate no: 0060 3990/000
 Rate no: 0060 4690/000

Scale: 1:100
 g.p. Exam
 date: 5 September 2013

drawing no. 4222/13/1 of 6